



Jumpy IV  
(K0)

Expert IV  
(K0)



Vivaro  
(K0)

Ref PCA: 16 544 721 80

Ref OV: 16 431 774 80

## Caméra de Recul VP1

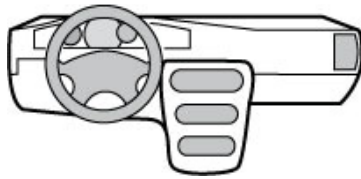

**NOT: 3895**

FR NOTICE DE POSE A USAGE PROFESSIONNEL / PHOTOS ET DESSINS NON CONTRACTUELS  
 GB FITTING INSTRUCTIONS FOR PROFESSIONAL FITTERS / PICTURES AND DRAWINGS ARE NOT CONTRACTUAL  
 ES INSTRUCCIONES DE MONTAJE PARA USO PROFESIONAL / FOTOS Y DIBUJOS NO SON CONTRACTUALES  
 P MANUAL DE MONTAGEM PARA UTILIZAÇÃO PROFISSIONAL / FOTOGRAFIAS E DESENHOS NÃO SÃO CONTRATUAIS  
 DE MONTAGEANLEITUNG FÜR EINSATZ IN FACHWERKSTATT / FOTOS UND ZEICHNUNGEN SIND NICHT VERTRAGLICH  
 IT ISTRUZIONI DI POSA AD USO PROFESSIONALE / FOTOGRAFIE E DISEGNI NON SONO CONTRATTUALI  
 NL MONTAGEHANDLEIDING VOOR PROFESSIONEEL GEBRUIK / FOTO'S EN TEKENINGEN ZIJN NIET CONTRACTUEEL





2



3

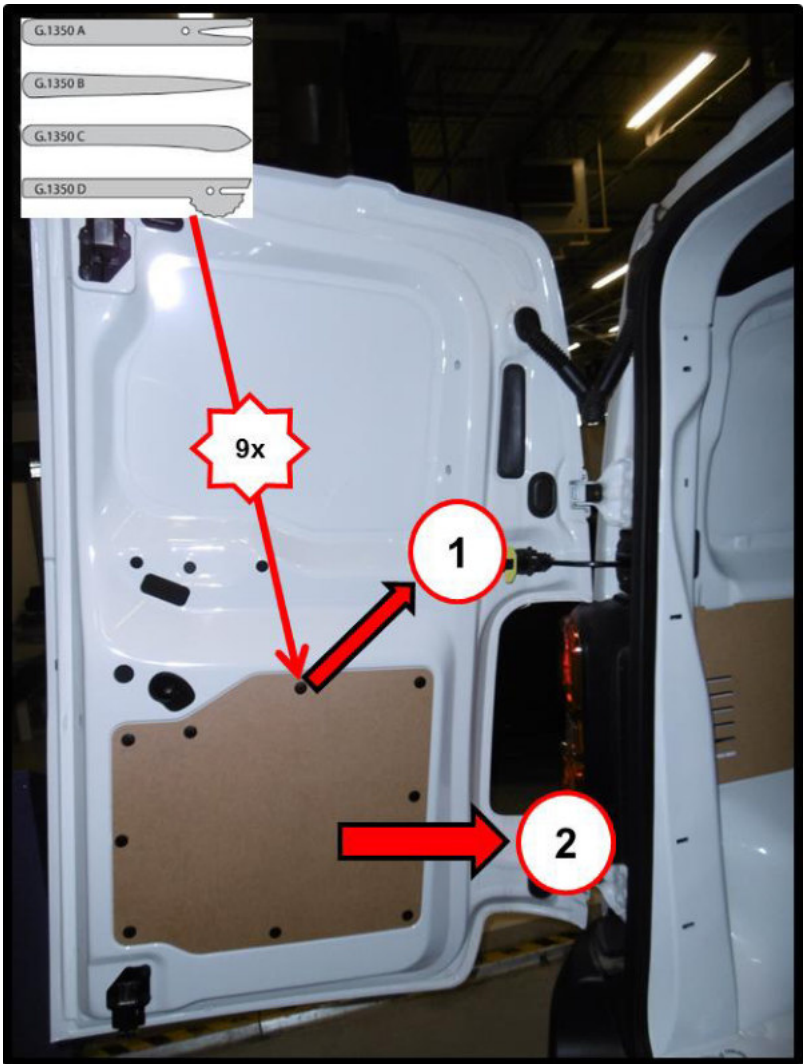

3-1

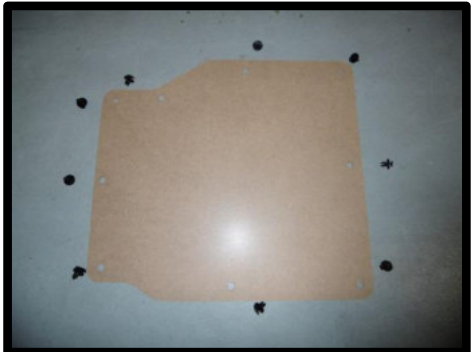

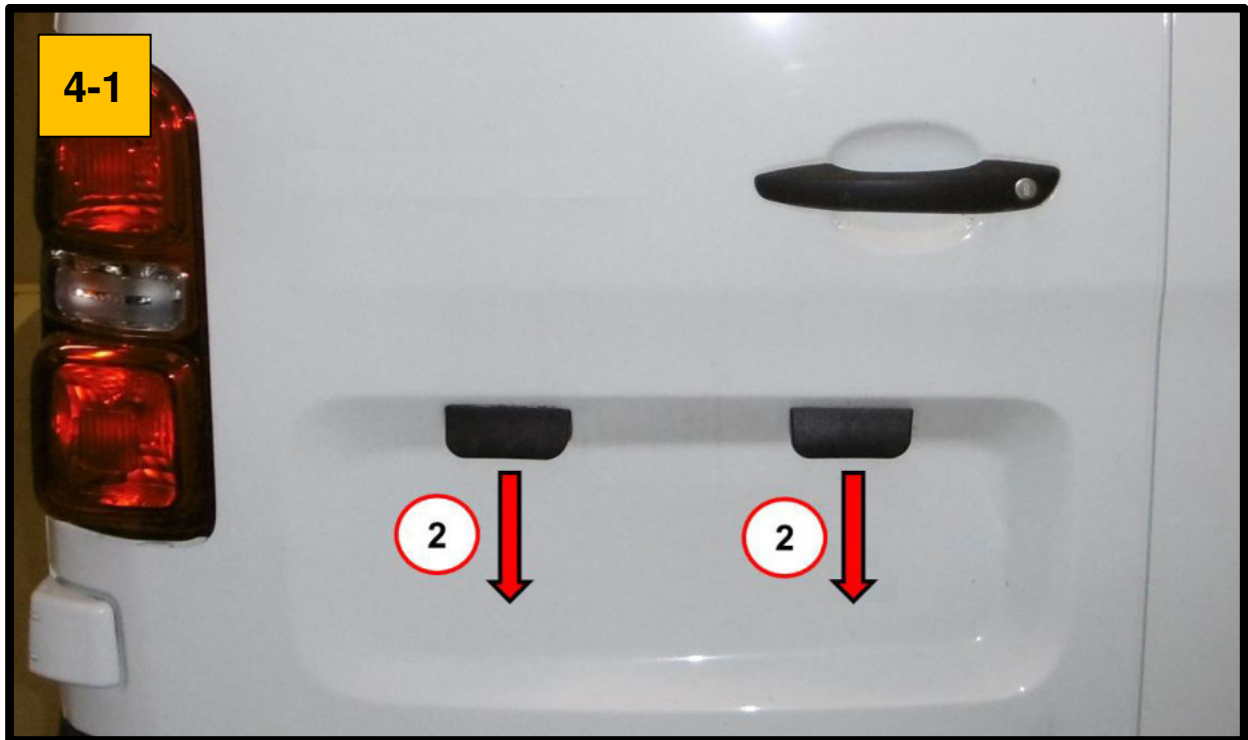
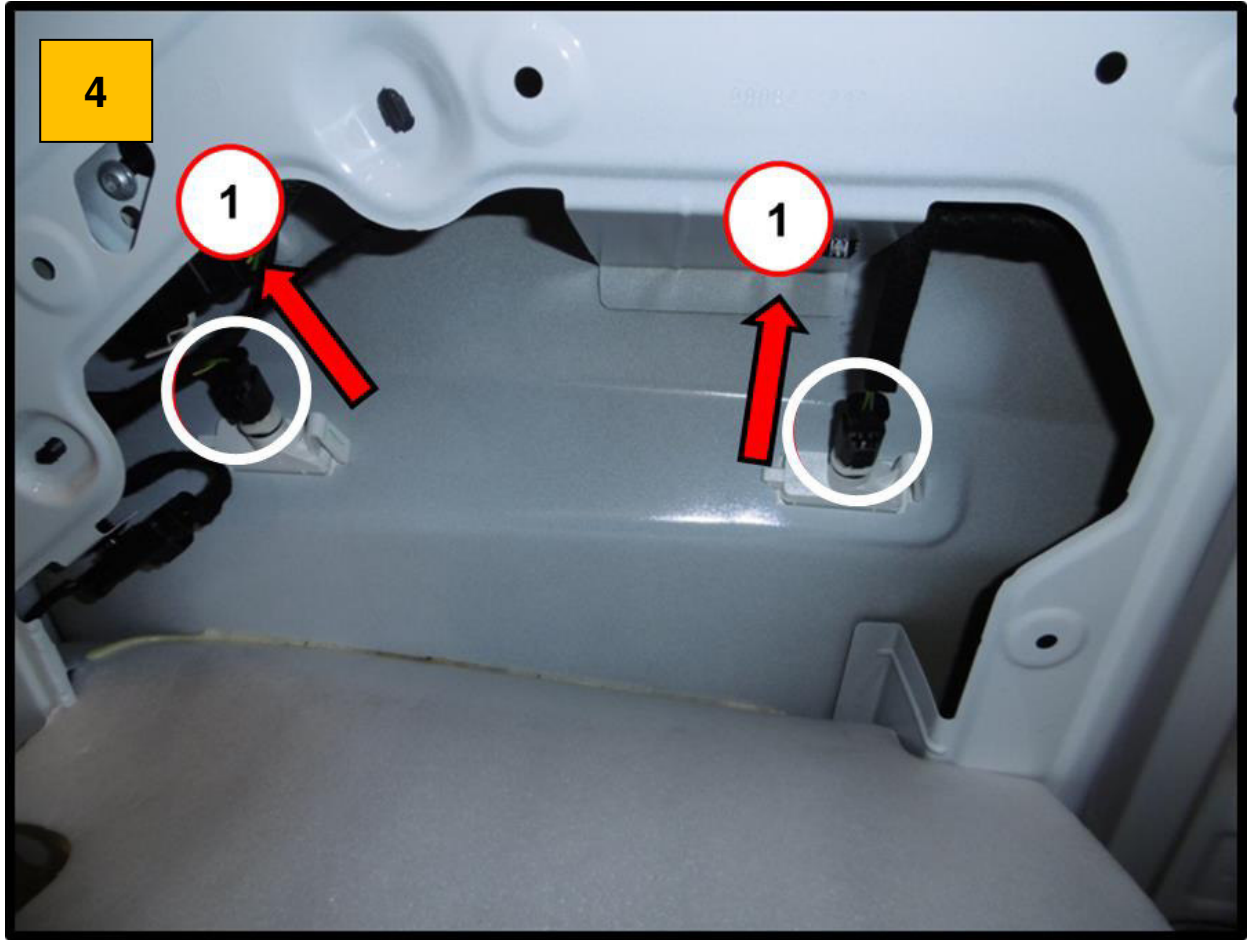

5

Annexe!

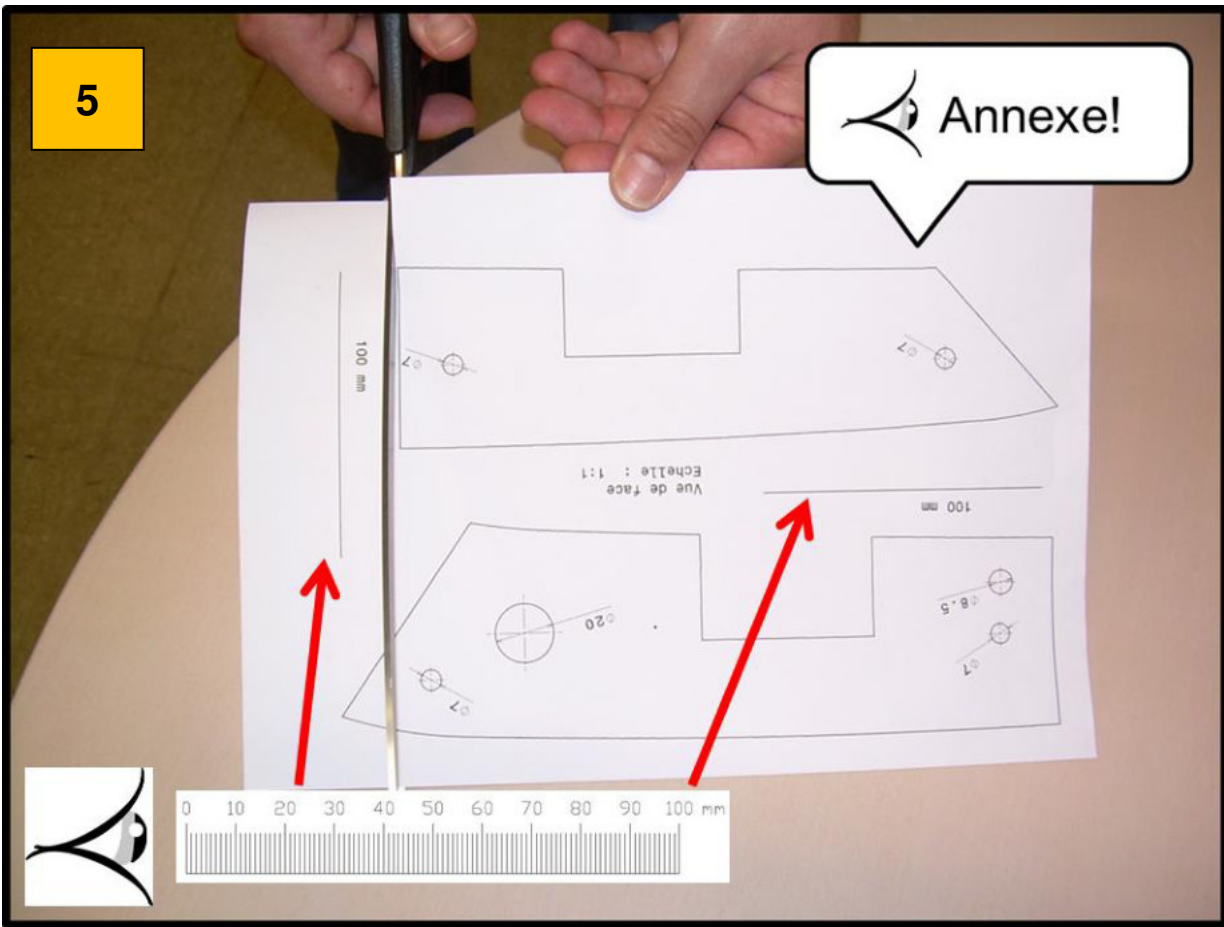

6

9885.83

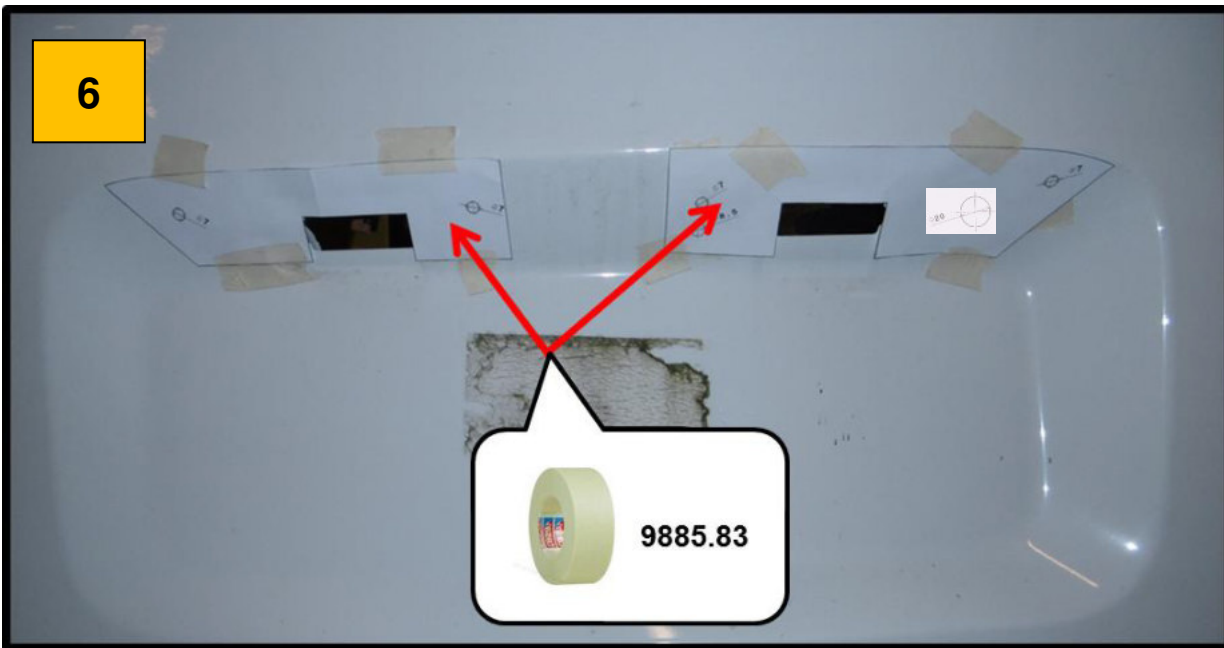

7

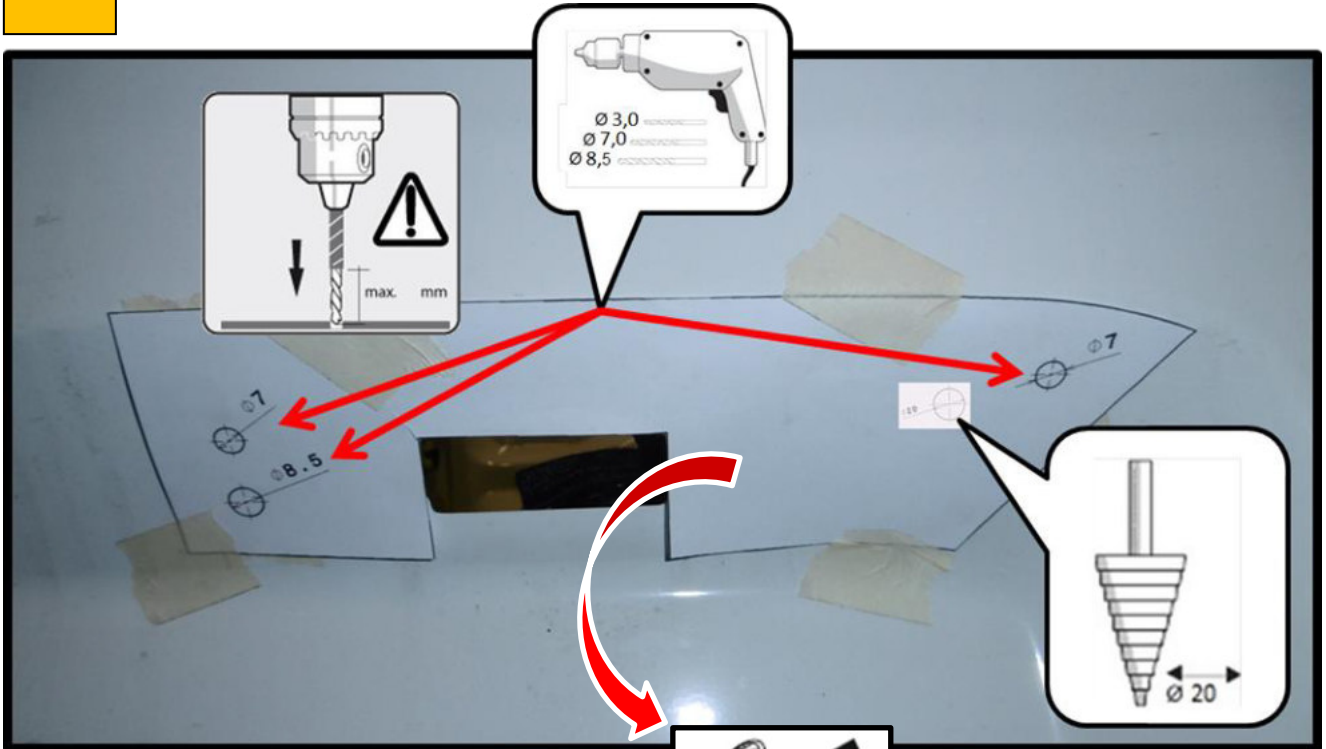

8

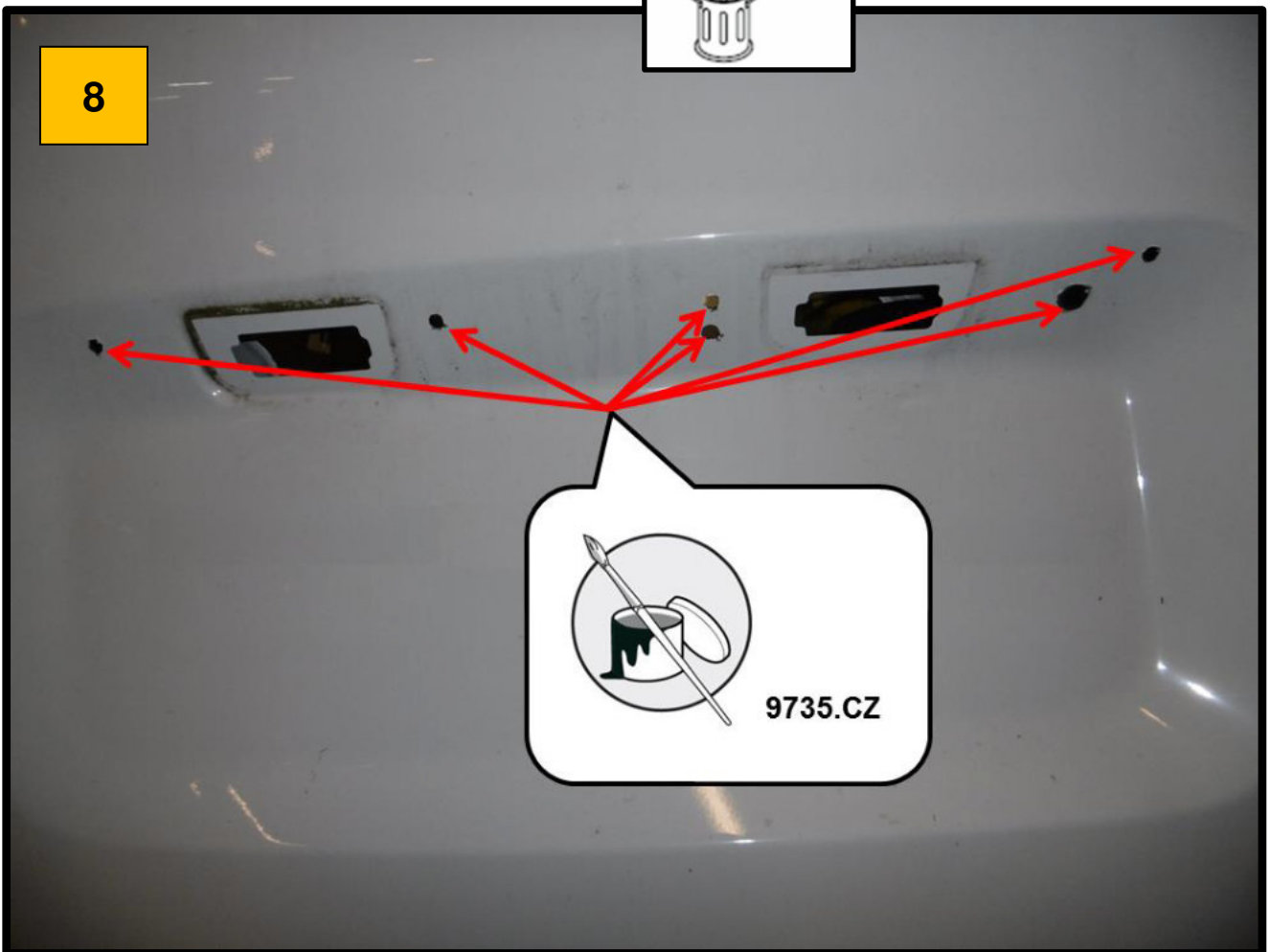

9



9-1



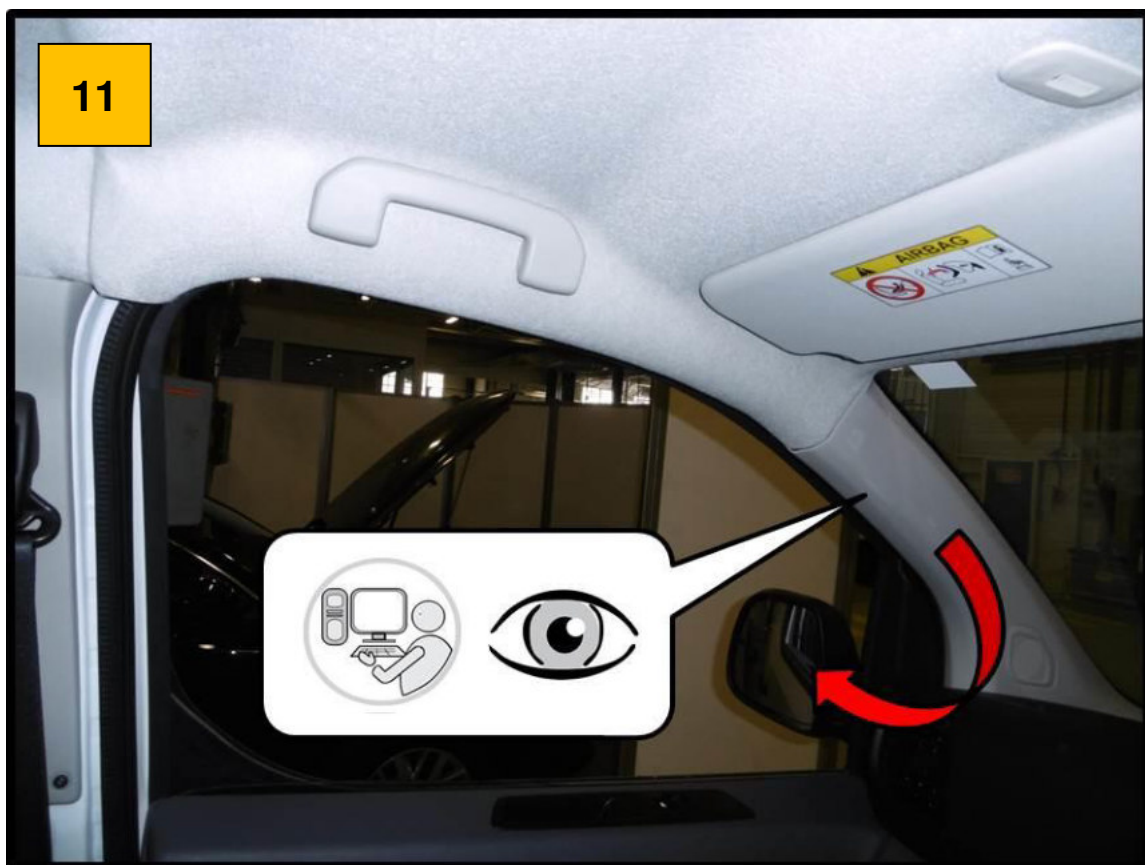
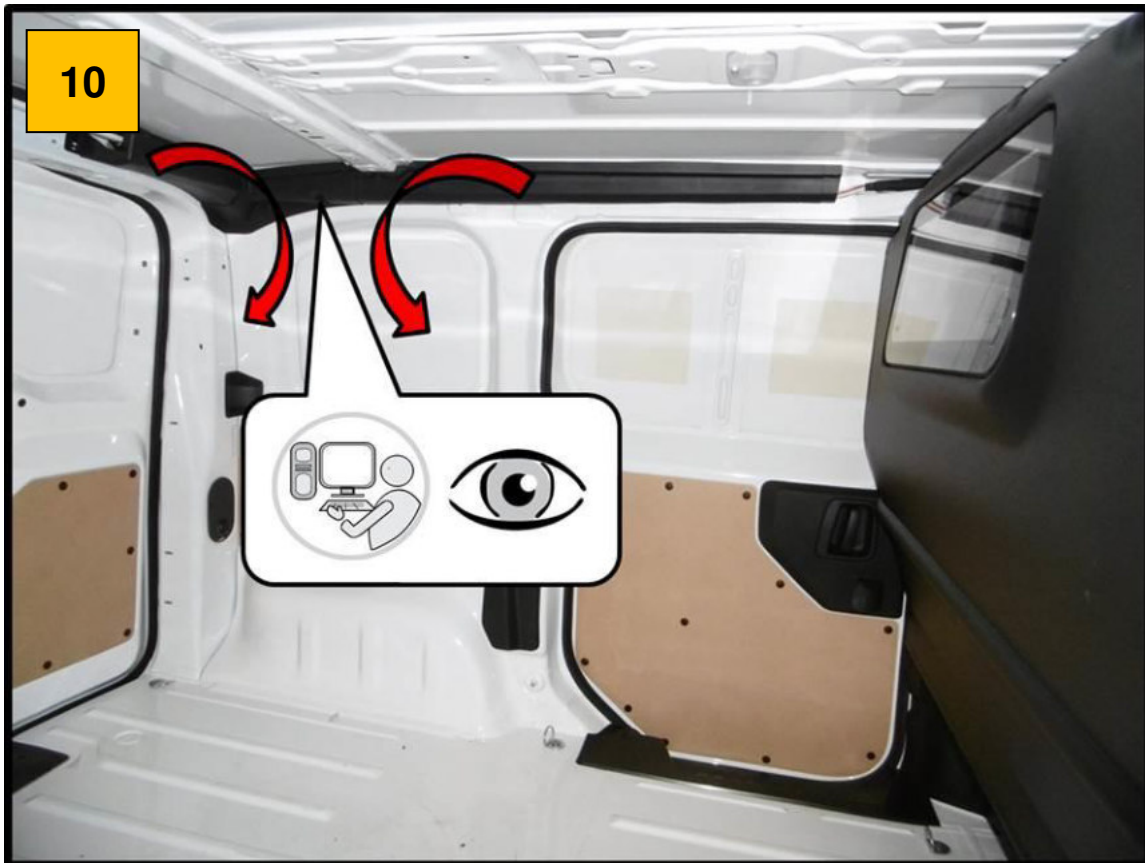





12-1

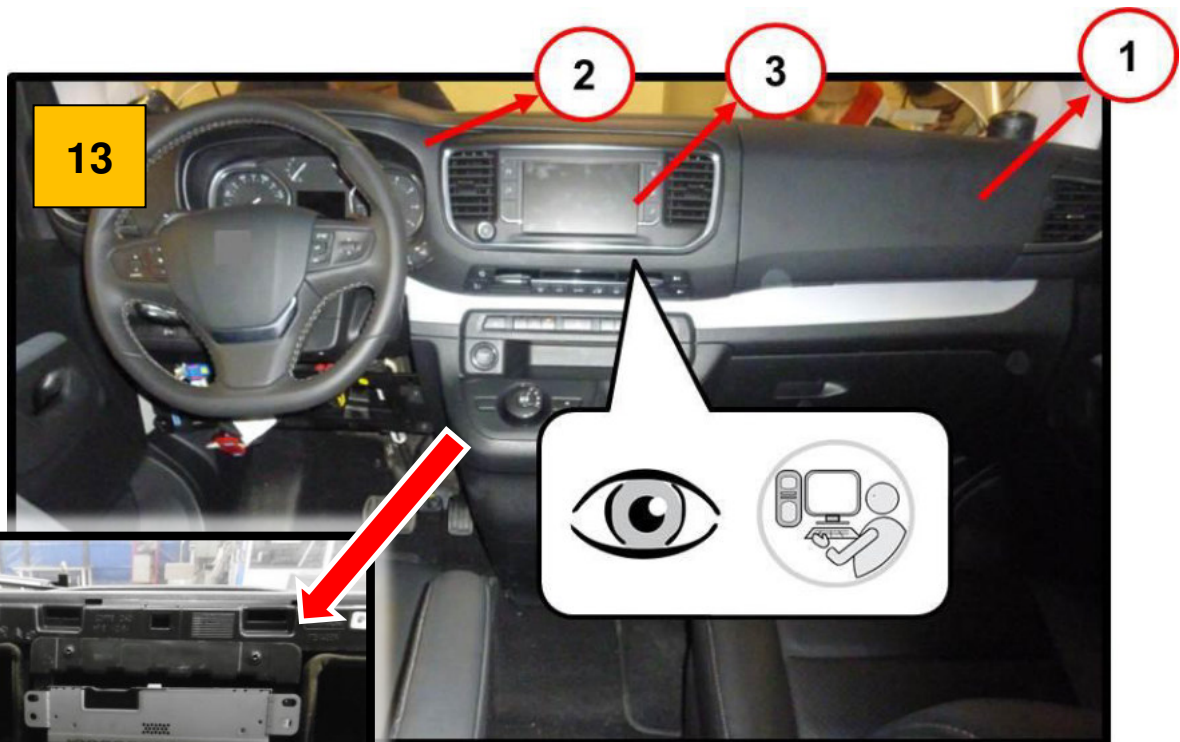

13-1

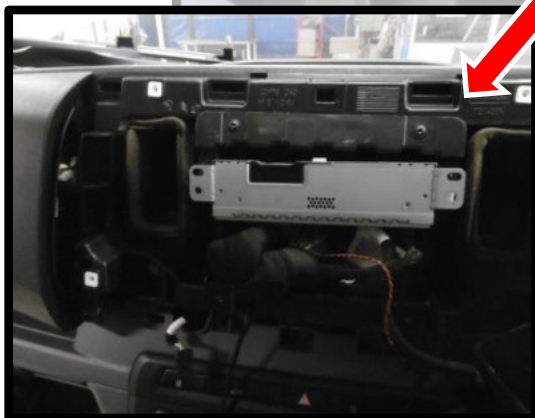

14

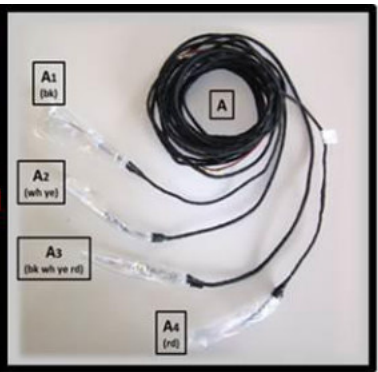
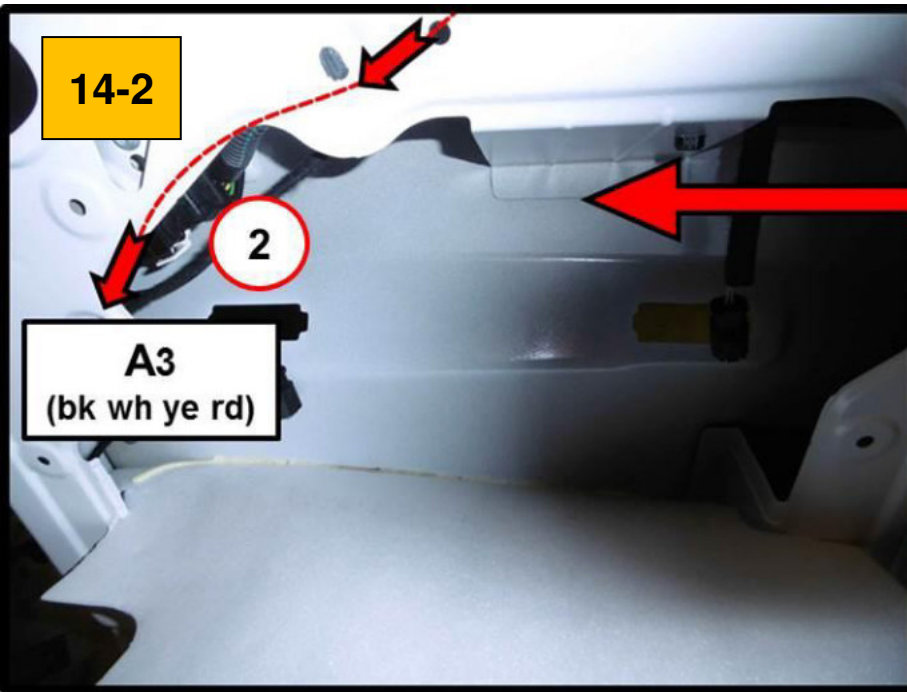
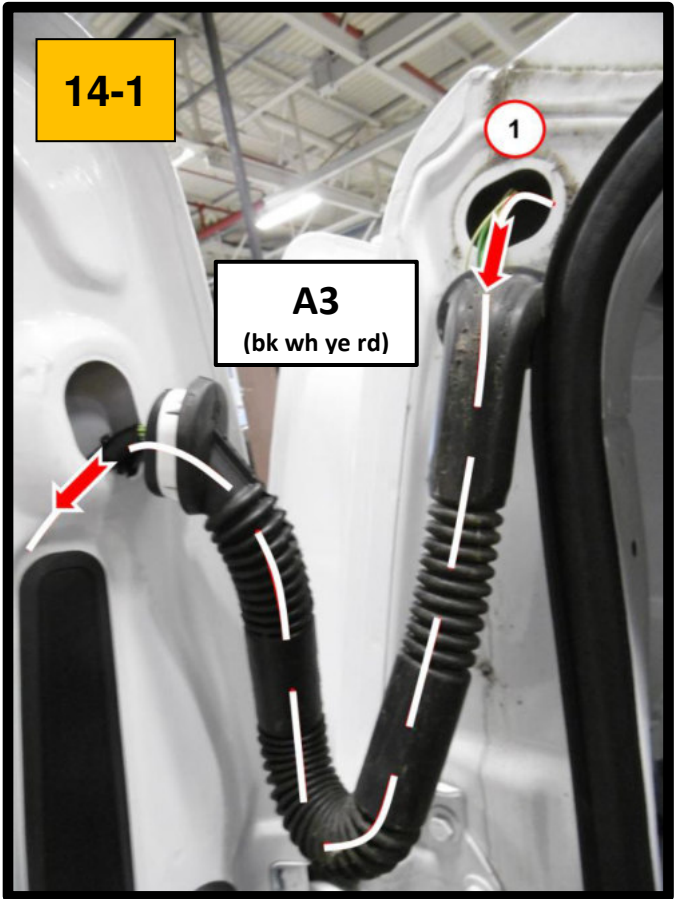
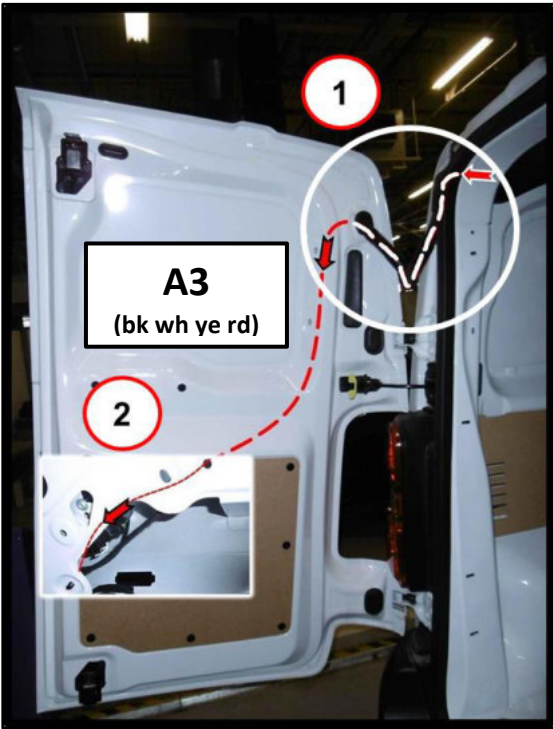

15

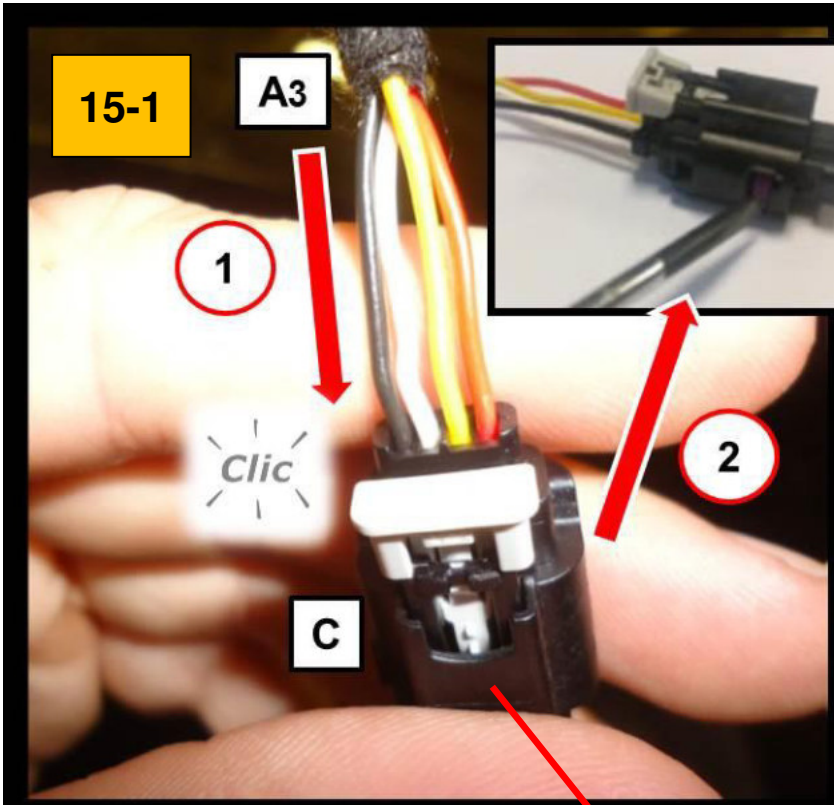
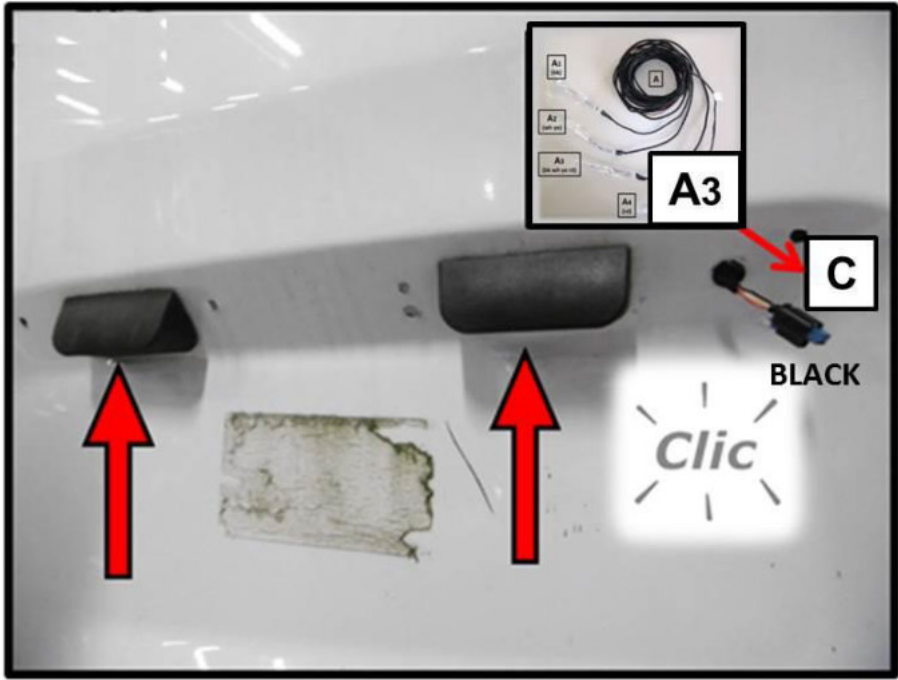
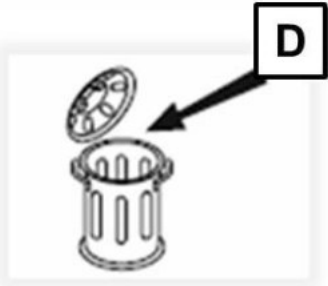
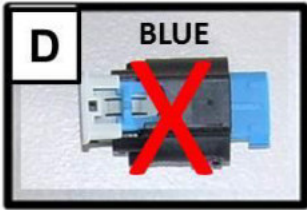

FROM	COLOR	TO	PIN
A3	rd	C	1
A3	ye	C	2
A3	wh	C	3
A3	bk	C	4

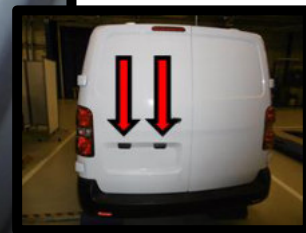
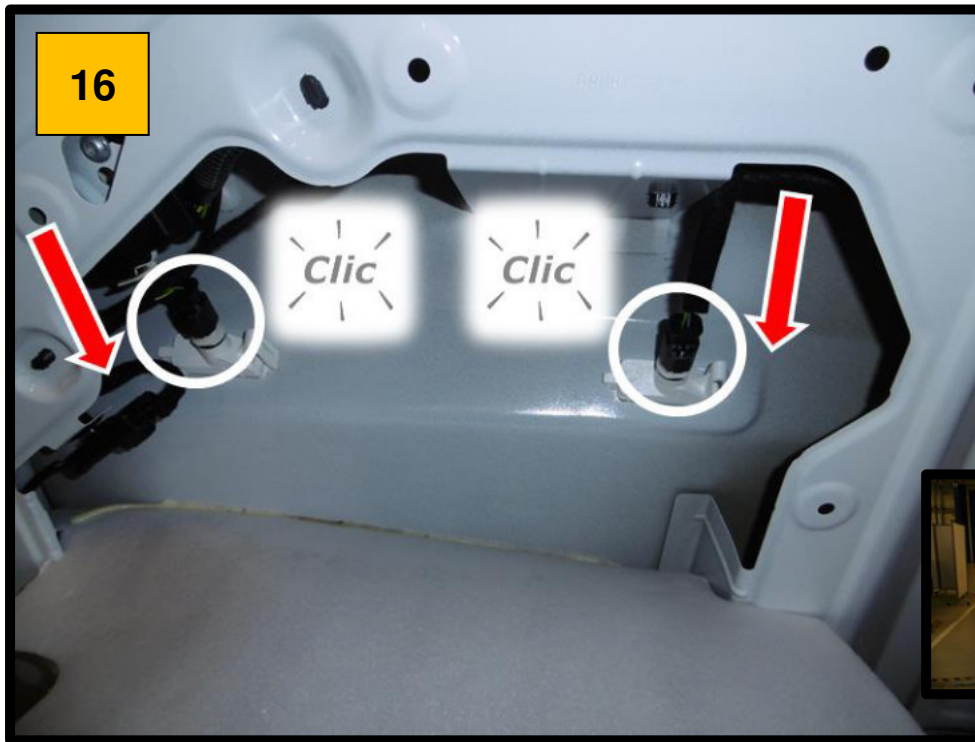

**17**

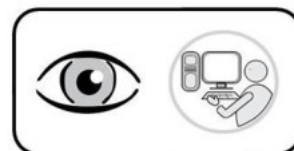

**17-1**



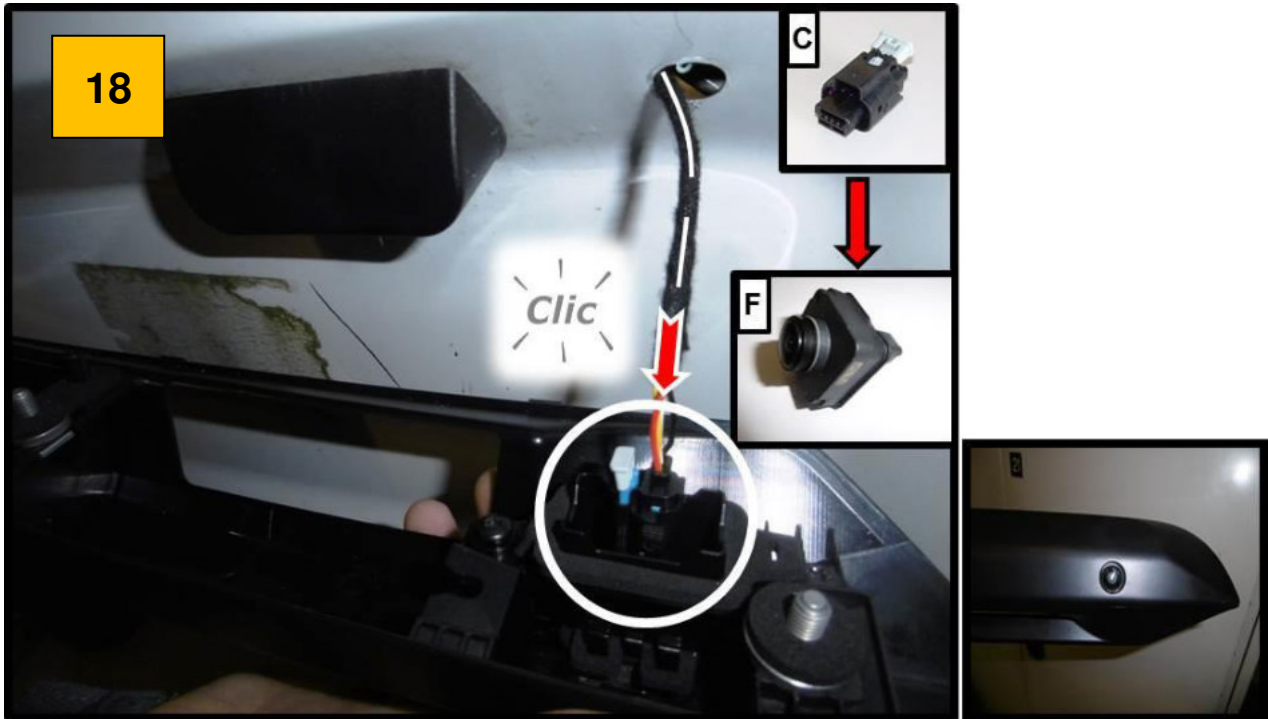

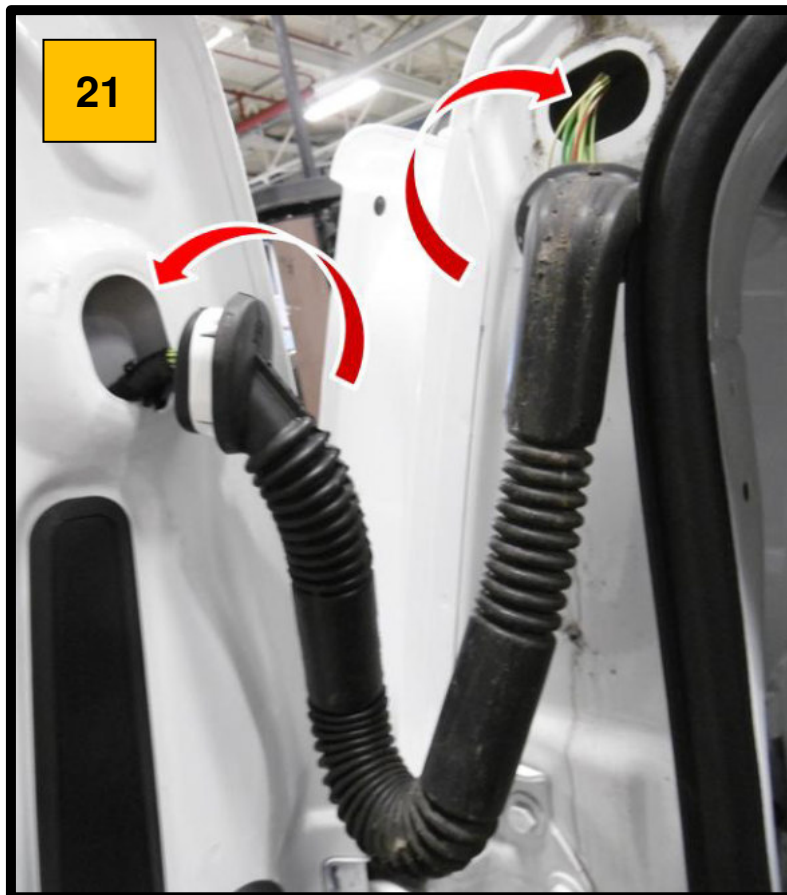

22-1

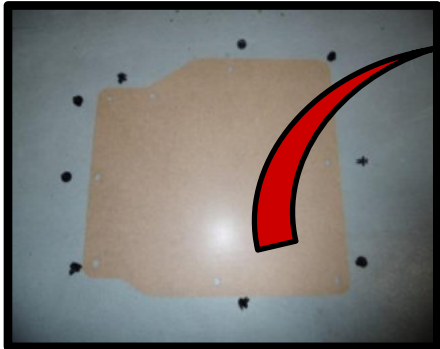

23

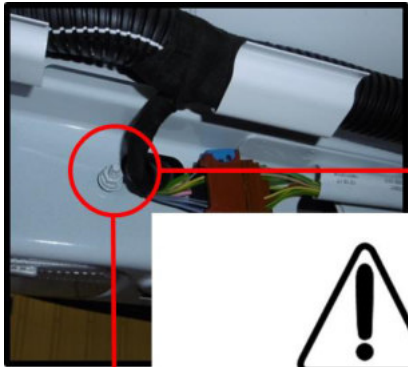

1

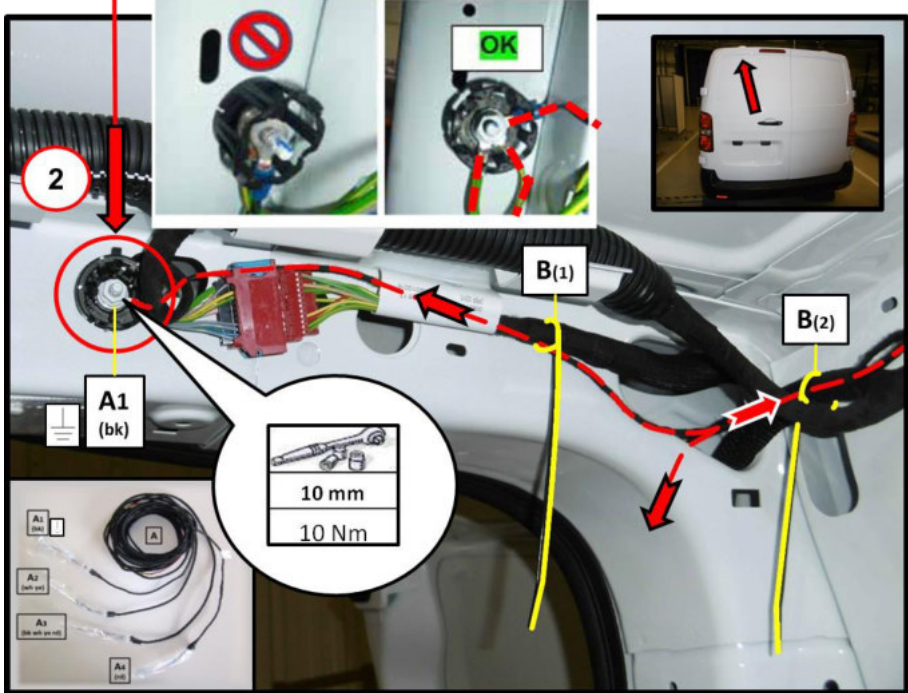
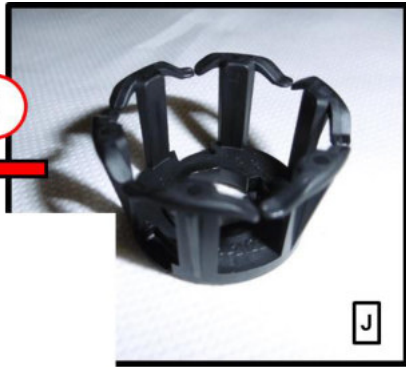

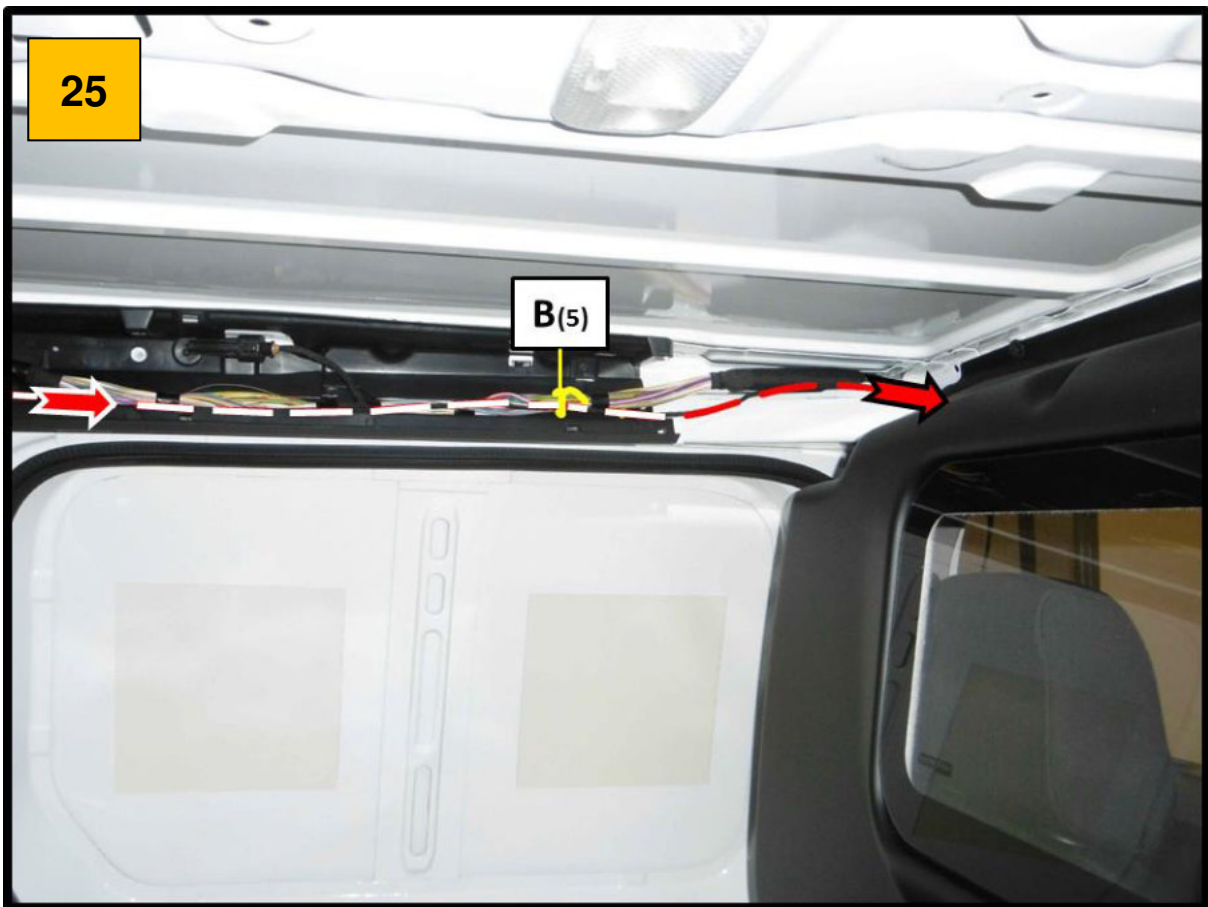
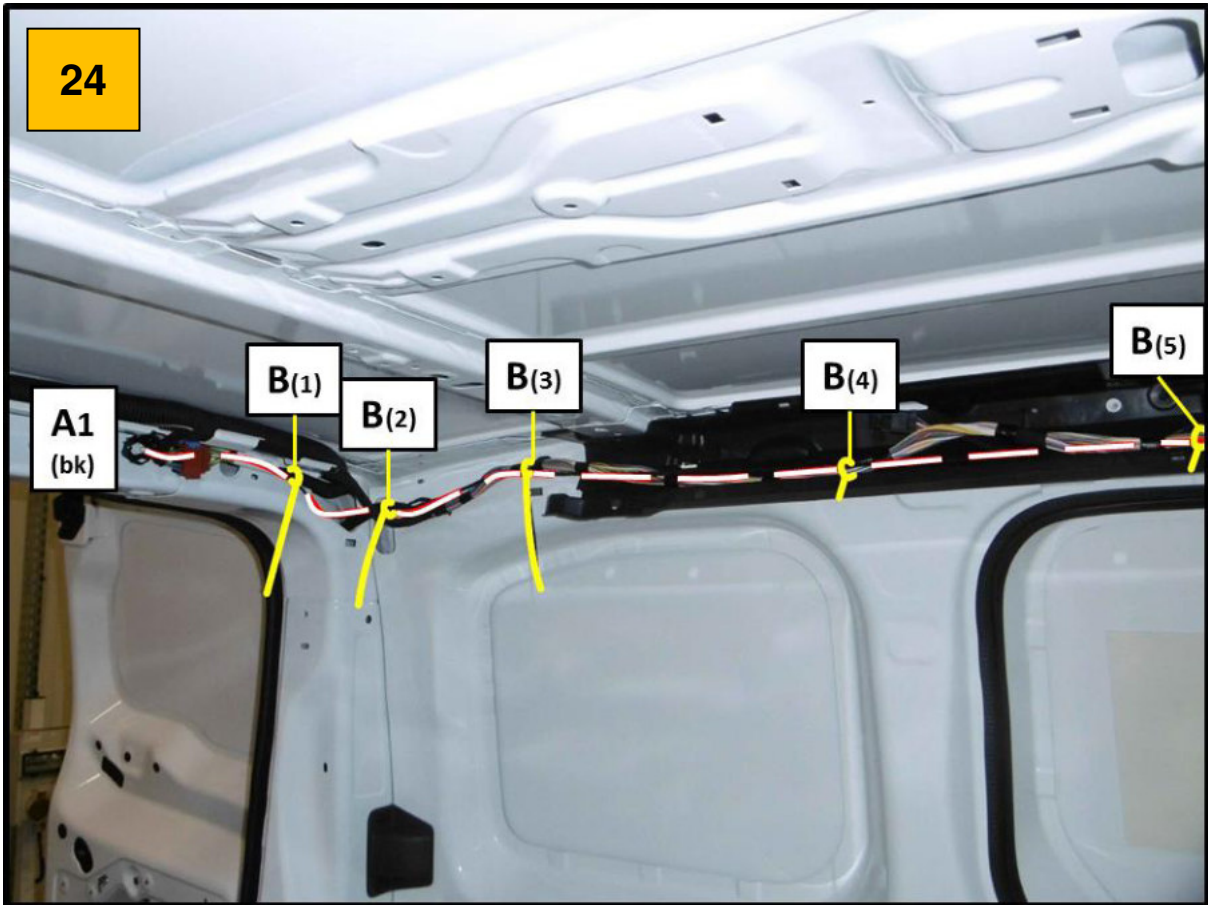



**26**

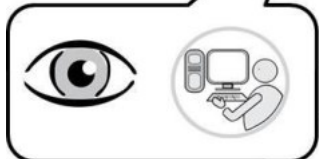
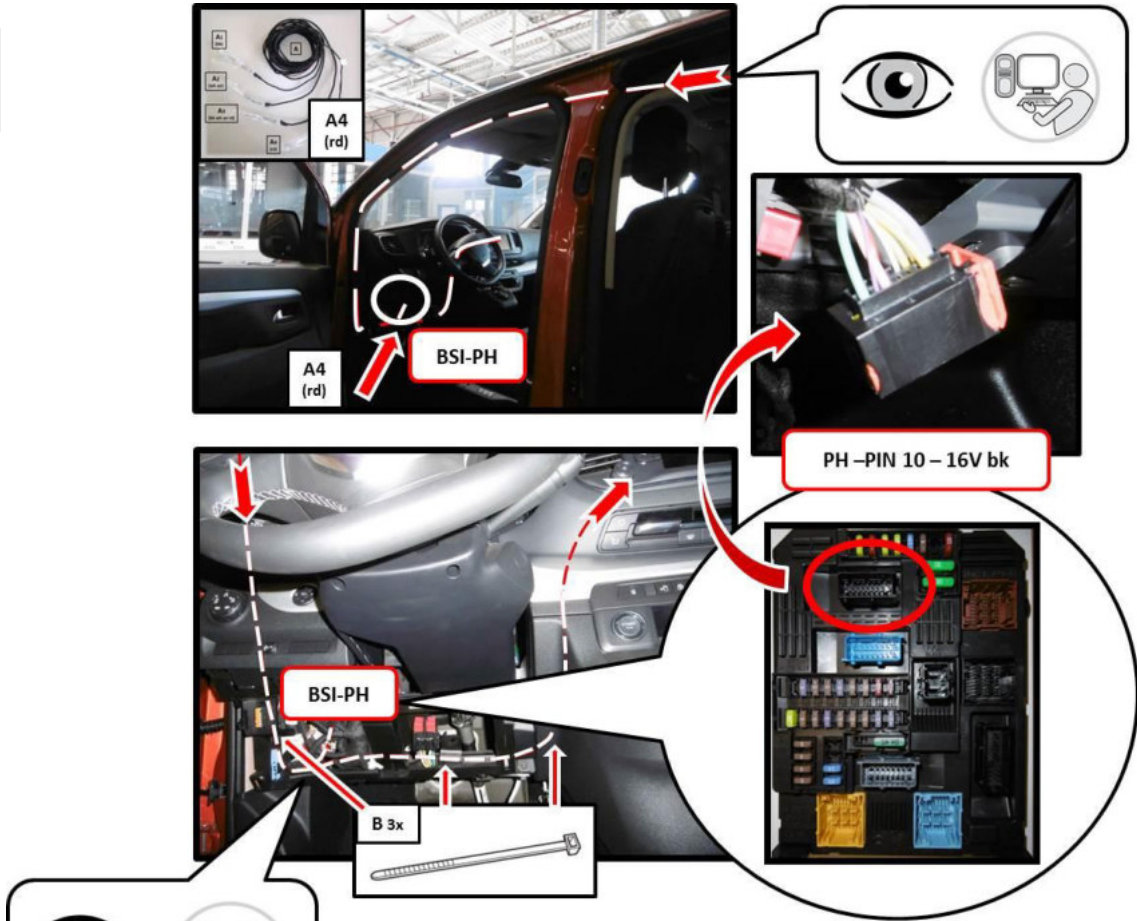

FROM	COLOR	TO	PIN
A4	rd	16V bk	10

**26-1**

**Option 1: PIN 10 16V bk free**

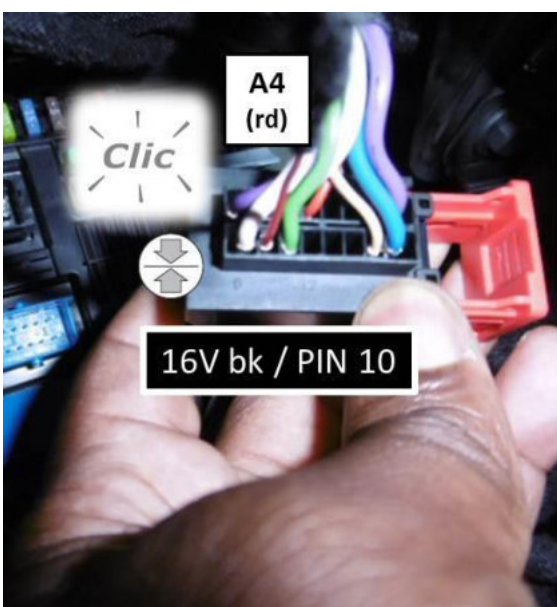

**26-2**

**Option 2: PIN 10 16V bk populated**

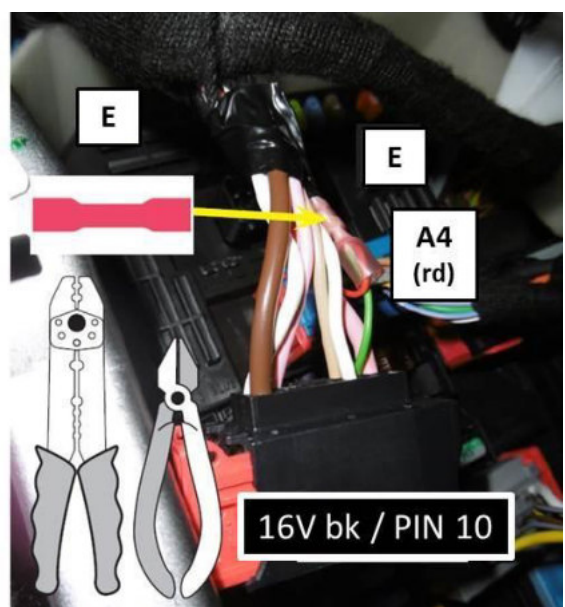



PH -PIN 10 - 16V bk

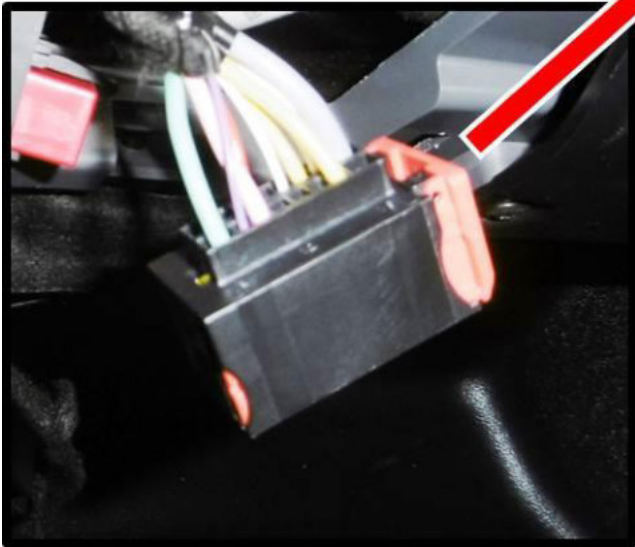

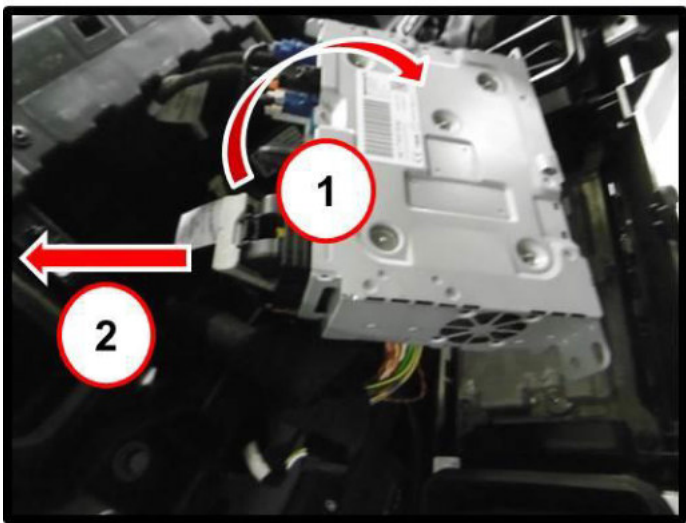
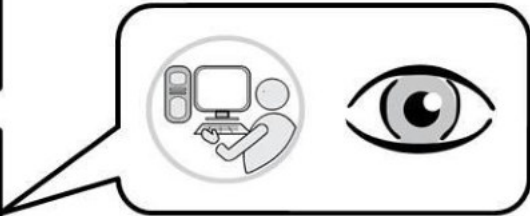
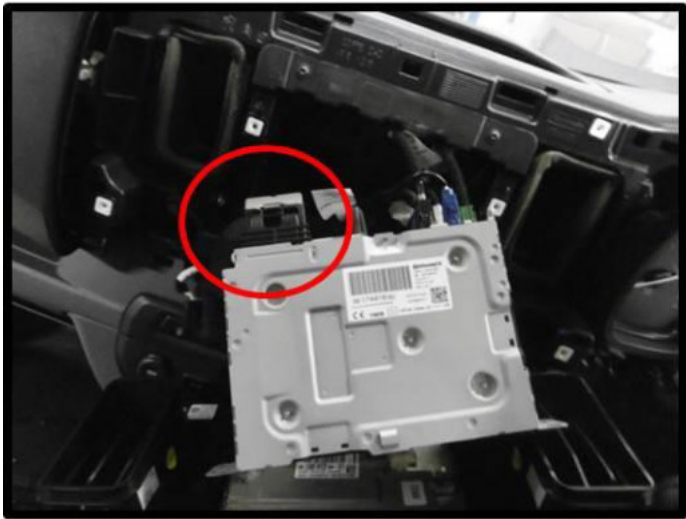
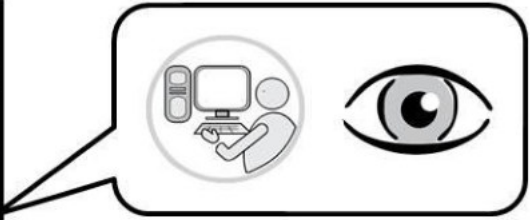
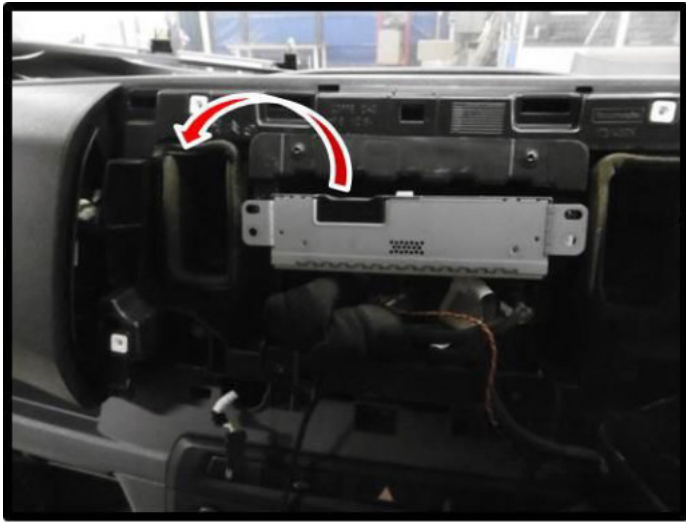

29

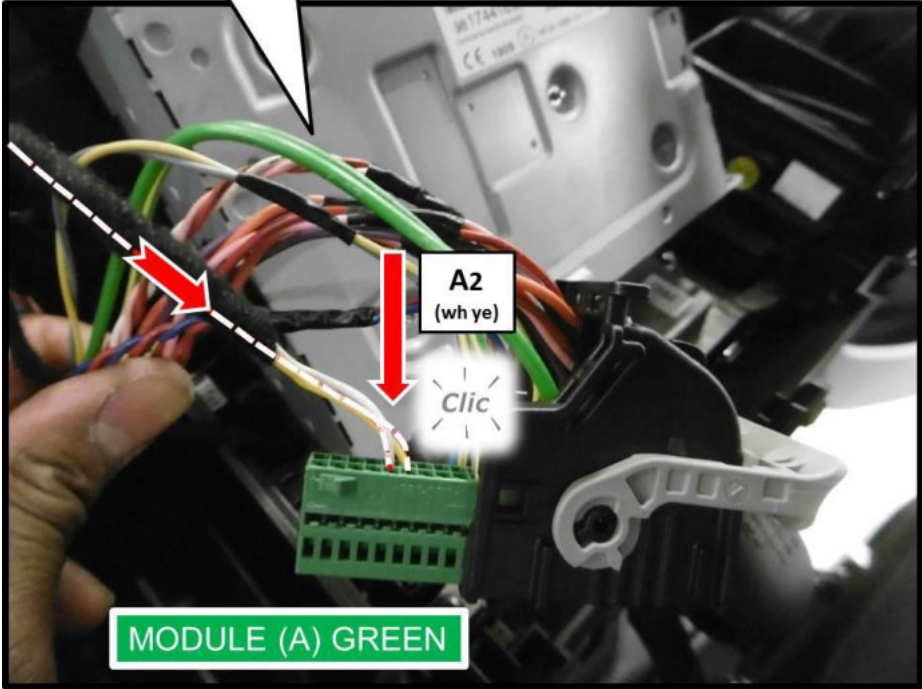
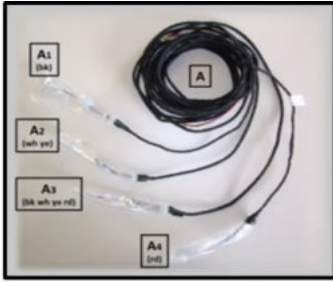
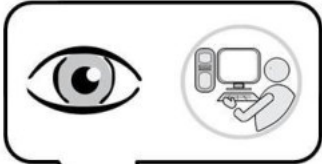

FROM	COLOR	TO	PIN
A2	wh	Module (A) gn	16
A2	ye	Module (A) gn	17

29-1

Option 1: PIN 16+17 20V gn free

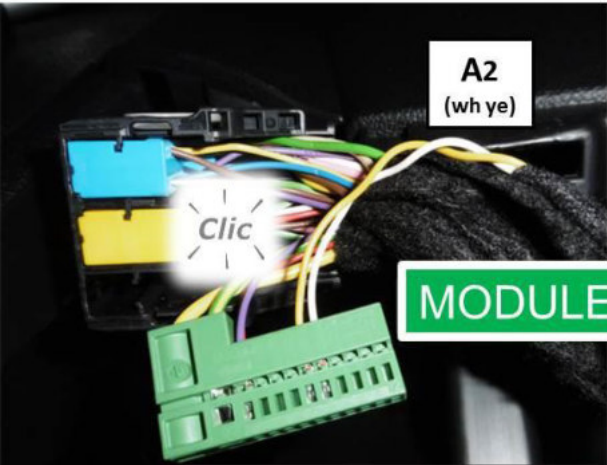

29-2

Option 2: PIN 16+17 20V gn populated

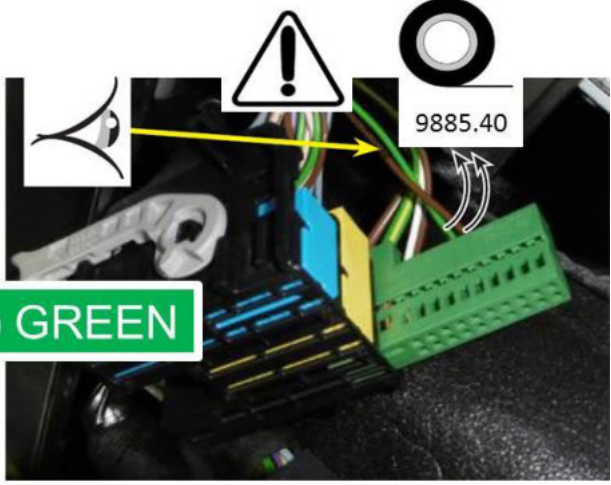

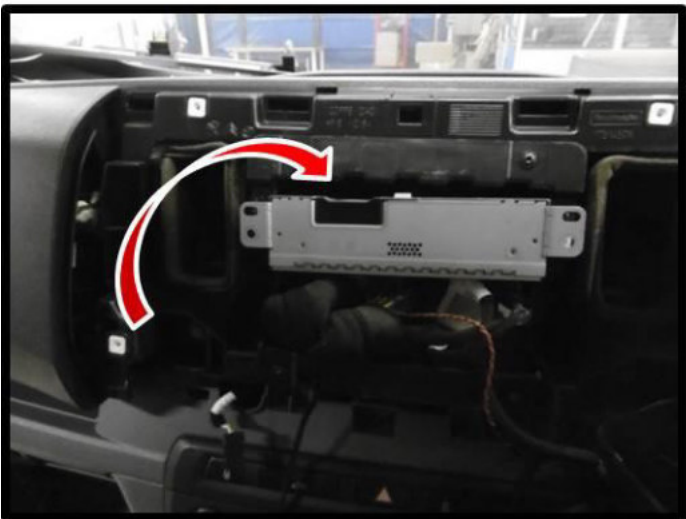
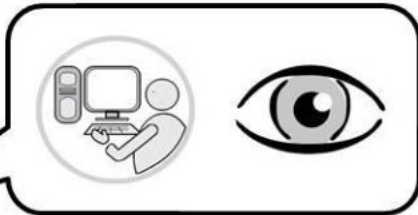
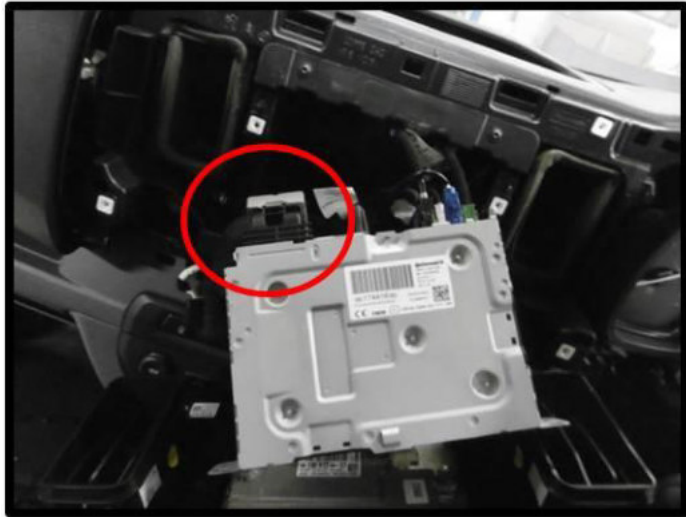
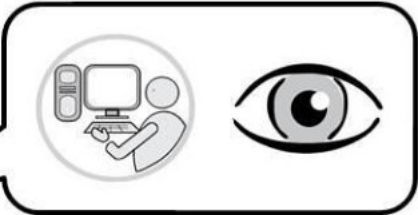
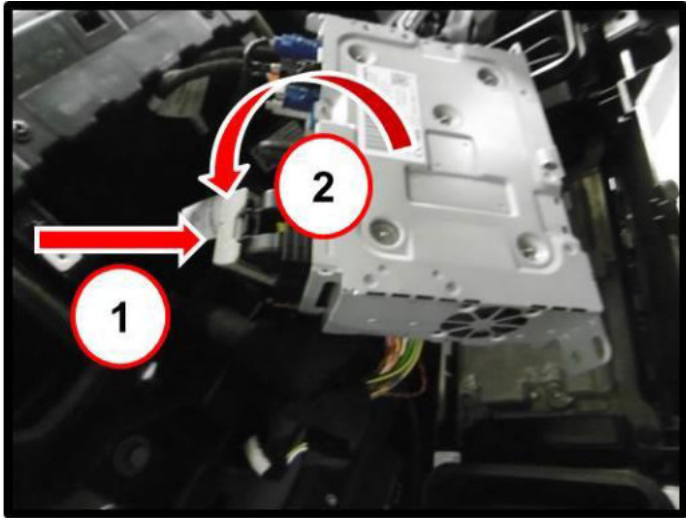

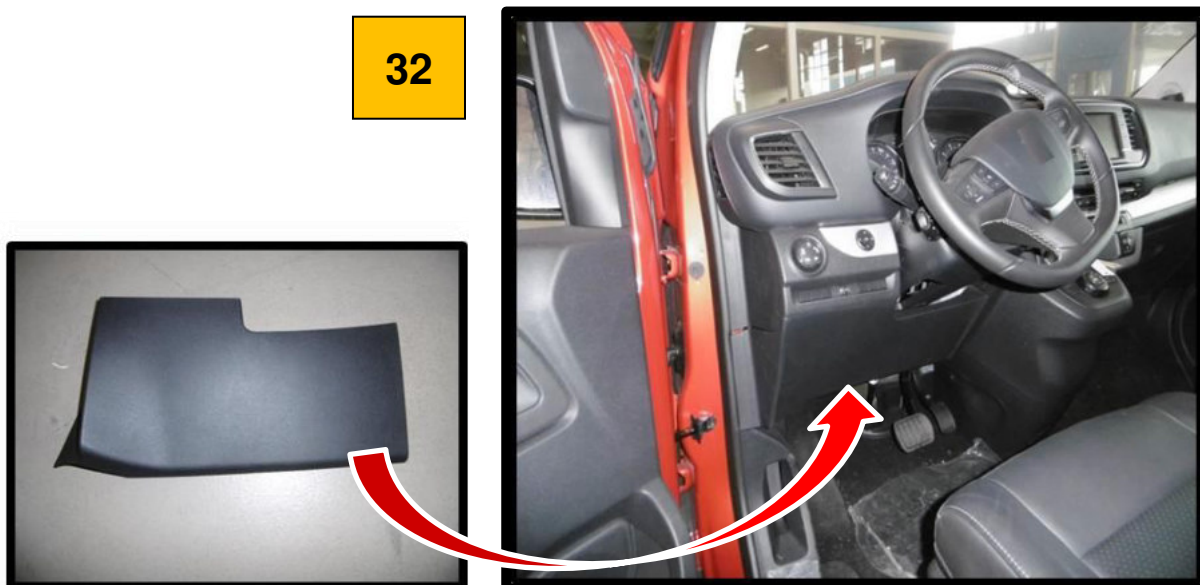



37



38

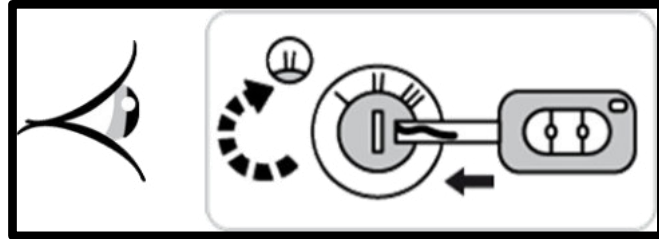

39





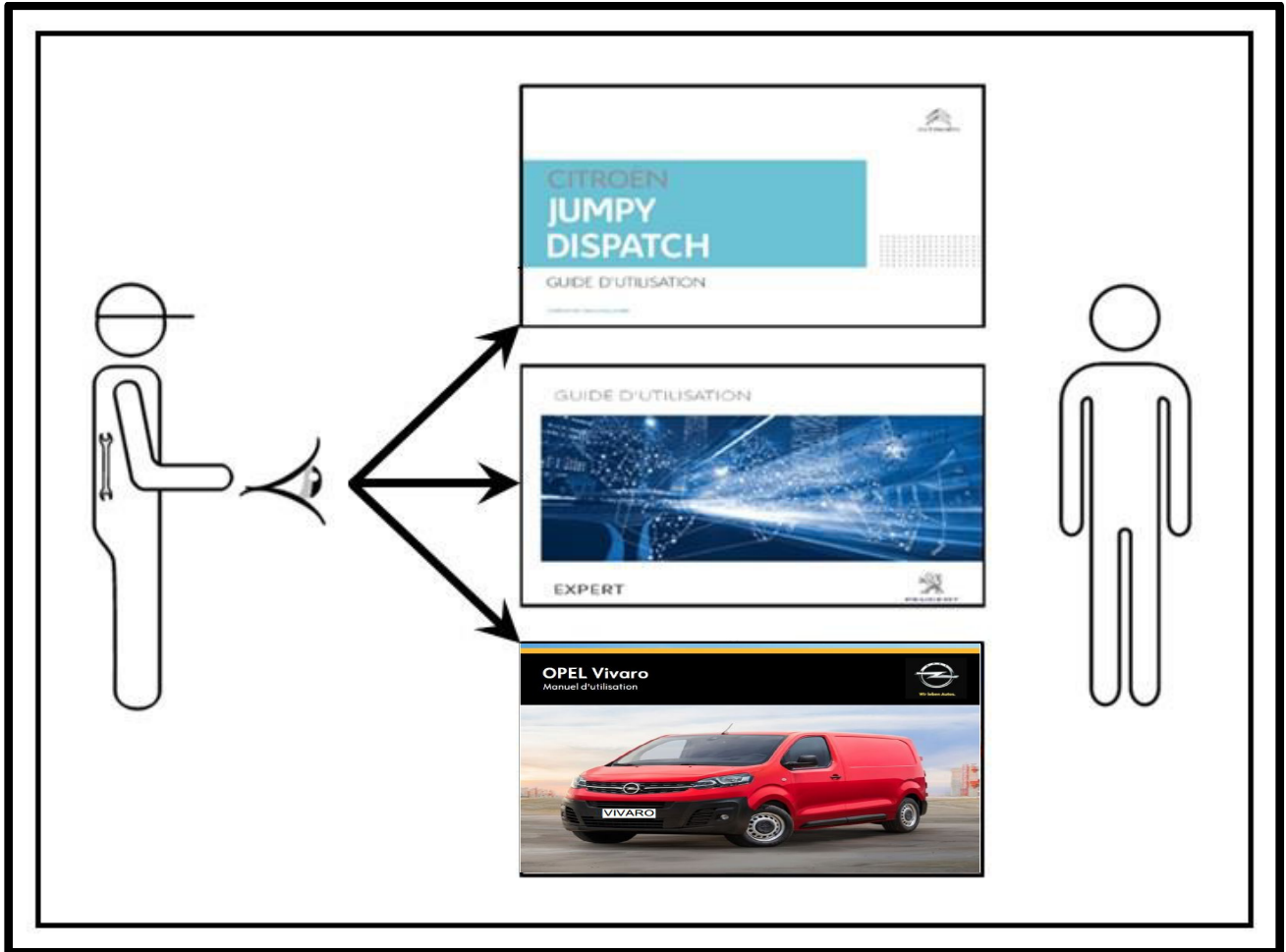



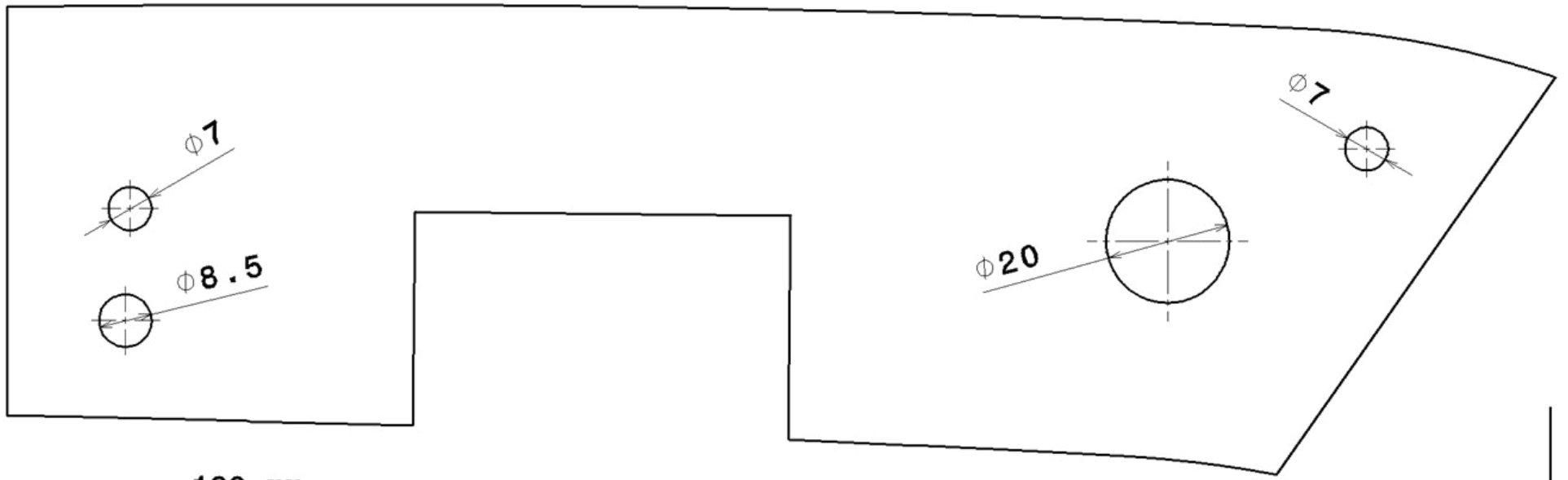

100 mm

Vue de face  
Echelle : 1:1

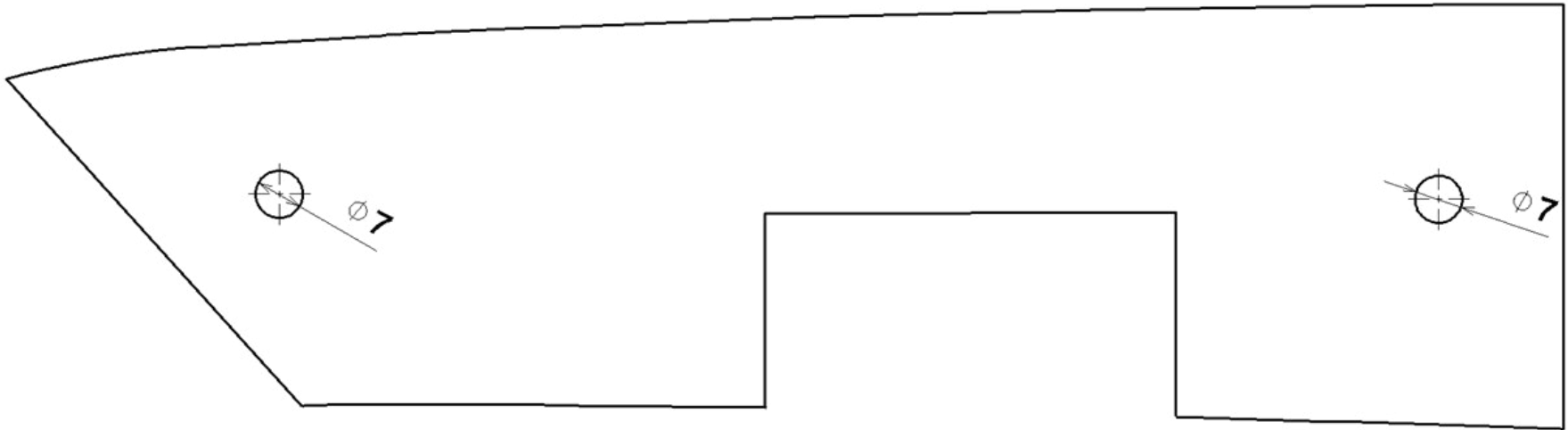

100 mm