

OMRON

Wrist Blood Pressure Monitor

Model HEM-6200
Instruction Manual

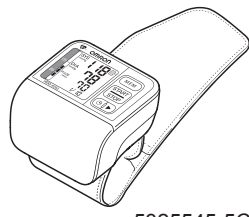

5325545-5C

Introduction

Thank you for purchasing the OMRON HEM-6200 Wrist Blood Pressure Monitor.

The OMRON HEM-6200 is a compact and easy to use blood pressure monitor, operating on the oscillometric principle. It measures your blood pressure and pulse rate simply and quickly. For comfortable controlled inflation without the need of pressure pre-setting or re-inflation the devices uses its advanced "IntelliSense" technology.

Please read this instruction manual thoroughly before using the unit. Please keep for future reference.

For specific information about your own blood pressure, CONSULT YOUR DOCTOR.

Important Safety Information

Consult your doctor prior to using in pregnancy or if diagnosed with arrhythmia or arteriosclerosis.

Please read this section carefully before using the unit.

Warning:

- Indicates a potentially hazardous situation which, if not avoided, could result in death or serious injury.

General Usage

- Always consult your doctor. Self-diagnosis of measurement results and self-treatment are dangerous.
- People with severe blood flow problems, or blood disorders, should consult a doctor before using the unit, as cuff inflation can cause internal bleeding.

Battery Usage

- If battery fluid should get in your eyes, immediately rinse with plenty of clean water. Consult a doctor immediately.

Caution:

- Indicates a potentially hazardous situation which, if not avoided, may result in minor or moderate injury to the user or patient or damage to the equipment or other property.

General Usage

- Do not leave the unit unattended with infants or persons who cannot express their consent.
- Do not use the unit for any purpose other than measuring blood pressure.
- Do not disassemble the unit or wrist cuff.
- Do not inflate the wrist cuff over 299 mmHg.
- Do not use a mobile phone or other devices that emit electromagnetic fields, near the unit. This may result in incorrect operation of the unit.
- Do not operate unit in a moving vehicle (car, airplane).

Battery Usage

- If battery fluid should get on your skin or clothing, immediately rinse with plenty of clean water.
- Use only two "AAA" alkaline (LR03) batteries with this unit. Do not use other types of batteries.
- Do not insert the batteries with their polarities incorrectly aligned.
- Replace old batteries with new ones immediately. Replace both batteries at the same time.
- Remove the batteries if the unit will not be used for three months or more.
- Do not use new and used batteries together.

General Precautions

- Do not apply strong shocks and vibrations to or drop the unit.
- Do not take measurements after bathing, drinking alcohol, smoking, exercising or eating.
- Do not inflate the wrist cuff when it is not wrapped around your wrist.
- Do not wash the wrist cuff or immerse it in water.
- Read and follow the "Important information regarding Electro Magnetic Compatibility (EMC)" in the Technical Data Section.
- Read and follow the "Correct Disposal of This Product" in the Technical Data Section when disposing of the device and any used accessories or optional parts.

1. Overview

Main unit:

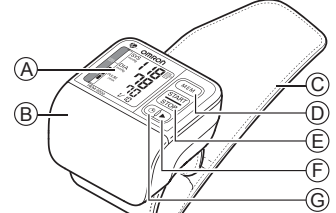

- A. Display
B. Battery compartment cover
C. Wrist cuff
D. MEM (Memory) button
- E. START/STOP button
F. SET (►) button
G. Date/Time setting (◂) button

Display:

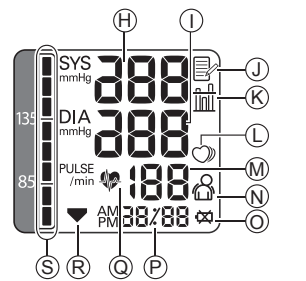

- H. Systolic blood pressure
I. Diastolic blood pressure
J. Memory symbol
K. Average value symbol
L. Irregular heartbeat symbol
M. Pulse display
N. Movement error symbol
- O. Battery low symbol
P. Date/Time display
Q. Heartbeat symbol (Flashes during measurement.)
R. Deflation symbol
S. Blood pressure level indicator

2. Preparation

2.1 Installing/Replacing the Batteries

- Remove the battery cover.
1) Push the hook on the bottom of the battery cover.
2) Pull the cover off the main unit.

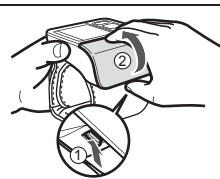

- Insert two 1.5V "AAA" alkaline (LR03) batteries as indicated in the battery compartment and then replace the battery cover.

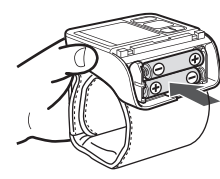

Notes:

- If the battery low symbol (O) appears on the display, turn the unit off then replace both batteries at the same time.
- The measurement values continue to be stored in memory even after the batteries are replaced.

Disposal of used batteries should be carried out in accordance with the national regulations for the disposal of batteries.

2.2 Setting the Date and Time

- Set the monitor to the correct date and time before taking a measurement for the first time. Press the (◂) button.



- Push the ► button to change.
• Hold down to advance the digit rapidly.

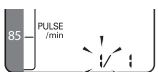

- Push the (◂) button to confirm. Next setting appears.

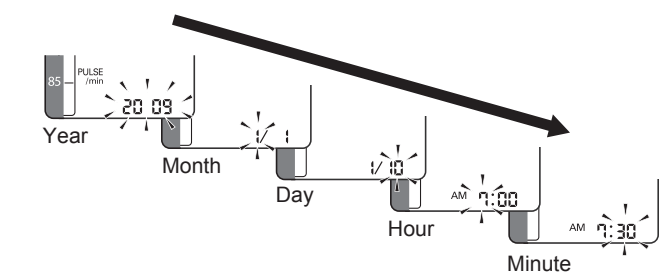

- Press the START/STOP button to store the setting.

Notes:

- To reset the date and time, hold down the (◂) button while the power is off.
- If the batteries have been removed for 30 seconds or more, the date and time setting will need to be reset.
- If the date and time are not set, "--:" appears during or after measurement.

3. Using the Unit

3.1 Applying the Wrist Cuff

Do not apply over clothing.

- Place the wrist cuff over your wrist.

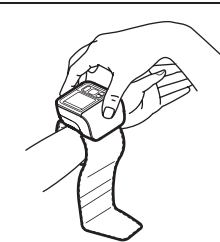

- Wrap the wrist cuff around your wrist.

Your thumb should face upward.



Make sure that the wrist cuff does not cover the protruding part of the wrist bone (ulna) on the outside of the wrist.

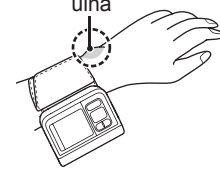

Notes:

- You can take a measurement on either your left or right wrist.

- Wrap the wrist cuff securely around the wrist for taking accurate measurements.

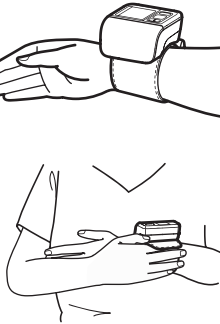

- The blood pressure can differ between the right arm and the left arm, and therefore also the measured blood pressure values can be different. Omron recommends to always use the same arm for measurement. If the values between the two arms differ substantially, please check with your doctor which arm to use for your measurement.

3.2 How to Sit Correctly

To take a measurement, you need to be relaxed and comfortably seated, under comfortable room temperature. No eating, smoking or exercising 30 minutes before taking a measurement.

- Sit on a chair with your feet flat on the floor.

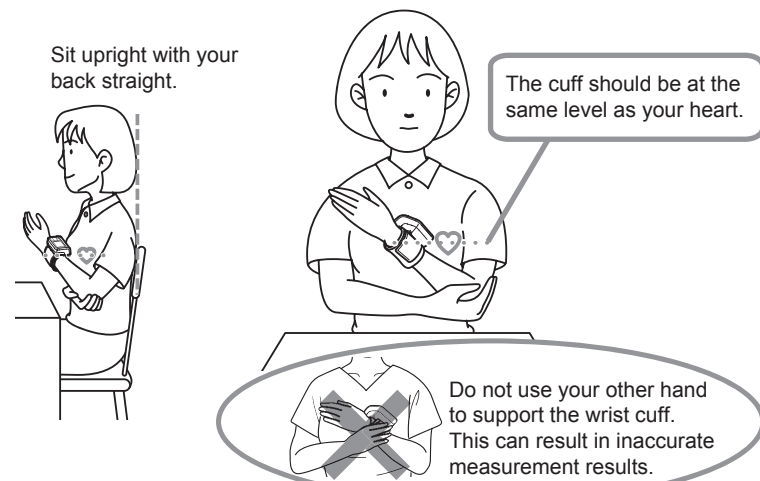

Relax your wrist and hand.

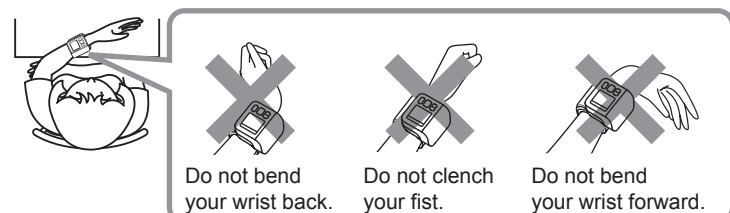

3.3 Taking a Reading

Notes:

- To cancel a measurement, press the START/STOP button at any time during measurement.
- Remain still while taking a measurement.

- Press the START/STOP button.

The wrist cuff will start to inflate automatically.

▼START ▼INFLATE ▼DEFLATE ▼COMPLETE

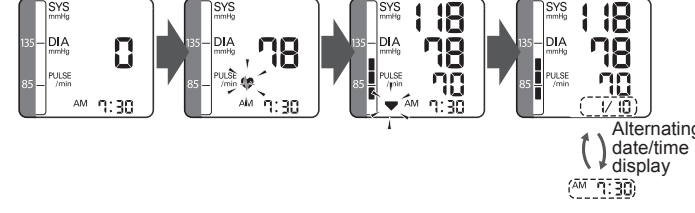

- Undo the wrist cuff and remove the unit.

- Press the START/STOP button to turn off the monitor. The monitor automatically stores the measurement in its memory. It will automatically turn off after two minutes.

Important:

- Recent research suggests that the following values can be used as a guide to high blood pressure for measurements taken at home.

Systolic Blood Pressure	Above 135 mmHg
Diastolic Blood Pressure	Above 85 mmHg

This criteria is for home blood pressure measurement.

- Your blood pressure monitor includes an irregular heartbeat feature. Irregular heartbeats can influence the results of the measurement. The irregular heartbeat algorithm automatically determines if the measurement is usable or needs to be repeated. If the measurement results are affected by irregular heartbeats but the result is valid, the result is shown together with the irregular heartbeat symbol (O). If the irregular heartbeats cause the measurement to be invalid, no result is shown. If the irregular heartbeat symbol (O) is shown after you have taken a measurement, repeat the measurement. If the irregular heartbeat symbol (O) is shown frequently, please make your doctor aware of it.

3.4 Using the Memory Function

The monitor automatically stores the result up to 60 sets. It can also calculate an average reading based on the measurements from the last three readings taken within 10 minutes. If there are only two readings in memory for that period, the average will be based on two readings. If there is one reading in memory for that period, the average will be based on one reading.

Notes:

- If the memory is full, the monitor will delete the oldest readings.
- When viewing the reading taken without setting the date and time, "--:" is displayed instead of the date and time.

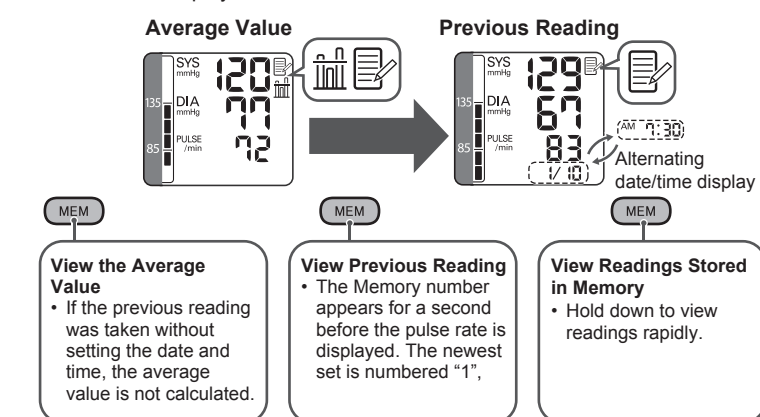

To delete all the values stored in memory

When the memory symbol (E) appears, first press the MEM button. Then while holding it down, press the START/STOP button simultaneously for about 2-3 seconds.

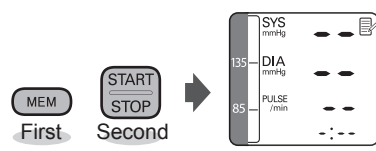

Note: You cannot partially delete the stored readings.

4. Troubleshooting and Maintenance

4.1 The Icons and Error Messages

Error Display	Cause	Remedy
	Irregular or weak pulses are detected.	Remove the wrist cuff. Wait 2-3 minutes and then take another measurement. Repeat the steps in section 3.3. If this error continues to appear, contact your doctor.
	Movement during measurement.	Carefully read and repeat the steps in section 3.3.
	The batteries are low.	You should replace them with new ones ahead of time. Refer to section 2.1.
	The batteries are exhausted.	You should replace them with new ones at once. Refer to section 2.1.
	Cuff is over inflated.	Carefully read and repeat the steps listed under section 3.3.
	Movement during measurement.	Carefully read and repeat the steps in section 3.3.
	An Er mark with a code/number indicates the device has a hardware failure.	Consult your OMRON retail outlet or distributor.

4.2 Troubleshooting

Problem	Cause	Remedy
The reading is extremely low (or high).	The wrist cuff is not at heart level.	Measure while in the correct posture. Refer to section 3.2.
	The cuff is wrapped snugly around the wrist.	Wrap the cuff correctly. Refer to section 3.1.
	Your arms and shoulders are tense.	Relax and try taking the measurement again. Refer to section 3.3.
Wrist cuff pressure does not rise.	Movement or talking during measurement.	Remain still and do not talk during measurement. Refer to section 3.3.
	Air is leaking from the wrist cuff.	Consult your OMRON retail outlet or distributor.
Wrist cuff deflates too soon.	The wrist cuff is loose.	Apply the cuff correctly so that it is securely wrapped around the wrist. Refer to section 3.1.
The blood pressure is different each time. The reading is extremely low (or high).		Blood pressure readings constantly vary with time of day and how relaxed you are. Take several deep breaths and try to remain relaxed before taking a measurement.
The unit loses power during measurement.	The batteries are drained.	Replace the batteries with new ones.
Nothing happens when you press the buttons.	The batteries are drained.	Replace the batteries with new ones.
	The batteries have been inserted incorrectly.	Insert the batteries with the correct (+/-) polarity.
Other problems.		<ul style="list-style-type: none"> Press the START/STOP button and repeat measurement. If the problem continues, try replacing the batteries with new ones. If this still does not solve the problem, contact your OMRON retail outlet or distributor.

4.3 Maintenance

To protect your unit from damage, please avoid the following:

- Subjecting your unit to extreme temperatures, humidity, or direct sunlight.
- Washing the cuff or exposing the cuff or unit to water.
- Disassembling the unit.
- Subjecting the unit to strong shocks or vibrations. Dropping the Unit.
- Cleaning the unit with volatile liquids. THE UNIT SHOULD BE CLEANED WITH A SOFT, DRY CLOTH.

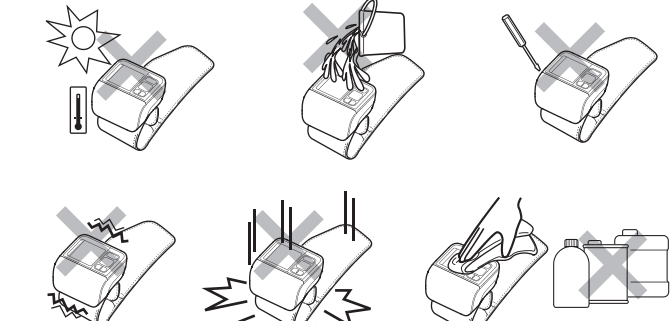

Use a soft, moistened cloth and soap to clean the cuff. Keep the unit in its storage case when not in use.

Fold the cuff into the storage case.

Do not store the unit in the following situations:

- If the unit is wet.
- Locations exposed to extreme temperatures, humidity, direct sunlight, dust or corrosive vapours.
- Locations exposed to vibrations, shocks or where it will be at risk of falling.

Calibration and Service

- The accuracy of this blood pressure monitor has been carefully tested and is designed for a long service life.
- It is generally recommended to have the unit inspected every two years to ensure correct functioning and accuracy. Please consult your local authorised OMRON distributor or dealer.

5. Technical Data

Product Description	Wrist Blood Pressure Monitor
Model	HEM-6200
Display	LCD Digital Display
Measurement Method	Oscillometric method
Measurement Range	Pressure: 0 mmHg to 299 mmHg Pulse: 40 to 180 beats/min. Pressure: ±3 mmHg Pulse: ±5% of reading
Accuracy	Automatic inflation by pump Automatic rapid deflation 60 Measurements
Inflation	2 "AAA" alkaline (LR03) batteries 1.5V
Deflation	Approx. 300 measurements with new alkaline batteries at a room temperature of 23°C
Memory	
Power Source	
Battery Life	
Applied Part	⬆ = Type B
Protection Against Electric Shock	Internally powered ME equipment
Operating temperature/ Humidity	+10°C to +40°C / Maximum: 30 to 85% RH
Storage temperature/ Humidity/ Air pressure	-20°C to +60°C / Maximum: 10 to 95% RH / 700-1060 hPa
Console Weight	Approximately 117g without batteries
Outer Dimensions	Approximately 71 (w) mm × 41 (h) mm × 70 (d) mm without the wrist cuff
Measurable circumference of wrist	Approximately 13.5 to 21.5 cm
Cuff Material	Nylon and polyester
Package Content	Main unit, storage case, two "AAA" alkaline (LR03) batteries, instruction manual

Notes:

- Subject to technical modification without prior notice.
- Disposal of this product and used batteries should be carried out in accordance with the national regulations for the disposal of electronic products.

Please read this instruction manual carefully before using the device.

CE 0197

- This device fulfils the provisions of EC directive 93/42/EEC (Medical Device Directive).
- This blood pressure monitor is designed according to the European Standard EN1060, Noninvasive sphygmomanometers Part 1: General Requirements and Part 3: Supplementary requirements for electromechanical blood pressure measuring systems.

Important information regarding Electro Magnetic Compatibility (EMC)

With the increased number of electronic devices such as PC's and mobile (cellular) telephones, medical devices in use may be susceptible to electromagnetic interference from other devices. Electromagnetic interference may result in incorrect operation of the medical device and create a potentially unsafe situation. Medical devices should also not interfere with other devices.

In order to regulate the requirements for EMC (Electro Magnetic Compatibility) with the aim to prevent unsafe product situations, the EN60601-1-2:2007 standard has been implemented. This standard defines the levels of immunity to electromagnetic interferences as well as maximum levels of electromagnetic emissions for medical devices.

This medical device manufactured by OMRON HEALTHCARE conforms to this EN60601-1-2:2007 standard for both immunity and emissions.

Nevertheless, special precautions need to be observed:

- Do not use mobile (cellular) telephones and other devices, which generate strong electrical or electromagnetic fields, near the medical device. This may result in incorrect operation of the unit and create a potentially unsafe situation. Recommendation is to keep a minimum distance of 7 m. Verify correct operation of the device in case the distance is shorter.

Further documentation in accordance with EN60601-1-2:2007 is available at OMRON HEALTHCARE EUROPE at the address mentioned in this instruction manual. Documentation is also available at www.omron-healthcare.com.

Correct Disposal of This Product (Waste Electrical & Electronic Equipment)

This marking shown on the product or its literature, indicates that it should not be disposed of, with other household wastes at the end of its working life. To prevent possible harm to the environment or human health from uncontrolled waste disposal, please separate this from other types of wastes and recycle it responsibly to promote the sustainable reuse of material resources.

Household users should contact either the retailer where they purchased this product, or their local government office, for details of where and how they can take this item for environmentally safe recycling. Business users should contact their supplier and check the terms and conditions of the purchase contract. This product should not be mixed with other commercial wastes for disposal.

This product does not contain any hazardous substances.



 EC REP	OMRON HEALTHCARE Co., Ltd. 53, Kunotsubo, Terado-cho, Muko, Kyoto 617-0002 JAPAN
	OMRON HEALTHCARE EUROPE B.V. Scorplus 33, 2132 LR Hoofddorp THE NETHERLANDS
Asia Pacific HQ	OMRON HEALTHCARE SINGAPORE PTE LTD. 438A Alexandra Road, #05-05/08 Alexandra Technopark, Singapore 119967 www.omron-healthcare.com.sg



手腕式血压计

型号 HEM-6200
使用说明书

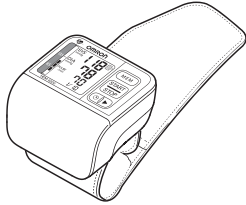

简介

感谢您购买 OMRON HEM-6200 手腕式血压计。

OMRON HEM-6200 是一款小巧精致和易于使用的血压计，根据示波法原理操作。可方便快捷地测量您的血压和脉搏速率。本设备利用先进的“IntelliSense”技术，既可舒适控制充气，而又免于预设压力或重新充气。

使用本血压计前请先通读本说明书。
请妥善保管本说明书以备将来参考。
有关您自身血压的具体详情，请咨询医生。

重要安全注意事项

孕妇或经诊断为心律不齐或动脉硬化的患者，请在使用本产品前咨询医生。
使用本产品之前请先细读本节内容。

△警告

•表示潜在的危险情形，如未避免此类情形，可能导致死亡或严重受伤。

(一般用途)

•始终咨询医生。依测量值自我诊断及自我治疗非常危险。
•血液流动存在严重问题或血液异常的患者在使用本机前应咨询医生，腕带充气时可能会导致内出血。

(使用电池)

•若电池溶液进入眼睛，请立刻用大量清水冲洗，并马上就诊。

△注意

•表示潜在的危险情形，如未避免此类情形，可能导致用户或患者轻微或中等程度的身体损伤，或损坏设备或其他财产。

(一般用途)

•本机不能用于婴儿或无法正确表达自己意愿的人士。
•请勿用于测量血压以外的任何目的。
•请勿拆卸血压计或腕带。
•请勿对腕带充气超过 299 mmHg。
•请勿在血压计附近使用手机或其他发射电磁场的装置。这可能导致血压计操作出错。
•请勿在行驶的交通工具（汽车、飞机）上使用血压计。

(使用电池)

•若电池溶液滴在皮肤或衣服上，请立刻用大量清水冲洗。
•本机只使用两节“AAA”碱性（LR03）电池。切勿使用其他类型电池。
•切勿将电池电极反接。
•及时用新的电池更换旧电池。同时将两节新电池全部装入。
•如果三个月或更长时间内不使用血压计，请取出电池。
•新旧电池不要混合使用。

一般安全注意事项

•请勿使血压计受到猛烈震动或晃动；不要摔扔血压计。
•请勿在沐浴、饮酒、吸烟、运动或进食后测量。
•腕带尚未缠绕于手腕上时，请勿给腕带充气。
•请勿洗涤腕带或将其浸入水中。
•请阅读并遵循技术数据章节“有关电磁兼容性(EMC)的重要信息”。
•弃置本装置以及任何旧配件或可选部件时，请参阅并遵循技术数据章节的“正确弃置本品”。

1. 概要

主机：

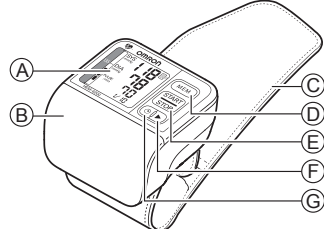

A. 显示屏
B. 电池仓盖
C. 腕带
D. MEM 记忆按钮
E. START/STOP 加压/停止按钮
F. 设定 (▶) 按钮
G. 日期/时间设定 (⊙) 按钮

显示屏：

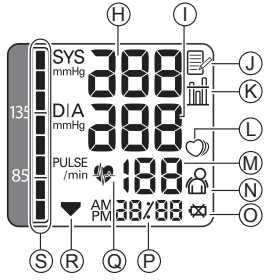

H. 收缩压
I. 舒张压
J. 记忆符号
K. 平均数值符号
L. 非正规心律符号
M. 脉搏显示
N. 移动错误符号
O. 电池电量不足符号
P. 日期/时间显示
Q. 心律符号
R. 测量时闪烁
S. 血压水平指示器

2. 准备

2.1 安装/更换电池

- 取出电池盖。
 - 按下电池盖底部的搭扣。
 - 将电池盖从主机中拉出。

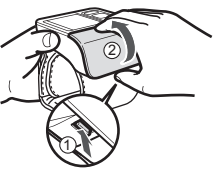

- 按指示在电池仓插入两节 1.5V “AAA”碱性（LR03）电池，然后重新装上电池盖。

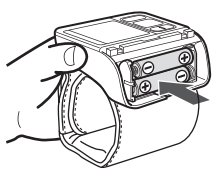

注意：

- 如果显示屏上出现电池电量不足符号 (⊖)，请关闭本装置并同时更换所有电池。
- 更换电池后，测量值仍会存储在记忆中。

旧电池的弃置应遵循有关弃置电池的国内规定。

2.2 设定日期及时间

- 第一次测量前，请将血压计设定到正确的日期及时间。按 ⊙ 按钮。



- 推 ▶ 按钮改变。
 - 按住可快速递增数字。

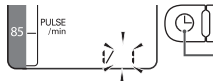

- 推 ⊙ 按钮确定。显示下一个设定。

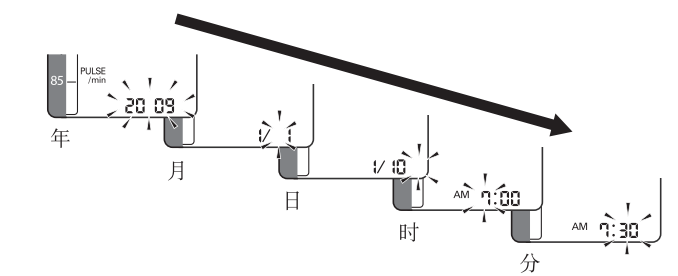

- 按下 START/STOP “加压 / 停止”按钮储存设定。

注意：

- 若要重置日期和时间，请在关闭电源时按住 ⊙ 按钮。
- 如果电池取出超过 30 秒，则需重新设定日期和时间。
- 如未设定日期和时间，测量过程中或测量后会出现 “-:-”。

3. 使用本机

3.1 缠绕腕带

不要缠绕在衣服上。

- 将腕带放在手腕上。

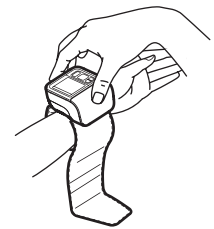

- 将腕带缠绕于手腕上。拇指朝上。



不要将腕带缠绕于手腕外侧腕骨的凸起部位（尺骨）。

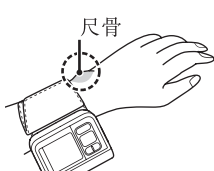

注意：

- 左右手腕上均可测量。

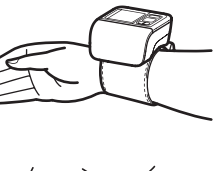

- 将腕带牢固缠绕在手腕上，以便执行精确测量。



- 左右手臂上均可测量。右臂和左臂上的血压可能各不相同，因此测得的血压值可能也有所差异。Omron 建议在测量时始终测量同一手臂。如果两臂的测量值存在明显的差异，请咨询医生应使用哪个手臂进行测量。

3.2 如何保持坐姿正确

测量时，您需要舒服的室温环境下放松并舒适坐着。测量前 30 分钟内，不得饮食、吸烟或运动。

- 坐在椅子上，双脚平放于地面。

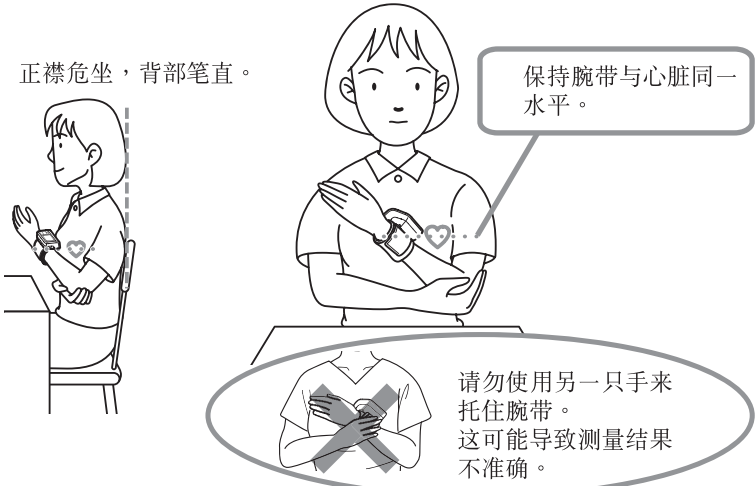

放松手腕及手。

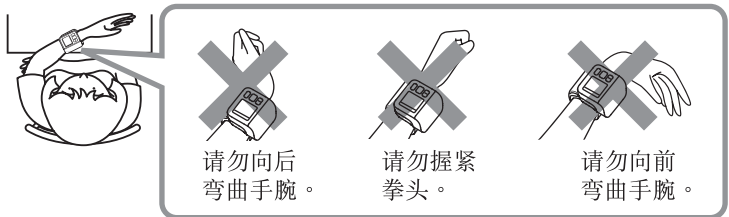

3.3 测量

注意：

- 要取消测量，在测量的任何时候按 START/STOP “加压 / 停止”按钮即可。
- 测量时保持静坐。

- 按 START/STOP “加压 / 停止”按钮。

腕带会自动开始充气。

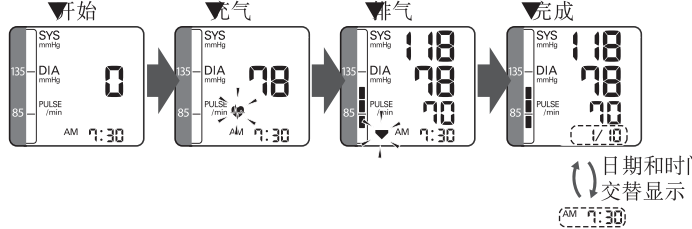

- 解开腕带，取下血压计。

- 按 START/STOP “加压 / 停止”按钮，关闭血压计。

血压计会自动将测量值储存在其记忆中。两分钟后，血压计会自动关闭。

重要事项：

- 最新研究表明以下数值可作为家庭测量时衡量高血压的指标。

收缩压	135 mmHg 以上
舒张压	85 mmHg 以上

此标准适用于家庭血压测量。

- 您的血压计可侦测非正规心律。非正规心律会影响测量结果。非正规心律算法可自动确定测量是否有效或需要重复测量。如果测量结果受非正规心律影响但仍然有效，此测数将伴随一个非正规心律符号 (⊖)。如果非正规心律导致测量无效，则不会显示结果。如果在进行测量后显示非正规心律符号 (⊖)，请重复测量过程。如果非正规心律符号 (⊖) 频繁显示，请告知医生。

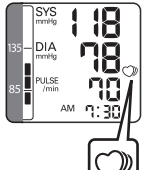
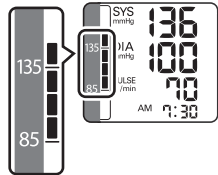

3.4 使用记忆读取功能

血压计最多可自动储存 60 组读数。它也可在 10 分钟内依据最后三次读数的测量结果计算平均读数。如果该时段的记忆中只有两个读数，则平均值将以这两个读数为基准。如果该时段的记忆中有一个读数，则平均值将以这个读数为基准。

注意：

- 如果记忆已满，血压计会删除最早的读数。
- 查看在未设置日期和时间情况下测量的读数，会显示 “-:-”，而不是日期和时间。

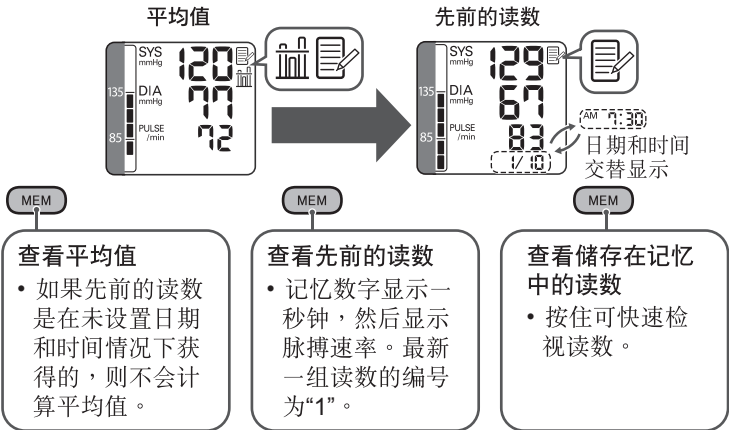

删除全部记忆值

出现记忆符号 (⊖) 时，首先按 MEM “记忆”按钮。然后在按住的同时，按 START/STOP “加压 / 停止”按钮大约 2-3 秒钟。

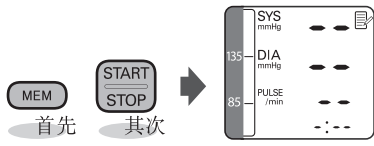

注意：您不能删除储存的部分读数。

4. 疑难排解与保养

4.1 标志与错误消息

错误符号	原因	更正
⊖	侦测到不规则心跳或弱脉。	取下腕带。等待 2 - 3 分钟后进行下一次测量。重复第 3.3 节中的步骤。如果错误持续出现，请联系您的医生。
⊖	测量过程中移动身体。	详读并重复第 3.3 节步骤。
⊖	电池电量低。	提前用新的电池更换全部旧电池。请参阅第 2.1 节。
⊖	电池电量耗尽。	用新的电池更换全部旧电池。请参阅第 2.1 节。
⊖	腕带过量充气。	详读并重复第 3.3 节步骤。
⊖	测量过程中移动身体。	详读并重复第 3.3 节步骤。
⊖	带代码 / 数字的 Er 标记表示装置出现硬件故障。	请联络 OMRON 零售店或分销商。

4.2 疑难排解

问题	原因	补救
读数过低（或过高）。	腕带没有与心脏位置齐平。 腕带紧贴手腕。 手臂和肩膀感到紧张。 测量过程中移动身体或说话。	测量时保持正确姿势。请参阅第 3.2 节。 正确缠绕腕带。请参阅第 3.1 节。 放松并再次测量。请参阅第 3.3 节。 测量期间，保持静坐并且不要说话。请参阅第 3.3 节。
腕带压力没有上升。	腕带漏气。	请联络 OMRON 零售店或分销商。
腕带排气太快。	腕带松弛。	正确缠绕腕带，确保腕带牢固地缠绕于手腕。请参阅第 3.1 节。
每次测量的血压值均不同。读数过低（或过高）。		血压读数因一天中的时刻和您的放松程度不断变化。在测量前深呼吸几次，尽量保持放松。
血压计在测量期间中断电源。	电池电量耗尽。 电池安装不正确。	用新的电池更换全部旧电池。 检查电池安装，(+/-) 电极是否放置正确。
按按钮时无任何反应。	电池电量耗尽。 电池安装不正确。	用新的电池更换全部旧电池。 检查电池安装，(+/-) 电极是否放置正确。
其他问题。		• 按 START/STOP “加压 / 停止”按钮，重复测量。 • 如果问题继续存在，尝试用新电池更换旧电池。 如果这依旧无法解决问题，请联络 OMRON 零售店或分销商。

4.3 保养

要保护血压计免遭损坏，请避免以下内容：

- 将主机置于高温、高湿、湿润或者阳光直射的环境中。
- 洗涤腕带或将其与主机浸入水中。
- 拆卸主机。
- 主机遭受撞击（例如，将主机跌落至地面）。
- 使用挥发性液体清洁主机。清洁血压计应使用柔软干燥的抹布。

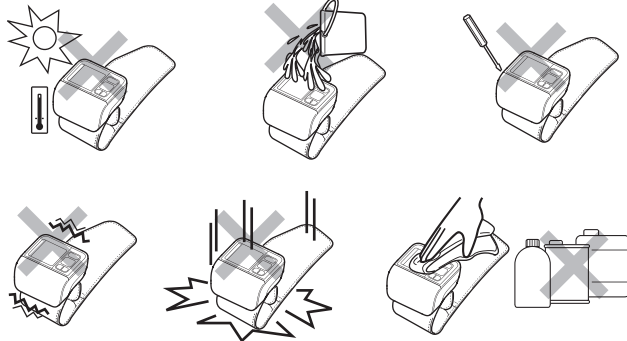

使用柔软的湿布和肥皂清洁腕带。血压计不使用时要放入储存盒中。折叠腕带，放入储存盒中。

请勿在以下情况储存血压计：

- 如果血压计潮湿。
- 高温、高湿、阳光直射、存在灰尘或腐蚀性气体的场所。
- 易晃动、震动或形成角度的位置。

校准与服务

- 本血压计的精度经过精心检测，且使用寿命长。
- 通常建议每隔两年对血压计进行检查，以确保其功能正常、准确无误。请联系您当地的 Omron 授权分销商或零售商。

5. 技术资料

产品名称	手腕式血压计
型号	HEM-6200
显示	LCD 数位显示屏
测量方式	动脉波动描记法
测量范围	血压：0 mmHg 至 299 mmHg 脉搏：40 至 180 拍/分钟
准确度	血压：±3 mmHg 脉搏：读数的 ±5%
充气	气囊自动充气
排气	自动快速排气
记忆	60 组测量值
电源	2 节“AAA”碱性（LR03）电池 1.5V
电池寿命	室温为 23°C 时，使用新的碱性电池可进行约 300 次测量
应用的部件	⊖ = B 型
电震保护	内部供电的 ME 设备
操作温度 / 湿度	+10°C 至 +40°C / 最高：30 至 85% RH
储存温度 / 湿度 / 空气压力	-20°C 至 +60°C / 最高：10 至 95% RH / 700-1060 hPa
主机重量	约 117 克（不包括电池）
外形尺寸	大约 71 mm（宽）x 41 mm（高）x 70 mm（长）（不包括腕带）
可测量手腕周长	大约 13.5 至 21.5 cm
腕带材料	尼龙和聚酯
附件	主机、储存盒、2 节“AAA”碱性（LR03）电池、使用说明书

注意：

- 技术资料如有更改，恕不提前通知。
- 本产品 and 旧电池的弃置应遵循国内对电子产品的弃置规定。

CE0197

使用本机前请先仔细阅读本使用说明书。

	OMRON HEALTHCARE Co., Ltd. 53, Kunotsubo, Terado-cho, Muko, Kyoto 617-0002 JAPAN
EC REP	OMRON HEALTHCARE EUROPE B.V. Scopius 33, 2132 LR Hoofddorp THE NETHERLANDS
Asia Pacific HQ	OMRON HEALTHCARE SINGAPORE PTE LTD. 438A Alexandra Road, #05-05/08 Alexandra Technopark, Singapore 119967 www.omron-healthcare.com.sg