

*GALLERYone DoubleTree extends exclusive  
Corporate Rates to clients of  
Vanguard Aesthetic Plastic Surgery*



*We would be delighted to have you stay with us during your recovery time!*

*2017 Rates: \$209 per night from 1/1-4/30, \$110 per night from 5/1-9/30,  
\$171 per night from 10/1-12/31 (rates available for city-view & water-view)*

*For reservations, please contact Monique Levers at [Monique.Levers@hilton.com](mailto:Monique.Levers@hilton.com) or 954-335-4614  
or Business Travel Sales Manager Lauren Gamber at 954-335-4628.*

*When making your reservations, please ask for the “Vanguard Corporate Rate.”*



GALLERYone  
HILTON  
A Hilton Hotel

The GALLERYone Business Travel Sales Manager Lauren Gamber / P: 954-335-4628 / [Lauren.Gamber@hilton.com](mailto:Lauren.Gamber@hilton.com)



**GALLERY**one  
FORT LAUDERDALE  
A DOUBLETREE SUITES BY HILTON

# A MASTERPIECE IN HOSPITALITY



## HOTEL AMENITIES

- 231 exquisitely designed one and two bedroom suites.
- Heated swimming pool and whirlpool overlooking the Intracoastal.
- Restaurant and Cocktail Bar offering indoor & outdoor dining.
- State-of-the-art fitness and cardiovascular center.
- Business Center with complimentary internet access.
- 100% non-smoking with designated smoking areas outdoors.
- Water Taxi stop at hotel dock offers guests the sights of Fort Lauderdale from the water.
- Next to the Galleria Mall with upscale shopping at Macy's, Neiman Marcus, Dillard's, Apple Store and more.
- Adjacent to Red Door Spa by Elizabeth Arden with full-service salon & spa treatments.
- Minutes from Riverwalk and Las Olas Boulevard with outdoor cafés, boutiques and art galleries.
- A short 5 minute walk to the beautiful Fort Lauderdale Beach.

GALLERYONE.DOUBLETREE.COM

TEL: +1-954-565-3800

FAX: +1-954-561-1413

2670 EAST SUNRISE BLVD.  
FT. LAUDERDALE, FL 33304

## GUEST SUITES

- Scenic views of the Intracoastal Waterway and Ft. Lauderdale skyline.
- Marble entry foyers.
- Euro Style kitchens featuring stainless steel appliances, granite countertops and marble floors.
- Exclusive DoubleTree Sweet Dreams® Sleep Experience Bedding.
- Elegant bathrooms featuring granite countertops, walk-in showers featuring rainfall showerheads and other luxurious amenities
- Eleven fully renovated one-bedroom Accessible Guest Suites featuring marble baths with roll-in/walk-in showers and grab bars, and audible & strobe fire/smoke alarms.
- Flat Screen Plasma TV's in both living room and bedroom.
- Wired and wireless high-speed Internet access.



## MEETING AND CONFERENCE FACILITIES

- 8,000 sq. ft. of versatile indoor space (public areas, conference, meeting and banquet rooms).
- Over 10,000 sq. ft. of flexible outdoor function space (public, pool and patio areas).
- 42" Plasma monitors, natural light and water views in break-out meeting rooms.
- Wi-Fi access available in all meeting rooms.

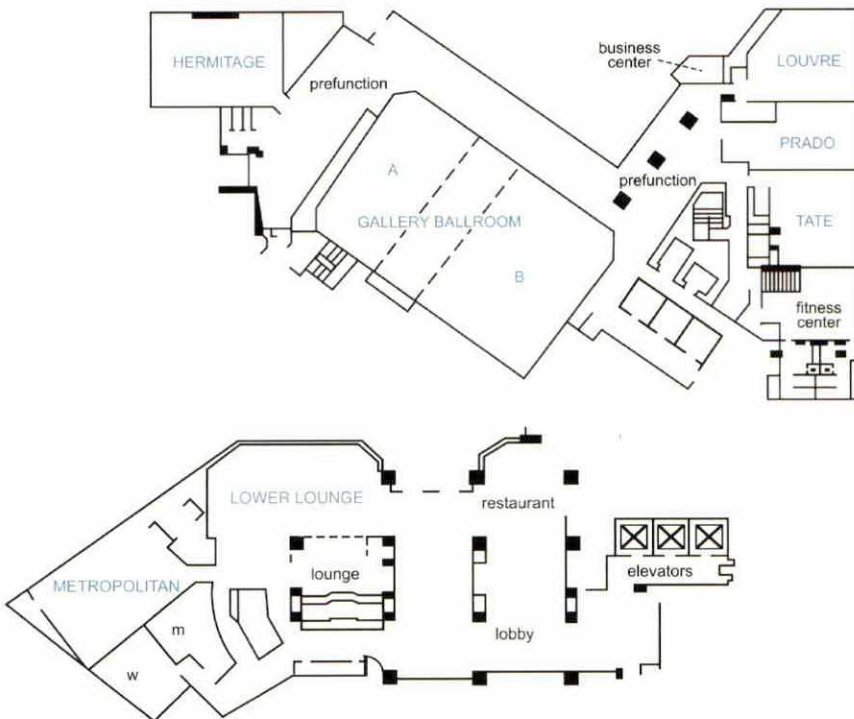

Name of Room	Square Ft.	Dimension	Ceiling Ht.	Banquet	Theater	Classroom	Reception
Gallery Ballroom	3,969	49' x 81'	9'8"	250	350	180	350
Gallery A	1,862	49' x 38'	9'8"	110	150	80	150
Gallery B	2,107	49' x 43'	9'8"	140	200	100	200
Hermitage	828	36' x 23'	9'10"	60	80	50	75
Louvre	616	28' x 22'	9'10"	40	50	25	50
Prado	456	24' x 19'	9'10"	30	40	25	40
Tate	475	25' x 19'	9'10"	30	40	25	40
Metropolitan	897	39' x 23'	12'	60	80	50	75

2670 EAST SUNRISE BOULEVARD ■ FT. LAUDERDALE, FL 33304  
 GALLERYONE.DOUBLETREE.COM  
 TEL: +1-954-565-3800 ■ FAX: +1-954-561-1413

