

ACT

ACT

Accelerating Change Together









Emissions By Sector

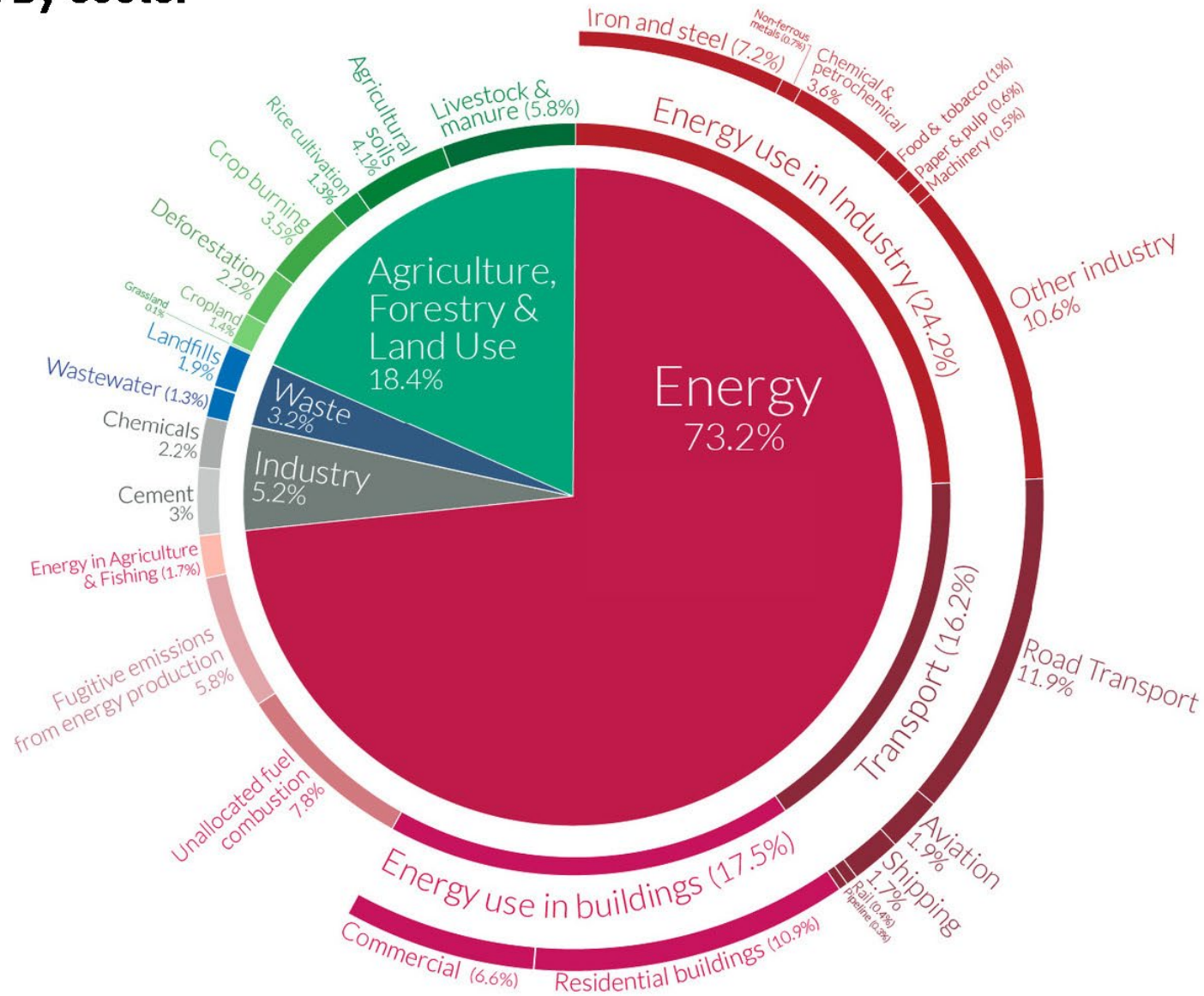

Emissions By Sector

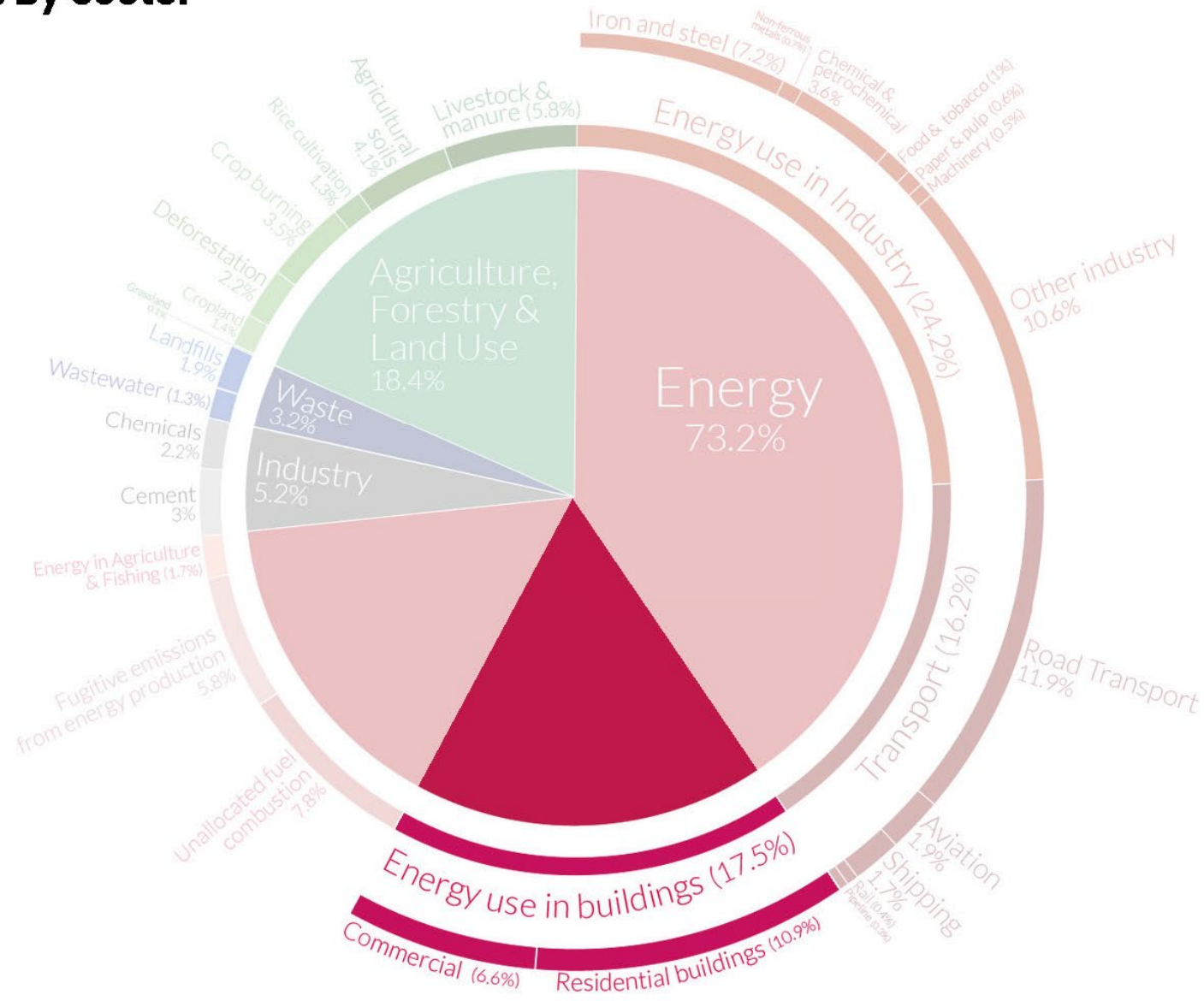

Emissions By Sector

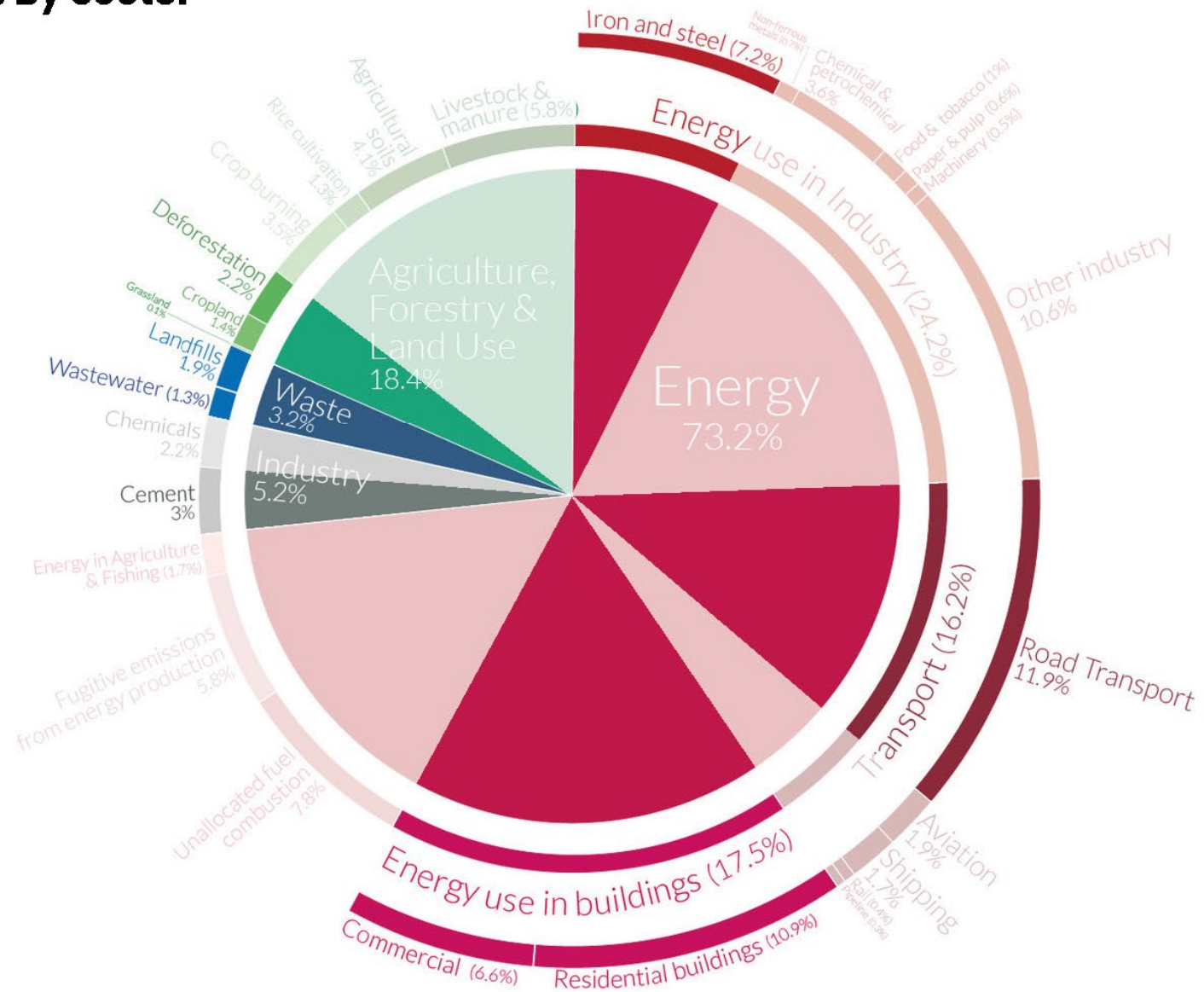

to accelerate the Green Transition

**to accelerate the Green Transition
to implement sustainable development**

to accelerate the Green Transition
to implement sustainable development
to inspire change

to accelerate the Green Transition
to implement sustainable development
to inspire change
to help realise a beautiful future

**buildings and
urban design**

**buildings and
urban design**

**visions and
strategies**

**buildings and
urban design**

**visions and
strategies**

**digital tools to
policy consultation**

local ←————→ **global**

**buildings and
urban design**

**visions and
strategies**

**digital tools to
policy consultation**

local ←————→ **global**

**buildings and
urban design**

**visions and
strategies**

**digital tools to
policy consultation**

Nature Based Solutions

ACT

Nature Based Solutions

Scotch House



Design Challenge

Why don't people live in rural town centres? Six towns were given €100k to see why - here's what they said

A pilot initiative from the government gave six rural towns €100,000 to develop proposals aimed at rejuvenating town centres.

Jun 28th 2020, 8:30 AM  87,642 Views  94 Comments

 Share 70  Tweet  Email 4

TO JUST ADDRESS the issue of vacant buildings in a town won't entice people to live back in town centres.

It needs a town to come up with a "master plan" and buy-in from potential investors and existing property owners, according to a new government report published this week.

The pilot Town Centre Living Initiative picked out towns in Ireland and, for the last two years,



The town of Banagher in Offaly was one of those chosen for the project

Image: Google Street View

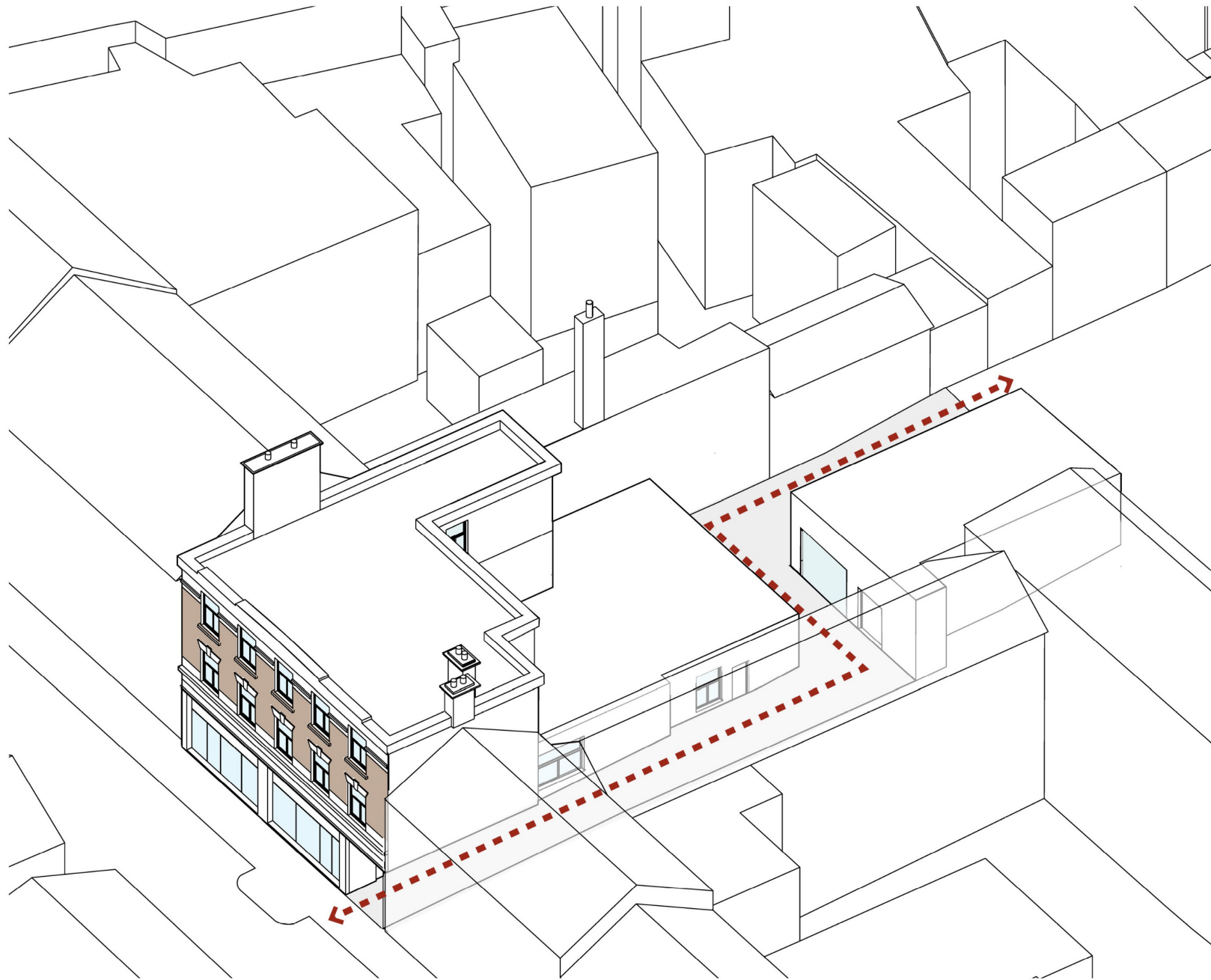

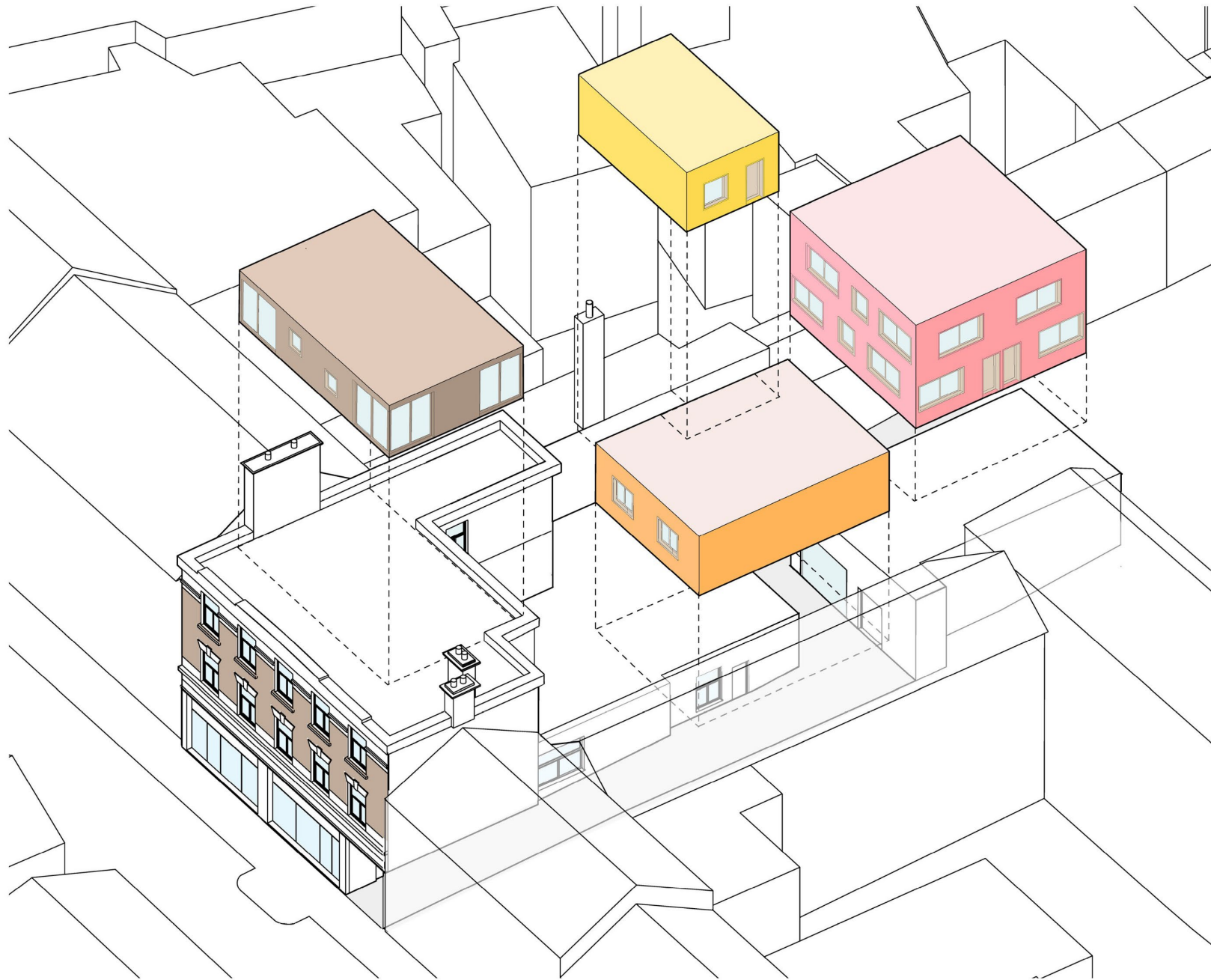

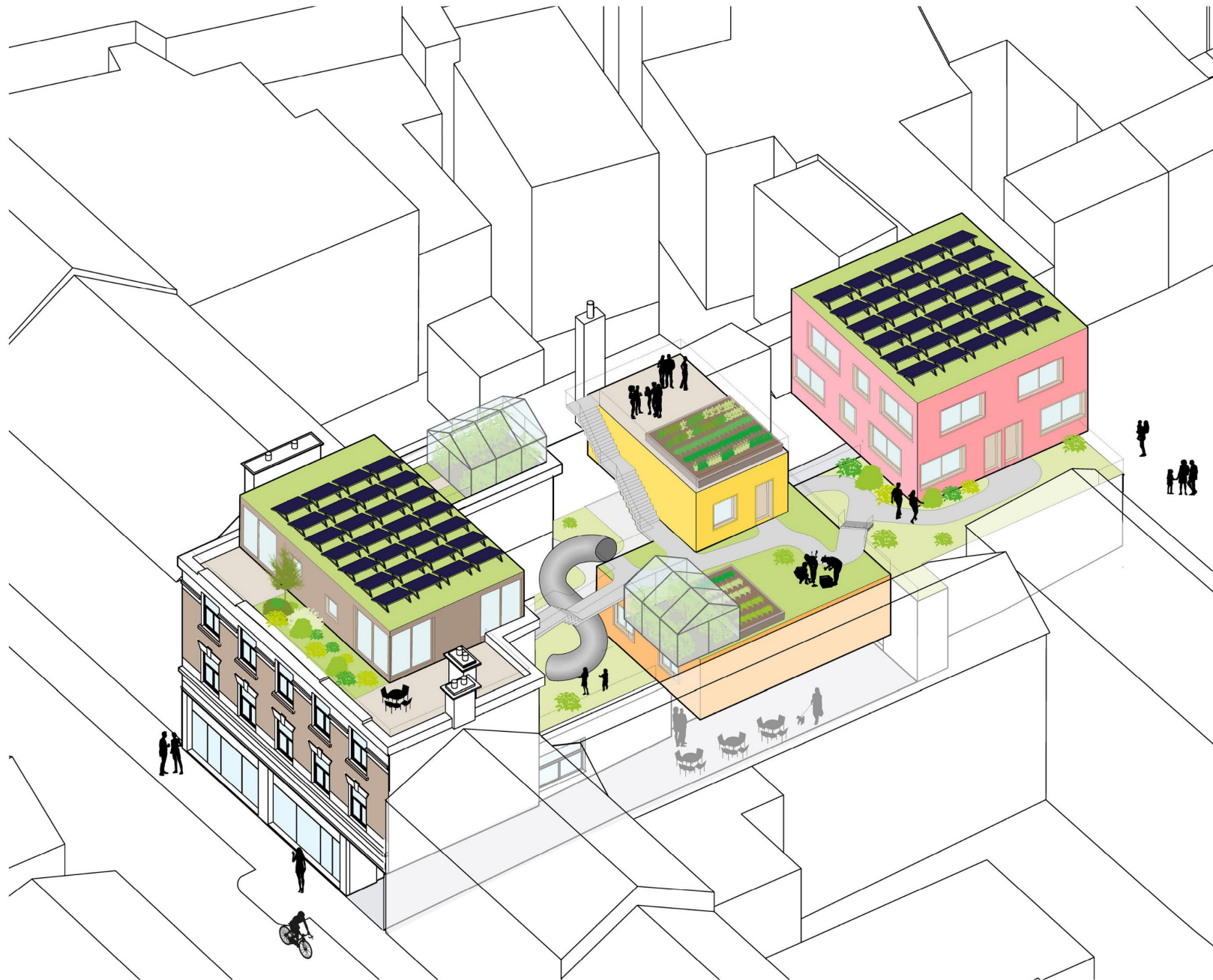







ACT

Nature Based Solutions

Sensory Park

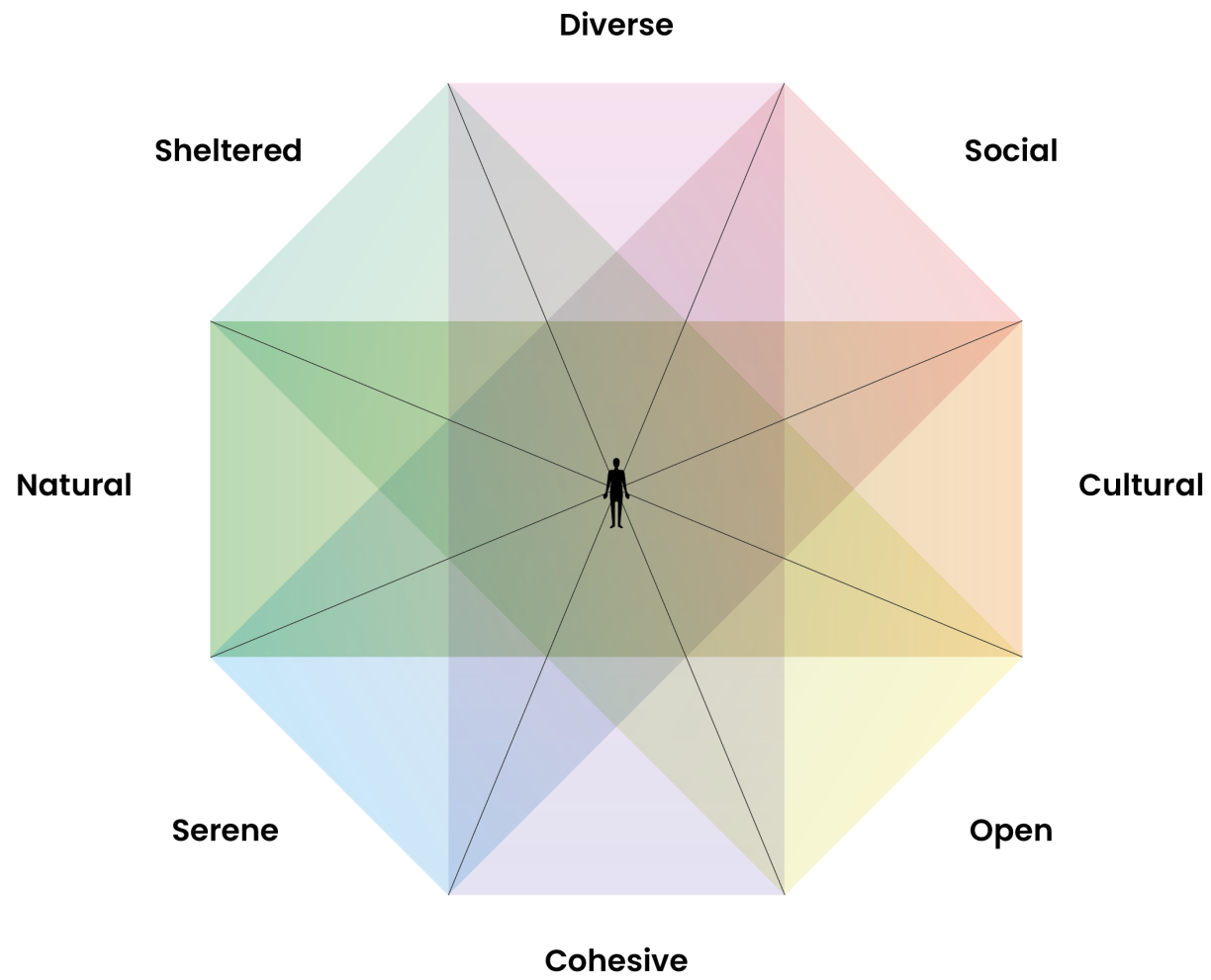

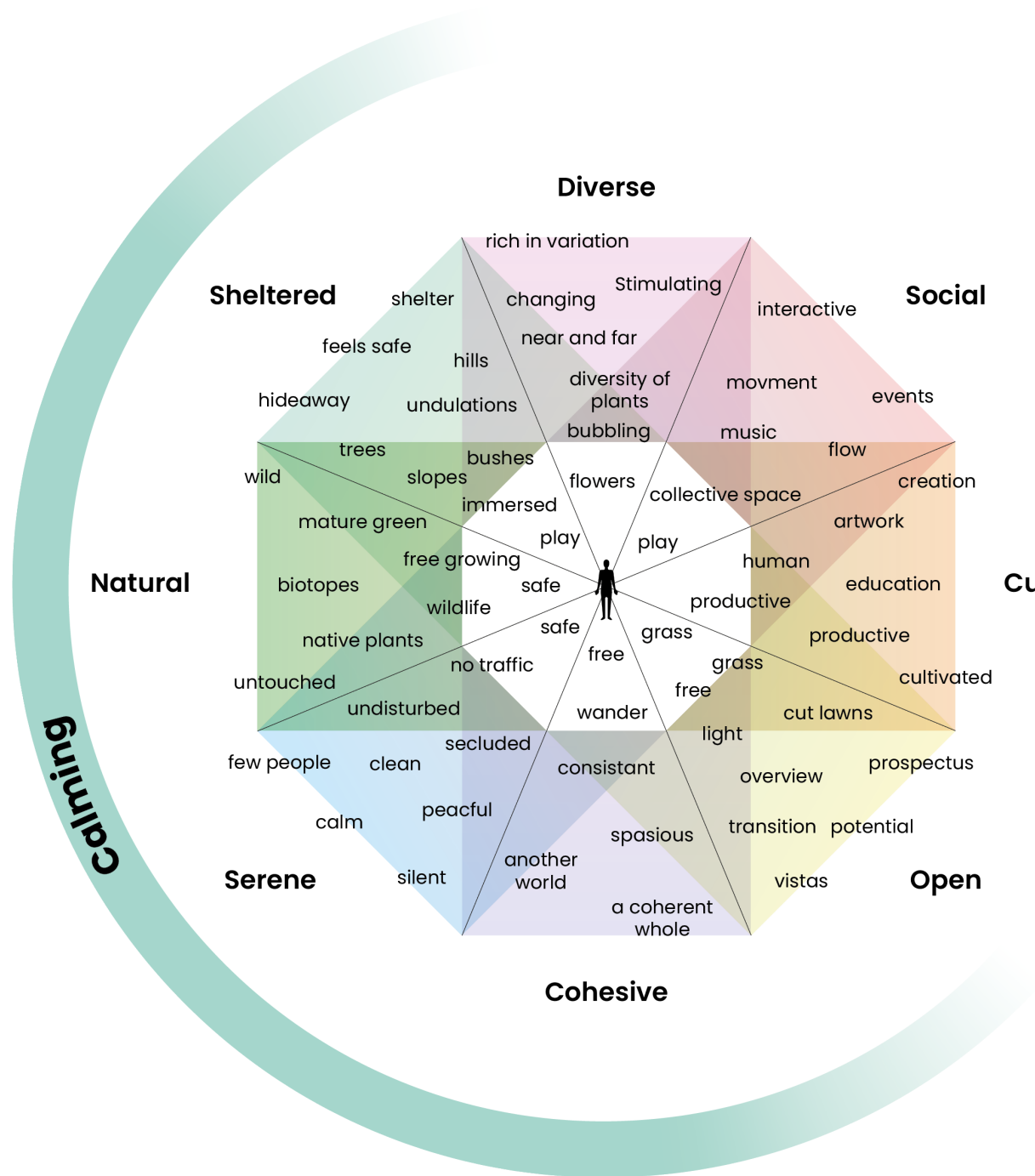

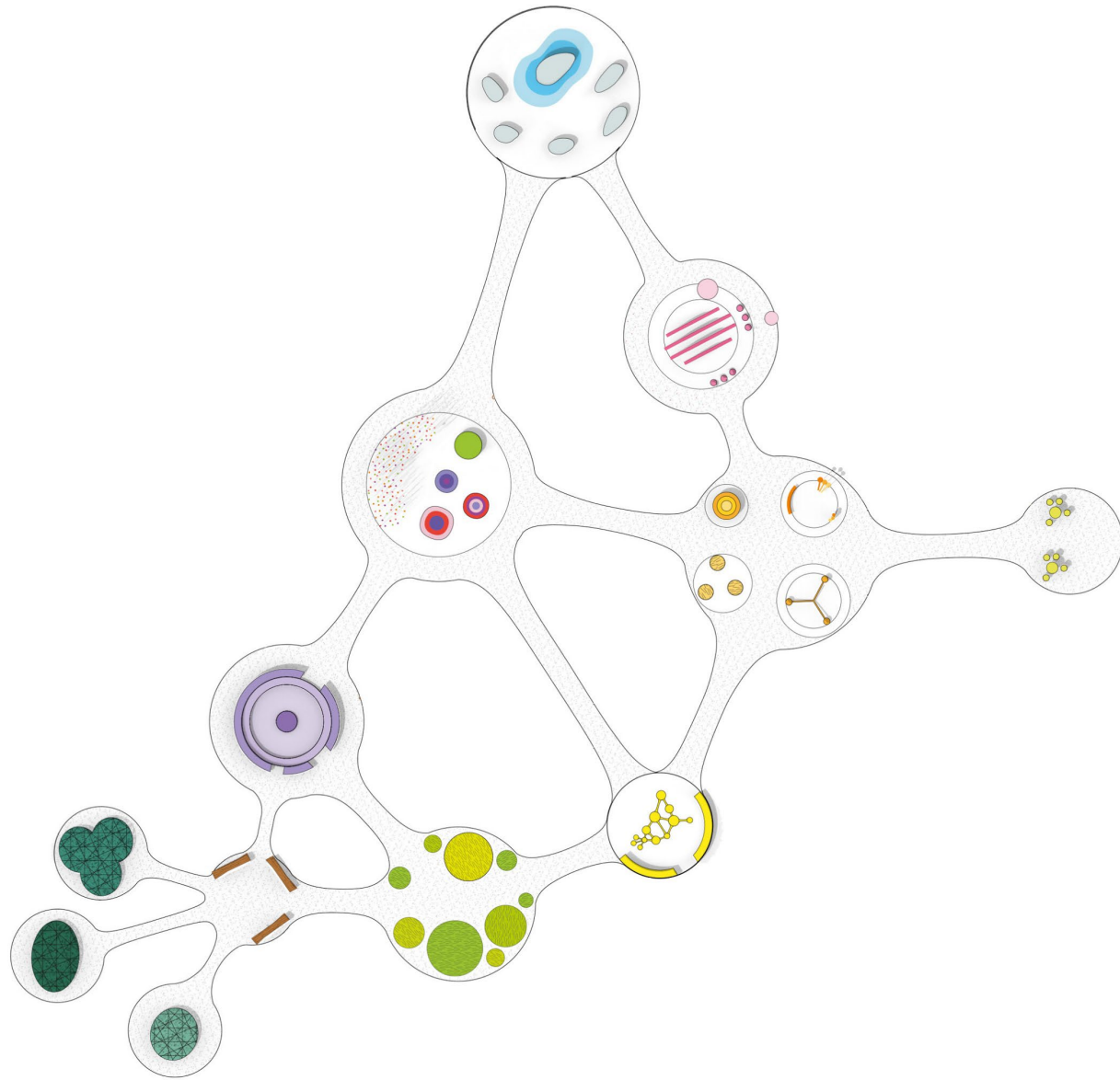

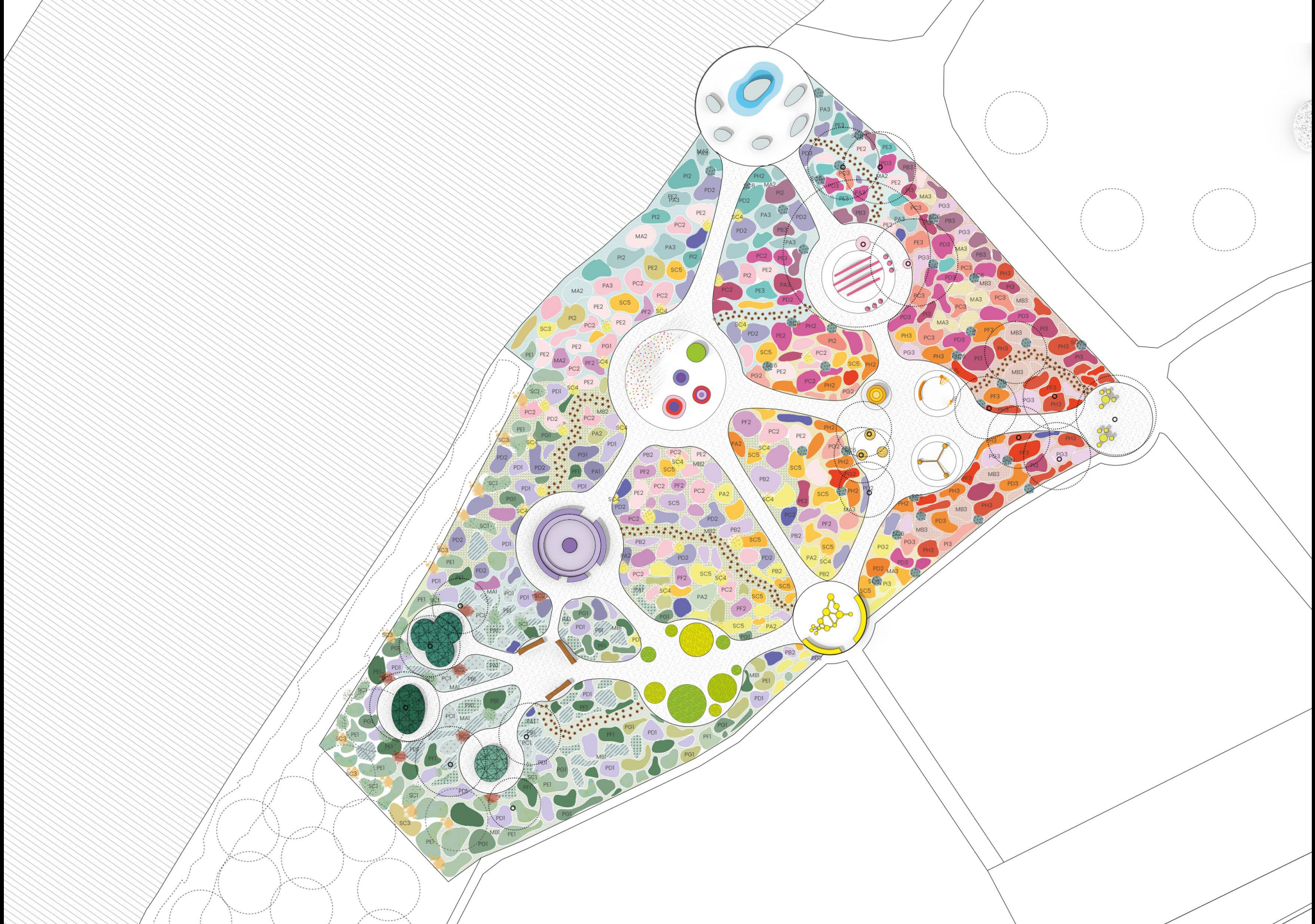

Plant Portraits

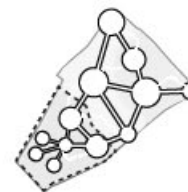

■ Rain Garden

PA1

Bugle
Ajuga reptans
(groundcover)



M

Graden
Speedwell
Veronica
langifolia



L

PB1

White Marsh
Marigold
Caltha
leptosepala



L

Peach-leaved
Bellflower
Campanula
persicifolia



L

PC1

August
moon hosta
Hosta
'x August Moon'



M
(cut back)

Frikarts Aster
Aster x frikartii
'Wunder
von Stöfa'



M
(cut back)

Culver's Root
Veronicastrum
virginicum
'Album'



L

MA1

Male Fern
Dryopteris
filix-mas



L

Ox-eye Daisy
Leucanthemum
vulgare



L

SC1

Royal Fern
Osmunda
regalis



M
(cut back)

SC2

Swithgrass
Panicum
vigatum



M
(cut back)

■ Zone 1

PA1

Bugle
Ajuga reptans
(groundcover)



M

Graden
Speedwell
Veronica
langifolia



L

PB1

White Marsh
Marigold
Caltha
leptosepala



L

Peach-leaved
Bellflower
Campanula
persicifolia



L

PD1

Garden
catmint
Nepeta
cataria



L
(Spring
cut back)

Pale Purple
Coneflower
Echinacea
pallida



L

Globe thistle
Echinops
 ritro



L

PE1

Tall Verbena
Verbena
barbatiensis



L

Mexican
Feathergrass
Nassella
tenuissima



M
(cut back)

PF1

Japanese
Anemone
Eriocapitella
hupahensis



L
(divide clumps
every few year)

Biokovo
Cranesbill
Geranium
Biokovo



L

PG1

Grape
Hyacinth
Muscari
armeniacum



L

Siberian
Bugloss
Brunneria
macrophylla



L

MB1

Cornflower
Centaurea
cyanus



L

Ox-eye Daisy
Leucanthemum
vulgare



L

SC1

Royal Fern
Osmunda
regalis



M

SC3

Feather Reed
Grass
'Karl Foerster'



M

— — — — —
— — — — —
ALL-IRELAND
POLLINATOR PLAN
— — — — —
2021-2025 — — — — —



Online edition: ISSN 2004-4902
Print edition: ISSN 2009-6844



www.pollinators.ie

Seasonal Interest Charts

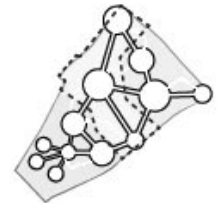

■ Naturalistic Zone

Zone 2

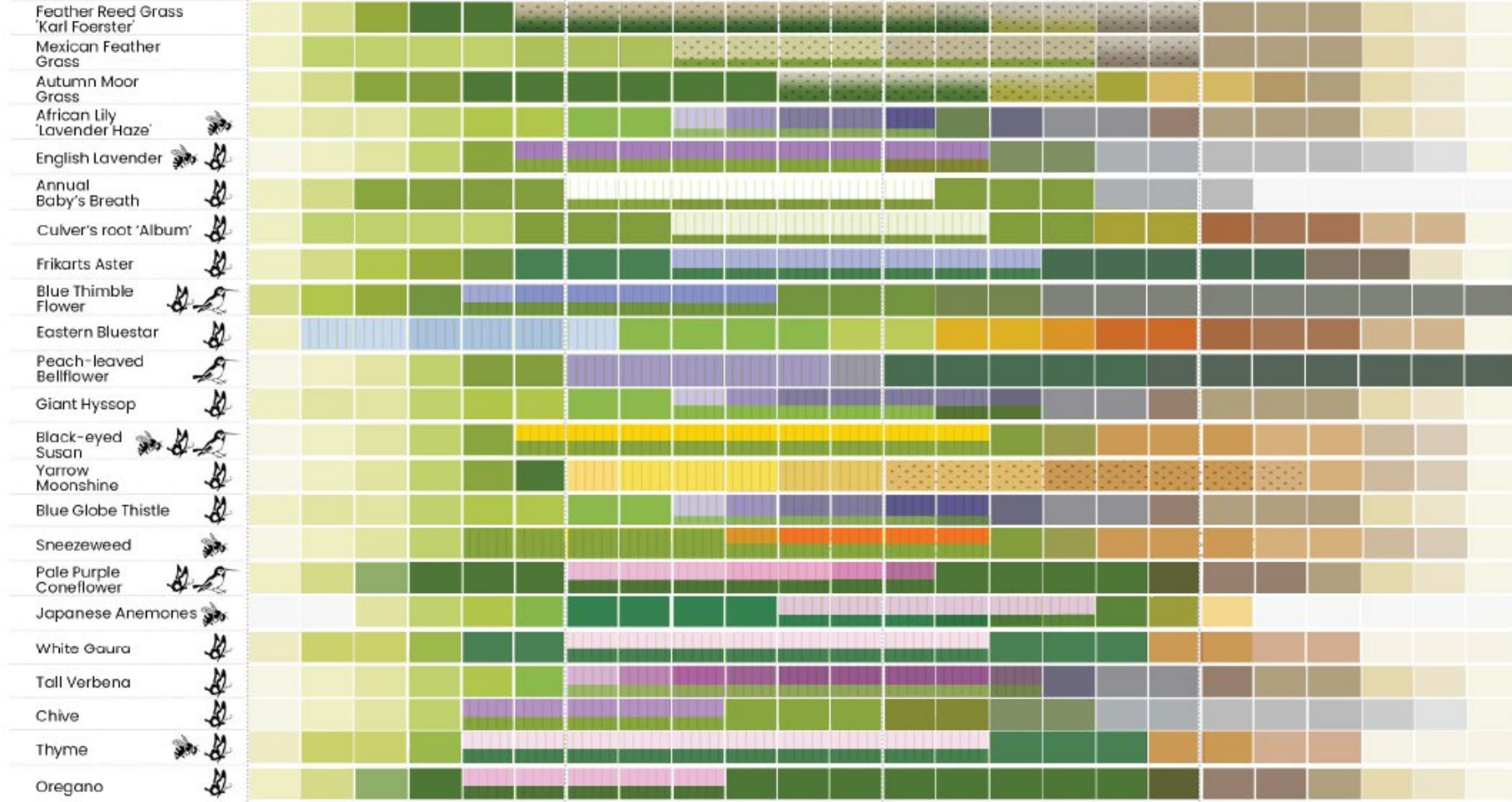









ACT

Nature Based Solutions

Bertra Sands Community Stewardship Plan



what it should be...

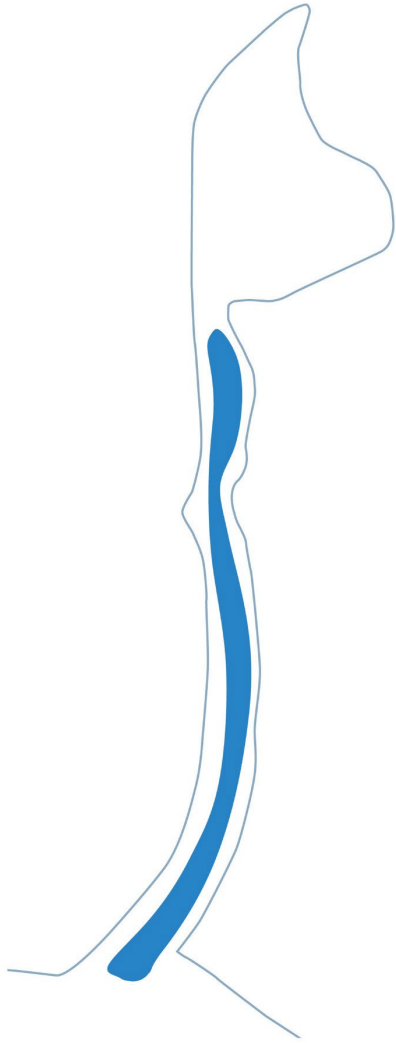

2010
52,358m²

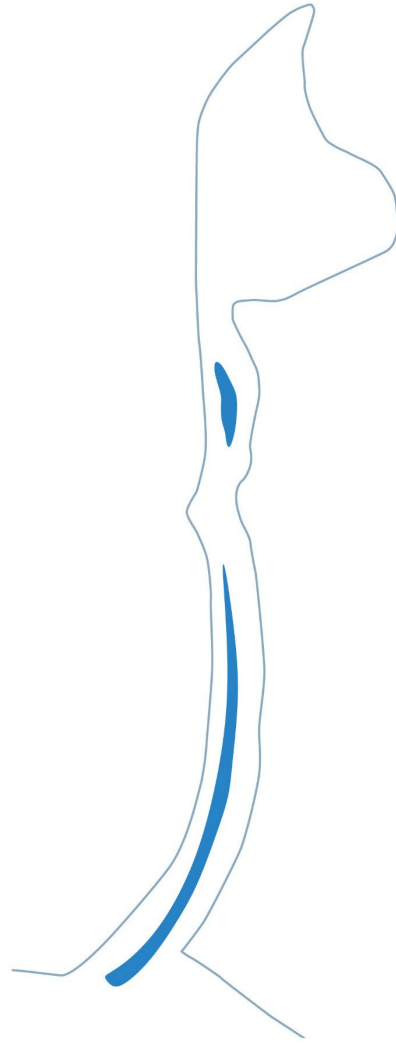

2022
19,898m²
62% Reduction



2010
Satellite Image

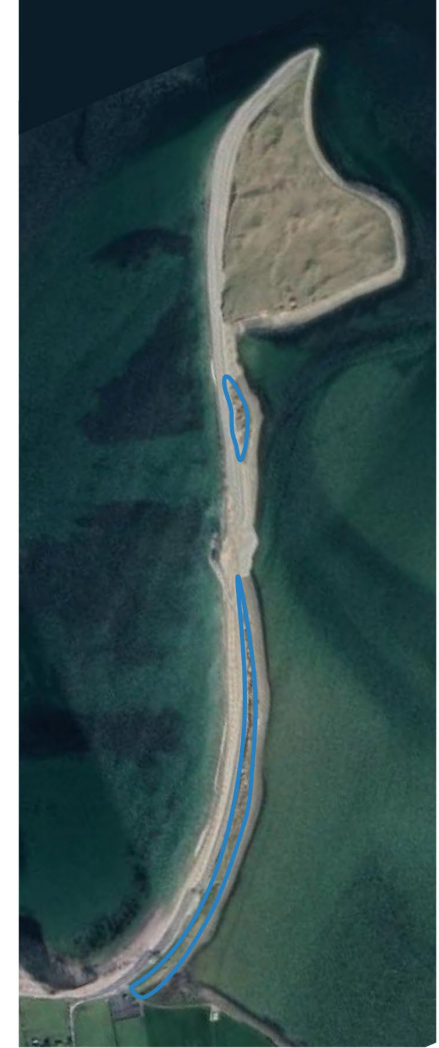

2022
Satellite Image

The Challenge

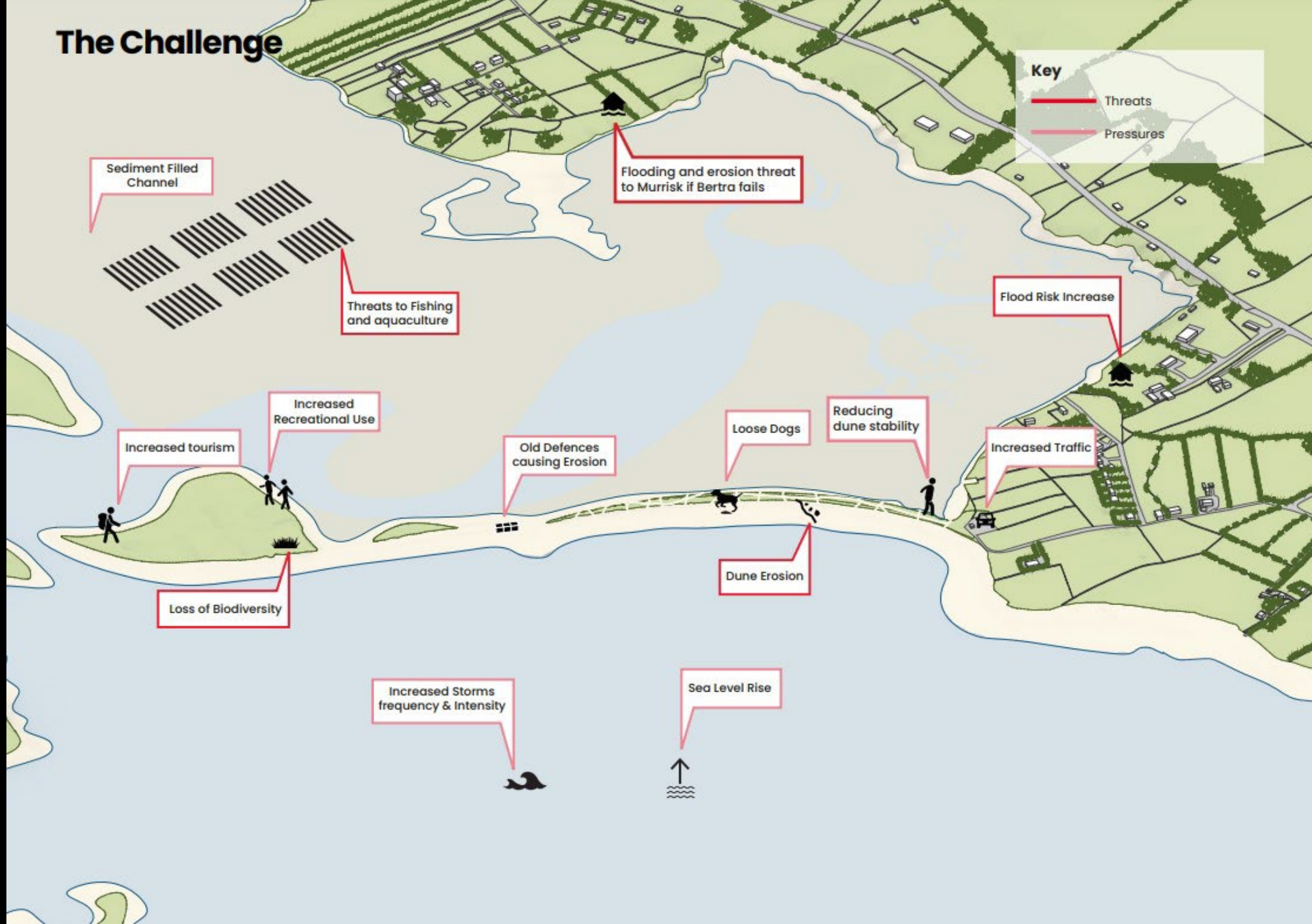



Proposed Solutions

Key

- Monitor and Manage
- Change User Habits
- Protect the Dunes
- Regenerate the Dunes

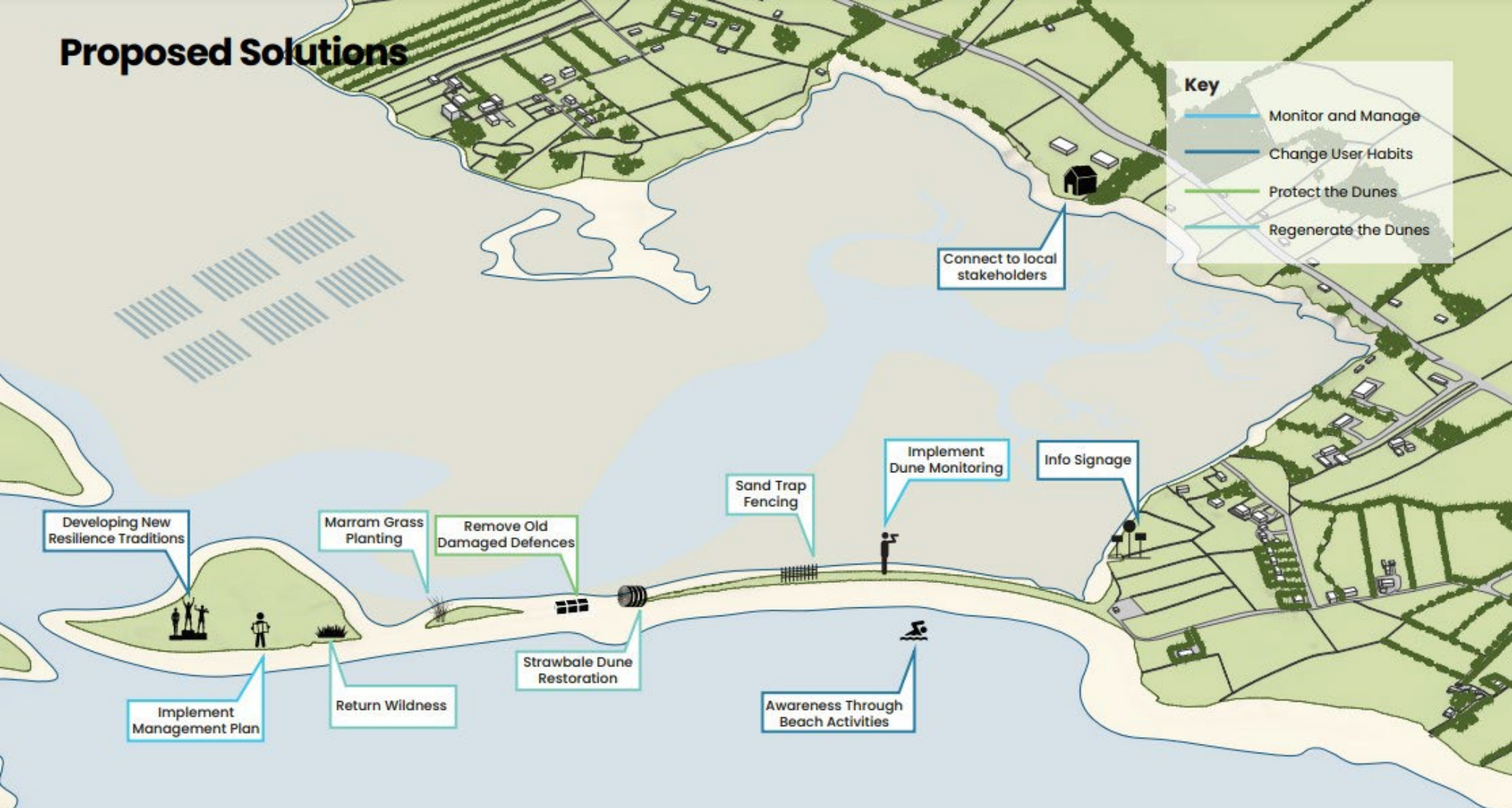

Long-Term Solutions

<p>Regenerate the Dunes</p> <ul style="list-style-type: none"> Controlled Grazing 	<p>Protect the Dunes</p> <ul style="list-style-type: none"> Board Walk Beach Replenishment Vertical Column Farming Sea Grass Restoration 	<p>Change User Habits</p> <ul style="list-style-type: none"> Use Murrisk Car Park Designated Recreational Area
---	---	---



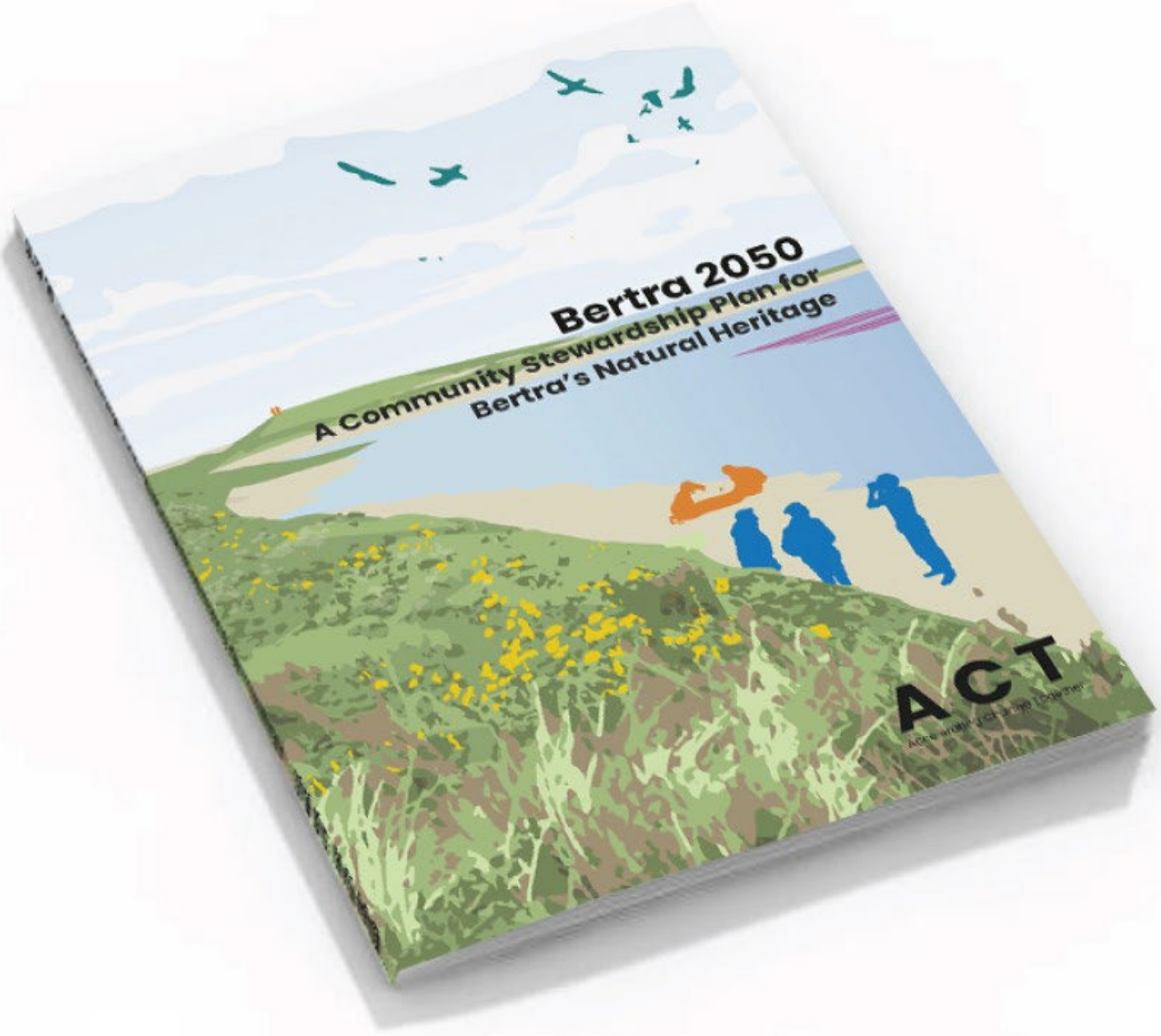

Bertra 2050

A Community Stewardship Plan for
Bertra's Natural Heritage

ACT
Agriculture, Conservation & Tourism



Áras an Chontae

Ballina Civic Offices

Belleek Woods

Bertra Beach Dunes Project

Bonniconlon West Housing Scheme

Caltragh Loop Walk

Connacht GAA Centre of Excellence

Cycle Friendly Clew Bay

Derrinumera

SPEAK

Bertra Beach Dunes Project

#ProtectOurDunes campaign

Damage to our sand dunes is evident all around the coast. In 2021, the [Climate Action Regional Offices](#) launched a campaign in collaboration with local authorities and NUI Galway to highlight the importance and fragility of these natural coastal protections and important habitats.

The preservation and strengthening of natural coastal defences, such as sand dune systems, plays an important role in increasing our coastal resilience to the impacts of climate change. Other countries, such as the Netherlands, are protecting and restoring their sand dune systems as a cheaper and better method - in some cases - than hard coastal protection works.



Popular Services



ACT

Nature Based Solutions

Dundalk Historic Trees Project

Winners of the Dundalk CTCHC Project Historic Trees Hashtags Competition 2022

#Dundalklongwalktrees – Zakaria

#Trees4bees – Tadgh

#Historictrees – Daniel

Thanks to all
at Coláiste
Chú Chulainn



An Chomhairle Oidhreachta
The Heritage Council



ACT
Accelerating Change Together

MoCI
Museum of Childhood Ireland
Músaem Óige na hÉireann





13%

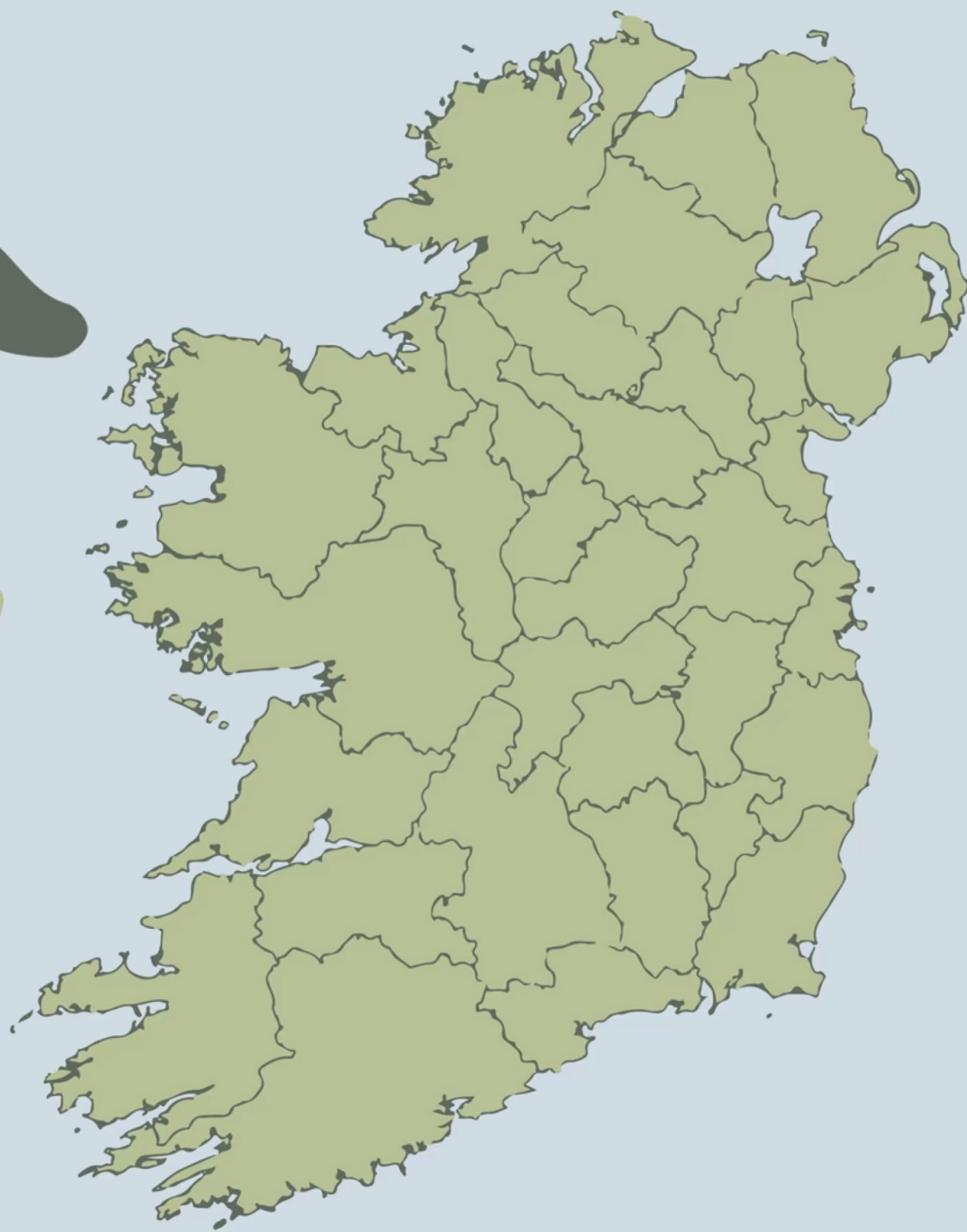
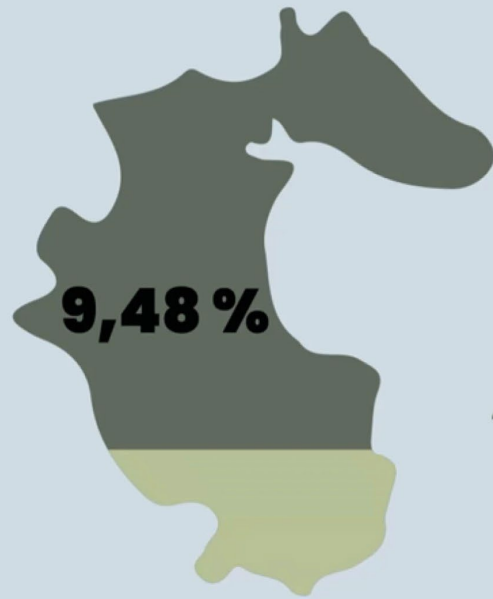

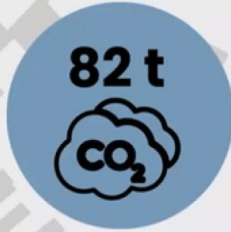

82 t
store carbon dioxide



filter pollutants



provide a cooling canopy



flood protection



increase neighbourhood property values



THE LONG WALK

MARKET SQUARE

EARL STREET

MAGNET ROAD

THE LONG WALK

NE



X64

THE NATURAL HERITAGE OF DUNDALK'S LONG WALK

DUNDALK, LOUTH



The Heritage Council is organising this mission.

Welcome to the Natural Heritage of the Long Walk!

The Heritage Council's Collaborative Town Centre Health Check Programme invites you to explore and celebrate the natural heritage of Dundalk Town Centre through the historic trees found at the Long Walk.

- Did you know that Dundalk once had a Demesne of nearly 400 acres?!
- Did you know that the 42 trees found at the Long Walk are some of the last remaining trees from this Demesne?
- Did you know that all the Long Walk trees contain 9 non-native species and that they collectively store an

DONATE TREES

This mission has ended. [Explore the trees planted.](#)



Collaborative Town Centre Health Check
(CTCHC) Programme

Dundalk Town Centre
Long Walk Historic Trees Project



H E
F A C E.

cerning the various Antiquities of
et appear'd in Publick, the Auth
pt will not prove al
scribers, or unwor
whose Curiosity lea
ture. And,

his Friends, more
l Motive for under
ound unequal to th
ing attempted it.

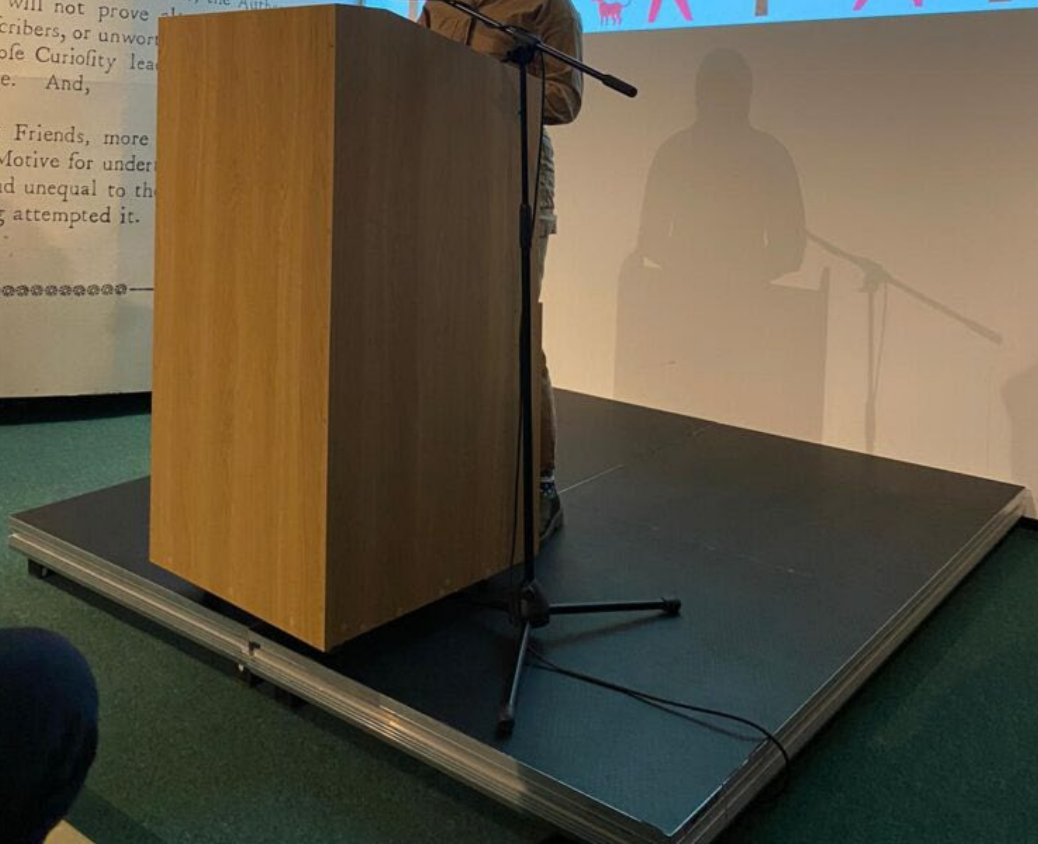



Dundalk's Historic Tre...

Dundalk historictrees

Historic Trees within Dundalk taken from Louth County Council's Tree Surveys of Drogheda & Dundalk* source:

56 views

Published on 17 May

[SHARE](#)

Protected Trees

- TP1 - Demesne
- TP2 - Long Walk
- TP3 - Icehouse Hill
- TP4 - Famdreg Estate
- TP5 - CASTLE PARK
- TP6 - CASTLETOWN CEMETERY
- TP7 - ST. LOUIS CONVENT
- TP8 - DE LA SALLE
- TP9 - THE PADDOCK
- TP10 - MOUNT AVENUE
- TP11 - CARRICK ROAD: RUCKY HILL
- TP12 - DERRYHALE.
- TP13 - MOUNTHAMILTON HOUSE
- TP14 - LISNAWULLY HOUSE
- TP15 - GRAMMAR SCHOOL
- TP16 - CRESCENT PARK
- TP17 - BROOK STREET
- TP18 - ENTRANCE TO MCARDLE'S BREWERY
- TP19 - BROOKFIELD
- TP20 - ST. OLIVER SHRINE
- TP21 - HILLTOP

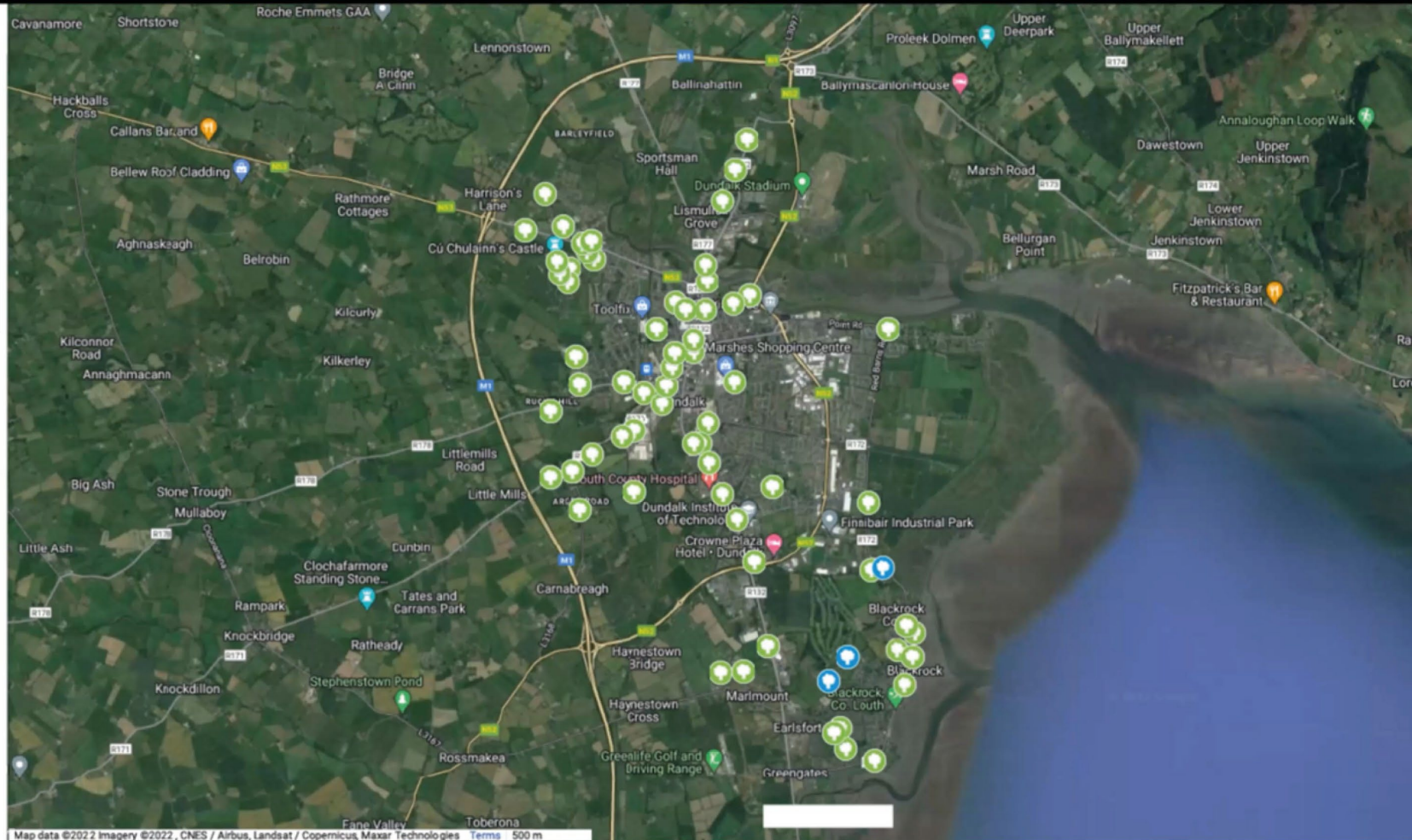

Map data ©2022 Imagery ©2022, CNES / Airbus, Landsat / Copernicus, Maxar Technologies Terms 500 m

https://www.youtube.com/watch?v=V0oMIXKE_-4

ACT

Nature Based Solutions

Ripple



IDEA	IMAGE	COMMENTS	VOTES	IDEA
1: WELCOME WILLOW Where: Entrance to Greenhills Estate What: A willow sculpture that celebrates biodiversity and nature. Possibly a tree or a sculpture.				9: HEDGEHOG HIGHWAY Where: The laneways connecting north and south of the estate and down to the river. What: A biodiverse route of protected paths, with hedgehog boxes, insect hotels, signs and planting.
2: TREE-LINED STREET Where: Along the entrance road into Greenhills Estate What: Retain the trees and plant new trees. Consider fruit or nut trees and seasonal grass verges.				10: GREEN LANES Where: Identified places in the Greenhills Laneways What: Bioswales and rain gardens dispersed throughout the laneways.
3: CHILD-FRIENDLY WATER PLAY GARDEN Where: The final stages What: A child-oriented play area featuring water and other activities in the vicinity. Drawings made by local children on our 'People and Places' project.				11: RIVER BANK TREES Where: Along the bank of the Brusna river What: Native tree planting including Weeping Willow, Fruit Trees, Strawberry Trees as a riparian buffer along the river.
4: RIVER BANK TREES Where: Along the bank of the Brusna river What: Native tree planting including Weeping Willow, Fruit Trees, Strawberry Trees as a riparian buffer along the river.				12: MEADOW BANK Where: The steep bank in the Caltra/Big Park What: No mow policy, and native wildflower planting all along the steep hill
5: MEADOW BANK Where: The steep bank in the Caltra/Big Park What: No mow policy, and native wildflower planting all along the steep hill				13: GREENHILLS WATER TRAIL Where: Throughout Greenhills What: A signposted trail throughout Greenhills, connecting all the associations by the Residents Association, Biodiversity Group and Ripple. This could link to the Mural Wall.
6: GREENHILLS WATER TRAIL Where: Throughout Greenhills What: A signposted trail throughout Greenhills, connecting all the associations by the Residents Association, Biodiversity Group and Ripple. This could link to the Mural Wall.				14: RAINWATER COLLECTION CHAMPIONS Where: Individual houses in Greenhills What: Rainwater butts connected to roof downpipes to relieve the drainage system & provide water use to residents for their personal use.
7: RAINWATER COLLECTION CHAMPIONS Where: Individual houses in Greenhills What: Rainwater butts connected to roof downpipes to relieve the drainage system & provide water use to residents for their personal use.				15: LIGHT MY WAY COURTS Where: The River paths and Ball Courts What: Solar and/or hydro powered lighting to the river paths and ball courts
8: LIGHT MY WAY COURTS Where: The River paths and Ball Courts What: Solar and/or hydro powered lighting to the river paths and ball courts				16: PARADISE GARDEN Where: The west end green space by the river, close to the bridge What: A community garden including a bog garden, vegetable garden, mini-orchard, picnic area and composting area. A watery haven for people and nature.
9: PARADISE GARDEN Where: The west end green space by the river, close to the bridge What: A community garden including a bog garden, vegetable garden, mini-orchard, picnic area and composting area. A watery haven for people and nature.				





Reconnecting with nature

RIPPLE

University College Dublin (UCD) /
Centre for Irish Towns (CFIT)
IRELAND





Published: Fri 14 Jul 2023, 2:41 PM

Last updated: Fri 14 Jul 2023, 2:48 PM



Image of the "Cascade" project, Ballina. Photo: Kevin Loftus ACT/ Ballina Green Town

Two Mayo projects secure creative climate funding

Two Mayo projects have been secured funding under the Creative Ireland Creative Climate Fund II, Councillor Mark Duffy has confirmed.

ACT

Nature Based Solutions

acceleratingaction.com

Make better, more sustainable decisions.

Upskill yourself and your team to discover, improve and communicate your sustainable impact in as little as 15 minutes.

Everything you need plus expert support on hand.

We all know the "why". Here's the "how".

Get started with the Accelerating Action Tool













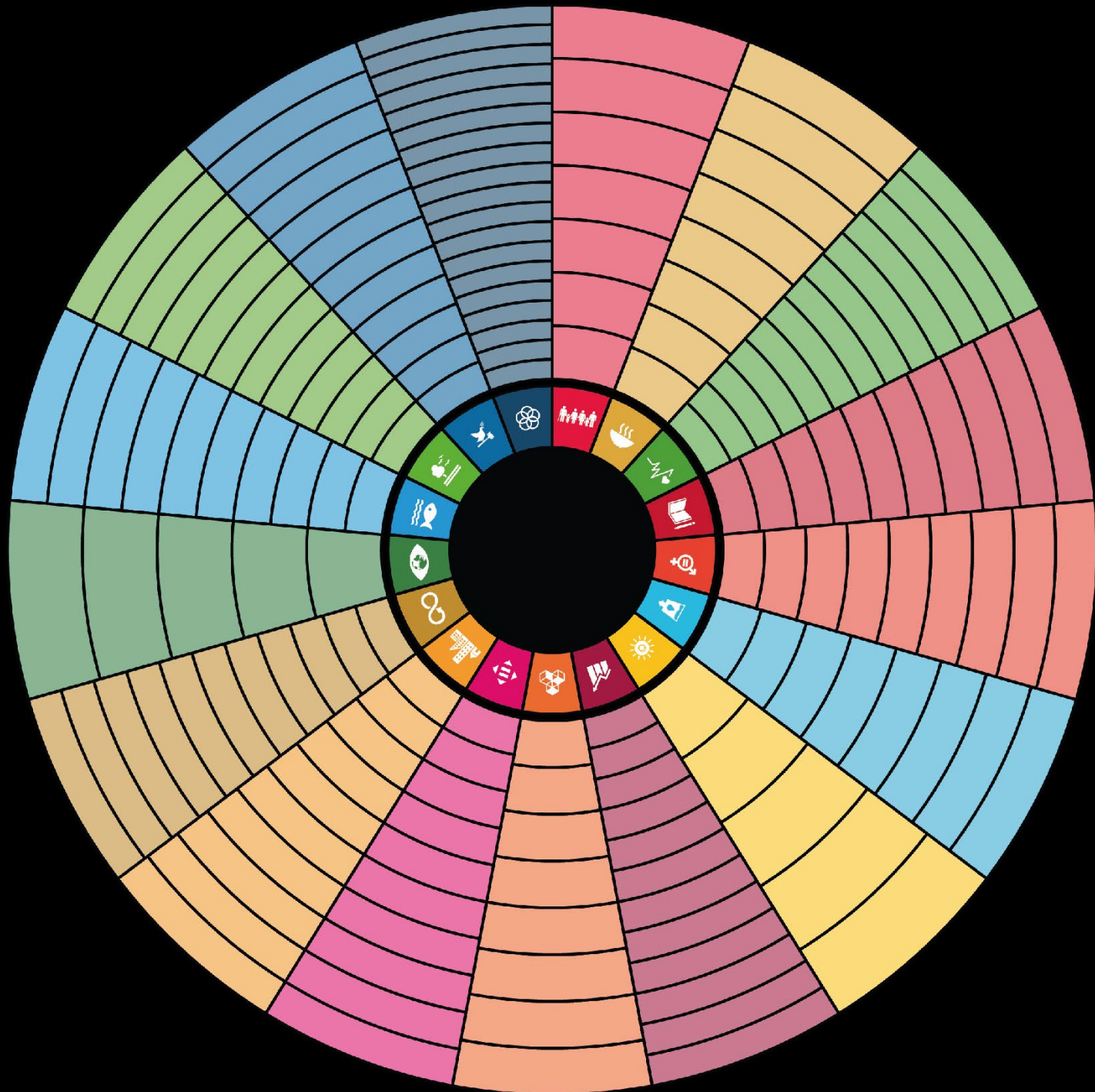

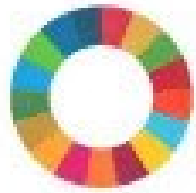

>>

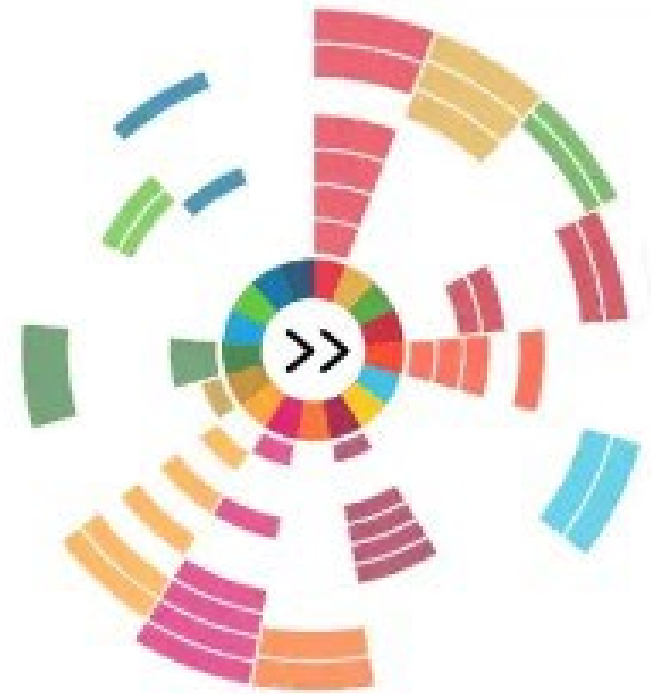

THE UN SDGs,

YOUR ACTIONS,

TRANSLATED.



Perform gap analyses and option appraisals to be able to make the right informed decisions.



UNDRR
UN Office for Disaster Risk Reduction



**Making
Cities
Resilient**

CASE STUDY

County/ regional assessments

Commissioned by the
Heritage Council's
Collaborative Town Centre
Health Check programme.

Assessments allowed for gap
analysis as well as the ability
to create coherency and
comparison across regional
strategies.

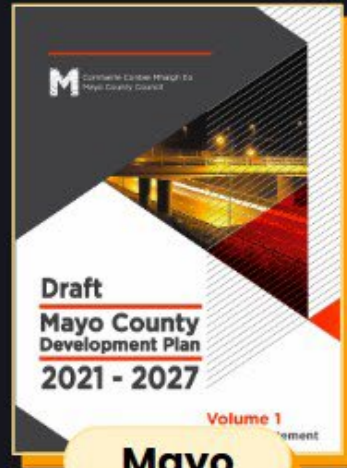
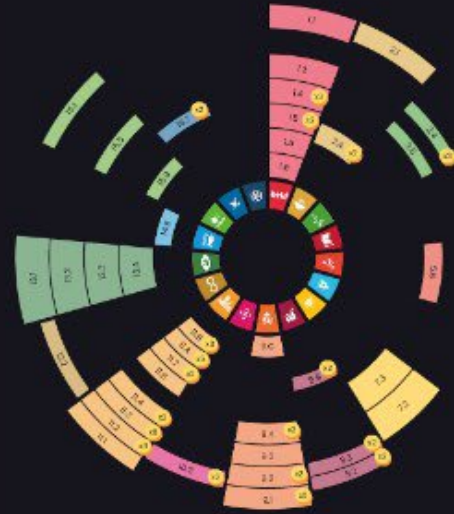

Mayo

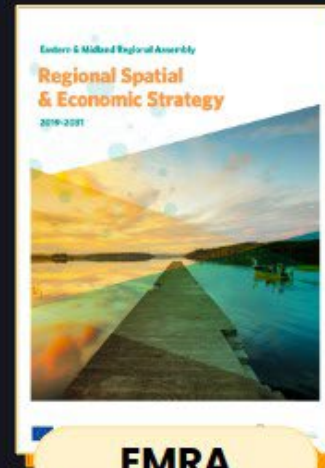

EMRA

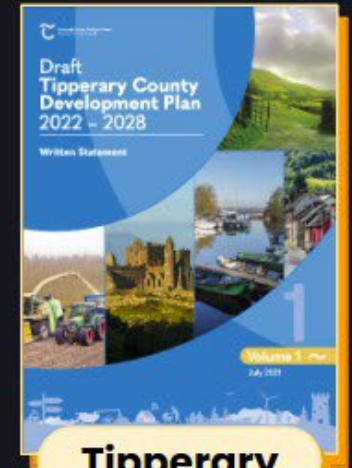

Tipperary



CASE STUDY

IRELAND'S

CLIMATE

ACTION PLAN

2023

Ireland's Department of the Environment, Climate and Communications (DECC) used the tool to assess their latest Climate Action Plan against the SDGs to articulate not only the climate benefits of the plan but also the environmental, social and economic benefits.

