

**eccomum**

Operating Manual

DOUBLE BOTTLE WARMER

Model :HB-055E

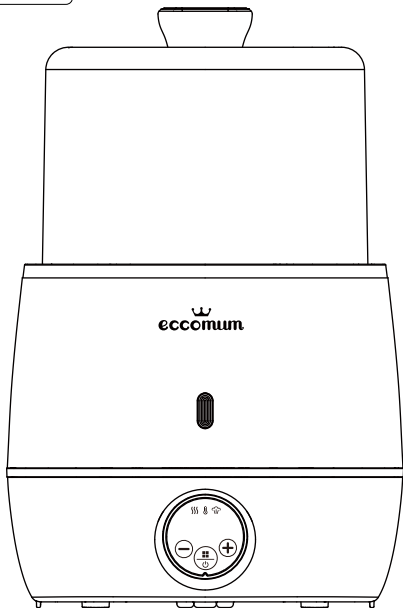

Please take a few minutes to read through the ENTIRE INSTRUCTION LEAFLET before using your product for the first time.
PLEASE SAVE THESE INSTRUCTIONS.

- Before using the appliance for the first time, check that the voltage of your electrical mains system is compatible with it.
- The bottle warmer should always be placed on a flat and dry surface, out of reach of children.
- Do not let power cord hang over edge of table or counter, or touch hot surfaces.
- Do not move the appliance when in use or if it contains hot water.
- The bottles should be placed in the bottle basket, with the ring slightly loosened.
- Always place the basket (bottle tray / baby food tray) in the chamber to heat up bottles and baby food.
- Never turn on the appliance without having filled the heating chamber with the required amount of water (the water used should be free of additives).
- Allow the bottle warmer to cool for approximately 15 minutes between uses. Never touch the inside of the chamber during or just after operation.
- Don't forget to unplug the appliance after use.
- Never immerse the appliance in water or any other liquids.
- If the milk and/or baby food is not hot enough after the heating cycle, we recommend that you increase the working time for heating. However, it is necessary to check the temperature of the milk or baby food before feeding to the baby.
- This appliance is not intended for use by persons (including children) with reduced physical, sensory or mental capabilities, or lack of experience and knowledge, unless they have been given supervision or instruction on the use of the appliance by a person responsible for their safety.
- Children should be supervised to ensure that they do not play with the appliance.
- If the power cord is damaged, it must be replaced by the manufacturer, its service agent or similarly qualified persons in order to avoid any hazard.
- The food should not be heated for too long.

The device is intended for use in the domestic /private environment only, not in commercial situations. Only use the device to warm up baby food/drinks and keep them warm. This device may only be used for the purpose for which it is designed and in the manner specified in the instructions for use. Improper use can be dangerous. The manufacturer is not liable for damage resulting from improper or careless use.

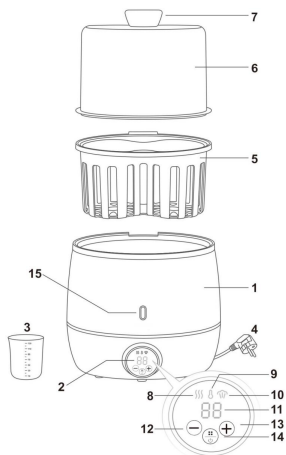

1. Main body
2. Control panel
3. Measuring cup(120ml)
4. AC plug
5. Heating basket
6. Top cover
7. Handle
8. Fast heating up symbol
9. Keeps warm symbol
10. Sterilization symbol
11. Time/temperature display
12. Time/Temperature decrease button
13. Time/Temperature increase button
14. Function, On/Off switch
15. Indicator

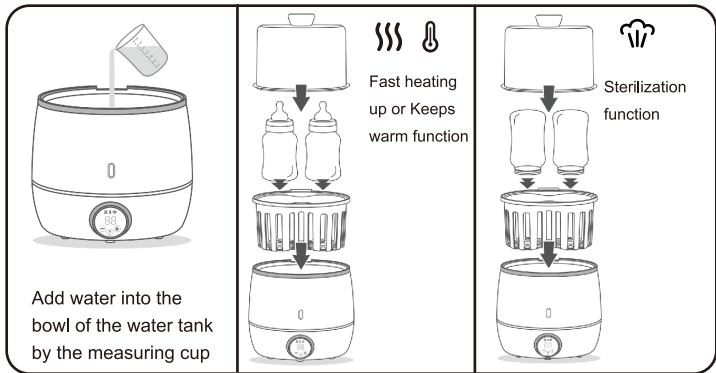

Add water into the bowl of the water tank by the measuring cup

Fast heating up or Keeps warm function

Sterilization function

Mode 1: Fast heating up(By default, when the device is switched on the fast heating up function will be selected.)

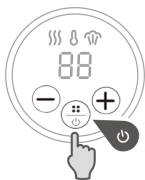

Press "ON" button



Select the function needed



Select the working time
After 5 seconds, the blue light will change to red, meaning that the device has started the heating cycle

Reference Table: warms up from 4 C (39 F) to 37 C (99 F)

Volume in the baby bottle	Water in the heater	Working time
60ml(2oz)	35ml(1.2oz)	3minutes
120ml(4oz)	35ml(1.2oz)	4minutes
150ml(5oz)	40ml(1.4oz)	4minutes
180ml(6oz)	40ml(1.4oz)	4minutes
210ml(7oz)	40ml(1.4oz)	4minutes
240ml(8oz)	40ml(1.4oz)	4minutes
270ml(9oz)	50ml(1.7oz)	5minutes
330ml(11oz)	50ml(1.7oz)	6minutes

By following the instructions of the tables, the temperature should vary between 37°C(99 F) and 40°C (104 F)after heating. However, variations in the material, shape, size, etc. of the receptacle which holds the milk or baby food, as well as any other conditioning factor, could cause the final range of temperatures to vary. For this reason, always check the temperature of the receptacles when the heating process

has finished before you give anything to your baby. Do this by placing a small amount on a sensitive part of your body (forearm of the back of your hand).

- Once the heating process has been completed, the device will beep to notify the user that the heating process has finished.
- If there is not enough water on the heater for the time set during the heating process, the device will beep intermittently. If you pour water in the tank again within three minutes, the device will start up again automatically.
- When heating jars of baby food, stir the baby food with a small spoon for 15-20 seconds after completion so that the temperature is evenly distributed throughout the contents.

Mode 2: Keeps warm

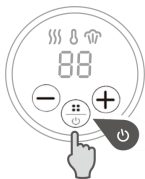

Add enough water to the tank to cover the receptacles halfway up their contents. Press "ON" button



Select the function needed

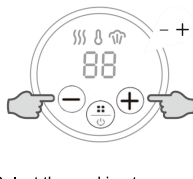

Select the working temperature. After 5 seconds, the blue light will change to red, meaning that the device has started the heating cycle

- The contents of the receptacle will take between 30 and 60 minutes to reach the temperature set, according to the material, the volume of the contents in the receptacle(s), and the initial temperature of the contents, etc.
- If it is not stopped manually, the device will keep going the process.

Mode 3: Sterilization



Add 100ml water to the heating chamber. Press "ON" button



Select the function needed



Select the working time.
After 5 seconds, the blue light will change to red, meaning that the device has started the heating cycle

- Once the heating process has been completed, the device will beep to notify the user that the heating process has finished.
- The device will stop working automatically once the water was run out.
- The steam which is released during the sterilization process is very hot. The device must not be touched whilst it is being used.
- It is recommended that you allow the device to cool down for a few minutes before opening the cover. After this, remove the baby bottles and accessories.
- Allow the sterilizer to cool down for at least 20 minutes before sterilizing again.
- After the necessary cooling of the heating chamber, always remove any remaining water from the it after each use, making sure that you leave it completely dry.
- If you wish to terminate the heating or sterilization process before the time indicated runs out, keep the power button pushed down for four seconds.

Always use the heating basket. The baby bottles or jars of baby food must never come into direct contact with the heater, since this could mean that heating is not optimal and the baby bottle/jar of baby food could be damaged.

Technical data:

Voltage: 120V~60Hz

Power: 500W

Heating time: 1-16 minutes

Temperature for keeping warm: 35-85 °C (95-185 °F)