

Automatic Transmission Control Lever Knob Package Installation (Instruction ID: 84501964)

Installation Instructions Part Number

84501964

Note: The contents of the kit are shown below.

Kit Contents

Description	Quantity
Automatic Transmission Control Lever Knob	1
Instruction Sheet	1

[Installation Instructions](#)

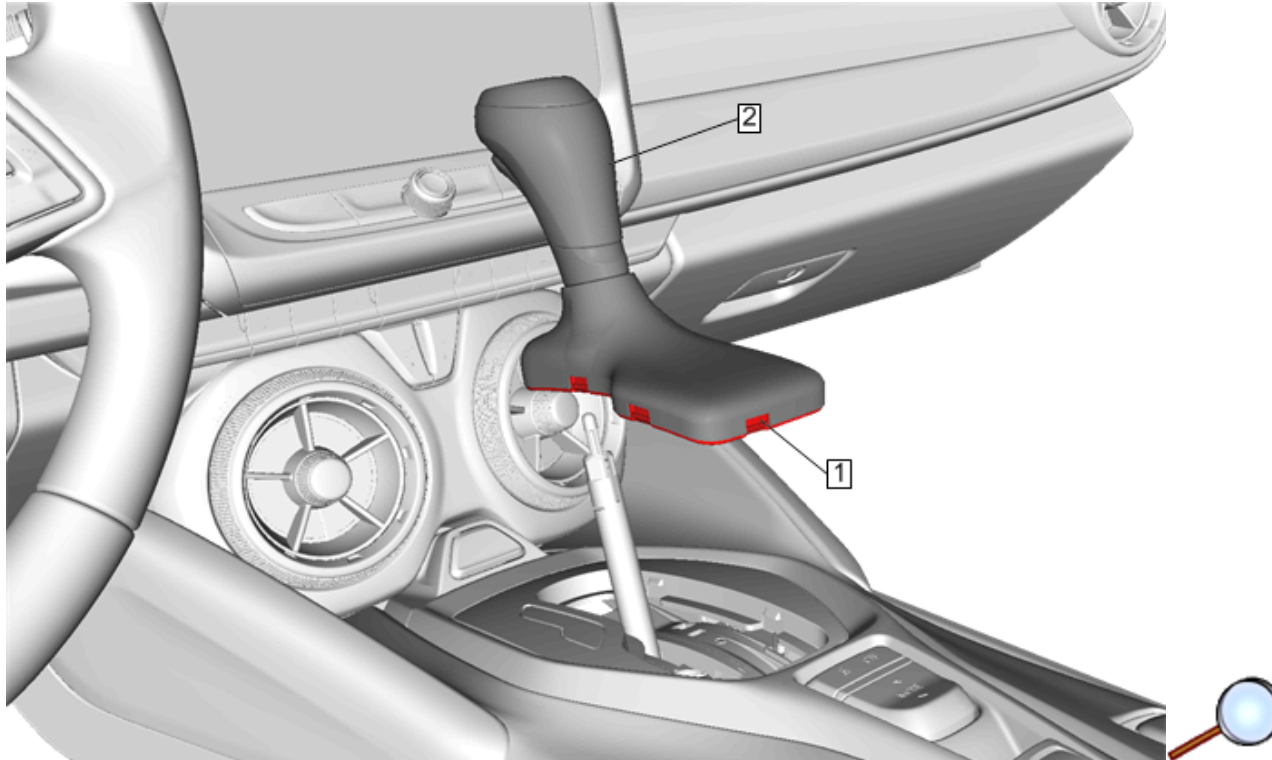

1. Using a flat bladed plastic trim tool, release the five retainer clips securing the control lever boot (1).
2. Pull upward and twist transmission control lever knob (2) and remove with control lever boot from the control lever assembly.

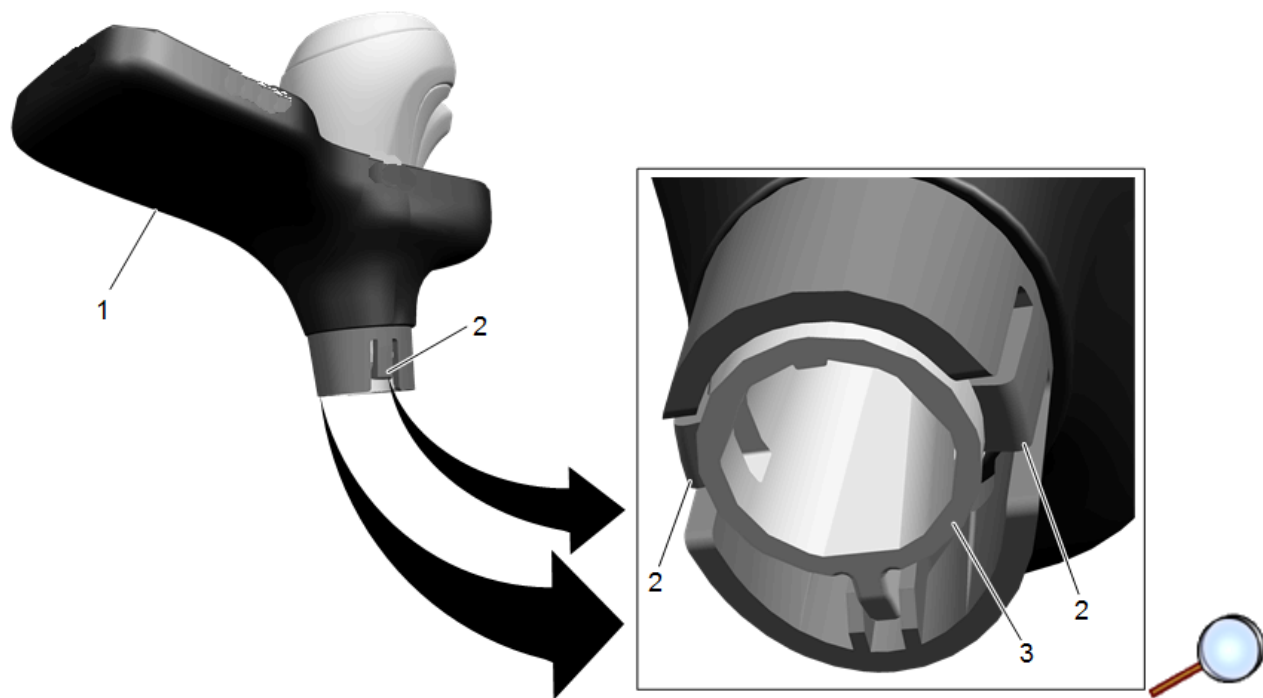

3. Roll up the control lever boot (1) to gain access to the retaining tabs for control lever knob.
4. Using a suitable flat bladed tool, disengage the retaining tabs (2) securing the control lever knob (3).

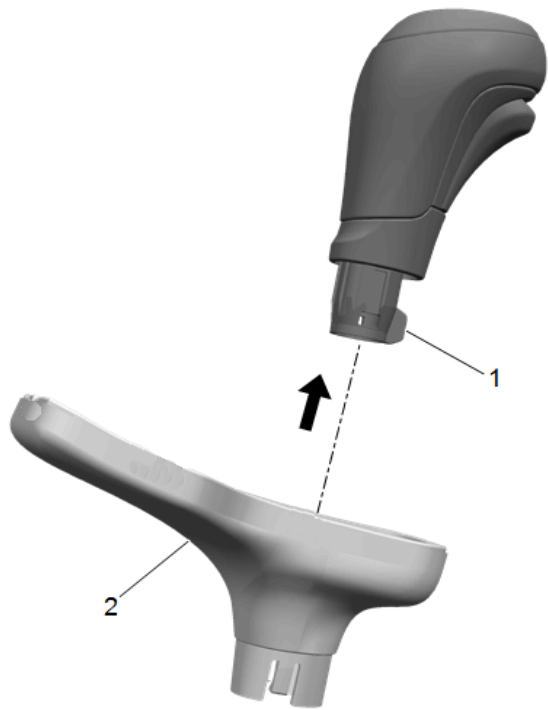

5. Lift up on control lever knob (1) and remove from control lever boot (2).

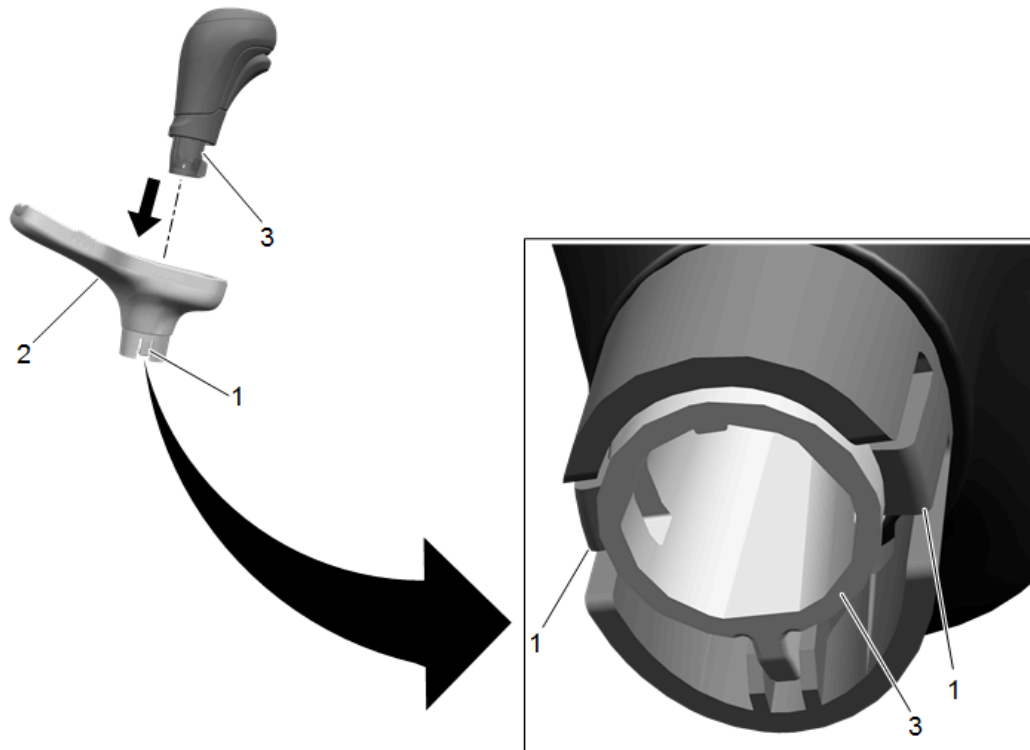

6. Position accessory control lever knob (3) to control lever boot (2) engaging the retaining tabs (1).

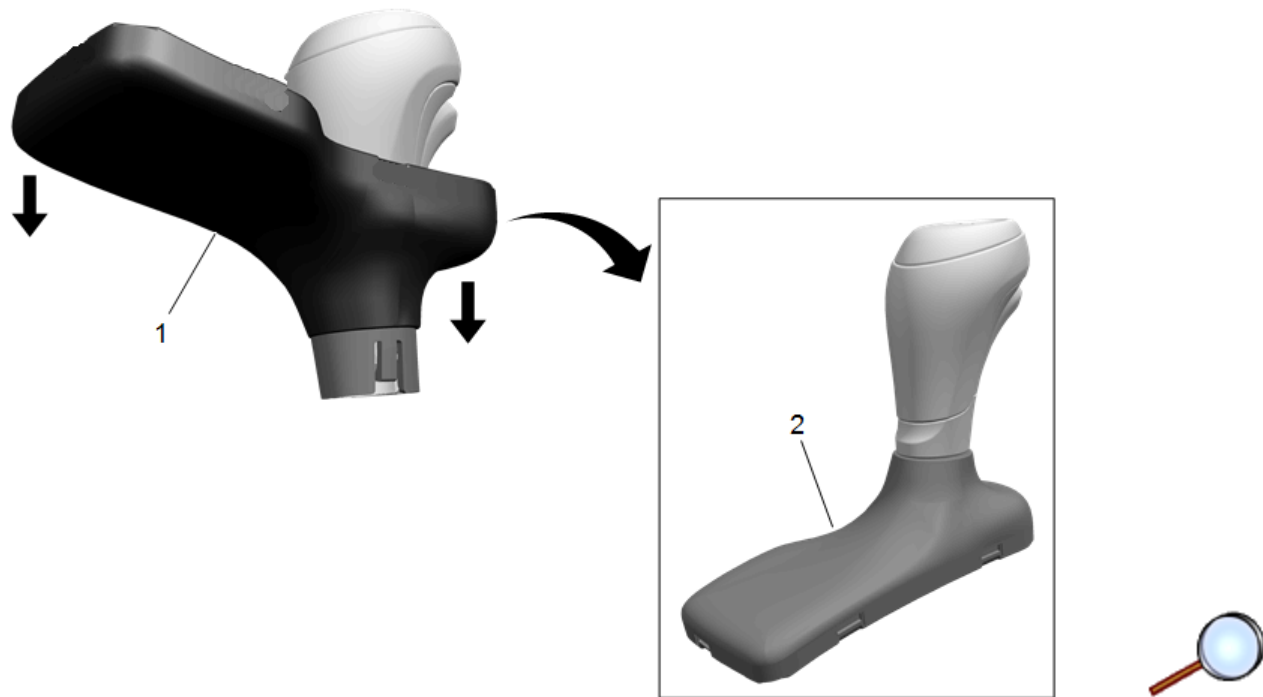

7. Roll down control lever boot (1) to its original position (2).

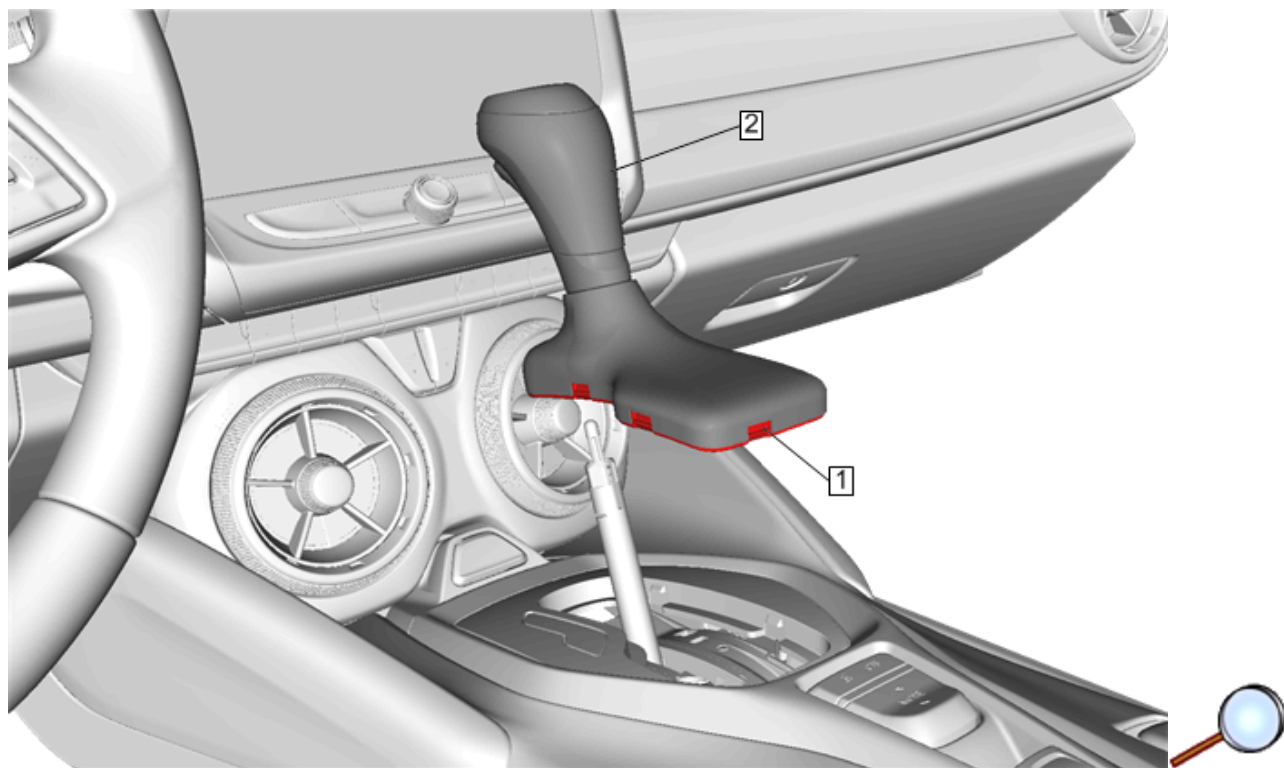

8. Position the transmission control lever boot (1) and control lever knob assembly (2) on the transmission control lever engaging the five retaining tabs on control lever boot to center console.
9. Push down on control lever knob (2) then pull straight upward with moderate force (no twisting motion) to ensure control lever knob is secure to control lever rod.
10. Place the transmission control in the park position and disengage the parking brake.