

# "O" GAUGE SWITCH R & L (base and controller)

RIGHT-HAND SWITCH SHOWN

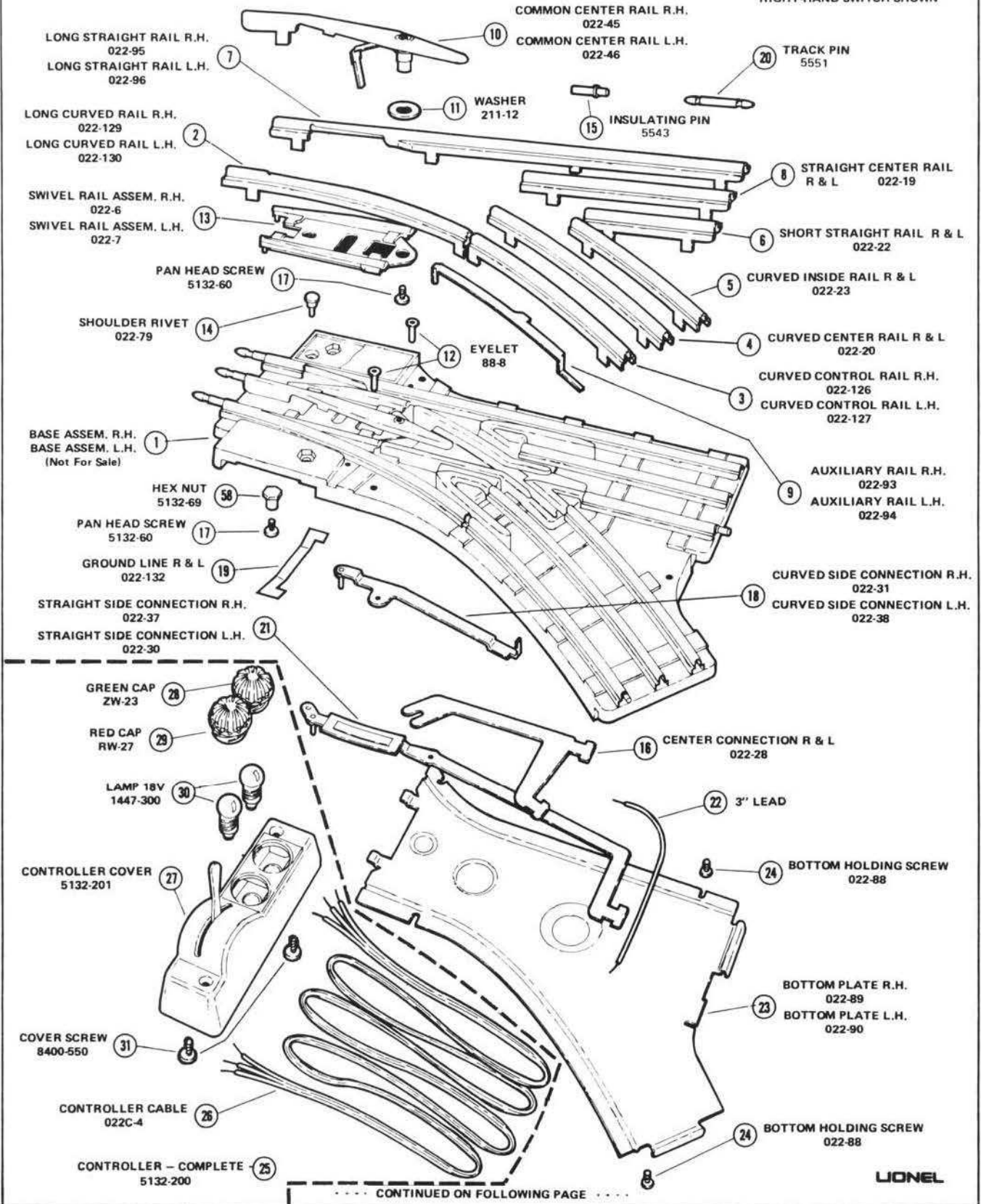

..... CONTINUED ON FOLLOWING PAGE .....

LIONEL

# "O" GAUGE SWITCH R & L (switching mechanism)

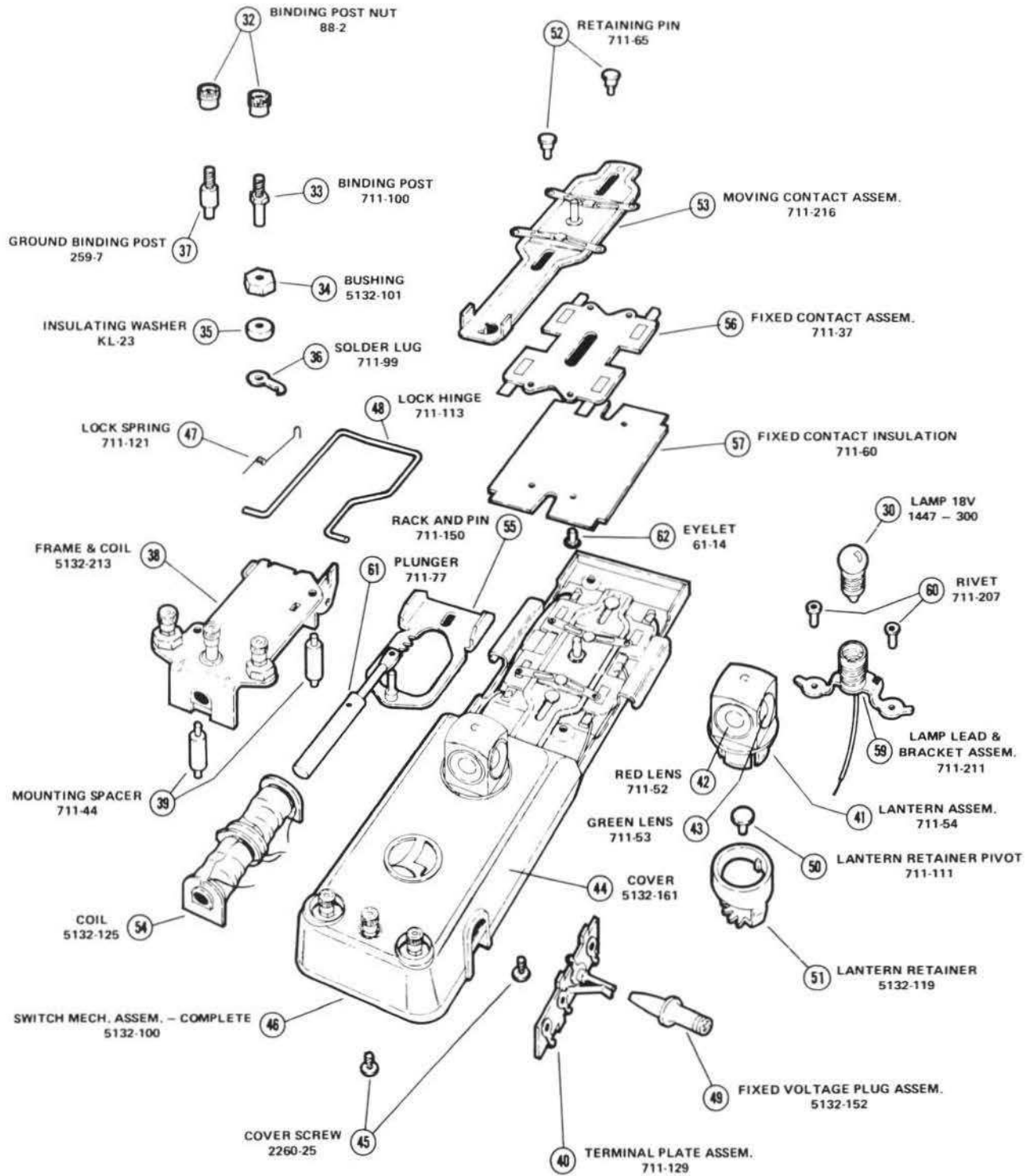

LIONEL

"0" GAUGE SWITCH RIGHT -5132  
LEFT -5133

SECTION TRACK & SWITCHES

DATE 11/80

REF. QUANTITY PER  
NO. PART NUMBER UNIT

REFERENCE  
DRAWING

DESCRIPTION

REF. NO.	PART NUMBER	QUANTITY PER UNIT	DESCRIPTION
1		1	Base assembly RH
		1	Base assembly LH
2	022-129	1	Long Curved rail RH
	022-130	1	Long Curved rail LH
3	022-126	1	Curved Control rail RH
	022-127	1	Curved Control rail LH
4	022-20	1	Curved Center rail R & L
5	022-23	1	Curved Inside rail R & L
6	022-22	1	Short Straight rail R & L
7	022-95	1	Long Straight rail RH
	022-96	1	Long Straight rail LH
8	022-19	1	Straight Center rail R & L
9	022-93	1	Auxiliary rail RH
	022-94	1	Auxiliary rail LH
10	022-45	1	Common Center rail RH
	022-46	1	Common Center rail LH
11	211-12	1	Washer
12	88-8	2	Eyelet
13	022-6	1	Swivel rail assembly RH
	022-7	1	Swivel rail assembly LH
14	022-79	1	Shoulder Rivet
15	5543	2	Insulating Pin
16	022-28	1	Center Connection R & L
17	5132-60	3	Pan Head screw
18	022-31	1	Curved side connection RH
	022-38	1	Curved side connection LH
19	022-132	1	Ground Link L & R
20	5551	8	Track pin (5 RH - 3 LH)
21	022-37	1	Straight side connection RH
	022-30	1	Straight side connection LH
22	011-16	1	3" Lead
23	022-89	1	Bottom Plate RH
	022-90	1	Bottom Plate LH
24	022-36	2	Bottom holding screw #0x3/16" drive screw
25	5132-200	1	Controller complete
26	022C-4	1	Controller cable
27	5132-201	1	Controller cover
28	ZW-23	1	Green Cap
29	RW-27	1	Red Cap
30	1447-300	3	Lamp 18v
31	8400-550	2	Cover screw #4x5/6 Pan Head Phil
32	88-2	3	Binding Post Nut
33	711-100	2	Binding Post
34	5132-101	1	Bushing
35	KL-23	1	Insulating washer
36	711-99	1	Solder Lug
37	259-7	1	Ground Binding Post
38	5132-213	1	Frame & Coil
39	711-44	2	Mounting Spacer
40	711-129	1	Terminal Plate assembly

