

Stručné označen Označen f:

Police:

1	Air conditioning, status	22B
1	Air conditioning, status	54B
1	Air conditioning, status	
10	Engine start, request	25C
10	Engine start, request	57C
10	Engine start, request	
10	Engine start, request	
10	Engine start, request	
10	Engine start, request	
11	Engine stop enable, status	
11	Engine stop enable, status	
12	Crash, signal	
12	Crash, signal	
12	Crash, signal	
12	Crash, signal	
13	Gear range, request	
13	Gear range, request	
14	Gear range, status	
14	Gear range, status	
15	ECO start/stop function button, status	26C
15	ECO start/stop function button, status	58C
15	ECO start/stop function button, status	
15	ECO start/stop function button, status	
16	Engine stop prohibited, request	9H
16	Engine stop prohibited, request	26C
16	Engine stop prohibited, request	42H
16	Engine stop prohibited, request	58C
16	Engine stop prohibited, request	
17	Engine stop prohibited, request	
17	Steering wheel angle sensor, signal	10D
17	Steering wheel angle sensor, signal	43D
18	Door rotary tumbler switch, status	25B
18	Door rotary tumbler switch, status	57B
18	Door rotary tumbler switch, status	
18	Door rotary tumbler switch, status	
19	Fuel pump, actuation	
19	Fuel pump, actuation	
2	Instrument cluster, message	

Stručné označen Označen f :

Pozice :

2	Instrument cluster, message	
2	Instrument cluster, message	
20	Engine speed, signal	7E
20	Engine speed, signal	39E
21	Coolant temperature, signal	7D
21	Coolant temperature, signal	
22	Accelerator pedal sensor, signal	
22	Accelerator pedal sensor, signal	7F
23	Brake light switch, signal	
23	Brake light switch, signal	
24	Brake vacuum sensor, signal	
24	Brake vacuum sensor, signal	
25	Seat belt buckle restraint system switch, status	
25	Seat belt buckle restraint system switch, status	
26	Engine hood anti-theft alarm system switch, status	25D
26	Engine hood anti-theft alarm system switch, status	
26	Engine hood anti-theft alarm system switch, status	57D
26	Engine hood anti-theft alarm system switch, status	
27	Wheel speed, signal	9H
27	Wheel speed, signal	41H
28	Transmission neutral position sensor, signal	
28	Transmission neutral position sensor, signal	
29	Clutch pedal switch, status	8D
29	Clutch pedal switch, status	40D
3	Fuel pump, specified pressure request	
3	Fuel pump, specified pressure request	
30	Engine hood contact switch, status	26D
30	Engine hood contact switch, status	
30	Engine hood contact switch, status	58D
30	Engine hood contact switch, status	
30	Engine hood contact switch, status	
31	Engine torque, increase request	
31	Engine torque, increase request	
32	Engine torque, reduce request	
32	Engine torque, reduce request	
33	ECO start/stop function button, status	29H
33	ECO start/stop function button, status	29J
33	ECO start/stop function button, status	26D
33	ECO start/stop function button, status	61J
33	ECO start/stop function button, status	61H

Stručné označen **Označen** **f** :

		Police :
33	EC0 start/stop function button, status	58D
33	EC0 start/stop function button, status	
33	EC0 start/stop function button, status	
4	Fuel pressure, status	
4	Fuel pressure, status	
5	Starter circuit 50 relay, actuation	
5	Starter circuit 50 relay, actuation	
6	Starter, actuation	
6	Starter, actuation	
7	Brake light switch, status	
7	Brake light switch, status	
8	Circuit 87, status	11G
8	Circuit 87, status	43G
9	Vehicle speed, signal	
9	Vehicle speed, signal	
9	Vehicle speed, signal	
9	Vehicle speed, signal	
A1	Instrument cluster	3E
A1	Instrument cluster	34E
A1p13	Multi-function display	2D
A1p13	Multi-function display	33D
A8/1	Transmitter key	24C
A8/1	Transmitter key	56C
A8/1	Transmitter key	35J
A8/1	Transmitter key	16B
A89	DISTRONIC electric controller unit	48B
A89	DISTRONIC electric controller unit	2B
B11/4	Coolant temperature sensor	35B
B11/4	Coolant temperature sensor	4G
B37	Accelerator pedal sensor	38G
B37	Accelerator pedal sensor	5J
B50	Fuel temperature sensor	37J
B50	Fuel temperature sensor	11K
B64/1	Fuel temperature sensor	43K
B64/1	Brake vacuum sensor	4D
B70	Brake vacuum sensor	36C
B70	Crankshaft Hall sensor	7J
B79/3	Crankshaft Hall sensor	39J
B79/3	Manual transmission main shifter shaft position sensor	27C
CAN B	Interior CAN	21C
CAN B	Interior CAN	

Stručné označen Označen f :

CAN B	Interior CAN	28E
CAN B	Interior CAN	59C
CAN B	Interior CAN	53C
CAN B	Interior CAN	60E
CAN C	Drive train CAN	136
CAN C	Drive train CAN	196
CAN C	Drive train CAN	466
CAN C	Drive train CAN	516
CAN E	Chassis CAN	13F
CAN E	Chassis CAN	12C
CAN E	Chassis CAN	8J
CAN E	Chassis CAN	6F
CAN E	Chassis CAN	8C
CAN E	Chassis CAN	19F
CAN E	Chassis CAN	14E
CAN E	Chassis CAN	41J
CAN E1	Chassis CAN 1	40C
CAN E1	Chassis CAN 1	46F
CAN E1	Chassis CAN 1	46E
CAN E1	Chassis CAN 1	45C
CAN E1	Chassis CAN 1	51F
CAN E1	Chassis CAN 1	37F
CAN E2	Chassis CAN 2	34G
Code 218	Backup camera	32A
Code 234	Blind spot assist	32A
Code 239	DISTRONIC PLUS	14A
Code 239	DISTRONIC PLUS	46A
Code 429	Dual clutch transmission	18J
Code 429	Dual clutch transmission	50J
Code 476	Automatic lane detection	32B
Code 494	USA version	5B
Code 494	USA version	37B
Code 513	Speed Limit Assist	32B
Code 614	Bi-xenon headlamp unit	32B
Code 615	Bi-xenon headlamp unit with integrated curve illumination	32C
Code 618	Bi-xenon headlamps	32C
Code 621	Intelligent Light System (left-hand traffic)	32C
Code 622	Intelligent Light System (right-hand traffic)	32C
Code 631	Static LED headlamp, left-hand traffic	32D

Pozice :

Stručné označen Označen f :

	Police :
Code 632	32D
Code B03	5B
Code B03	37B
F58	166
F58	496
F58KM	14J
F58KM	46J
F58KM	146
F58KN	466
F58KN	28J
LIN B15	60J
LIN B15	14K
M1	46K
M1	25J
M3	57J
M3	28F
M3	60F
M10	246
M10	566
N118	9A
N118	41A
N2/10	18B
N2/10	51B
N22/7	9E
N22/7	41E
N3/9	8J
N3/9	41J
N30/4	30B
N30/4	63B
N69/1	28K
N69/1	60K
N72/1	31H
N72/1	31H
N72/1s50	63H
N72/1s50	23B
N73	55B
N73	34H
N80	12A
N80	45A
S40/3	7A

Stručné označen Označení:

Police:

S40/3	Clutch pedal switch	39A
S40/5	Start enable clutch pedal switch	7B
S40/5	Start enable clutch pedal switch	39B
S9/1	Stop lamp switch	11K
S9/1	Stop lamp switch	43K
U24	Valid for manual transmission	4A
U24	Valid for manual transmission	6J
U24	Valid for manual transmission	38J
U24	Valid for manual transmission	37A
U240	Not valid for reversing camera	1A
U297	Not valid for Blind Spot Assist	1B
U315	Valid for engine 651 with EUR06 exhaust treatment	8E
U315	Valid for engine 651 with EUR06 exhaust treatment	40E
U318	Valid for engine 651 with EUR05 exhaust treatment	8E
U318	Valid for engine 651 with EUR05 exhaust treatment	40E
U431	Not valid for Lane Keeping Assist	1B
U434	Not valid for Traffic Sign Assist	1B
U493	Valid for halogen lamp unit	1C
Y3/14n4	Dual clutch transmission fully integrated transmission control unit	20J
Y3/14n4	Dual clutch transmission fully integrated transmission control unit	52J

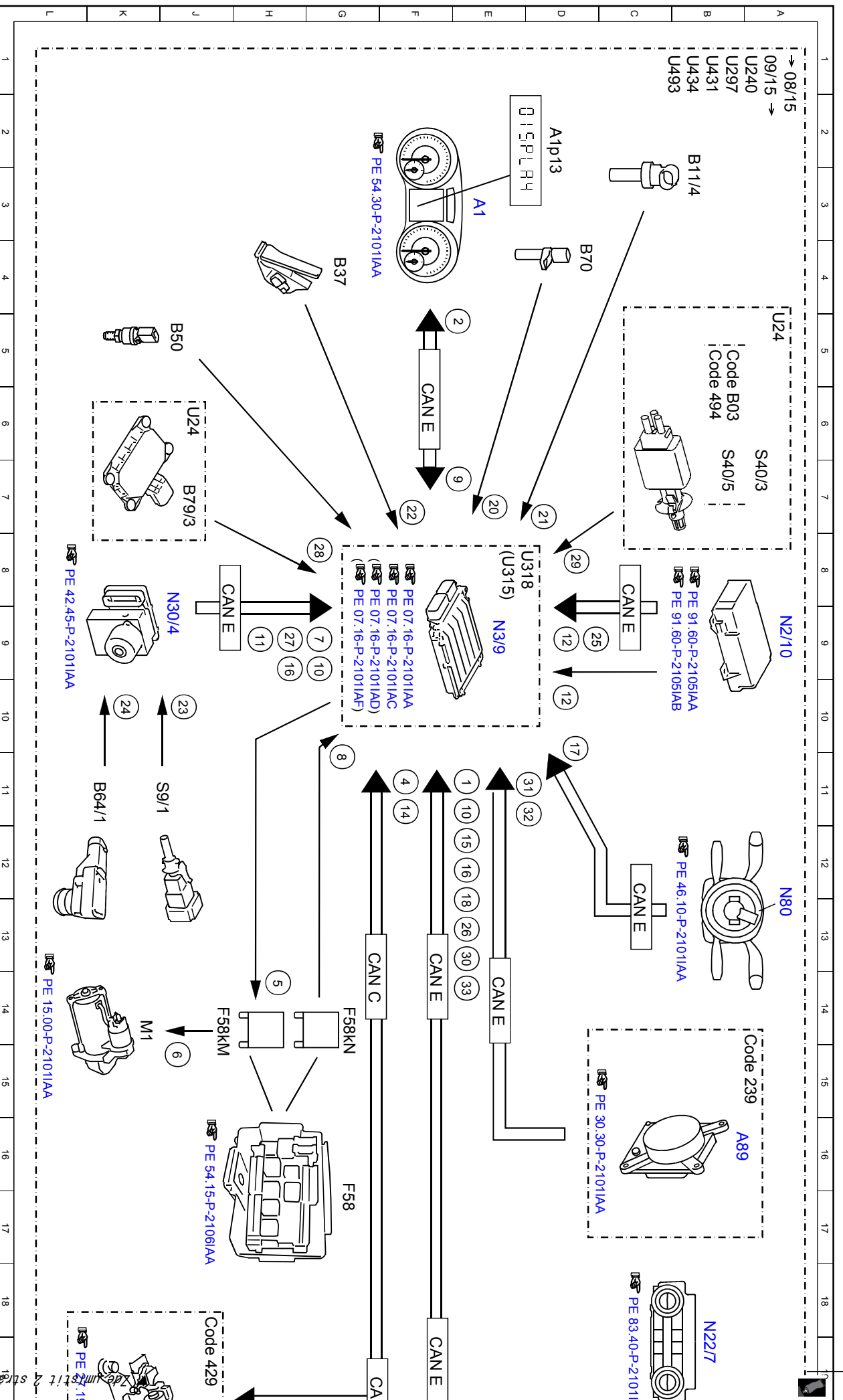

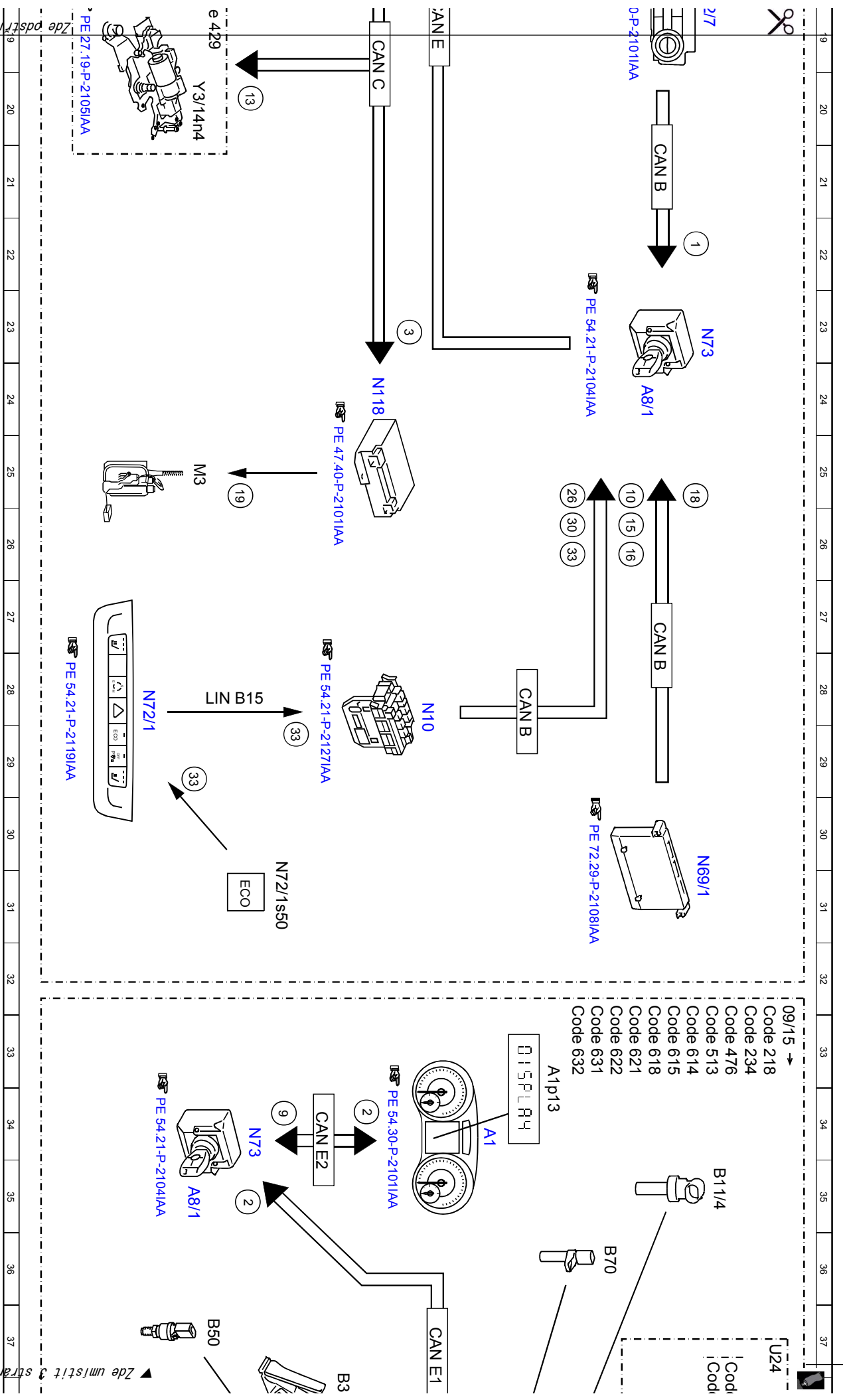

Zde pokračuje stránku

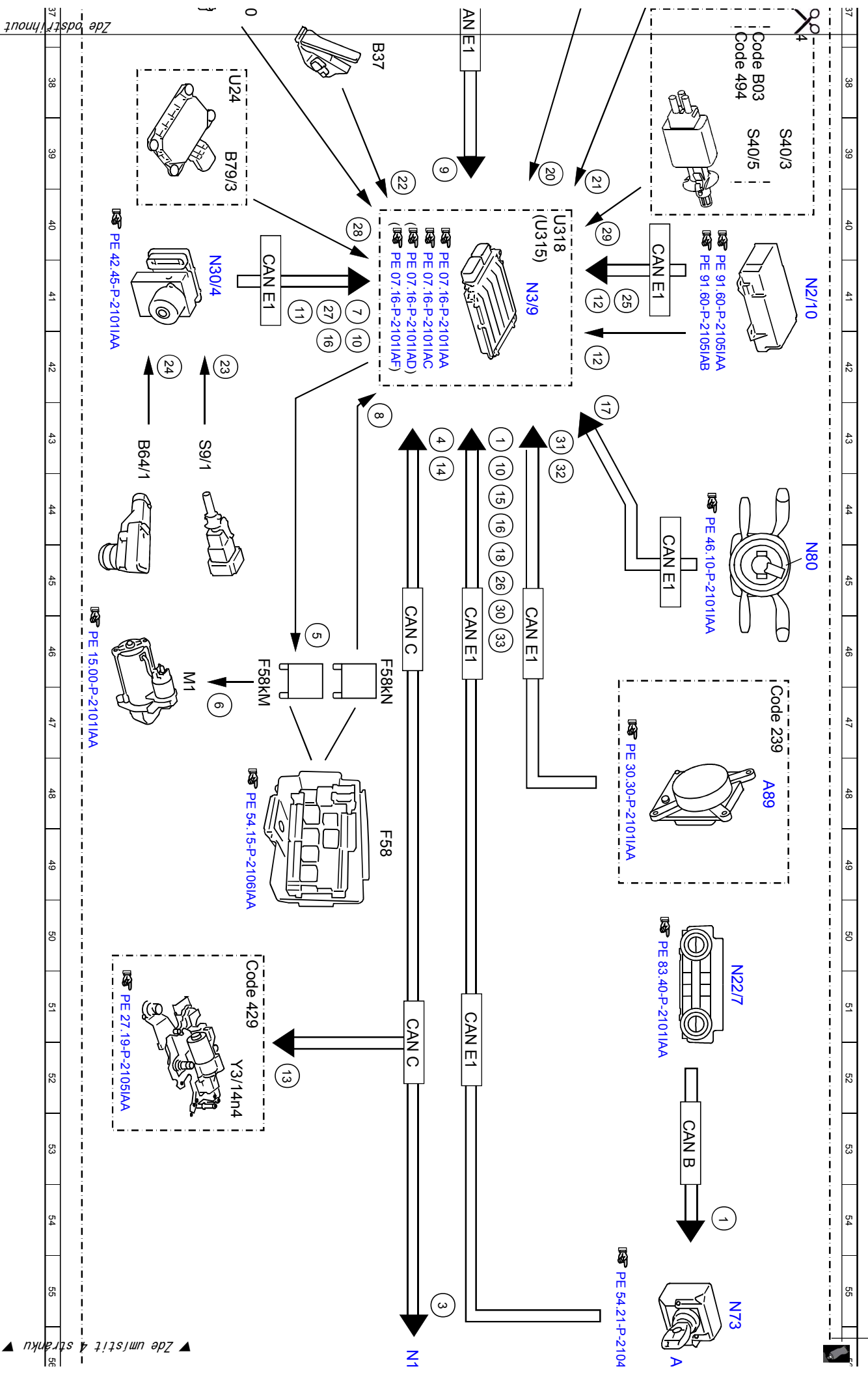

37 38 39 40 41 42 43 44 45 46 47 48 49 50 51 52 53 54 55

Zde odstřihnout

Zde umístít stránku

