

CDX-GT572

SERVICE MANUAL

E Model

Ver. 1.0 2008.04



- The tuner and CD sections have no adjustments.

Model Name Using Similar Mechanism	CDX-GT527EE/ GT570/GT570S
CD Drive Mechanism Type	MG-101TC-188//Q
Optical Pick-up Name	DAX-25A

SPECIFICATIONS

CD Player section

Signal-to-noise ratio: 120 dB

Frequency response: 10 – 20,000 Hz

Wow and flutter: Below measurable limit

Tuner section

FM

Tuning range:

87.5 – 108.0 MHz (at 50 kHz step)

87.5 – 107.9 MHz (at 200 kHz step)

FM tuning interval:

50 kHz/200 kHz switchable

Antenna (aerial) terminal:

External antenna (aerial) connector

Intermediate frequency: 10.7 MHz/450 kHz

Usable sensitivity: 9 dBf

Selectivity: 75 dB at 400 kHz

Signal-to-noise ratio:

67 dB (stereo), 69 dB (mono)

Harmonic distortion at 1 kHz:

0.5 % (stereo), 0.3 % (mono)

Separation: 35 dB at 1 kHz

Frequency response: 30 – 15,000 Hz

MW

Tuning range:

531 – 1,602 kHz (at 9 kHz step)

530 – 1,710 kHz (at 10 kHz step)

MW tuning interval:

9 kHz/10 kHz switchable

Antenna (aerial) terminal:

External antenna (aerial) connector

Intermediate frequency: 10.7 MHz/450 kHz

Sensitivity: 30 μ V

SW

Tuning range:

SW1: 2,940 – 7,735 kHz

SW2: 9,500 – 18,135 kHz

(except for 10,140 – 11,500 kHz)

Antenna (aerial) terminal:

External antenna (aerial) connector

Intermediate frequency: 10.7 MHz/450 kHz

Sensitivity: 30 μ V

Power amplifier section

Outputs: Speaker outputs (sure seal connectors)

Speaker impedance: 4 – 8 ohms

Maximum power output: 52 W \times 4 (at 4 ohms)

General

Output:

Audio outputs terminal (front/rear)

Subwoofer output terminal (mono)

Power antenna (aerial) relay control terminal

Power amplifier control terminal

Inputs:

BUS control input terminal

BUS audio input terminal

Remote controller input terminal

Antenna (aerial) input terminal

AUX input jack (stereo mini jack)

Tone controls:

Low: ± 10 dB at 60 Hz (XPLOD)

Mid: ± 10 dB at 1 kHz (XPLOD)

High: ± 10 dB at 10 kHz (XPLOD)

Power requirements: 12 V DC car battery
(negative ground (earth))

Dimensions: Approx. 178 \times 50 \times 180 mm
(7 $\frac{1}{8}$ \times 2 \times 7 $\frac{1}{8}$ in.) (w/h/d)

Mounting dimensions: Approx.

182 \times 53 \times 162 mm

(7 $\frac{1}{4}$ \times 2 $\frac{1}{8}$ \times 6 $\frac{1}{2}$ in.) (w/h/d)

Mass: Approx. 1.2 kg (2 lb 11 oz)

Supplied accessories:

Card remote commander: RM-X151

Parts for installation and connections (1 set)

Design and specifications are subject to change without notice.

FM/MW/SW COMPACT DISC PLAYER

9-889-086-01

2008D04-1

© 2008.04

Sony Corporation

Audio Business Group

Published by Sony Techno Create Corporation

SONY®

NOTES ON HANDLING THE OPTICAL PICK-UP BLOCK OR BASE UNIT

The laser diode in the optical pick-up block may suffer electrostatic break-down because of the potential difference generated by the charged electrostatic load, etc. on clothing and the human body. During repair, pay attention to electrostatic break-down and also use the procedure in the printed matter which is included in the repair parts. The flexible board is easily damaged and should be handled with care.

NOTES ON LASER DIODE EMISSION CHECK

The laser beam on this model is concentrated so as to be focused on the disc reflective surface by the objective lens in the optical pickup block. Therefore, when checking the laser diode emission, observe from more than 30 cm away from the objective lens.

CAUTION

Use of controls or adjustments or performance of procedures other than those specified herein may result in hazardous radiation exposure.

If the optical pick-up block is defective, please replace the whole optical pick-up block. Never turn the semi-fixed resistor located at the side of optical pick-up block.

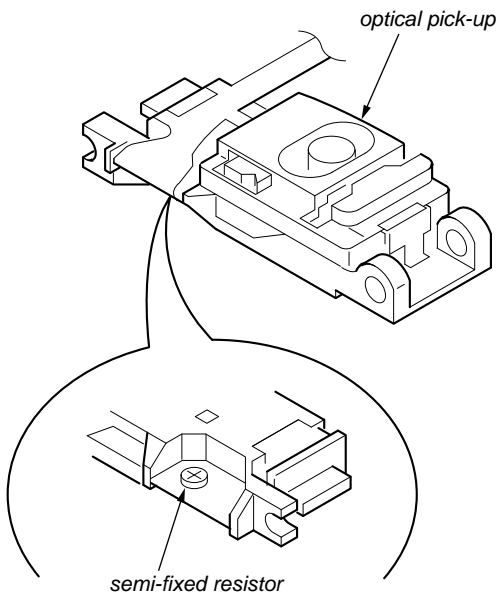

This compact disc player is classified as a CLASS 1 LASER product. The CLASS 1 LASER PRODUCT label is located on the exterior.

**CLASS 1
LASER PRODUCT**

This label is located on the bottom of the chassis.

Notes on chip component replacement

- Never reuse a disconnected chip component.
- Notice that the minus side of a tantalum capacitor may be damaged by heat.

TEST DISCS

Please use the following test discs for the check on the CD section.

- YDES-18 (Part No. 3-702-101-01)
- PATD-012 (Part No. 4-225-203-01)

• CD playback

You can play CD-DA (also containing CD TEXT), CD-R/CD-RW (MP3/WMA files).

Type of discs	Label on the disc
CD-DA	
MP3 WMA	

UNLEADED SOLDER

Boards requiring use of unleaded solder are printed with the lead-free mark (LF) indicating the solder contains no lead. (Caution: Some printed circuit boards may not come printed with the lead free mark due to their particular size)

LF : LEAD FREE MARK

Unleaded solder has the following characteristics.

- Unleaded solder melts at a temperature about 40 °C higher than ordinary solder. Ordinary soldering irons can be used but the iron tip has to be applied to the solder joint for a slightly longer time. Soldering irons using a temperature regulator should be set to about 350 °C. Caution: The printed pattern (copper foil) may peel away if the heated tip is applied for too long, so be careful!
- Strong viscosity. Unleaded solder is more viscous (sticky, less prone to flow) than ordinary solder so use caution not to let solder bridges occur such as on IC pins, etc.
- Usable with ordinary solder. It is best to use only unleaded solder but unleaded solder may also be added to ordinary solder.

SAFETY-RELATED COMPONET WARNING!

COMPONENTS IDENTIFIED BY MARK △ OR DOTTED LINE WITH MARK △ ON THE SCHEMATIC DIAGRAMS AND IN THE PARTS LIST ARE CRITICAL TO SAFE OPERATION. REPLACE THESE COMPONENTS WITH SONY PARTS WHOSE PART NUMBERS APPEAR AS SHOWN IN THIS MANUAL OR IN SUPPLEMENTS PUBLISHED BY SONY.

TABLE OF CONTENTS

1. SERVICE NOTE	4	5. DIAGRAMS	
2. GENERAL		5-1. Block Diagram –Main Section–	17
Location of Controls	5	5-2. Block Diagram –Display Section–	18
Connections	5	5-3. Printed Wiring Board –Main Section–.....	19
3. DISASSEMBLY		5-4. Schematic Diagram –Main Section (1/3)–.....	20
3-1. Sub Panel Assy	8	5-5. Schematic Diagram –Main Section (2/3)–.....	21
3-2. CD Mechanism Block.....	8	5-6. Schematic Diagram –Main Section (3/3)–.....	22
3-3. Main Board	9	5-7. Printed Wiring Boards –Sub Section–	23
3-4. Servo Board	9	5-8. Schematic Diagram –Sub Section–.....	23
3-5. Chassis (T) Sub Assy	10	5-9. Printed Wiring Boards –Key Section–.....	24
3-6. Roller Arm Assy.....	10	5-10. Schematic Diagram –Key Section–	25
3-7. Chassis (OP) Assy.....	11	6. EXPLODED VIEWS	
3-8. Chucking Arm Sub Assy.....	11	6-1. Main Section	29
3-9. Sled Motor Assy.....	12	6-2. Front Panel Section.....	30
3-10. Optical Pick-up Section	13	6-3. CD Mechanism Section (MG-101TC-188//Q)	31
3-11. Optical Pick-up	13	7. ELECTRICAL PARTS LIST	32
4. DIAGNOSIS FUNCTION	14		

SECTION 1 SERVICE NOTE

EXTENSION CABLE AND SERVICE POSITION

When repairing or servicing this set, connect the jig (extension cable) as shown below.

- Connect the MAIN board (CN350) and the SERVO board (CN2) with the extension cable (Part No. J-2502-076-1).

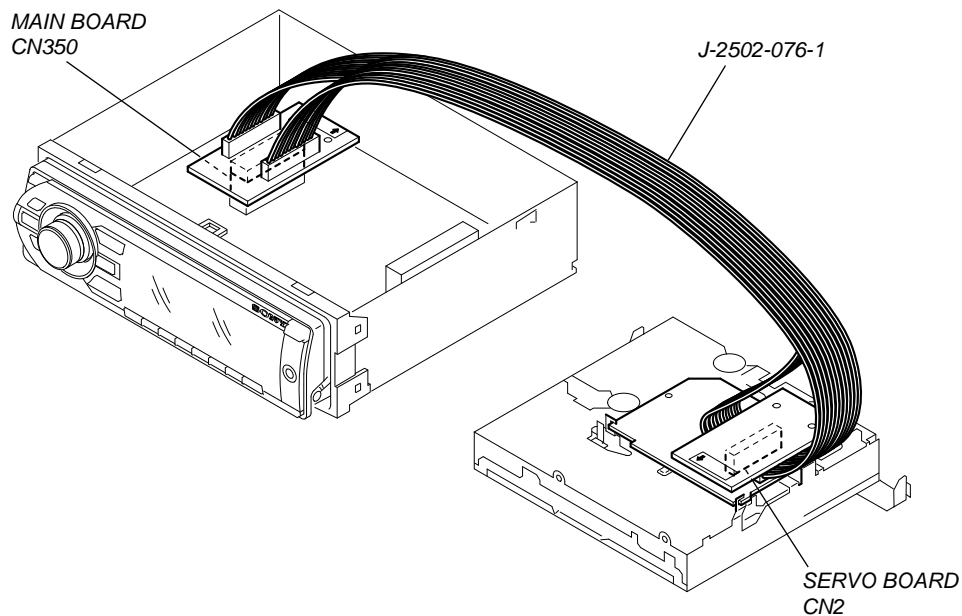

NOTE FOR REPLACEMENT OF THE AUX JACK (J901)

To replace the AUX jack requires alignment.

1. Insert the AUX jack into the KEY board.
2. Place the KEY board on the front panel.
3. Solder the three terminals of the jack.

NOTE FOR REPLACEMENT OF THE SERVO BOARD

When repairing, the complete SERVO board (A-1177-201-A) should be replaced since any parts in the SERVO board cannot be repaired.

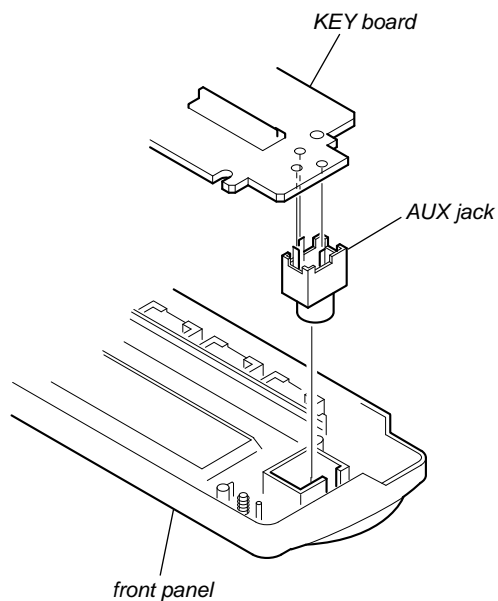

SECTION 2 GENERAL

This section is extracted from instruction manual.

• LOCATION OF CONTROLS

Location of controls and basic operations

Main unit

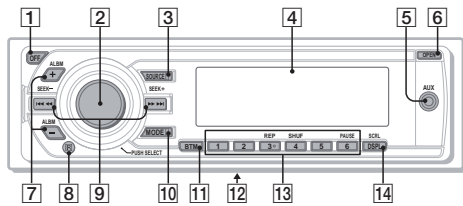

Front panel removed

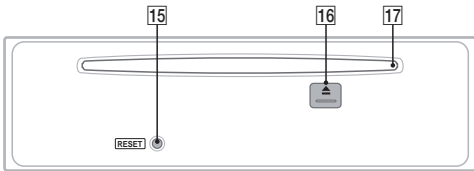

Card remote commander RM-X151

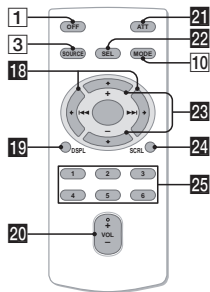

This section contains instructions on the location of controls and basic operations. For details, see the respective pages.

For optional device (CD/MD changer, etc.,) operation, see "Using optional equipment" on page 10. The corresponding buttons on the card remote commander control the same functions as those on the unit.

- 1 **OFF button**
To power off; stop the source.
- 2 **Volume control dial/select button**
page 9
To adjust volume (rotate); select setup items (press and rotate).
- 3 **SOURCE button**
To power on; change the source (Radio/CD/AUX)*.
- 4 **Display window**
- 5 **AUX input jack** page 10
To connect a portable audio device.

- 6 **OPEN button** page 5
- 7 **ALBM +/- buttons** (during MP3/WMA playback)
To skip albums (press); skip albums continuously (press and hold).
- 8 **Receptor for the card remote commander**
- 9 **SEEK +/- buttons**
CD:
To skip tracks (press); skip tracks continuously (press, then press again within about 1 second and hold); reverse/fast-forward a track (press and hold).
Radio:
To tune in stations automatically (press); find a station manually (press and hold).
- 10 **MODE button** page 8
To select the radio band (FM/MW/SW)*.
- 11 **BTM button** page 8
To start the BTM function (press and hold).
- 12 **Frequency select switch** (located on the bottom of the unit)
See "Frequency select switch" in the supplied installation/connections manual.
- 13 **Number buttons**
CD:
③ **REP** page 8
④ **SHUF** page 8
⑥ **PAUSE**
To pause playback of a CD on this unit. To cancel, press again.
Radio:
To receive stored stations (press); store stations (press and hold).
- 14 **DSPL (display)/SCRL (scroll) button** page 8
To change display items (press); scroll the display item (press and hold).
- 15 **RESET button** page 4
To eject the disc.
- 16 **(eject) button** page 5
To eject the disc.
- 17 **Disc slot** page 5
To insert the disc.

The following buttons on the card remote commander have also different buttons/functions from the unit. Remove the insulation film before use (page 4).

- 18 **(SEEK) +/- buttons**
To control CD/radio, the same as (SEEK) +/- on the unit. Setup, sound setting, etc., can be operated by $\leftarrow \rightarrow$.
- 19 **DSPL (display) button**
To change display items.
- 20 **VOL (volume) +/- button**
To adjust volume.
- 21 **ATT (attenuate) button**
To attenuate the sound. To cancel, press again.
- 22 **SEL (select) button**
The same as the select button on the unit.
- 23 **(+/-) (-) buttons**
To control CD, the same as (ALBM) +/- on the unit. Setup, sound setting, etc., can be operated by $\uparrow \downarrow$.
- 24 **SCRL (scroll) button**
To scroll the display item.
- 25 **Number buttons**
To receive stored stations (press); store stations (press and hold).

* In the case of a CD/MD changer being connected, when (SOURCE) is pressed, the connected device ("MD") will appear in the display, depending on which device is connected. Furthermore, if (SEEK) is pressed, you can switch the changer.

Note
If the unit is turned off and the display disappears, it cannot be operated with the card remote commander unless (SOURCE) on the unit is pressed, or a disc is inserted to activate the unit first.

6

7

• CONNECTIONS

2 A

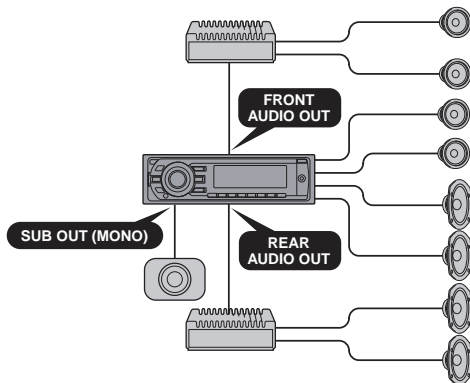

B

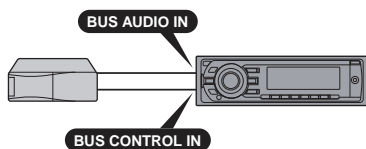

Connection example 2

Notes (2-A)

- Be sure to connect the ground (earth) lead before connecting the amplifier.
- The alarm will only sound if the built-in amplifier is used.

Tip (2-B)

When connecting only a single CD/MD changer or other optional device, connect directly to this unit.

Ejemplo de conexión 2

Notas (2-A)

- Asegúrese de conectar primero el cable de conexión a masa antes de realizar la conexión del amplificador.
- La alarma sonará solamente si se utiliza el amplificador integrado.

Sugerencia (2-B)

Cuando conecte un solo cambiador de CD/MD u otro dispositivo opcional, hágalo directamente a esta unidad.

2 نمونه اتصال

نکات (2-A)

- اطمینان حاصل کنید که سیم زمین (ارت) را پیش از وصل کردن تقویت کننده وصل کنید.
- تنها در صورتی که تقویت کننده داخلی مورد استفاده قرار گیرد زنگ به صدا در خواهد آمد.

اشاره (2-B)

هنگام اتصال تنها یک مبدل CD/MD یا دستگاه اختیاری دیگر، مستقیماً به این دستگاه وصل کنید.

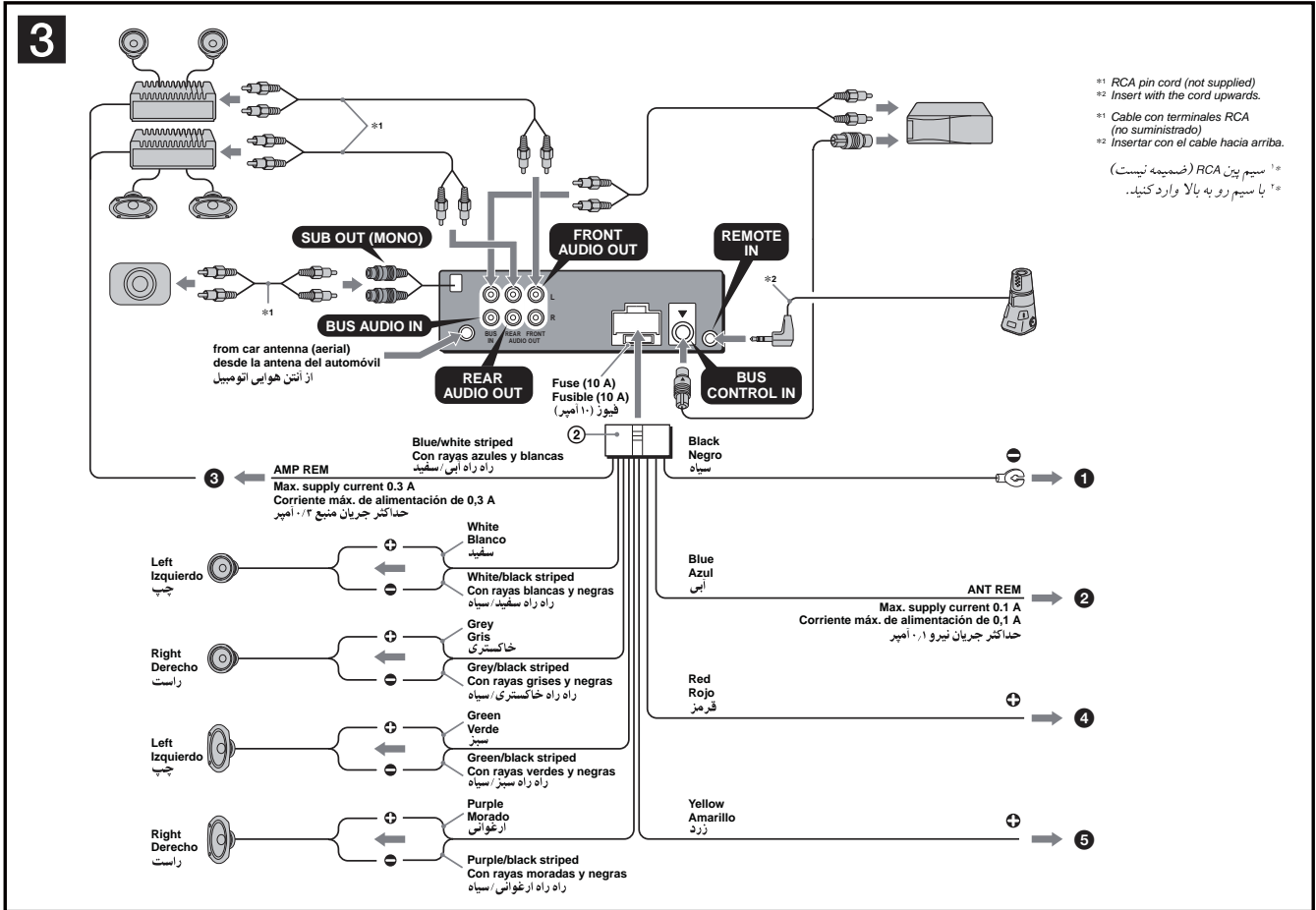

*1 RCA pin cord (not supplied)
 *2 Insert with the cord upwards.
 *3 Cable con terminales RCA (no suministrado)
 *4 Insertar con el cable hacia arriba.
 *5 سیم پین RCA (ضمیمه نیست)
 *6 با سیم رو به بالا وارد کنید.

3 Connection diagram

- To a metal surface of the car**
 First connect the black ground (earth) lead, then connect the yellow and red power supply leads.
- To the power antenna (aerial) control lead or power supply lead of antenna (aerial) booster**
 Notes
 • It is not necessary to connect this lead if there is no power antenna (aerial) or antenna (aerial) booster, or with a manually-operated telescopic antenna (aerial).
 • When your car has a built-in FM/MW/SW antenna (aerial) in the rear-side glass, see "Notes on the control and power supply leads".
- To AMP REMOTE IN of an optional power amplifier**
 This connection is only for amplifiers. Connecting any other system may damage the unit.
- To the +12 V power terminal which is energized in the accessory position of the ignition switch**
 Notes
 • If there is no accessory position, connect to the +12 V power (battery) terminal which is energized at all times.
 • Be sure to connect the black ground (earth) lead to a metal surface of the car first.
 • When your car has a built-in FM/MW/SW antenna (aerial) in the rear-side glass, see "Notes on the control and power supply leads".
- To the +12 V power terminal which is energized at all times**
 Be sure to connect the black ground (earth) lead to a metal surface of the car first.

Notes on the control and power supply leads

- The power antenna (aerial) control lead (blue) supplies +12 V DC when you turn on the tuner.
- When your car has built-in FM/MW/SW antenna (aerial) in the rear-side glass, connect the power antenna (aerial) control lead (blue) or the accessory power supply lead (red) to the power terminal of the existing antenna (aerial) booster. For details, consult your dealer.
- A power antenna (aerial) without a relay box cannot be used with this unit.

Memory hold connection
 When the yellow power supply lead is connected, power will always be supplied to the memory circuit even when the ignition switch is turned off.

Notes on speaker connection

- Before connecting the speakers, turn the unit off.
- Use speakers with an impedance of 4 to 8 ohms, and with adequate power handling capacities to avoid its damage.
- Do not connect the speaker terminals to the car chassis, or connect the terminals of the right speakers with those of the left speaker.
- Do not connect the ground (earth) lead of this unit to the negative (-) terminal of the speaker.
- Do not attempt to connect the speakers in parallel.
- Connect only passive speakers. Connecting active speakers (with built-in amplifiers) to the speaker terminals may damage the unit.
- To avoid a malfunction, do not use the built-in speaker leads installed in your car if the unit shares a common negative (-) lead for the right and left speakers.
- Do not connect the unit's speaker leads to each other.

Note on connection
 If speaker and amplifier are not connected correctly, "FAILURE" appears in the display. In this case, make sure the speaker and amplifier are connected correctly.

3 Diagrama de conexión

- A una superficie metálica del automóvil**
 Conecte primero el cable de conexión a masa negro, y después los cables amarillo y rojo de entrada de alimentación.
- Al cable de control de la antena motorizada o al cable de fuente de alimentación del amplificador de señal de la antena**
 Notes
 • Si no se dispone de antena motorizada ni de amplificador de alimentación de una antena telescópica accionada manualmente, no será necesario conectar este cable.
 • Si el automóvil dispone de una antena de FM/MW/SW integrada en el cristal trasero o lateral, consulte "Notas sobre los cables de control y de fuente de alimentación".
- A AMP REMOTE IN de un amplificador de potencia opcional**
 Esta conexión es solamente para amplificadores. La conexión de cualquier otro sistema puede dañar la unidad.
- Al terminal de alimentación de +12 V que recibe energía en la posición de accesorios del interruptor de la llave de encendido**
 Notes
 • Si no hay posición de accesorios, conéctelo al terminal de alimentación (batería) de +12 V que recibe energía sin interrupción.
 • Asegúrese de conectar primero el cable de conexión a masa negro a una superficie metálica del automóvil.
 • Si el automóvil dispone de una antena de FM/MW/SW integrada en el cristal trasero o lateral, consulte "Notas sobre los cables de control y de fuente de alimentación".
- Al terminal de alimentación de +12 V que recibe energía sin interrupción**
 Asegúrese de conectar primero el cable de conexión a masa negro a una superficie metálica del automóvil.

Notes sobre los cables de control y de fuente de alimentación

- El cable de control de la antena motorizada (azul) suministra cc de +12 V cuando conecte la alimentación del sintonizador.
- Si el automóvil dispone de una antena de FM/MW/SW integrada en el cristal trasero o lateral, conecte el cable de control de antena motorizada (azul) o el cable de entrada de alimentación auxiliar (rojo) al terminal de alimentación del amplificador de antena externa. Para obtener más información, consulte a su distribuidor.
- Con esta unidad no es posible utilizar una antena motorizada sin caja de relé.

Conexión para protección de la memoria
 Si conecta el cable de entrada de alimentación amarillo, el circuito de la memoria recibirá siempre alimentación, aunque apague el interruptor de la llave de encendido.

Notas sobre la conexión de los altavoces

- Antes de conectar los altavoces, desconecte la alimentación de la unidad.
- Utilice altavoces con una impedancia de 4 a 8 Ω con la capacidad de potencia adecuada para evitar que se dañen.
- No conecte los terminales de altavoz al chasis del automóvil, ni conecte los terminales del altavoz derecho con los del izquierdo.
- No conecte el cable de conexión a masa de esta unidad al terminal negativo (-) del altavoz.
- No intente conectar los altavoces en paralelo.
- Conecte solamente altavoces pasivos. Si conecta altavoces activos (con amplificadores integrados) a los terminales de altavoz, puede dañar la unidad.
- Para evitar fallos de funcionamiento, no utilice los cables de altavoz integrados instalados en el automóvil si la unidad comparte un cable negativo común (-) para los altavoces derecho e izquierdo.
- No conecte los cables de altavoz de la unidad entre sí.

Note sobre la conexión
 Si el altavoz y el amplificador no están conectados correctamente, aparecerá "FAILURE" en la pantalla. Si es así, compruebe la conexión de ambos dispositivos.

3 نمودار اتصال

- به یک سطح فلزی اتومبیل**
 ابتدا سیم سیاه زمین را وصل کنید، سپس سیم های ورودی زرد و قرمز را وصل کنید.
- به سیم کنترل آنتن هوائی برقی یا سیم منبع برق تقویت کننده هوائی**
 نکات
 • در صورتی که آنتن هوائی برقی یا تقویت کننده هوائی وجود ندارد، یا با آنتن هوائی تلسکوپی دستی وصل کردن این سیم ضروری نیست.
 • هنگامی که اتومبیل شما دارای یک آنتن هوائی FM/MW/SW در شیشه عقبی/کناری می باشد، "نکات در مورد سیم های کنترل و منبع برق" را مطالعه نمایید.
- به AMP REMOTE IN یک تقویت کننده نیرو اختیاری**
 این اتصال تنها برای تقویت کننده ها است. وصل کردن هر سیستم دیگری ممکن است دستگاه را خراب کند.
- به تریمینال برق +12 ولت که در موقعیت جانی کلید احتراق نیرو می گیرد**
 نکات
 • اگر موقعیت جانی وجود ندارد، به تریمینال برق (باتری) +12 ولت که همواره نیرو می گیرد وصل کنید. اطمینان حاصل کنید که ابتدا سیم سیاه زمین را به سطح فلزی اتومبیل وصل کنید.
 • هنگامی که اتومبیل شما دارای یک آنتن هوائی FM/MW/SW در شیشه عقبی/کناری می باشد، "نکات در مورد سیم های کنترل و منبع برق" را مطالعه نمایید.
- به تریمینال برق +12 ولت که همواره نیرو می گیرد**
 اطمینان حاصل کنید که ابتدا سیم سیاه زمین را به سطح فلزی اتومبیل وصل کنید.

نکات در مورد سیم های کنترل و منبع برق

- هنگامی که شما موج سیاه را روشن می کنید سیم کنترل آنتن هوائی برقی (آبی) برق مستقیم +12 ولت را تأمین می کند.
- هنگامی که اتومبیل شما دارای یک آنتن هوائی FM/MW/SW در شیشه عقبی/کناری می باشد، سیم کنترل آنتن هوائی برقی (آبی) یا سیم منبع برق جانی (قرمز) را به تریمینال برق تقویت کننده آنتن هوائی موجود در اتومبیل وصل کنید. برای جزئیات، با فروشنده خود مشورت نمایید.
 • یک آنتن هوائی بدون یک ایستگاه تقویت نمی تواند با این دستگاه مورد استفاده قرار گیرد.

اتصال حفظ حافظه
 هنگامی که سیم منبع برق زرد وصل می شود، برق همیشه به مدار حافظه حتی هنگامی که سوئیچ احتراق خاموش است تأمین خواهد شد.

نکات در مورد اتصال بلندگو

- پیش از وصل کردن بلندگوها، دستگاه را خاموش کنید.
- از بلندگوها یا امپدانس 4 تا 8 اهم، و با ظرفیت بالای برق استفاده کنید تا از صدمه به آن جلوگیری کنید.
- تریمینال های بلندگو را به شاسی اتومبیل وصل نکنید، یا تریمینال های بلندگوهای راست را به تریمینال های بلندگوهای چپ وصل نکنید.
- سیم زمین این دستگاه را به تریمینال منفی (-) بلندگو وصل نکنید.
- سعی نکنید بلندگوها را بطور موازی وصل کنید.
- تنها بلندگوهای غیر فعال را وصل کنید. وصل کردن بلندگوهای فعال (با تقویت کننده های داخلی) به تریمینال های بلندگو ممکن است به دستگاه صدمه وارد کند. برای اجتناب از یک سوء عملکرد، از سیم های بلندگوی داخلی نصب شده در اتومبیل خود در صورتی که دستگاه دارای یک سیم منفی (-) مشترک برای بلندگوهای راست و چپ می باشد استفاده نکنید.
 • سیم های بلندگوی دستگاه را به یکدیگر وصل نکنید.

توجه در مورد اتصال
 اگر بلندگو بطور صحیح وصل نشده باشد، "FAILURE" در صفحه نمایش ظاهر می شود. در چنین حالتی، اطمینان حاصل کنید که بلندگو بطور صحیح نصب شده است.

SECTION 3 DISASSEMBLY

- This set can be disassembled in the order shown below.

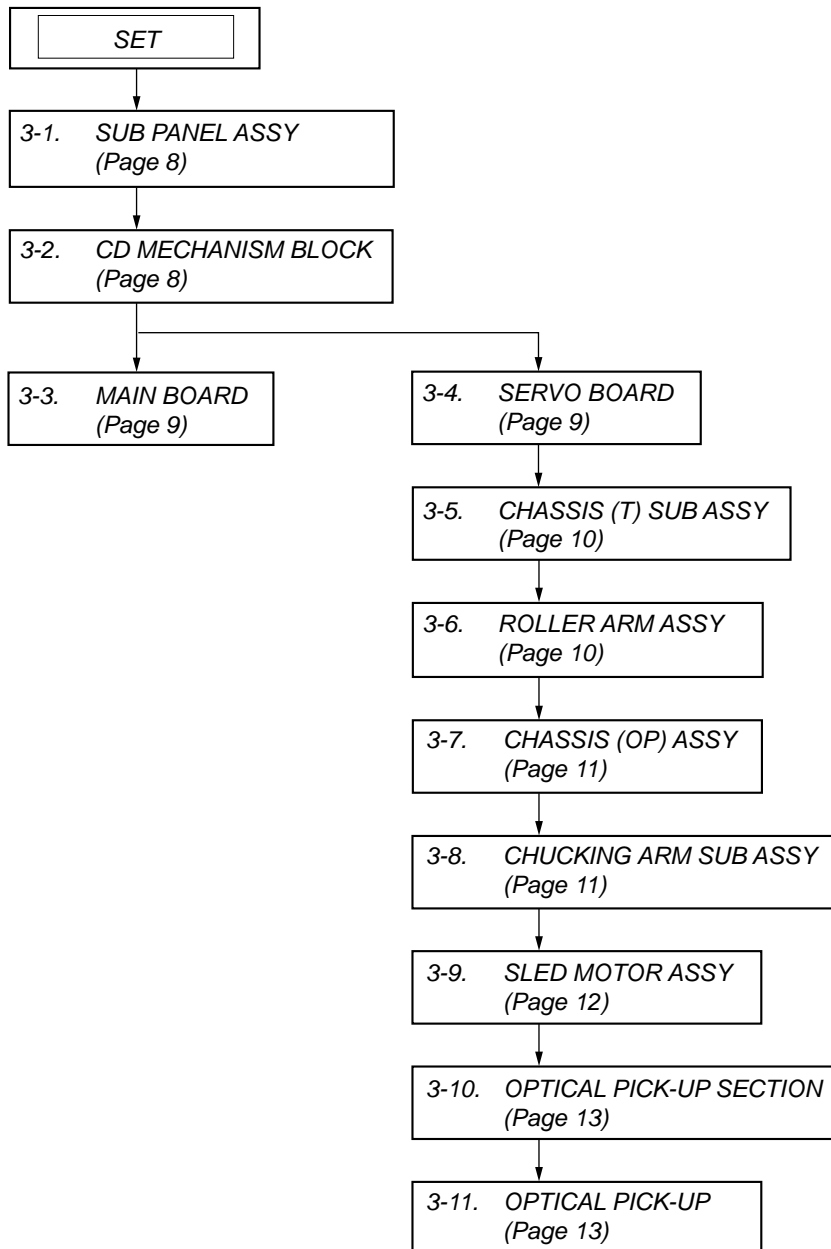

Note: Follow the disassembly procedure in the numerical order given.

3-1. SUB PANEL ASSY

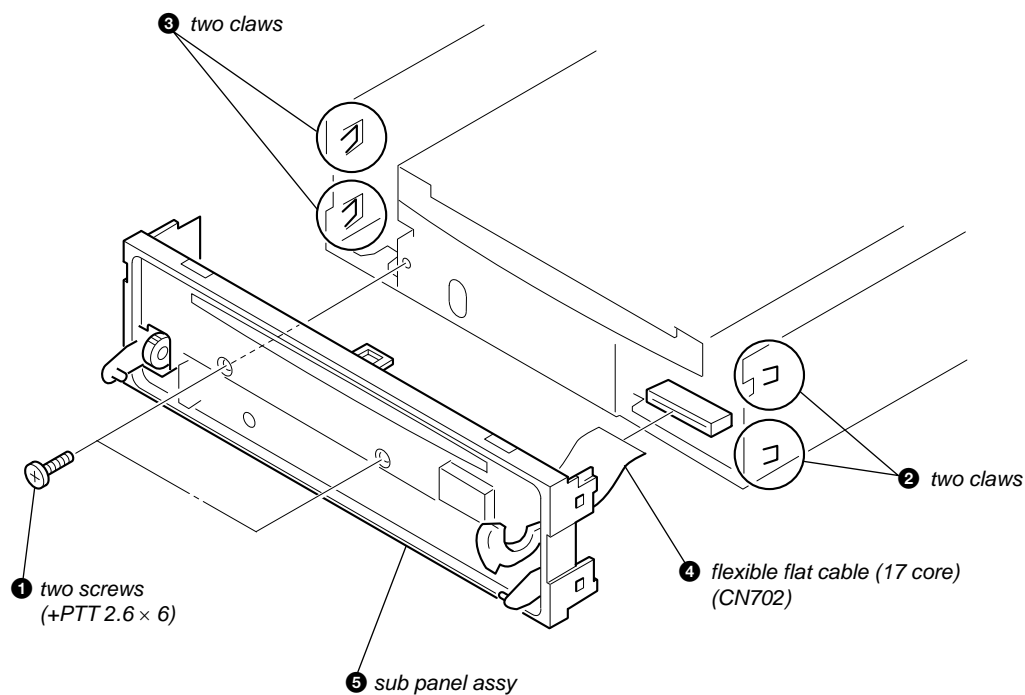

3-2. CD MECHANISM BLOCK

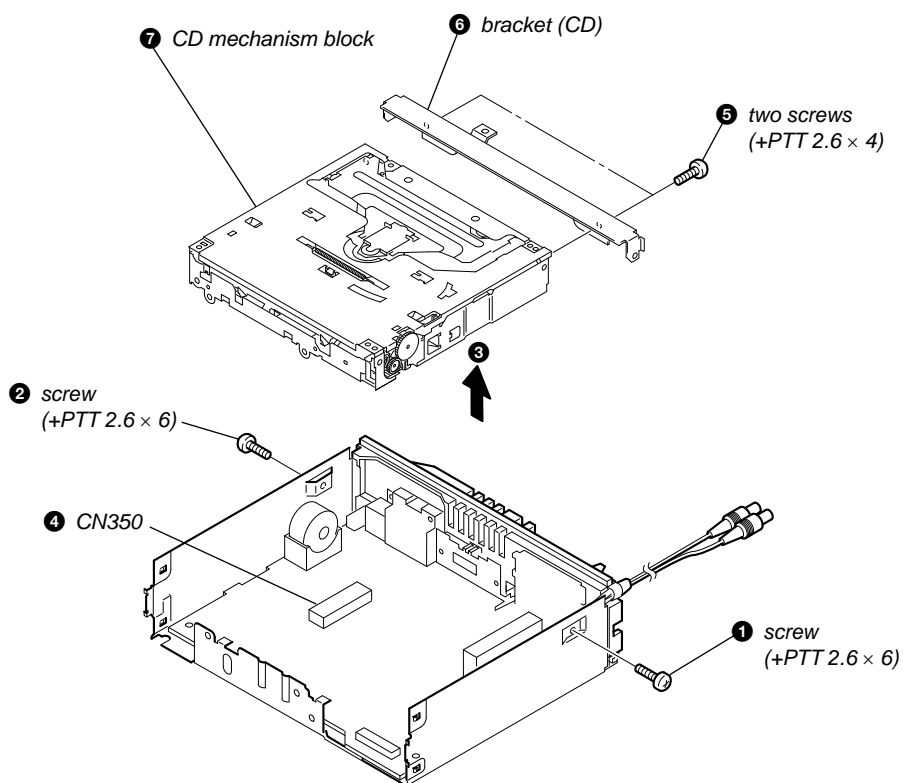

3-3. MAIN BOARD

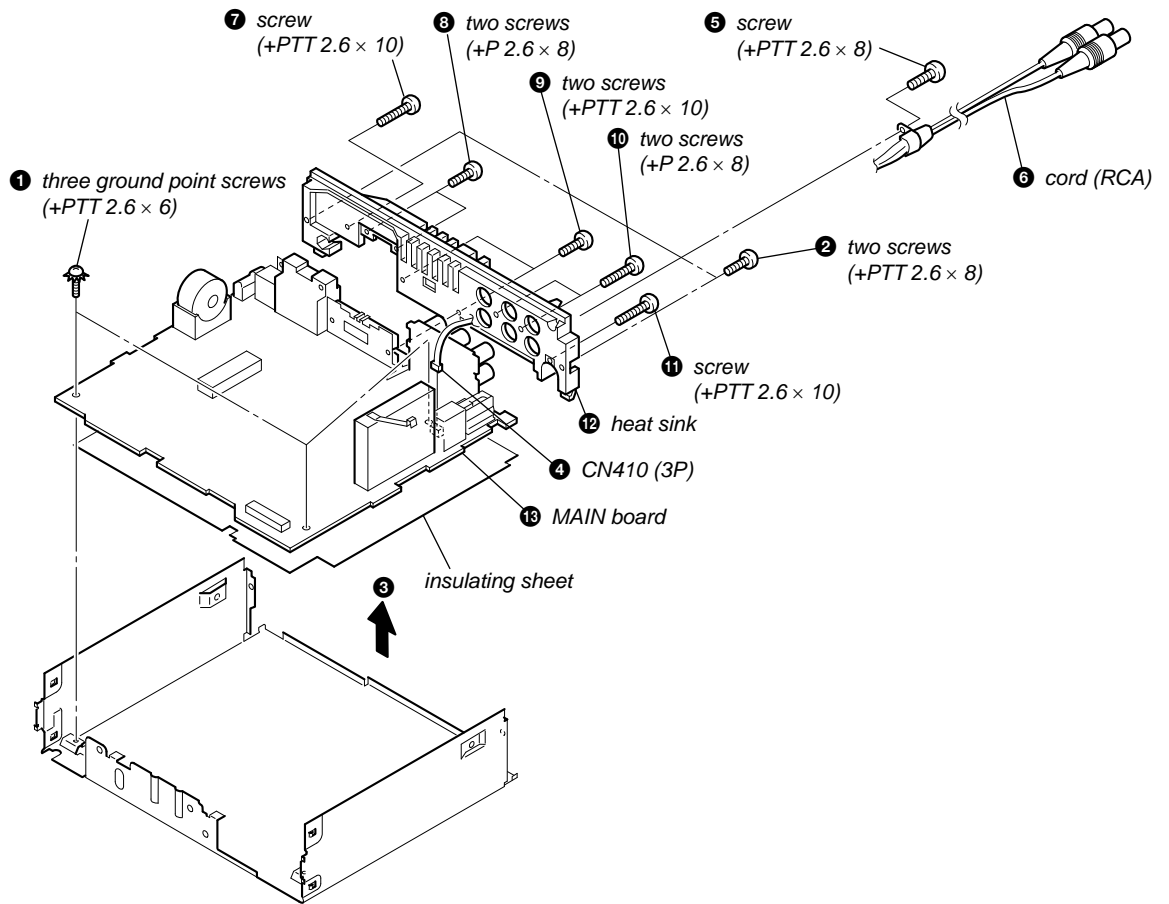

3-4. SERVO BOARD

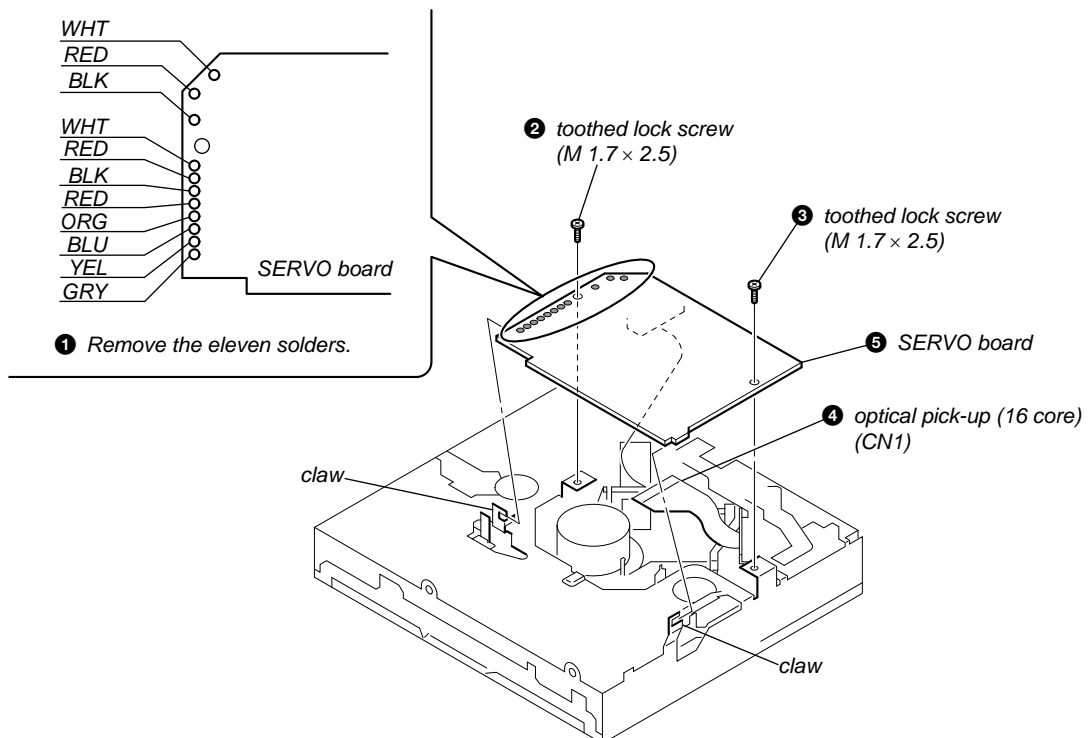

3-5. CHASSIS (T) SUB ASSY

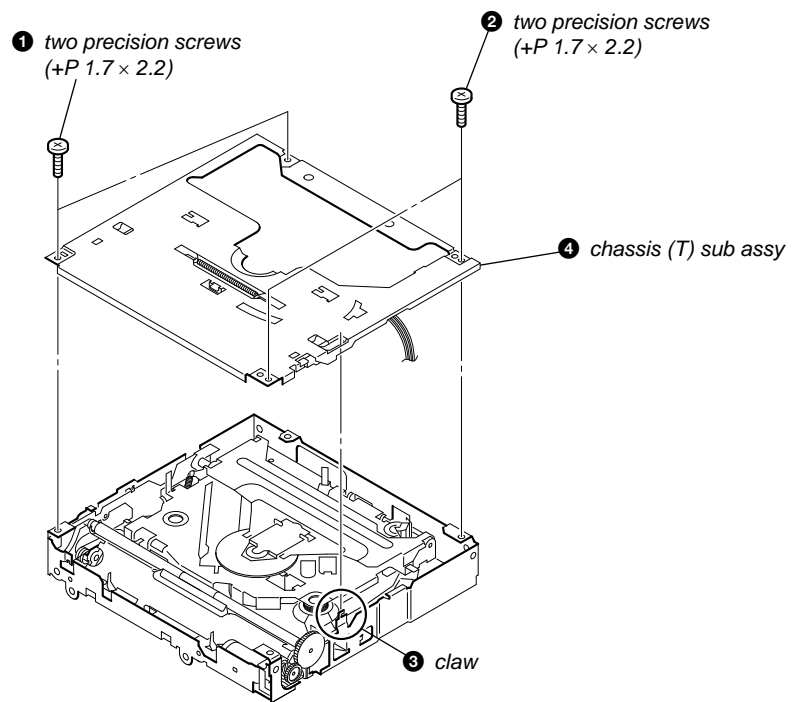

3-6. ROLLER ARM ASSY

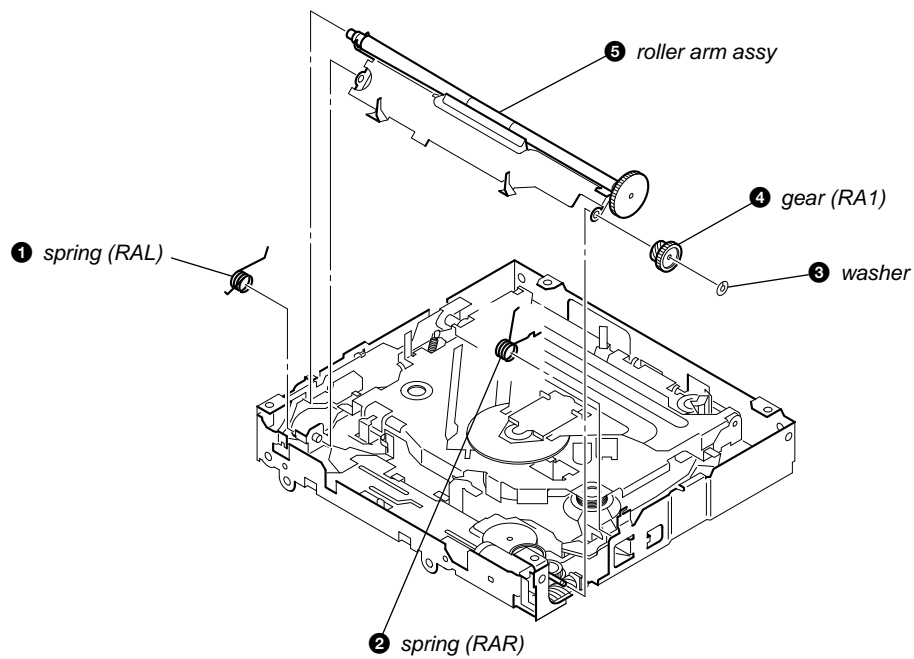

3-7. CHASSIS (OP) ASSY

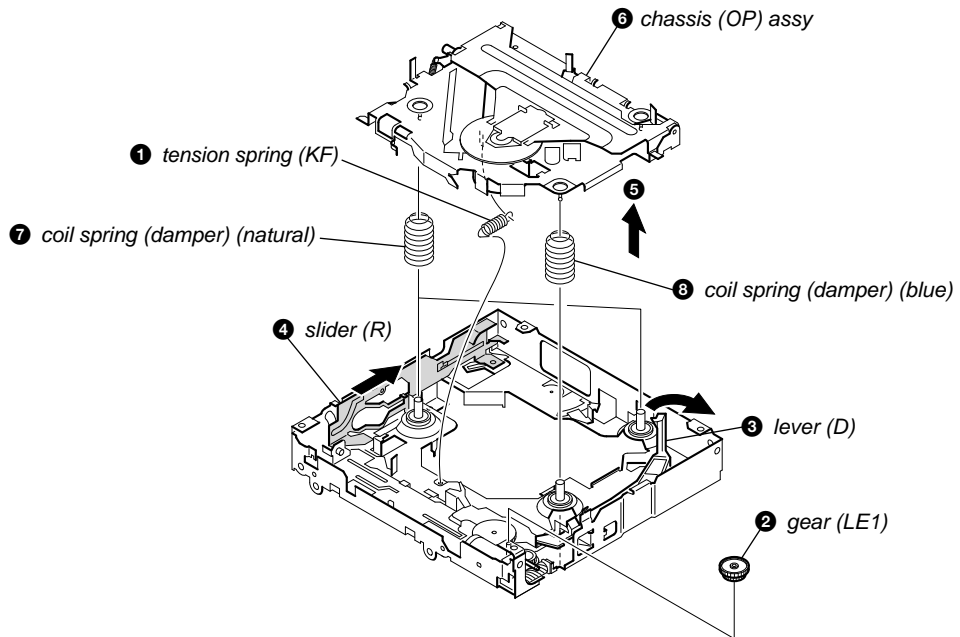

3-8. CHUCKING ARM SUB ASSY

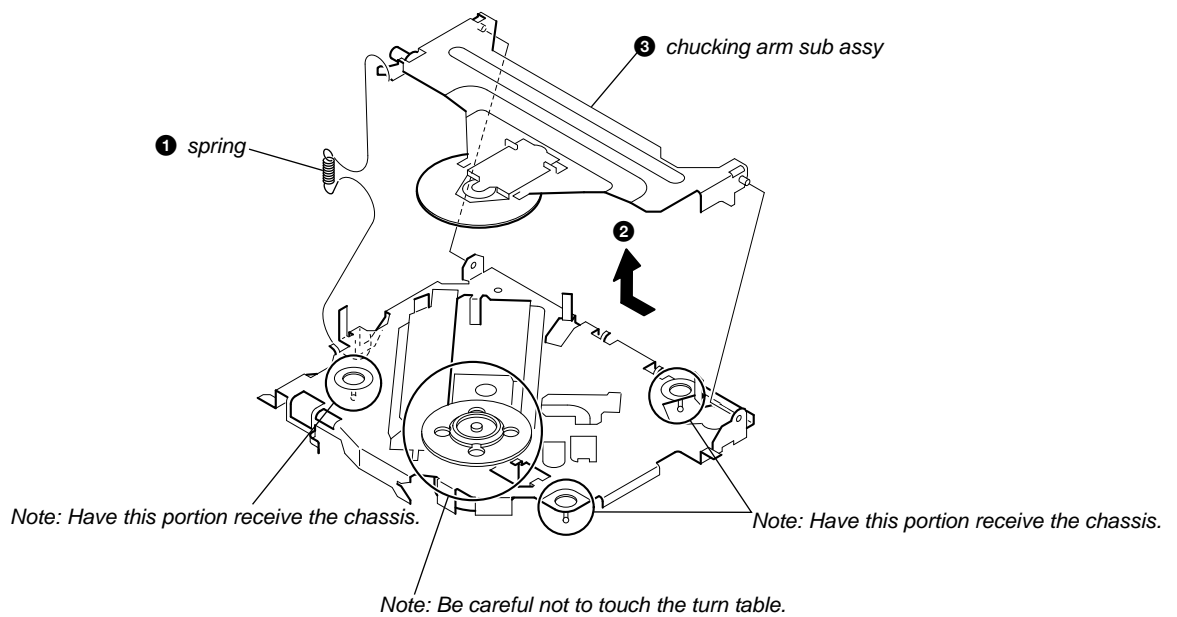

3-9. SLED MOTOR ASSY

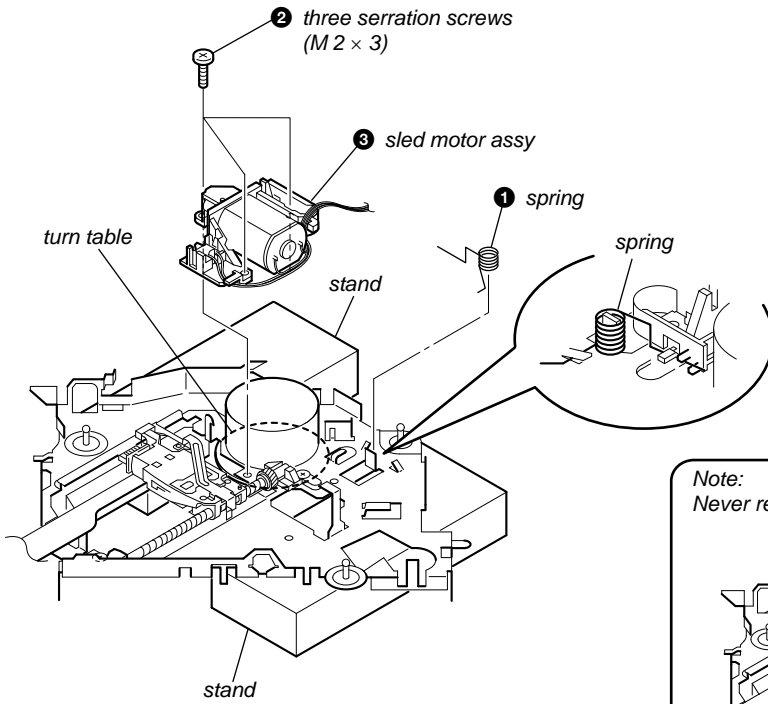

Note: Place the stand with care not to touch the turn table.

Note:
Never remove these parts since they were adjusted.

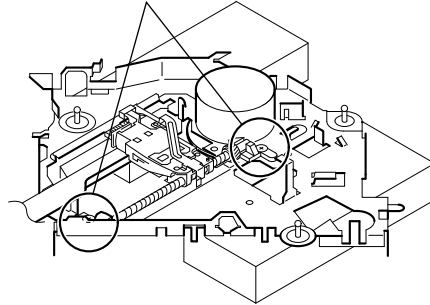

Note for Assembly

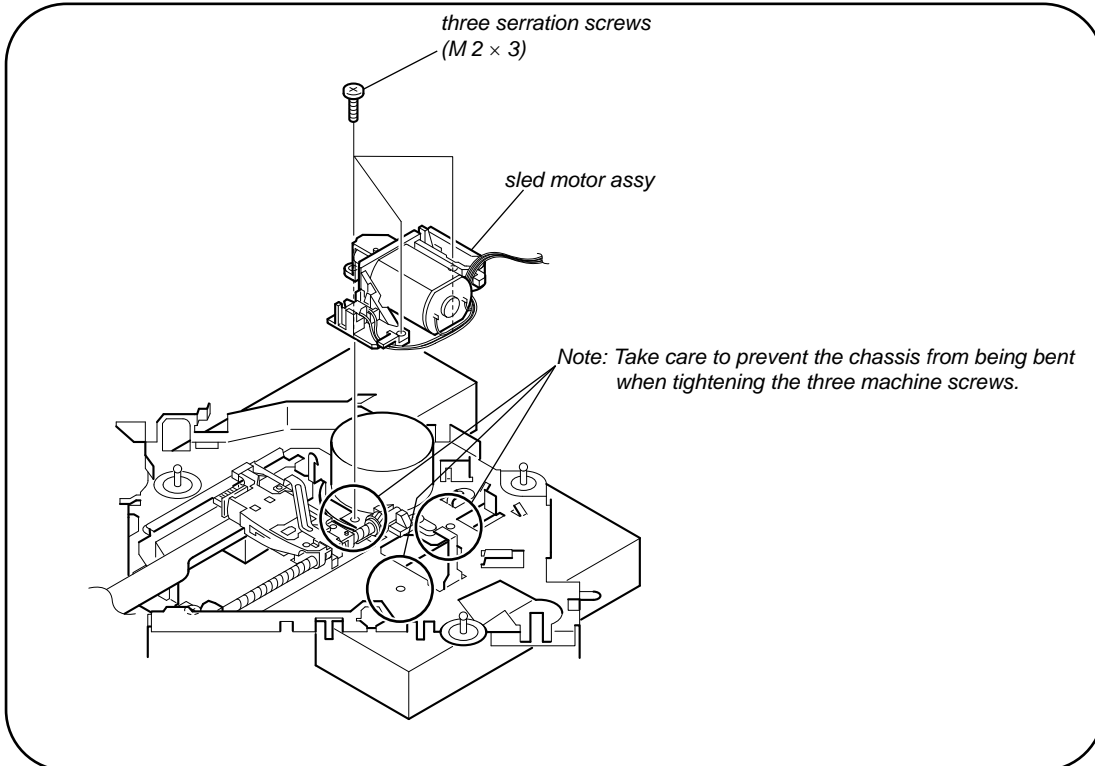

3-10. OPTICAL PICK-UP SECTION

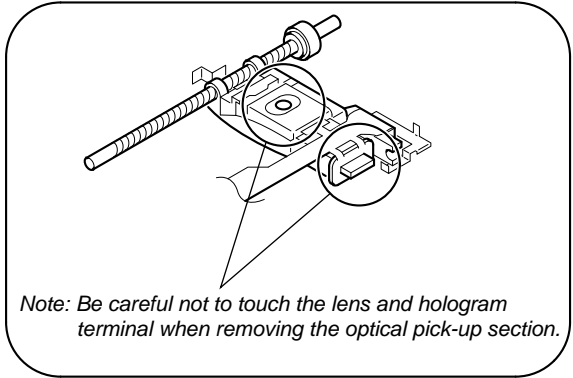
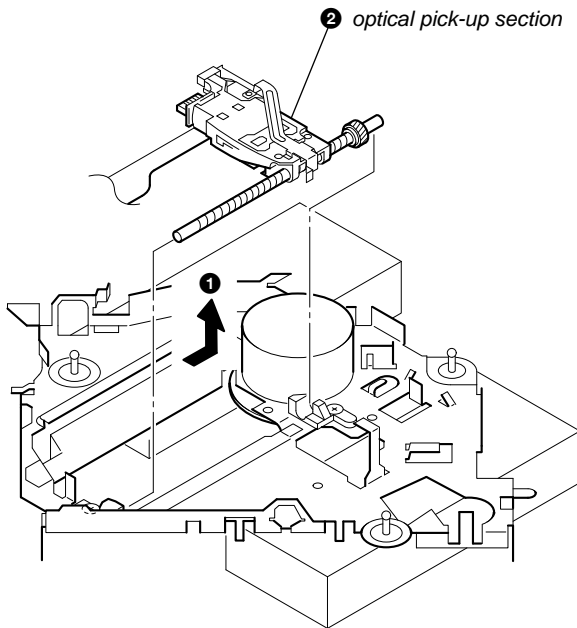

3-11. OPTICAL PICK-UP

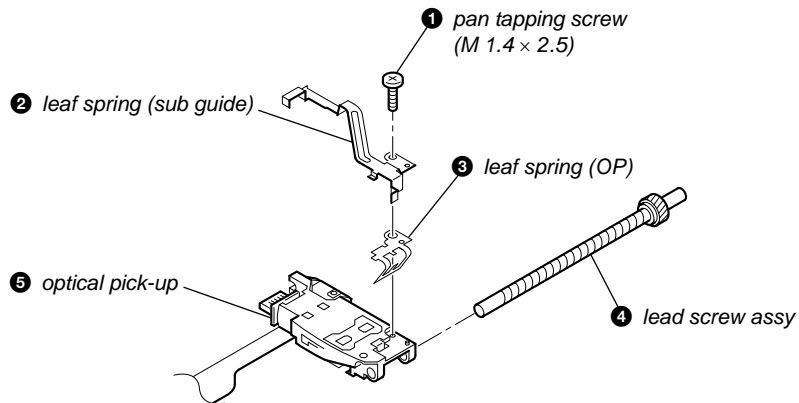

Notes for Assembly

Prevent the end of the leaf spring (sub guide) from being in contact with the OP slide base.

Prevent the end of the leaf spring (sub guide) from being in contact with the OP slide base.

There is space at the end of the leaf spring (sub guide) to avoid contact with the slide.

SECTION 4 DIAGNOSIS FUNCTION

Description of the Diagnostics function:

1. Setting the Diag display mode

With the power off, press the [4/SHUF] button, [5] button, and [4/SHUF] button on the set body or the remote control (for more than 2 seconds) in turn.

2. Canceling the Diag display mode

During the Diag function mode, press the [OFF] button.

3. Initial display in the Diag display mode

Just when the Diag mode is entered, "reset count" is displayed. The display mode is switched by each rotation of [SEEK +/▶▶▶▶] or [SEEK -/◀◀◀◀] buttons.

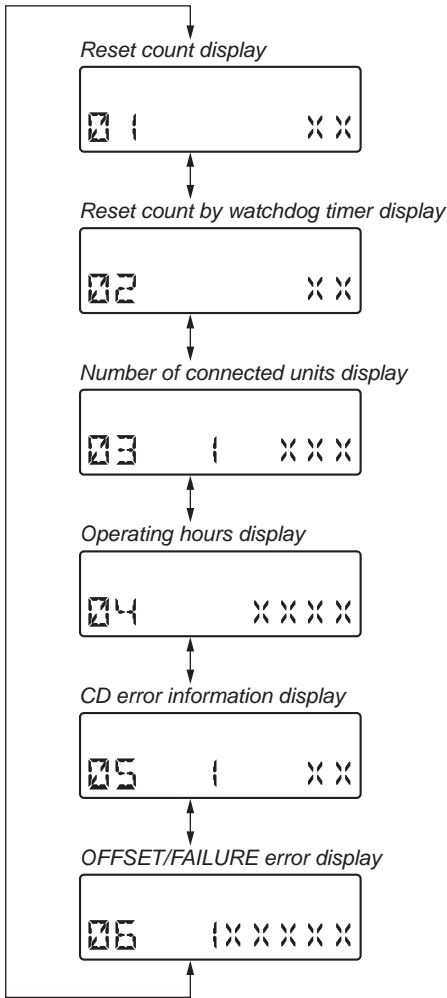

4. Contents of each display mode

4-1. Reset count display mode

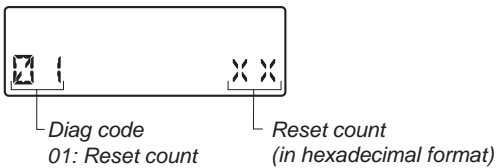

4-2. Reset count by watchdog timer display mode

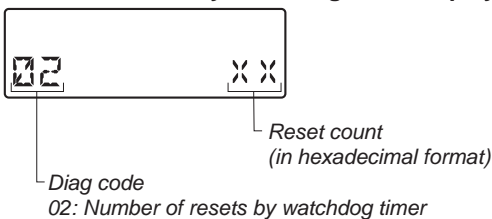

4-3. Number of connected units display mode

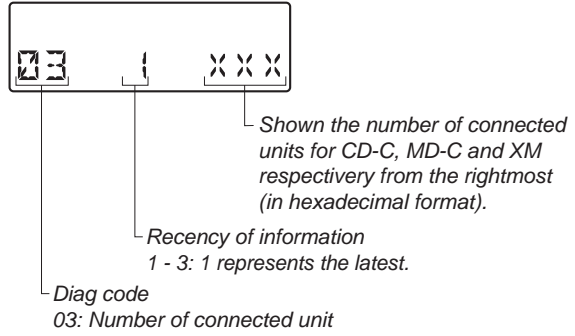

The display mode is switched by each rotation of [ALBM+] or [ALBM-] buttons during the number of connected units display mode.

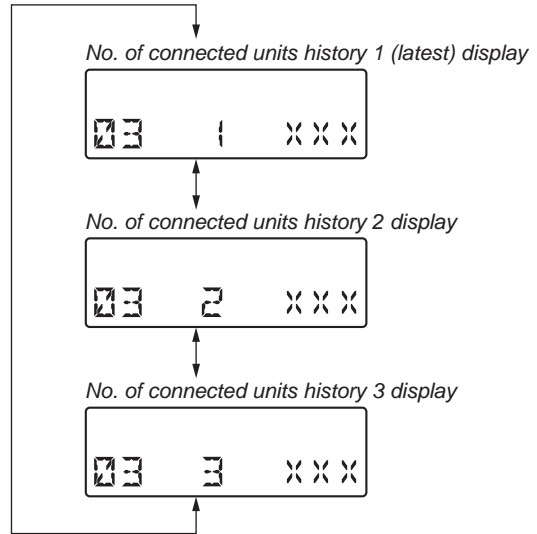

4-4. Operating hours display mode

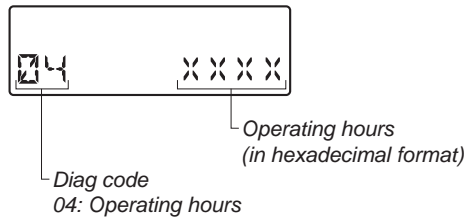

4-5. CD error information display mode

4-5-1. Error description

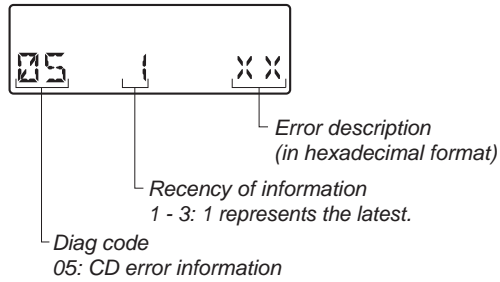

Error information

Indication	Description
1X	SERVO ERROR
3X	LOADING ERROR
4X	TRACK JUMP
5X	TEXT ERROR
FX	MECHA ERROR

4-5-2. Disc type and operating hours

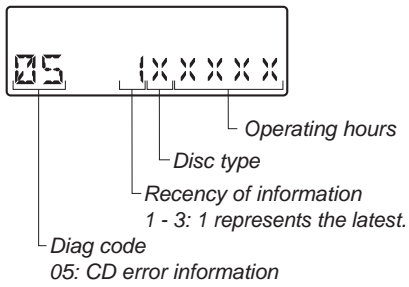

Disc type

Indication	Disc type
0	MP3
1	WMA
2	AAC
3	ATRAC
8	CD-DA
F	UNKNOWN

The display mode is switched by each rotation of [ALBM+] or [ALBM-] buttons during the CD error information display mode.

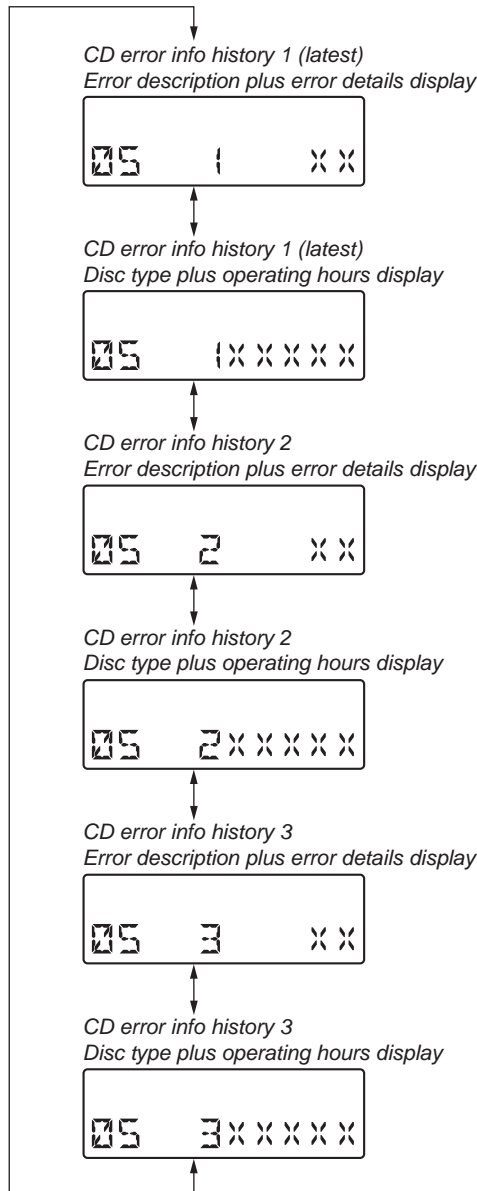

4-6. OFFSET/FAILURE error display mode

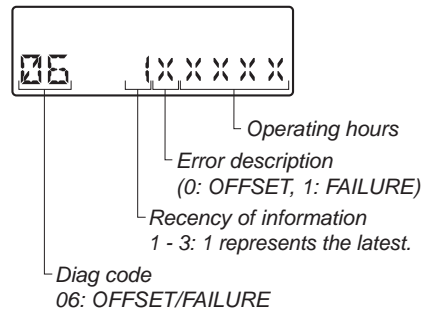

The display mode is switched by each rotation of [ALBM+] or [ALBM-] buttons during the OFFSET/FAILURE error display mode.

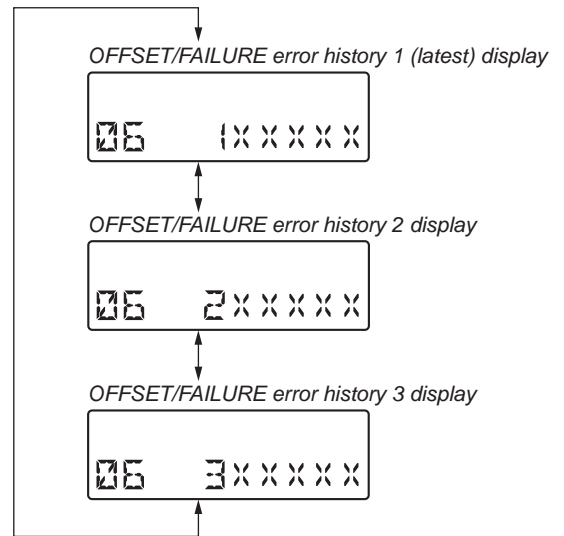

SECTION 5 DIAGRAMS

**THIS NOTE IS COMMON FOR PRINTED WIRING BOARDS AND SCHEMATIC DIAGRAMS.
(In addition to this, the necessary note is printed in each block.)**

For Schematic Diagram.

Note:

- All capacitors are in μF unless otherwise noted. (p: pF)
50 WV or less are not indicated except for electrolytics and tantalums.
- All resistors are in Ω and 1/4 W or less unless otherwise specified.
- \triangle : internal component.
- : panel designation.

Note: The components identified by mark \triangle or dotted line with mark \triangle are critical for safety.
Replace only with part number specified.

- — : B+ Line.
- - - - : B- Line.
- Voltages and waveforms are dc with respect to ground under no-signal (detuned) conditions.
no mark : FM
() : MW
< > : CD PLAY
- Voltages are taken with a VOM (Input impedance 10 M Ω).
Voltage variations may be noted due to normal production tolerances.
- Waveforms are taken with an oscilloscope.
Voltage variations may be noted due to normal production tolerances.
- Circled numbers refer to waveforms.
- Signal path.
 - ⇨ : CD PLAY
 - ⇨ : FM
 - ⇨ : MW
 - ⇨ : AUX
 - ⇨ : AUDIO

For Printed Wiring Boards.

Note:

- ○— : Parts extracted from the component side.
- — : parts extracted from the conductor side.
- ○ : Through hole.
- : Pattern from the side which enables seeing.
(The other layers' patterns are not indicated.)

Caution:
 Pattern face side: Parts on the pattern face side seen from the pattern face are indicated.
 Parts face side: Parts on the parts face side seen from the parts face are indicated.

• **Waveforms**

– MAIN Board –

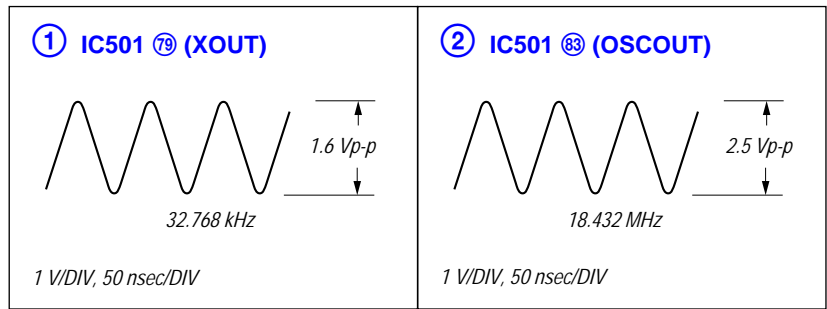

5-1. BLOCK DIAGRAM – MAIN Section –

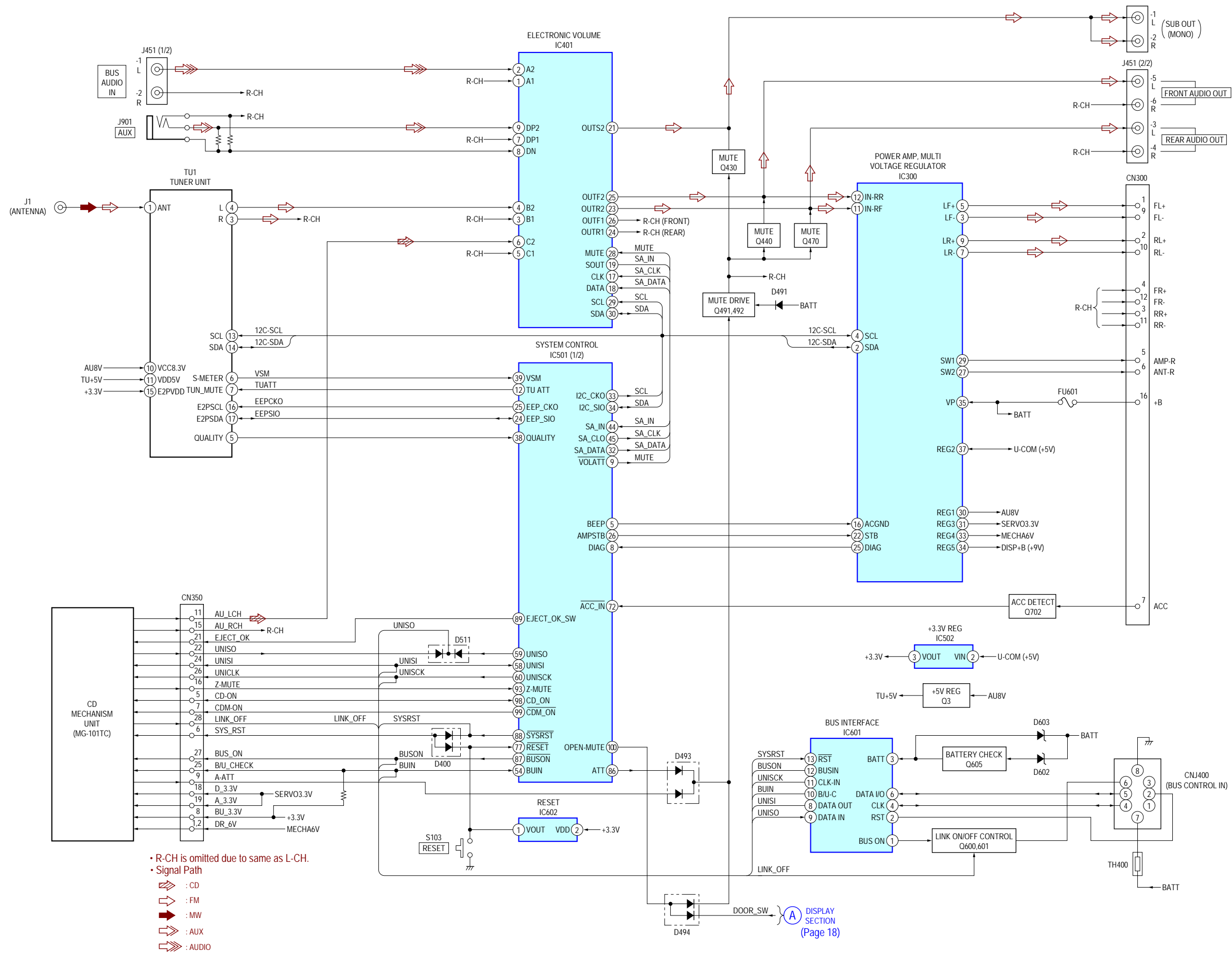

5-2. BLOCK DIAGRAM – DISPLAY Section –

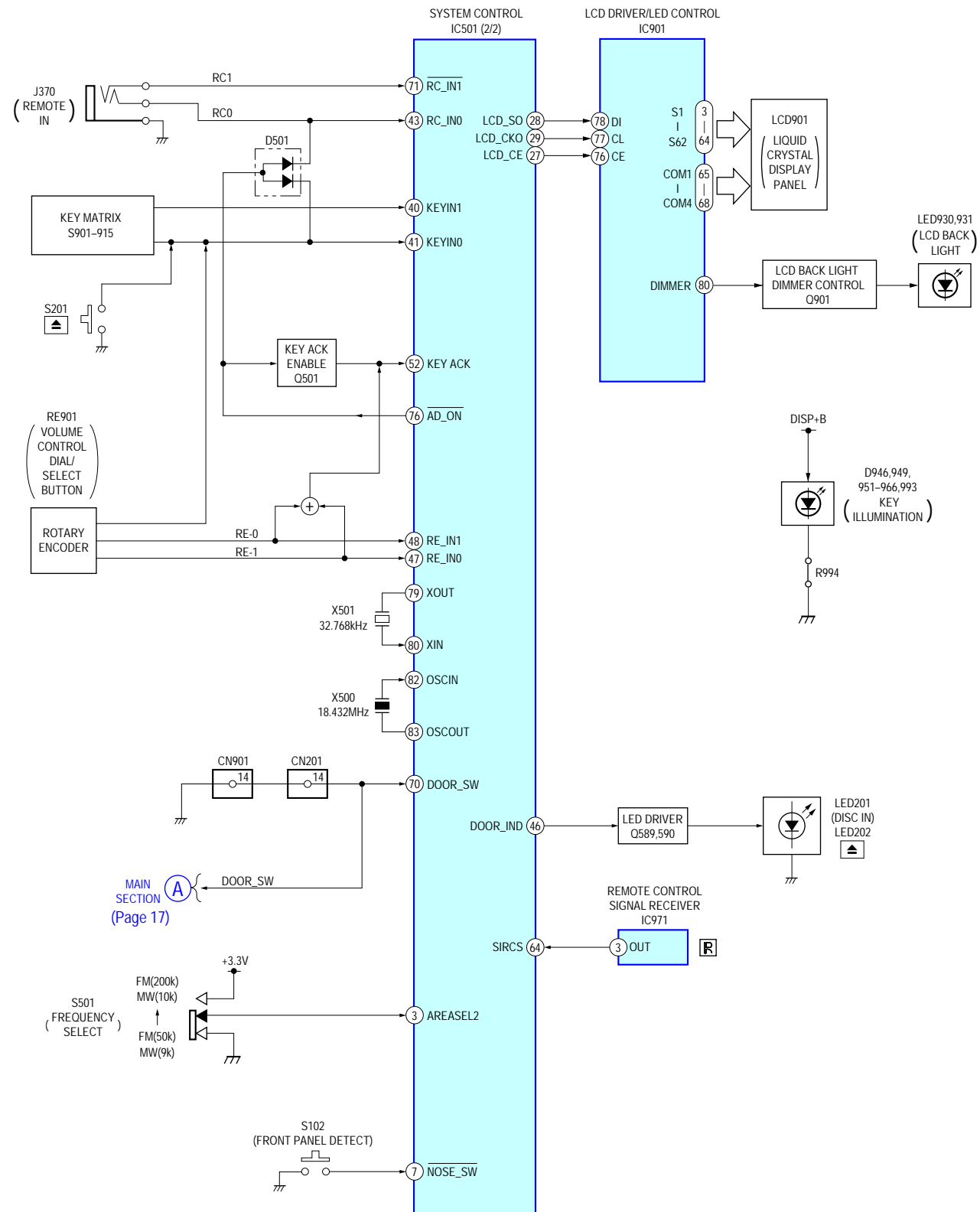

5-3. PRINTED WIRING BOARD – MAIN Section –  : Uses unleaded solder.

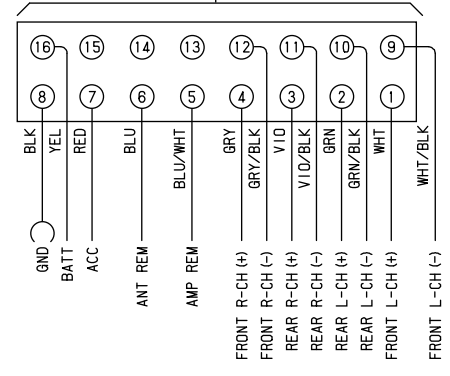
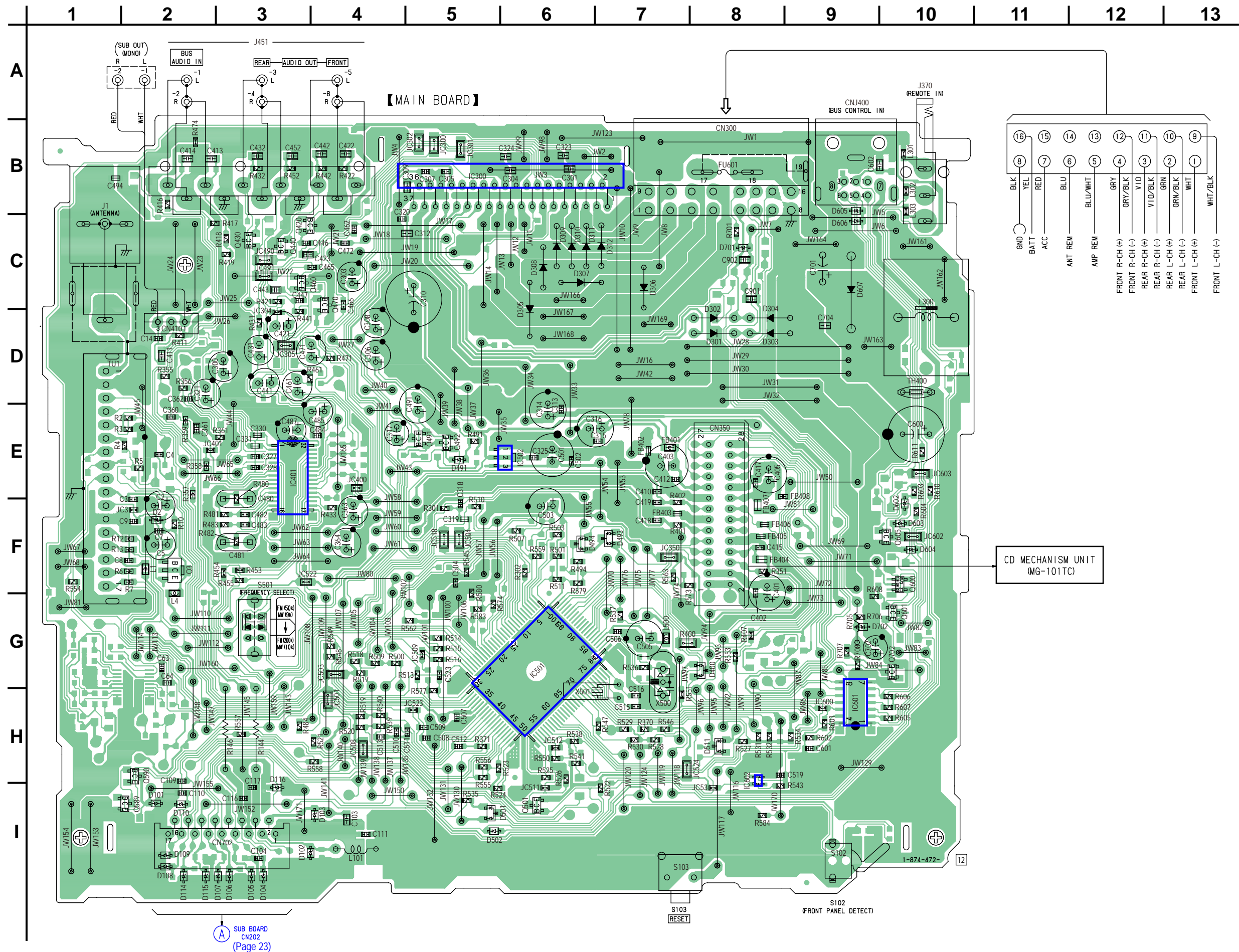

• Semiconductor Location

Ref. No.	Location
D2	F-2
D101	I-2
D102	I-3
D103	I-4
D104	I-3
D105	I-3
D106	I-3
D107	I-2
D108	I-2
D109	I-2
D110	I-2
D114	I-2
D115	I-2
D301	D-8
D302	C-8
D303	D-8
D304	C-8
D305	C-6
D306	C-6
D307	C-6
D308	C-6
D309	C-6
D310	C-6
D311	C-6
D312	C-7
D400	G-8
D491	E-5
D493	F-7
D494	F-6
D501	I-5
D502	I-5
D511	H-8
D602	F-10
D603	F-10
D604	F-10
D605	B-9
D606	C-9
D607	C-9
D701	C-8
D702	G-9
IC300	B-6
IC401	E-3
IC501	G-6
IC502	H-8
IC601	G-9
IC602	H-8
Q3	F-2
Q420	C-4
Q430	C-3
Q440	C-3
Q460	C-3
Q470	C-4
Q491	E-5
Q492	E-5
Q501	I-6
Q589	I-2
Q590	H-2
Q600	F-10
Q601	G-10
Q605	F-10
Q702	G-10

5-4. SCHEMATIC DIAGRAM – MAIN Section (1/3) – • See page 26 for IC Block Diagrams.

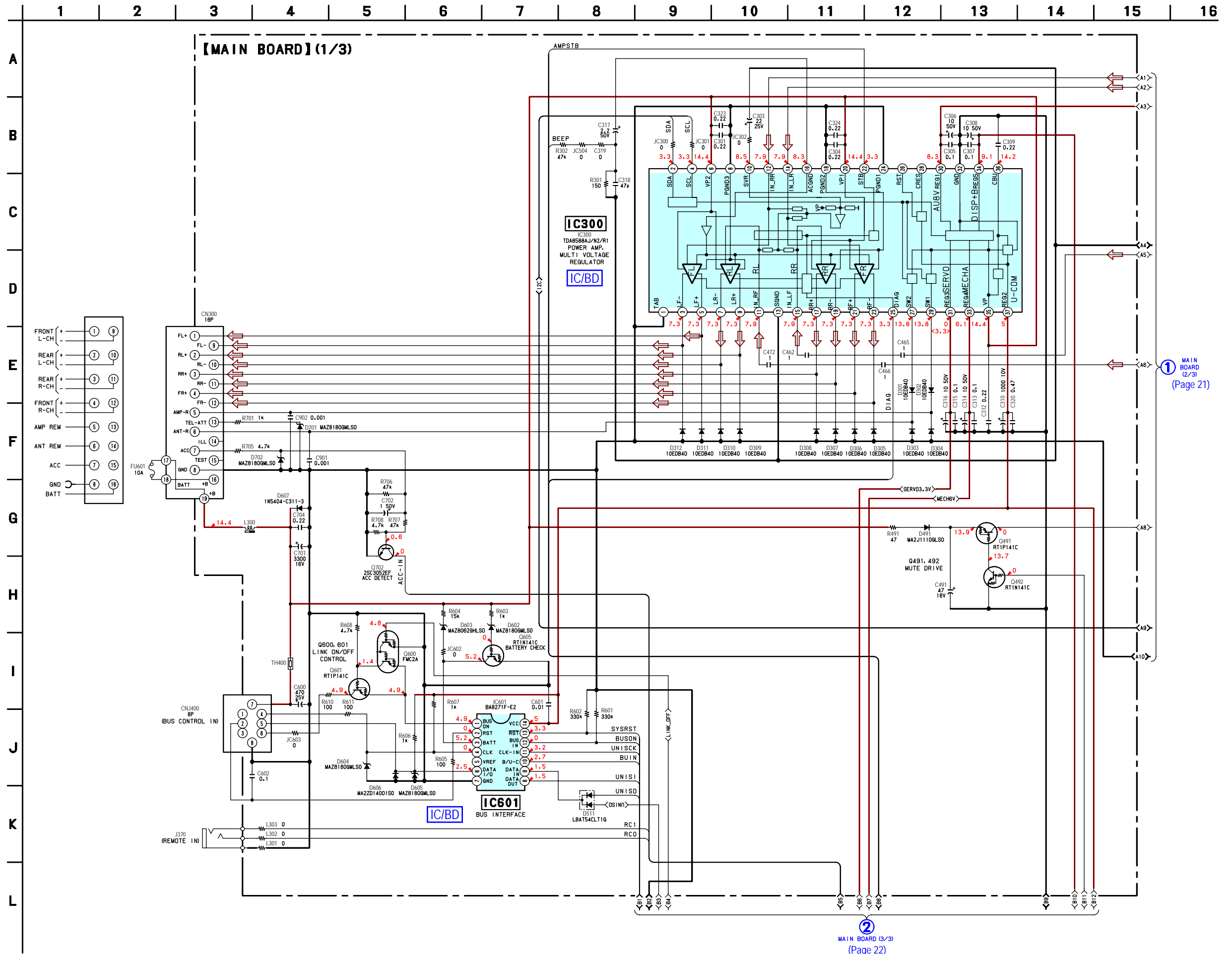

5-5. SCHEMATIC DIAGRAM – MAIN Section (2/3) – • See page 26 for IC Block Diagrams.

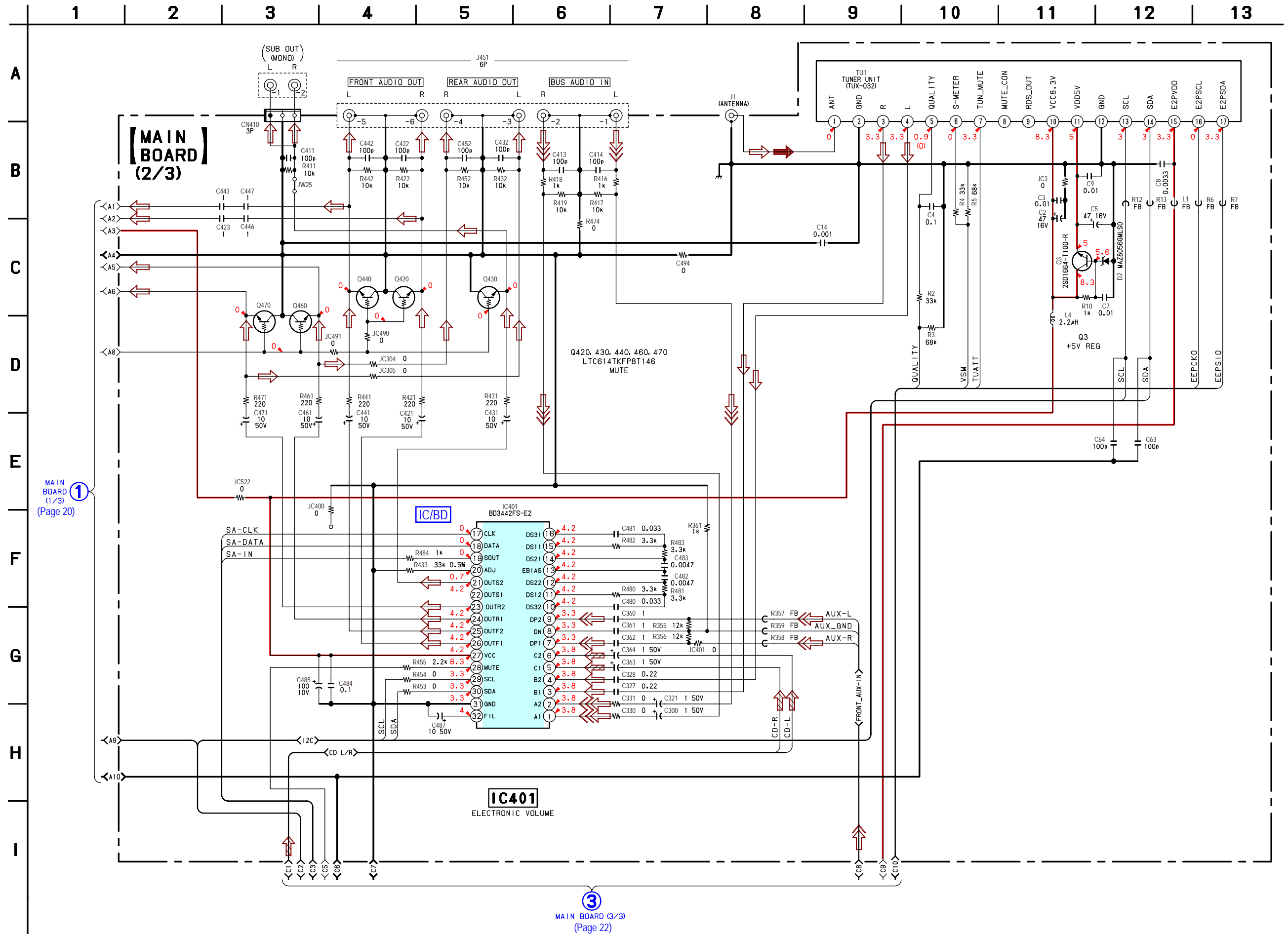

5-6. SCHEMATIC DIAGRAM – MAIN Section (3/3) – • See page 16 for waveforms. • See page 27 for IC Pin Function Description of IC501.

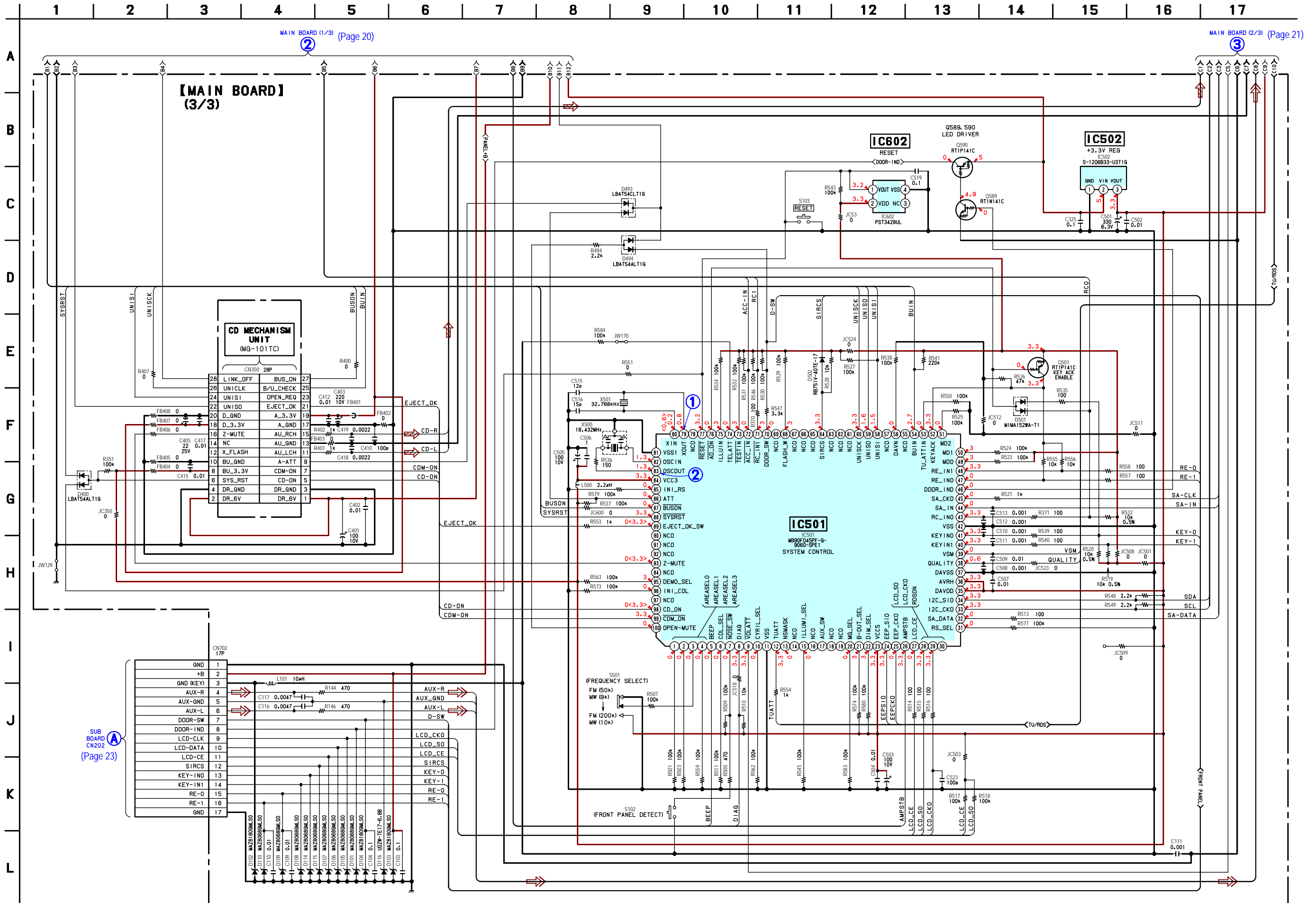

5-7. PRINTED WIRING BOARD – SUB Section –  : Uses unleaded solder.

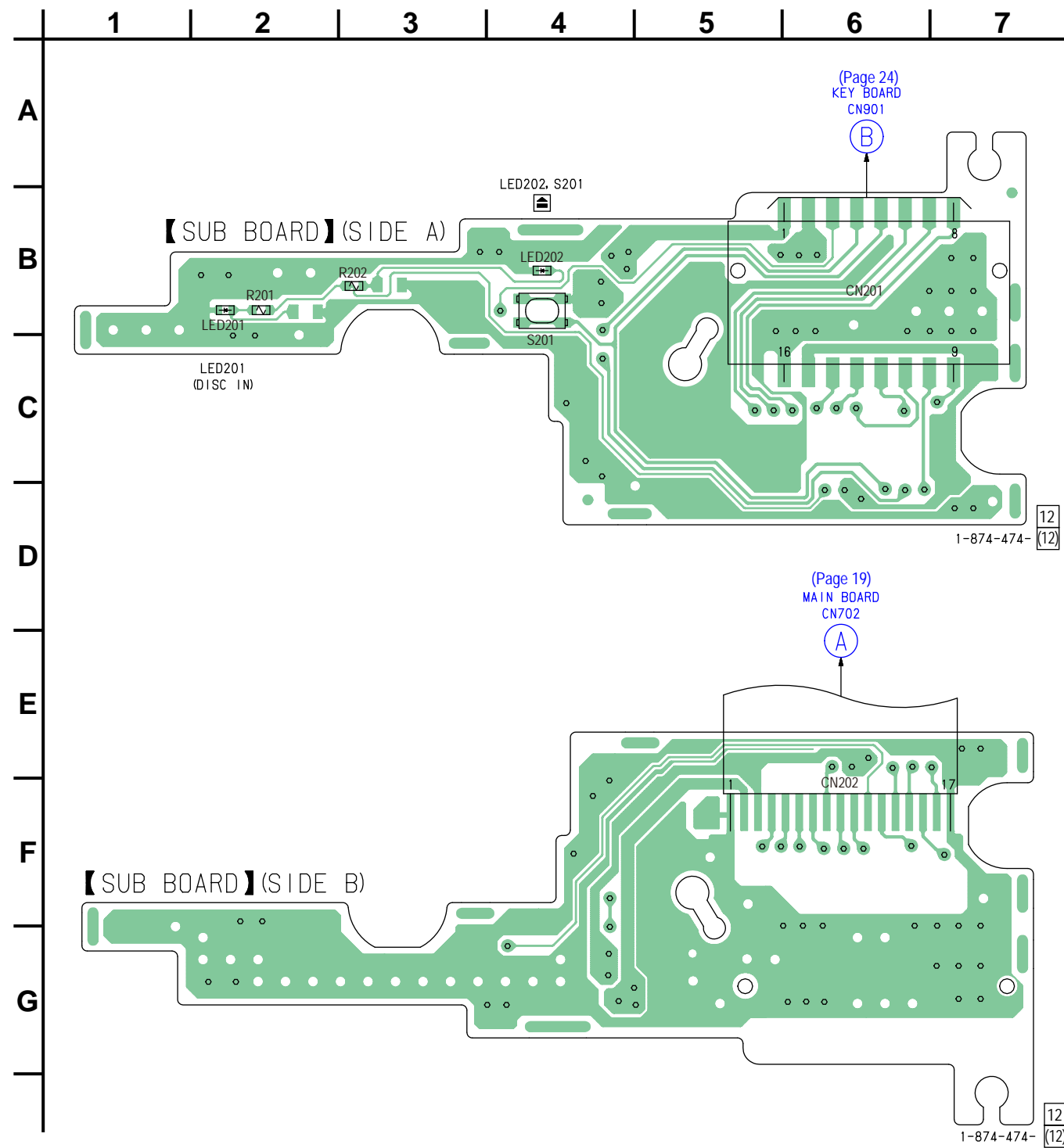

5-8. SCHEMATIC DIAGRAM – SUB Section –

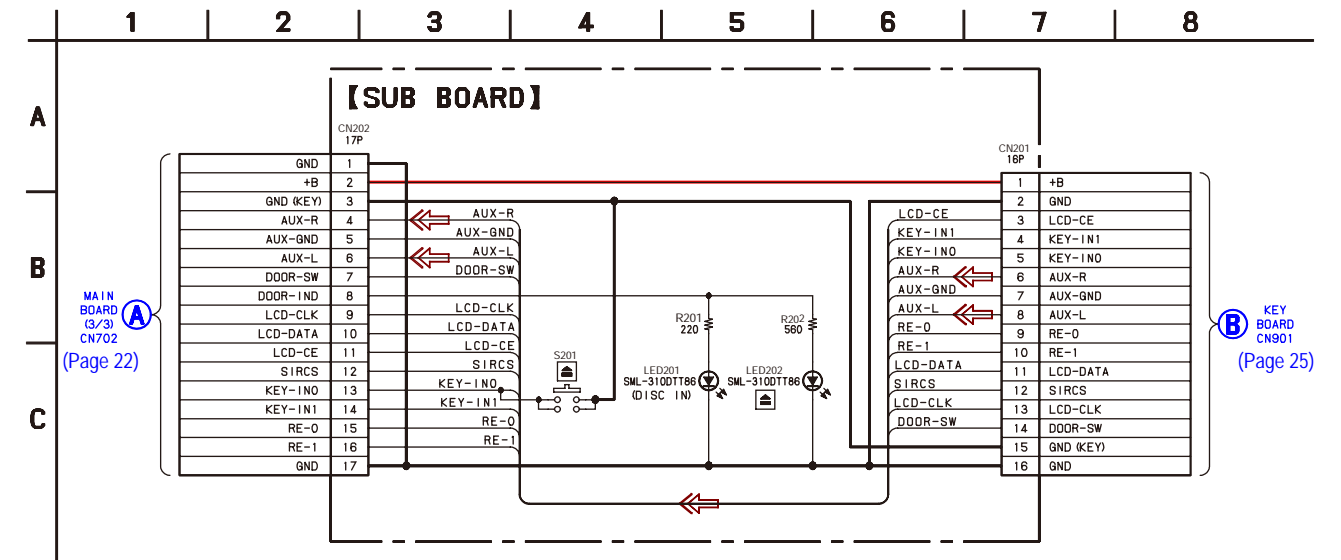

5-9. PRINTED WIRING BOARD – KEY Section –  : Uses unleaded solder.

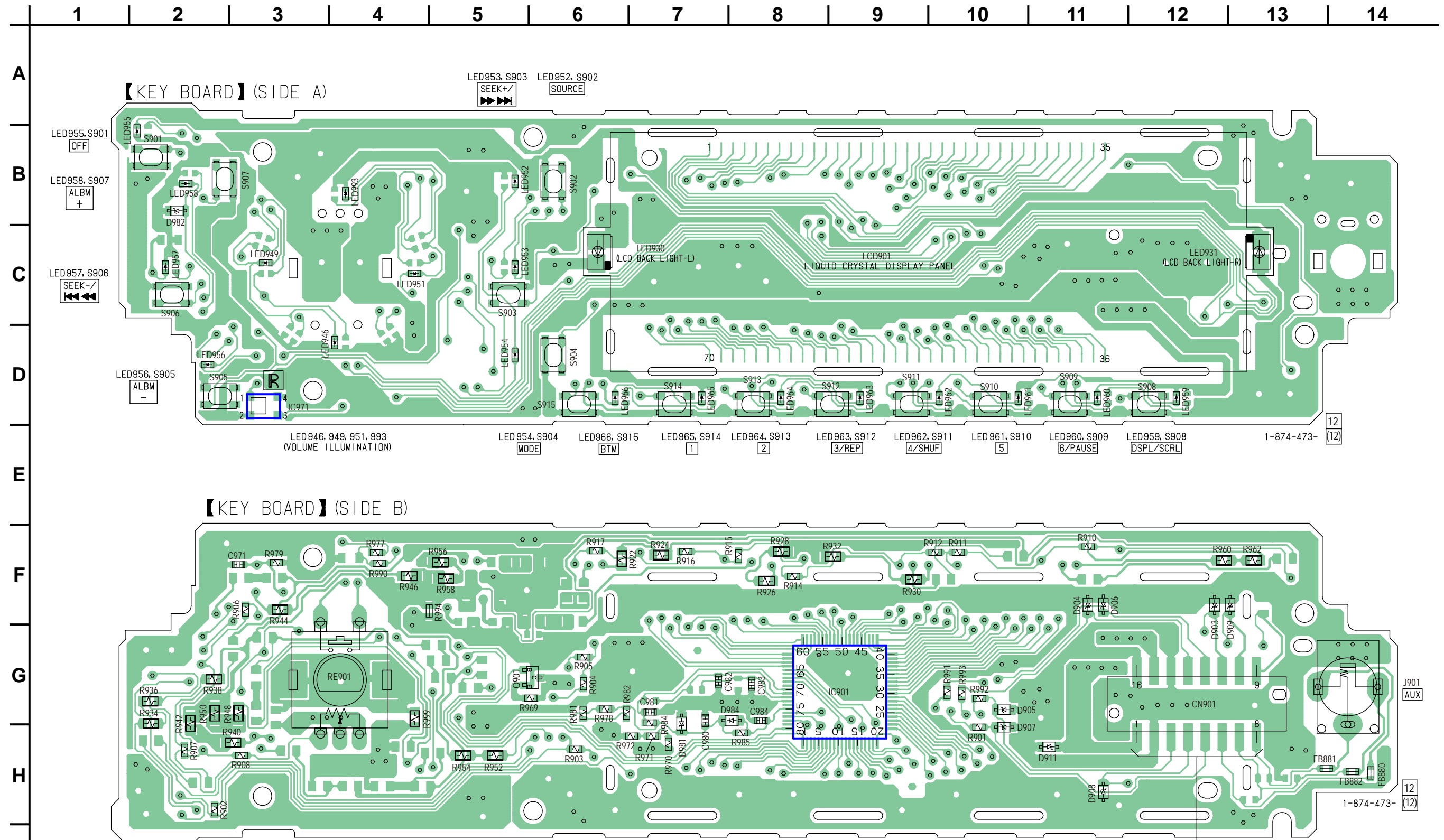

• Semiconductor Location

Ref. No.	Location	Ref. No.	Location	Ref. No.	Location	Ref. No.	Location	Ref. No.	Location
D903	F-12	D981	G-7	LED931	C-12	LED956	D-2	LED964	D-8
D904	F-11	D982	B-2	LED946	D-4	LED957	C-2	LED965	D-7
D905	G-10	D984	G-8	LED949	C-3	LED958	B-2	LED966	D-6
D906	F-11			LED951	C-4	LED959	D-12	LED993	B-4
D907	G-10	IC901	G-9	LED952	B-5	LED960	D-11		
D908	H-11	IC971	D-3	LED953	C-5	LED961	D-10	Q901	G-5
D909	F-12			LED954	D-5	LED962	D-10		
D911	H-11	LED930	C-7	LED955	B-2	LED963	D-9		

 SUB BOARD
CN201
(Page 23)

• IC Block Diagrams

IC300 TDA8588AJ/N2/R1 (MAIN Board (1/3))

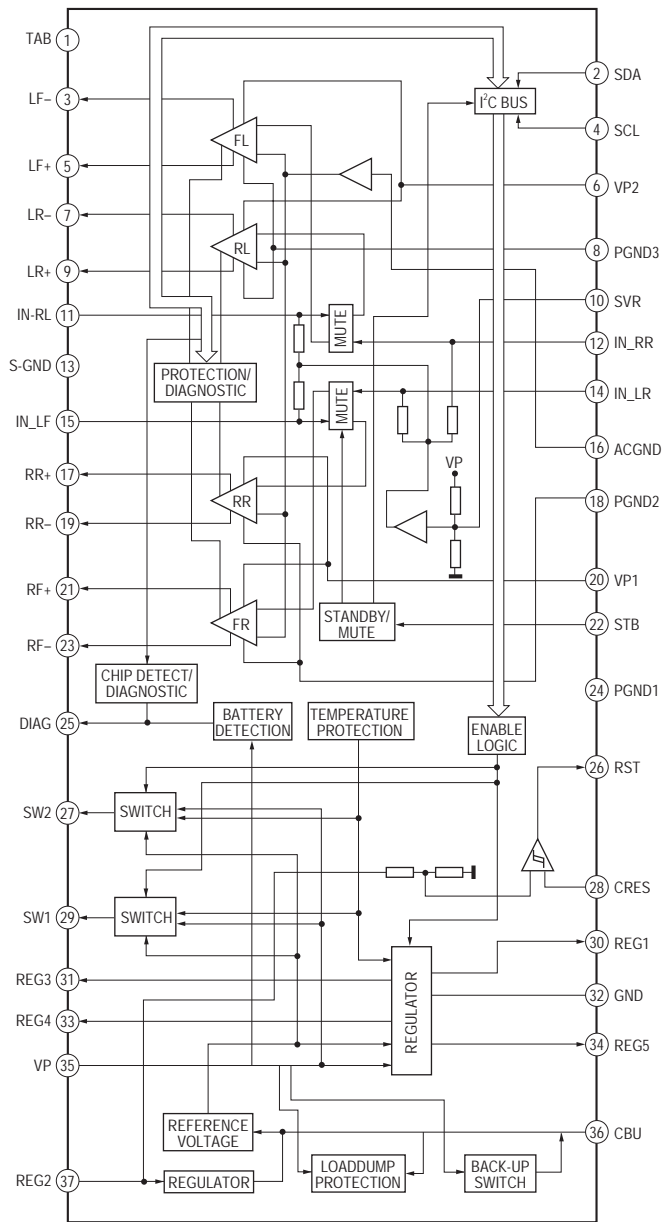

IC601 BA8271F-E2 (MAIN Board (1/3))

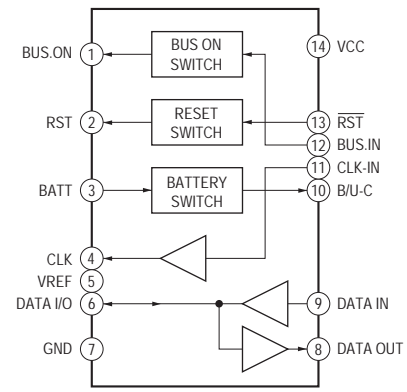

IC401 BD3442FS-E2 (MAIN Board (2/3))

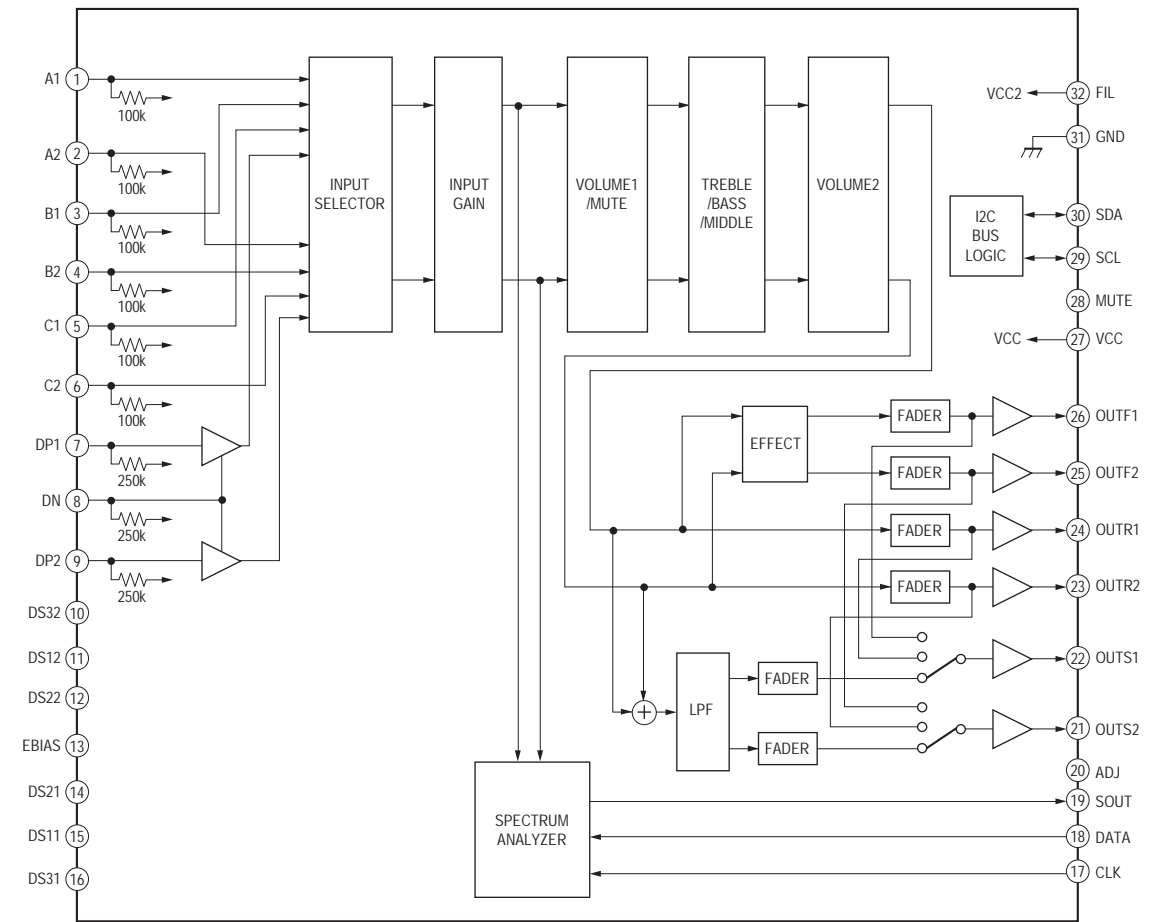

• IC Pin Function Description

IC501 MB90F045PF-G-9060-SPE1 (SYSTEM CONTROL) (MAIN BOARD (3/3))

Pin No.	Pin Name	I/O	Description
1	AREASEL0	I	Destination setting pin 0 (Fixed at L in this set)
2	AREASEL1	I	Destination setting pin 1 (Fixed at L in this set)
3	AREASEL2	I	Destination setting pin 2 (L: FM (50k) /MW (9k), H: FM (200k)/MW (10k))
4	AREASEL3	I	Destination setting pin 3 (Fixed at L in this set)
5	BEEP	O	BEEP signal output to power amp IC.
6	COL_SET	I	Key illumination 2 colors select signal input (L: 1 color, H: 2 color) (Fixed at L in this set)
7	NOSE_SW	I	Front panel detach detection signal input (L: with panel, H: without panel)
8	DIAG	I	Status signal input from power amp IC.
9	VOLATT	O	Attenuator control signal output to electronic volume IC.
10	CYRIL_SEL	I	CYRIL select signal input (L: non CYRIL, H: CYRIL) (Fixed at L in this set)
11	VSS	—	Ground pin
12	TUATT	O	Tuner mute control signal output
13	NSMASK	O	Noise mask signal output Not used in this set. (Open)
14	NCO	O	Not used. (Open)
15	ILLUMI_SEL	I	Illumination voltage setting pin (L: illumination power supply 9 V)
16	NCO	O	Not used. (Open)
17	AUX_SW	O	Not used. (Open)
18, 19	NCO	O	Not used. (Open)
20	MG_SEL	I	Mechanism deck select signal input (L: MG-101TC)
21	B-OUT_SEL	I	Black out select signal input (L: non black out, H: black out) (Fixed at H in this set)
22	DIM_SEL	I	Dimmer select signal input (H: non auto dimmer)
23	VCC5	—	Power supply pin (+3.3V)
24	EEP_SIO	I/O	Serial data signal input/output for EEPROM communication.
25	EEP_CKO	O	Serial clock signal output for EEPROM communication.
26	AMPSTB	O	Stand-by signal output to power amp IC.
27	LCD_CE	O	Chip enable signal output to LCD drive IC.
28	LCD_SO	O	Serial data signal output to LCD drive IC.
29	LCD_CKO	O	Serial clock signal output to LCD drive IC.
30	RDSON	O	RDS (radio data system) ON signal output Not used in this set. (Open)
31	RS-SEL	I	Rear/sub switchable select signal input (L: non rear/sub switchable, H: rear/sub switchable) (Fixed at L in this set)
32	SA-DATA	O	Data output for electronic volume IC spectrum analyzer.
33	I2C_CKO	O	I2C bus serial clock signal output
34	I2C_SIO	I/O	I2C bus serial data signal input/output
35	DAVDD	—	A/D converter power supply pin (+3.3V)
36	AVRH	—	A/D converter external reference power supply pin (+3.3V)
37	DAVSS	—	A/D converter Ground pin
38	QUALITY	I	Noise detect signal input
39	VSM	I	S-meter voltage detect signal input
40	KEYIN1	I	Key signal input 1
41	KEYIN0	I	Key signal input 0
42	VSS	—	Ground pin
43	RC_IN0	I	Rotary commander key signal input
44	SA_IN	I	Spectrum analyzer signal input
45	SA_CKO	O	Spectrum analyzer clock signal output
46	DOOR_IND	O	DISC IN indicator LED control signal output
47	RE_IN0	I	Rotary encoder signal input 0
48	RE_IN1	I	Rotary encoder signal input 1
49, 50	MD0, MD1	I	Signal input for operation mode designation. (Fixed at H in this set)
51	MD2	I	Signal input for operation mode designation. (Fixed at L in this set)
52	KEYACK	I	Key acknowledgment detect signal input
53	TU_ATTIN	I	Tuner mute zero cross detect signal input Not used in this set. (Pull down)
54	BUIN	I	Back-up power supply detect signal input
55	NCO	O	Not used. (Open)

Pin No.	Pin Name	I/O	Description
56	DAVN	I	RDS data block synchronized detect signal input Not used in this set. (Pull down)
57	NCO	O	Not used. (Open)
58	UNISI	I	S-BUS data signal input
59	UNISO	O	S-BUS data signal output
60	UNISCK	O	S-BUS clock signal output
61 to 63	NCO	O	Not used. (Open)
64	SIRCS	I	Remote control signal input
65 to 67	NCO	O	Not used. (Open)
68	FLASH_W	I	Memory mode select signal input Normally "H" input: Single chip mode, after reset "L": Flash write mode (Fixed at H in this set)
69	NCO	O	Not used. (Open)
70	DOOR_SW	I	Front panel open/close detection signal input
71	RC_IN1	I	Rotary commander shift key signal input
72	ACC_IN	I	Accessory power supply detect signal input
73	TESTIN	I	Test mode detect signal input Not used in this set. (Pull up)
74	TELATT	I	Telephone attenuate detect signal input Not used in this set. (Pull down)
75	ILLUIN	I	Illumination detection signal input (H: illumination OFF)
76	AD_ON	O	A/D converter power supply control signal output
77	RESET	I	System reset signal input
78	NCO	O	Not used. (Open)
79	XOUT	O	Low speed operation clock signal output (32.768 kHz)
80	XIN	I	Low speed operation clock signal input (32.768 kHz)
81	VSS1	—	Ground pin
82	OSCIN	I	High speed operation clock signal input (18.432 MHz)
83	OSCOU	O	High speed operation clock signal output (18.432 MHz)
84	VCC3	—	Power supply pin (+3.3 V)
85	DEMOSEL	I	DEMO select signal input (H: DEMO on, L: DEMO off)
86	ATT	O	Audio mute control signal output
87	BUSON	O	BUS ON signal output
88	SYRST	O	System reset signal output
89	EJECT_OK_SW	O	Eject OK signal output
90 to 92	NCO	O	Not used. (Open)
93	Z-MUTE	I	CD zero cross mute detect signal input
94	NCO	O	Not used. (Open)
95	DEMOSEL	I	Demo select signal input (H: Demo ON)
96	INI_COL	I	Initial color setting signal input (Fixed at L in this set)
97	NCO	O	Not used. (Open)
98	CD_ON	I	CD mechanism servo power supply control request signal input
99	CDM_ON	I	CD mechanism deck power supply control request signal input
100	OPEN-MUTE	O	Mute signal output at during the AUX source mode. (L: other, H: keep)

SECTION 6 EXPLODED VIEWS

Note:

- -XX and -X mean standardized parts, so they may have some difference from the original one.
- Items marked "*" are not stocked since they are seldom required for routine service. Some delay should be anticipated when ordering these items.

- The mechanical parts with no reference number in the exploded views are not supplied.
- Color Indication of Appearance Parts Example:
KNOB, BALANCE (WHITE) . . . (RED)

↑ Parts Color ↑ Cabinet's Color
- Accessories are given in the last of the electrical parts list.

The components identified by mark \triangle or dotted line with mark \triangle are critical for safety. Replace only with part number specified.

6-1. MAIN SECTION

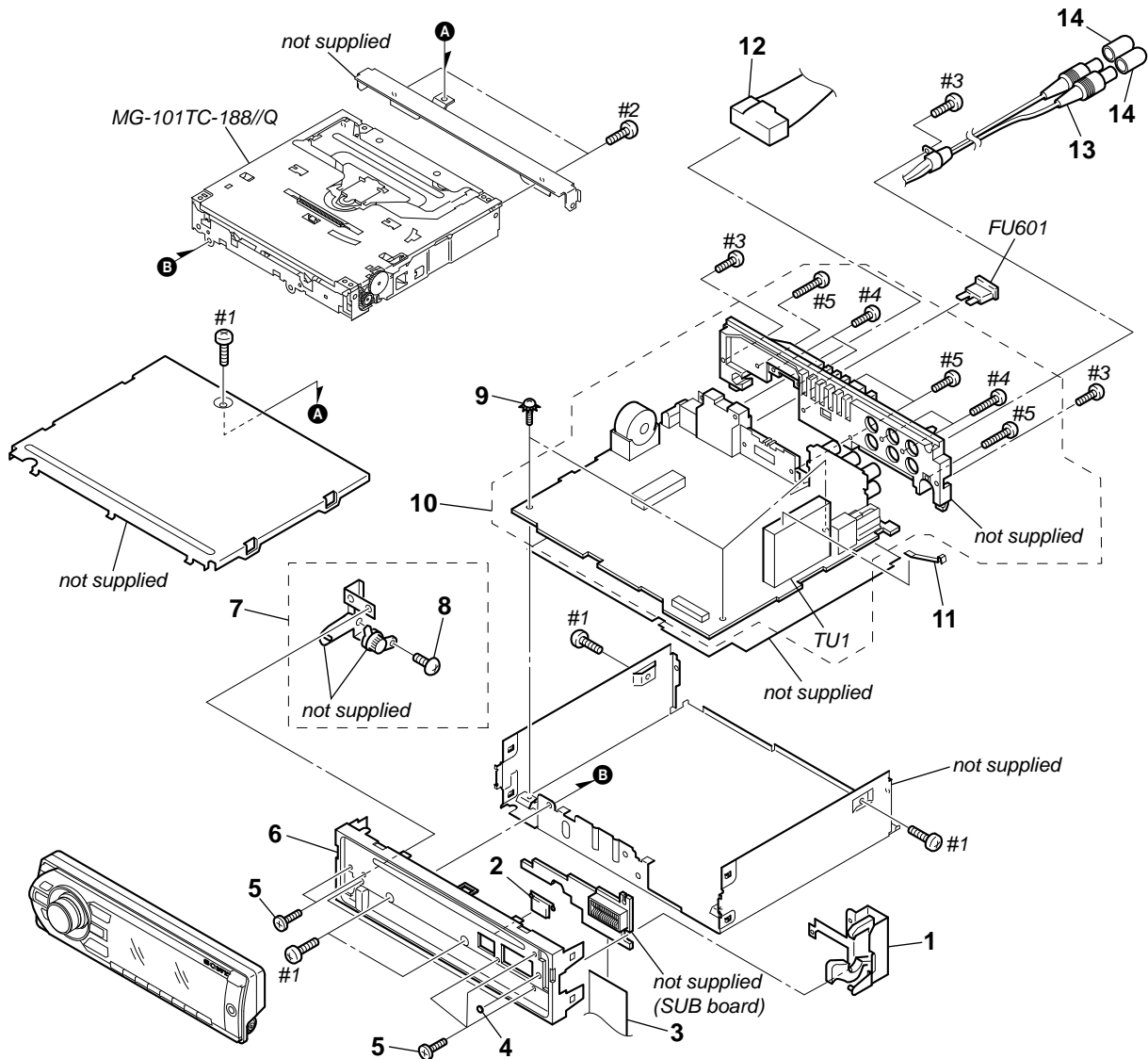

Ref. No.	Part No.	Description	Remark	Ref. No.	Part No.	Description	Remark
1	X-2176-202-1	LOCK ASSY		12	1-833-974-21	CONNECTION CORD FOR AUTOMOBILE (POWER)	
2	3-246-441-01	BUTTON (EJECT)		13	1-833-887-11	CONNECTION CORD (RCA) (SUB OUT (MONO))	
3	1-834-507-11	CABLE, FLEXIBLE FLAT (17 CORE)		14	3-264-798-01	CAP	
4	3-260-247-01	CUSHION (SUB PANEL)		FU601	1-532-877-11	FUSE (BLADE TYPE) (AUTO FUSE) 10A	
5	3-042-244-01	SCREW (T)		TU1	A-3220-960-B	TUNER UNIT (TUX-032)	
6	X-2179-173-2	PANEL ASSY, SUB		#1	7-685-792-09	SCREW +PTT 2.6X6 (S)	
7	X-3384-203-2	GEAR ASSY		#2	7-685-790-01	SCREW +PTT 2.6X4 (S)	
8	3-713-786-51	SCREW +P 2X3		#3	7-685-793-09	SCREW +PTT 2.6X8 (S)	
9	3-376-464-11	SCREW (+PTT 2.6X6), GROUND POINT		#4	7-685-134-19	SCREW +P 2.6X8 TYPE2 NON-SLIT	
10	A-1312-912-A	MAIN BOARD, COMPLETE		#5	7-685-794-09	SCREW +PTT 2.6X10 (S)	
11	2-021-848-01	SHEET (TU), GROUND					

6-2. FRONT PANEL SECTION

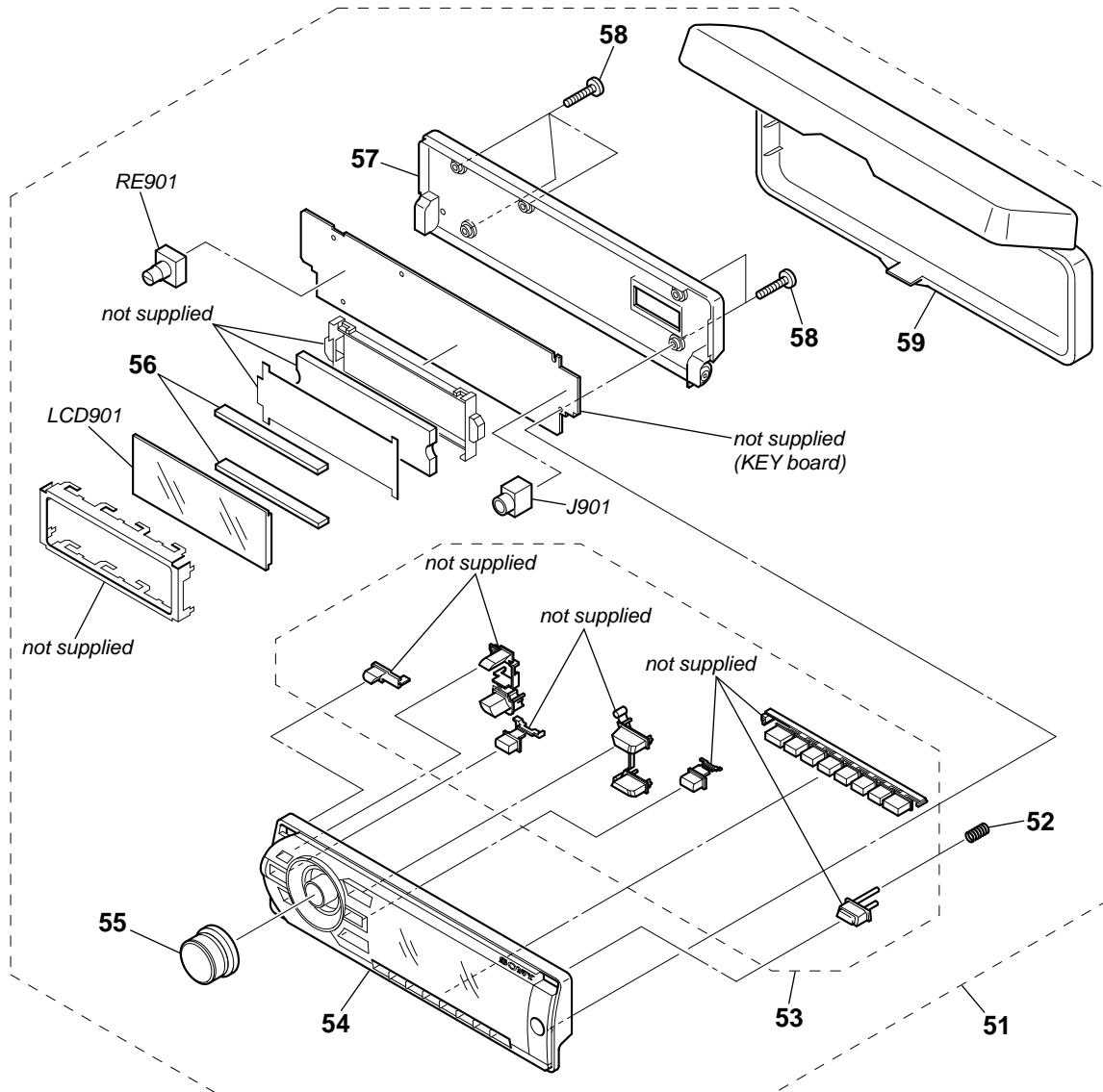

Ref. No.	Part No.	Description	Remark	Ref. No.	Part No.	Description	Remark
51	A-1548-032-A	PANEL OVERALL ASSY, FRONT		58	3-250-543-21	SCREW (+B P-TITE M2)	
52	3-264-712-01	SPRING (OPEN)		59	X-2187-544-1	CASE ASSY (for FRONT PANEL)	
53	X-2179-192-2	BUTTON ASSY (S)		J901	1-820-833-11	JACK, SMALL TYPE (VERTICAL) (AUX)	
54	X-2318-426-1	PANEL (SV) ASSY, FRONT		LCD901	1-802-535-11	DISPLAY PANEL, LIQUID CRYSTAL	
55	X-2179-191-2	KNOB ASSY (S)		RE901	1-479-902-22	ENCODER, ROTARY (VOLUME CONTROL DIAL/SELECT BUTTON)	
56	1-780-563-11	CONDUCTIVE BOARD, CONNECTION					
57	X-2179-174-1	PANEL ASSY, FRONT BACK					

6-3. CD MECHANISM SECTION
(MG-101TC-188//Q)

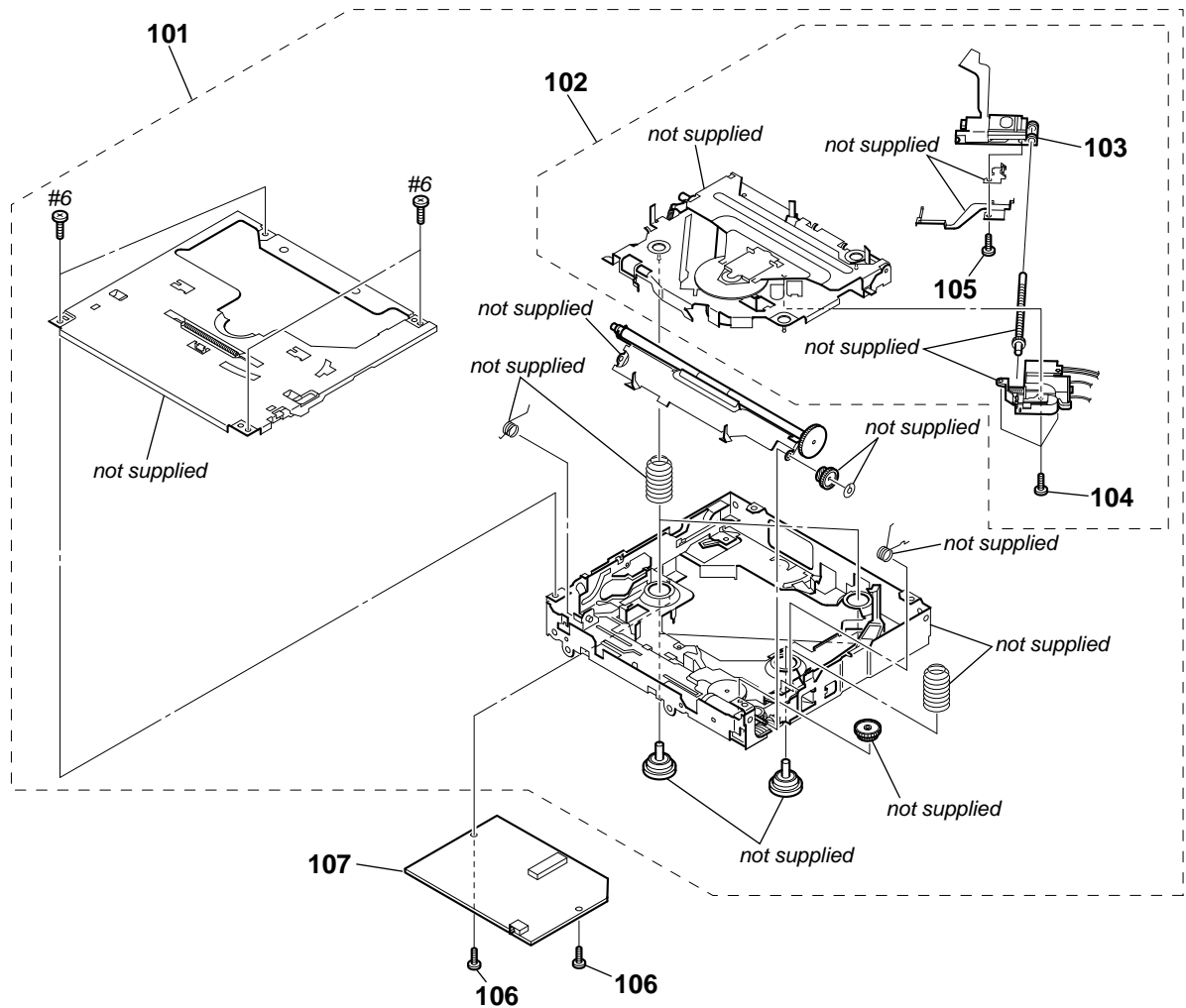

Ref. No.	Part No.	Description	Remark	Ref. No.	Part No.	Description	Remark
101	A-1289-450-A	MECHANICAL BLOCK ASSY (08)		105	3-348-998-31	SCREW (M1.4X2.5), TAPPING, PAN	
102	A-1284-705-A	DAXEV08//Q		106	3-352-758-31	SCREW (M1.7X2.5), TOOTHED LOCK	
△ 103	X-2149-672-1	SERVICE ASSY, OP (DAX-25A)		107	A-1177-201-A	SERVO BOARD, COMPLETE	
104	2-626-869-01	SCREW (M2X3), SERRATION		#6	7-627-000-08	SCREW, PRECISION +P 1.7X2.2 TYPE3	

Ref. No.	Part No.	Description	Remark	Ref. No.	Part No.	Description	Remark
R917	1-216-825-11	METAL CHIP	2.2K 5%	1/10W			
R922	1-216-030-00	RES-CHIP	160 5%	1/10W			
R924	1-216-031-00	RES-CHIP	180 5%	1/10W			
R926	1-216-030-00	RES-CHIP	160 5%	1/10W			
R928	1-216-031-00	RES-CHIP	180 5%	1/10W			
R930	1-216-030-00	RES-CHIP	160 5%	1/10W			
R932	1-216-031-00	RES-CHIP	180 5%	1/10W			
R934	1-216-033-00	RES-CHIP	220 5%	1/10W			
R936	1-216-029-00	RES-CHIP	150 5%	1/10W			
R938	1-216-025-11	RES-CHIP	100 5%	1/10W			
R940	1-216-033-00	RES-CHIP	220 5%	1/10W			
R942	1-216-031-00	RES-CHIP	180 5%	1/10W			
R944	1-216-029-00	RES-CHIP	150 5%	1/10W			
R946	1-216-031-00	RES-CHIP	180 5%	1/10W			
R948	1-216-033-00	RES-CHIP	220 5%	1/10W			
R950	1-216-031-00	RES-CHIP	180 5%	1/10W			
R952	1-216-029-00	RES-CHIP	150 5%	1/10W			
R954	1-216-031-00	RES-CHIP	180 5%	1/10W			
R956	1-216-031-00	RES-CHIP	180 5%	1/10W			
R958	1-216-031-00	RES-CHIP	180 5%	1/10W			
R960	1-216-030-00	RES-CHIP	160 5%	1/10W			
R962	1-216-031-00	RES-CHIP	180 5%	1/10W			
R969	1-216-824-11	METAL CHIP	1.8K 5%	1/10W			
R970	1-216-813-11	METAL CHIP	220 5%	1/10W			
R971	1-216-813-11	METAL CHIP	220 5%	1/10W			
R972	1-216-813-11	METAL CHIP	220 5%	1/10W			
R977	1-216-809-11	METAL CHIP	100 5%	1/10W			
R978	1-216-813-11	METAL CHIP	220 5%	1/10W			
R979	1-216-821-11	METAL CHIP	1K 5%	1/10W			
R981	1-216-811-11	METAL CHIP	150 5%	1/10W			
R982	1-216-811-11	METAL CHIP	150 5%	1/10W			
R984	1-216-811-11	METAL CHIP	150 5%	1/10W			
R985	1-216-857-11	METAL CHIP	1M 5%	1/10W			
R990	1-216-809-11	METAL CHIP	100 5%	1/10W			
R991	1-216-817-11	METAL CHIP	470 5%	1/10W			
R992	1-216-817-11	METAL CHIP	470 5%	1/10W			
R993	1-216-817-11	METAL CHIP	470 5%	1/10W			
R994	1-216-864-11	SHORT CHIP	0				
R999	1-216-001-00	RES-CHIP	10 5%	1/10W			
		< ROTARY ENCODER >					
RE901	1-479-902-22	ENCODER, ROTARY (VOLUME CONTROL DIAL/SELECT BUTTON)					
		< SWITCH >					
S901	1-786-653-21	SWITCH, TACTILE (OFF)					
S902	1-786-653-21	SWITCH, TACTILE (SOURCE)					
S903	1-786-653-21	SWITCH, TACTILE (SEEK+▶▶▶▶▶)					
S904	1-786-653-21	SWITCH, TACTILE (MODE)					
S905	1-786-653-21	SWITCH, TACTILE (ALBM -)					
S906	1-786-653-21	SWITCH, TACTILE (SEEK-◀◀◀◀◀)					
S907	1-786-653-21	SWITCH, TACTILE (ALBM +)					
S908	1-786-653-21	SWITCH, TACTILE (DSPL/SCR L)					
S909	1-786-653-21	SWITCH, TACTILE (6/PAUSE)					
S910	1-786-653-21	SWITCH, TACTILE (5)					
S911	1-786-653-21	SWITCH, TACTILE (4/SHUF)					
S912	1-786-653-21	SWITCH, TACTILE (3/REP)					
S913	1-786-653-21	SWITCH, TACTILE (2)					
S914	1-786-653-21	SWITCH, TACTILE (1)					
S915	1-786-653-21	SWITCH, TACTILE (BTM)					

					A-1312-912-A	MAIN BOARD, COMPLETE *****	
					7-685-134-19	SCREW +P 2.6X8 TYPE2 NON-SLIT	
					7-685-794-09	SCREW +PTT 2.6X10 (S)	
						< CAPACITOR >	
				C2	1-126-947-11	ELECT 47uF 20%	35V
				C3	1-162-970-11	CERAMIC CHIP 0.01uF 10%	25V
				C4	1-107-826-11	CERAMIC CHIP 0.1uF 10%	16V
				C5	1-126-947-11	ELECT 47uF 20%	35V
				C7	1-162-970-11	CERAMIC CHIP 0.01uF 10%	25V
				C8	1-162-967-11	CERAMIC CHIP 0.0033uF 10%	50V
				C9	1-162-970-11	CERAMIC CHIP 0.01uF 10%	25V
				C14	1-162-964-11	CERAMIC CHIP 0.001uF 10%	50V
				C63	1-162-927-11	CERAMIC CHIP 100PF 5%	50V
				C64	1-162-927-11	CERAMIC CHIP 100PF 5%	50V
				C103	1-165-319-11	CERAMIC CHIP 0.1uF	50V
				C104	1-107-826-11	CERAMIC CHIP 0.1uF 10%	16V
				C109	1-162-970-11	CERAMIC CHIP 0.01uF 10%	25V
				C110	1-162-970-11	CERAMIC CHIP 0.01uF 10%	25V
				C111	1-162-964-11	CERAMIC CHIP 0.001uF 10%	50V
				C116	1-162-968-11	CERAMIC CHIP 0.0047uF 10%	50V
				C117	1-162-968-11	CERAMIC CHIP 0.0047uF 10%	50V
				C300	1-126-960-11	ELECT 1uF 20%	50V
				C301	1-115-340-11	CERAMIC CHIP 0.22uF 10%	25V
				C303	1-128-551-11	ELECT 22uF 20%	63V
				C304	1-115-340-11	CERAMIC CHIP 0.22uF 10%	25V
				C305	1-107-826-11	CERAMIC CHIP 0.1uF 10%	16V
				C306	1-126-964-11	ELECT 10uF 20%	50V
				C307	1-107-826-11	CERAMIC CHIP 0.1uF 10%	16V
				C308	1-126-964-11	ELECT 10uF 20%	50V
				C309	1-115-340-11	CERAMIC CHIP 0.22uF 10%	25V
				C310	1-126-926-11	ELECT 1000uF 20%	10V
				C312	1-115-340-11	CERAMIC CHIP 0.22uF 10%	25V
				C313	1-107-826-11	CERAMIC CHIP 0.1uF 10%	16V
				C314	1-124-261-00	ELECT 10uF 20%	50V
				C315	1-107-826-11	CERAMIC CHIP 0.1uF 10%	16V
				C316	1-124-261-00	ELECT 10uF 20%	50V
				C317	1-124-257-00	ELECT 2.2uF 20%	50V
				C318	1-162-923-11	CERAMIC CHIP 47PF 5%	50V
				C319	1-216-864-11	SHORT CHIP 0	
				C320	1-125-891-11	CERAMIC CHIP 0.47uF 10%	10V
				C321	1-126-960-11	ELECT 1uF 20%	50V
				C323	1-115-340-11	CERAMIC CHIP 0.22uF 10%	25V
				C324	1-115-340-11	CERAMIC CHIP 0.22uF 10%	25V
				C325	1-107-826-11	CERAMIC CHIP 0.1uF 10%	16V
				C327	1-127-715-11	CERAMIC CHIP 0.22uF 10%	16V
				C328	1-127-715-11	CERAMIC CHIP 0.22uF 10%	16V
				C330	1-216-864-11	SHORT CHIP 0	
				C331	1-216-864-11	SHORT CHIP 0	
				C360	1-165-908-11	CERAMIC CHIP 1uF 10%	10V
				C361	1-165-908-11	CERAMIC CHIP 1uF 10%	10V
				C362	1-165-908-11	CERAMIC CHIP 1uF 10%	10V
				C363	1-115-871-11	ELECT 1uF 20%	50V
				C364	1-115-871-11	ELECT 1uF 20%	50V
				C401	1-124-584-00	ELECT 100uF 20%	10V
				C402	1-162-970-11	CERAMIC CHIP 0.01uF 10%	25V
				C403	1-126-176-11	ELECT 220uF 20%	10V
				C405	1-124-248-00	ELECT 22uF 20%	25V
				C410	1-162-927-11	CERAMIC CHIP 100PF 5%	50V

MAIN

Ref. No.	Part No.	Description	Remark	Ref. No.	Part No.	Description	Remark
C411	1-162-927-11	CERAMIC CHIP	100PF 5%	50V		< CONNECTOR >	
C412	1-162-970-11	CERAMIC CHIP	0.01uF 10%	25V			
C413	1-163-251-11	CERAMIC CHIP	100PF 5%	50V			
C414	1-163-251-11	CERAMIC CHIP	100PF 5%	50V			
C415	1-162-970-11	CERAMIC CHIP	0.01uF 10%	25V			
C417	1-162-970-11	CERAMIC CHIP	0.01uF 10%	25V			
C418	1-162-966-11	CERAMIC CHIP	0.0022uF 10%	50V			
C419	1-162-966-11	CERAMIC CHIP	0.0022uF 10%	50V			
C421	1-126-964-11	ELECT	10uF 20%	50V			
C422	1-163-251-11	CERAMIC CHIP	100PF 5%	50V			
C423	1-165-908-11	CERAMIC CHIP	1uF 10%	10V			
C431	1-126-964-11	ELECT	10uF 20%	50V			
C432	1-163-251-11	CERAMIC CHIP	100PF 5%	50V			
C441	1-126-964-11	ELECT	10uF 20%	50V			
C442	1-163-251-11	CERAMIC CHIP	100PF 5%	50V			
C443	1-165-908-11	CERAMIC CHIP	1uF 10%	10V			
C446	1-165-908-11	CERAMIC CHIP	1uF 10%	10V			
C447	1-165-908-11	CERAMIC CHIP	1uF 10%	10V			
C452	1-163-251-11	CERAMIC CHIP	100PF 5%	50V			
C461	1-126-964-11	ELECT	10uF 20%	50V			
C462	1-165-908-11	CERAMIC CHIP	1uF 10%	10V			
C465	1-165-908-11	CERAMIC CHIP	1uF 10%	10V			
C466	1-165-908-11	CERAMIC CHIP	1uF 10%	10V			
C471	1-126-964-11	ELECT	10uF 20%	50V			
C472	1-165-908-11	CERAMIC CHIP	1uF 10%	10V			
C480	1-136-159-00	FILM	0.033uF 5%	50V			
C481	1-136-159-00	FILM	0.033uF 5%	50V			
C482	1-162-968-11	CERAMIC CHIP	0.0047uF 10%	50V			
C483	1-162-968-11	CERAMIC CHIP	0.0047uF 10%	50V			
C484	1-107-826-11	CERAMIC CHIP	0.1uF 10%	16V			
C485	1-104-665-11	ELECT	100uF 20%	25V			
C487	1-126-964-11	ELECT	10uF 20%	50V			
C491	1-124-589-11	ELECT	47uF 20%	16V			
C494	1-216-864-11	SHORT CHIP	0				
C501	1-128-057-11	ELECT	330uF 20%	6.3V			
C502	1-162-970-11	CERAMIC CHIP	0.01uF 10%	25V			
C503	1-124-584-00	ELECT	100uF 20%	10V			
C504	1-162-970-11	CERAMIC CHIP	0.01uF 10%	25V			
C505	1-124-584-00	ELECT	100uF 20%	10V			
C506	1-165-908-11	CERAMIC CHIP	1uF 10%	10V			
C507	1-162-970-11	CERAMIC CHIP	0.01uF 10%	25V			
C508	1-162-964-11	CERAMIC CHIP	0.001uF 10%	50V			
C509	1-162-970-11	CERAMIC CHIP	0.01uF 10%	25V			
C510	1-162-964-11	CERAMIC CHIP	0.001uF 10%	50V			
C511	1-162-964-11	CERAMIC CHIP	0.001uF 10%	50V			
C512	1-162-964-11	CERAMIC CHIP	0.001uF 10%	50V			
C513	1-162-964-11	CERAMIC CHIP	0.001uF 10%	50V			
C515	1-162-916-11	CERAMIC CHIP	12PF 5%	50V			
C516	1-162-917-11	CERAMIC CHIP	15PF 5%	50V			
C519	1-107-826-11	CERAMIC CHIP	0.1uF 10%	16V			
C523	1-162-927-11	CERAMIC CHIP	100PF 5%	50V			
C600	1-126-941-11	ELECT	470uF 20%	25V			
C601	1-162-970-11	CERAMIC CHIP	0.01uF 10%	25V			
C602	1-165-319-11	CERAMIC CHIP	0.1uF 50V				
C701	1-112-302-11	ELECT	3300uF 20%	16V			
C702	1-126-160-11	ELECT	1uF 20%	50V			
C704	1-115-340-11	CERAMIC CHIP	0.22uF 10%	25V			
C901	1-163-009-11	CERAMIC CHIP	0.001uF 10%	50V			
C902	1-163-009-11	CERAMIC CHIP	0.001uF 10%	50V			
CN300	1-774-701-21	PIN, CONNECTOR	16P				
CN350	1-820-611-11	CONNECTOR, BOARD TO BOARD	28P				
* CN410	1-564-506-11	PLUG, CONNECTOR	3P				
* CN702	1-770-524-31	CONNECTOR, FFC/FPC	17P				
CNJ400	1-580-907-41	PLUG, CONNECTOR	8P (BUS CONTROL IN)				
						< DIODE >	
D2	6-501-734-01	DIODE	MAZ8056GMLS0				
D101	6-501-743-01	DIODE	MAZ8068GMLS0				
D102	6-501-782-01	DIODE	MAZ8180GMLS0				
D103	6-501-782-01	DIODE	MAZ8180GMLS0				
D104	6-501-782-01	DIODE	MAZ8180GMLS0				
D105	6-501-743-01	DIODE	MAZ8068GMLS0				
D106	6-501-743-01	DIODE	MAZ8068GMLS0				
D107	6-501-743-01	DIODE	MAZ8068GMLS0				
D108	6-501-743-01	DIODE	MAZ8068GMLS0				
D109	6-501-743-01	DIODE	MAZ8068GMLS0				
D110	6-501-743-01	DIODE	MAZ8068GMLS0				
D114	6-501-743-01	DIODE	MAZ8068GMLS0				
D115	6-501-743-01	DIODE	MAZ8068GMLS0				
D116	6-501-170-01	DIODE	UDZW-TE17-6.8B				
D301	6-500-522-01	DIODE	10EDB40-TA1B2				
D302	6-500-522-01	DIODE	10EDB40-TA1B2				
D303	6-500-522-01	DIODE	10EDB40-TA1B2				
D304	6-500-522-01	DIODE	10EDB40-TA1B2				
D305	6-500-522-01	DIODE	10EDB40-TA1B2				
D306	6-500-522-01	DIODE	10EDB40-TA1B2				
D307	6-500-522-01	DIODE	10EDB40-TA1B2				
D308	6-500-522-01	DIODE	10EDB40-TA1B2				
D309	6-500-522-01	DIODE	10EDB40-TA1B2				
D310	6-500-522-01	DIODE	10EDB40-TA1B2				
D311	6-500-522-01	DIODE	10EDB40-TA1B2				
D312	6-500-522-01	DIODE	10EDB40-TA1B2				
D400	6-501-656-01	DIODE	LBAT54ALT1G				
D491	6-501-817-01	DIODE	MA2J1110GLS0				
D493	6-501-654-01	DIODE	LBAT54CLT1G				
D494	6-501-656-01	DIODE	LBAT54ALT1G				
D501	8-719-050-37	DIODE	M1MA152WA-T1				
D502	8-719-060-48	DIODE	RB751V-40TE-17				
D511	6-501-654-01	DIODE	LBAT54CLT1G				
D602	6-501-782-01	DIODE	MAZ8180GMLS0				
D603	6-501-739-01	DIODE	MAZ8062GHL50				
D604	6-501-782-01	DIODE	MAZ8180GMLS0				
D605	6-501-782-01	DIODE	MAZ8180GMLS0				
D606	8-719-072-70	DIODE	MA2ZD14001S0				
D607	6-501-571-01	DIODE	1N5404-C311-3				
D701	6-501-782-01	DIODE	MAZ8180GMLS0				
D702	6-501-782-01	DIODE	MAZ8180GMLS0				
						< FERRITE BEAD >	
FB401	1-414-595-11	INDUCTOR, FERRITE BEAD					
FB402	1-216-864-11	SHORT CHIP	0				
FB403	1-216-864-11	SHORT CHIP	0				
FB404	1-216-295-11	SHORT CHIP	0				
FB405	1-216-864-11	SHORT CHIP	0				
FB406	1-216-864-11	SHORT CHIP	0				
FB407	1-216-295-11	SHORT CHIP	0				
FB408	1-216-864-11	SHORT CHIP	0				

Ref. No.	Part No.	Description	Remark	Ref. No.	Part No.	Description	Remark
		< IC >					
IC300	6-705-359-02	IC TDA8588AJ/N2/R1		Q491	8-729-027-23	TRANSISTOR DTA114EKA-T146	
IC401	6-710-065-01	IC BD3442FS-E2		Q492	8-729-027-43	TRANSISTOR DTC114EKA-T146	
IC501	6-807-655-01	IC MB90F045PF-G-9060-SPE1		Q501	8-729-027-23	TRANSISTOR DTA114EKA-T146	
IC502	6-711-653-01	IC S-1206B33-U3T1G		Q589	8-729-027-43	TRANSISTOR DTC114EKA-T146	
IC601	6-703-884-01	IC BA8271F-E2		Q590	8-729-027-23	TRANSISTOR DTA114EKA-T146	
IC602	8-759-659-13	IC PST3428UL		Q600	8-729-047-76	TRANSISTOR FMC2A-T148	
		< JACK >		Q601	8-729-027-23	TRANSISTOR DTA114EKA-T146	
J1	1-815-185-13	JACK (ANTENNA)		Q605	8-729-027-43	TRANSISTOR DTC114EKA-T146	
J370	1-566-822-41	JACK (REMOTE IN)		Q702	8-729-620-07	TRANSISTOR 2SC3052EF-T1-LEF	
J451	1-774-700-41	JACK, PIN 6P (BUS AUDIO IN, REAR AUDIO OUT,FRONT AUDIO OUT)				< RESISTOR >	
		< JUMPER RESISTOR >		R2	1-216-839-11	METAL CHIP 33K 5%	1/10W
JC3	1-216-864-11	SHORT CHIP 0		R3	1-216-843-11	METAL CHIP 68K 5%	1/10W
JC53	1-216-864-11	SHORT CHIP 0		R4	1-216-839-11	METAL CHIP 33K 5%	1/10W
JC300	1-216-296-11	SHORT CHIP 0		R5	1-216-843-11	METAL CHIP 68K 5%	1/10W
JC301	1-216-296-11	SHORT CHIP 0		R6	1-414-595-11	INDUCTOR, FERRITE BEAD	
JC302	1-216-296-11	SHORT CHIP 0		R7	1-414-595-11	INDUCTOR, FERRITE BEAD	
JC304	1-216-864-11	SHORT CHIP 0		R10	1-216-821-11	METAL CHIP 1K 5%	1/10W
JC305	1-216-296-11	SHORT CHIP 0		R12	1-414-595-11	INDUCTOR, FERRITE BEAD	
JC350	1-216-296-11	SHORT CHIP 0		R13	1-414-595-11	INDUCTOR, FERRITE BEAD	
JC400	1-216-295-11	SHORT CHIP 0		R144	1-249-413-11	CARBON 470 5%	1/4W
JC401	1-216-864-11	SHORT CHIP 0		R146	1-249-413-11	CARBON 470 5%	1/4W
JC490	1-216-296-11	SHORT CHIP 0		R301	1-216-811-11	METAL CHIP 150 5%	1/10W
JC491	1-216-296-11	SHORT CHIP 0		R302	1-216-841-11	METAL CHIP 47K 5%	1/10W
JC501	1-216-296-11	SHORT CHIP 0		R351	1-216-845-11	METAL CHIP 100K 5%	1/10W
JC503	1-216-296-11	SHORT CHIP 0		R355	1-216-834-11	METAL CHIP 12K 5%	1/10W
JC504	1-216-296-11	SHORT CHIP 0		R356	1-216-834-11	METAL CHIP 12K 5%	1/10W
JC508	1-216-296-11	SHORT CHIP 0		R357	1-414-595-11	INDUCTOR, FERRITE BEAD	
JC509	1-216-864-11	SHORT CHIP 0		R358	1-414-595-11	INDUCTOR, FERRITE BEAD	
JC511	1-216-864-11	SHORT CHIP 0		R359	1-500-329-21	INDUCTOR, FERRITE BEAD	
JC512	1-216-864-11	SHORT CHIP 0		R361	1-216-821-11	METAL CHIP 1K 5%	1/10W
JC518	1-216-296-11	SHORT CHIP 0		R370	1-216-809-11	METAL CHIP 100 5%	1/10W
JC522	1-216-295-11	SHORT CHIP 0		R371	1-216-809-11	METAL CHIP 100 5%	1/10W
JC523	1-216-864-11	SHORT CHIP 0		R400	1-216-296-11	SHORT CHIP 0	
JC524	1-216-296-11	SHORT CHIP 0		R401	1-216-821-11	METAL CHIP 1K 5%	1/10W
JC600	1-216-864-11	SHORT CHIP 0		R402	1-216-821-11	METAL CHIP 1K 5%	1/10W
JC602	1-216-296-11	SHORT CHIP 0		R407	1-216-864-11	SHORT CHIP 0	
JC603	1-216-296-11	SHORT CHIP 0		R411	1-216-833-11	METAL CHIP 10K 5%	1/10W
		< COIL >		R416	1-216-821-11	METAL CHIP 1K 5%	1/10W
L1	1-500-245-11	INDUCTOR, FERRITE BEAD		R417	1-216-833-11	METAL CHIP 10K 5%	1/10W
L4	1-469-844-11	INDUCTOR 2.2uH		R418	1-216-821-11	METAL CHIP 1K 5%	1/10W
L101	1-410-509-11	INDUCTOR 10uH		R419	1-216-833-11	METAL CHIP 10K 5%	1/10W
L300	1-456-617-11	COIL, CHOKE		R421	1-216-813-11	METAL CHIP 220 5%	1/10W
L301	1-216-864-11	SHORT CHIP 0		R422	1-216-833-11	METAL CHIP 10K 5%	1/10W
L302	1-216-864-11	SHORT CHIP 0		R431	1-216-813-11	METAL CHIP 220 5%	1/10W
L303	1-216-864-11	SHORT CHIP 0		R432	1-216-833-11	METAL CHIP 10K 5%	1/10W
L500	1-469-844-11	INDUCTOR 2.2uH		R433	1-218-883-11	METAL CHIP 33K 0.5%	1/10W
		< TRANSISTOR >		R441	1-216-813-11	METAL CHIP 220 5%	1/10W
Q3	8-729-106-68	TRANSISTOR 2SD1615A-GP		R442	1-216-833-11	METAL CHIP 10K 5%	1/10W
Q420	6-551-856-01	TRANSISTOR LTC614TKFP8T146		R452	1-216-833-11	METAL CHIP 10K 5%	1/10W
Q430	6-551-856-01	TRANSISTOR LTC614TKFP8T146		R453	1-216-864-11	SHORT CHIP 0	
Q440	6-551-856-01	TRANSISTOR LTC614TKFP8T146		R454	1-216-864-11	SHORT CHIP 0	
Q460	6-551-856-01	TRANSISTOR LTC614TKFP8T146		R455	1-216-825-11	METAL CHIP 2.2K 5%	1/10W
Q470	6-551-856-01	TRANSISTOR LTC614TKFP8T146		R461	1-216-813-11	METAL CHIP 220 5%	1/10W
				R471	1-216-813-11	METAL CHIP 220 5%	1/10W
				R474	1-216-864-11	SHORT CHIP 0	
				R480	1-216-827-11	METAL CHIP 3.3K 5%	1/10W
				R481	1-216-827-11	METAL CHIP 3.3K 5%	1/10W
				R482	1-216-827-11	METAL CHIP 3.3K 5%	1/10W
				R483	1-216-827-11	METAL CHIP 3.3K 5%	1/10W
				R484	1-216-821-11	METAL CHIP 1K 5%	1/10W

MAIN **SERVO**

Ref. No.	Part No.	Description	Remark
R491	1-216-805-11	METAL CHIP 47 5%	1/10W
R494	1-216-825-11	METAL CHIP 2.2K 5%	1/10W
R500	1-216-817-11	METAL CHIP 470 5%	1/10W
R501	1-216-845-11	METAL CHIP 100K 5%	1/10W
R503	1-216-845-11	METAL CHIP 100K 5%	1/10W
R507	1-216-845-11	METAL CHIP 100K 5%	1/10W
R509	1-216-845-11	METAL CHIP 100K 5%	1/10W
R510	1-216-833-11	METAL CHIP 10K 5%	1/10W
R511	1-216-845-11	METAL CHIP 100K 5%	1/10W
R513	1-216-809-11	METAL CHIP 100 5%	1/10W
R514	1-216-809-11	METAL CHIP 100 5%	1/10W
R515	1-216-809-11	METAL CHIP 100 5%	1/10W
R516	1-216-809-11	METAL CHIP 100 5%	1/10W
R517	1-216-845-11	METAL CHIP 100K 5%	1/10W
R518	1-216-845-11	METAL CHIP 100K 5%	1/10W
R519	1-218-871-11	METAL CHIP 10K 0.5%	1/10W
R520	1-218-871-11	METAL CHIP 10K 0.5%	1/10W
R521	1-216-821-11	METAL CHIP 1K 5%	1/10W
R522	1-218-871-11	METAL CHIP 10K 0.5%	1/10W
R523	1-216-845-11	METAL CHIP 100K 5%	1/10W
R524	1-216-845-11	METAL CHIP 100K 5%	1/10W
R525	1-216-845-11	METAL CHIP 100K 5%	1/10W
R526	1-216-841-11	METAL CHIP 47K 5%	1/10W
R527	1-216-845-11	METAL CHIP 100K 5%	1/10W
R528	1-216-833-11	METAL CHIP 10K 5%	1/10W
R529	1-216-845-11	METAL CHIP 100K 5%	1/10W
R530	1-216-845-11	METAL CHIP 100K 5%	1/10W
R531	1-216-845-11	METAL CHIP 100K 5%	1/10W
R532	1-216-845-11	METAL CHIP 100K 5%	1/10W
R534	1-216-845-11	METAL CHIP 100K 5%	1/10W
R535	1-216-809-11	METAL CHIP 100 5%	1/10W
R536	1-216-811-11	METAL CHIP 150 5%	1/10W
R537	1-216-845-11	METAL CHIP 100K 5%	1/10W
R538	1-216-845-11	METAL CHIP 100K 5%	1/10W
R539	1-216-809-11	METAL CHIP 100 5%	1/10W
R540	1-216-809-11	METAL CHIP 100 5%	1/10W
R541	1-216-849-11	METAL CHIP 220K 5%	1/10W
R543	1-216-845-11	METAL CHIP 100K 5%	1/10W
R545	1-216-845-11	METAL CHIP 100K 5%	1/10W
R546	1-216-845-11	METAL CHIP 100K 5%	1/10W
R547	1-216-827-11	METAL CHIP 3.3K 5%	1/10W
R548	1-216-825-11	METAL CHIP 2.2K 5%	1/10W
R549	1-216-825-11	METAL CHIP 2.2K 5%	1/10W
R550	1-216-845-11	METAL CHIP 100K 5%	1/10W
R551	1-216-864-11	SHORT CHIP 0	
R553	1-216-821-11	METAL CHIP 1K 5%	1/10W
R554	1-216-821-11	METAL CHIP 1K 5%	1/10W
R555	1-216-833-11	METAL CHIP 10K 5%	1/10W
R556	1-216-833-11	METAL CHIP 10K 5%	1/10W
R557	1-216-809-11	METAL CHIP 100 5%	1/10W
R558	1-216-809-11	METAL CHIP 100 5%	1/10W
R559	1-216-845-11	METAL CHIP 100K 5%	1/10W
R562	1-216-845-11	METAL CHIP 100K 5%	1/10W
R563	1-216-845-11	METAL CHIP 100K 5%	1/10W
R573	1-216-845-11	METAL CHIP 100K 5%	1/10W
R574	1-216-845-11	METAL CHIP 100K 5%	1/10W
R577	1-216-845-11	METAL CHIP 100K 5%	1/10W
R579	1-216-845-11	METAL CHIP 100K 5%	1/10W
R580	1-216-845-11	METAL CHIP 100K 5%	1/10W
R583	1-216-845-11	METAL CHIP 100K 5%	1/10W

Ref. No.	Part No.	Description	Remark
R584	1-216-845-11	METAL CHIP 100K 5%	1/10W
R601	1-216-851-11	METAL CHIP 330K 5%	1/10W
R602	1-216-851-11	METAL CHIP 330K 5%	1/10W
R603	1-216-821-11	METAL CHIP 1K 5%	1/10W
R604	1-216-835-11	METAL CHIP 15K 5%	1/10W
R605	1-216-809-11	METAL CHIP 100 5%	1/10W
R606	1-216-821-11	METAL CHIP 1K 5%	1/10W
R607	1-216-821-11	METAL CHIP 1K 5%	1/10W
R608	1-216-829-11	METAL CHIP 4.7K 5%	1/10W
R610	1-216-809-11	METAL CHIP 100 5%	1/10W
R611	1-216-809-11	METAL CHIP 100 5%	1/10W
R701	1-216-821-11	METAL CHIP 1K 5%	1/10W
R705	1-249-425-11	CARBON 4.7K 5%	1/4W
R706	1-216-841-11	METAL CHIP 47K 5%	1/10W
R707	1-216-841-11	METAL CHIP 47K 5%	1/10W
R708	1-216-829-11	METAL CHIP 4.7K 5%	1/10W
S102	1-786-458-11	SWITCH, PUSH (1 KEY) (FRONT PANEL DETECT)	
S103	1-786-826-11	SWITCH, TACTILE (RESET)	
S501	1-571-478-11	SWITCH, SLIDE (FREQUENCY SELECT)	
TH400	1-803-350-21	THERMISTOR, POSITIVE < TUNER UNIT >	
TU1	A-3220-960-B	TUNER UNIT (TUX-032) < VIBRATOR >	
X500	1-813-524-21	VIBRATOR, CERAMIC (18.432MHz)	
X501	1-767-317-11	VIBRATOR, CRYSTAL (32.768kHz)	

A-1177-201-A	SERVO BOARD, COMPLETE *****		

SUB BOARD *****			
< CONNECTOR >			
CN201	1-819-782-11	SOCKET, CONNECTOR 16P	
< DIODE >			
LED201	8-719-053-08	LED SML-310DTT86 (DISC IN)	
LED202	8-719-053-08	LED SML-310DTT86 (▲)	
< RESISTOR >			
R201	1-216-813-11	METAL CHIP 220 5%	1/10W
R202	1-216-818-11	METAL CHIP 560 5%	1/10W
< SWITCH >			
S201	1-786-653-21	SWITCH, TACTILE (▲)	

Ref. No.	Part No.	Description	Remark
MISCELLANEOUS *****			
3	1-834-507-11	CABLE, FLEXIBLE FLAT (17 CORE) (CN202)	
12	1-833-974-21	CONNECTION CORD FOR AUTOMOBILE (POWER)	
13	1-833-887-11	CONNECTION CORD (RCA) (SUB OUT (MONO))	
△ 103	X-2149-672-1	SERVICE ASSY, OP (DAX-25A)	
FU601	1-532-877-11	FUSE (BLADE TYPE) (AUTO FUSE) 10A	

ACCESSORIES

1-479-077-13	REMOTE COMMANDER (RM-X151)	
2-548-729-01	LID, BATTERY CASE (for RM-X151)	
3-217-494-32	MANUAL, INSTRUCTION (ENGLISH,SPANISH, PERSIAN)	
3-217-595-32	MANUAL, INSTRUCTION, INSTALL (ENGLISH, SPANISH,PERSIAN)	
X-2187-544-1	CASE ASSY (for FRONT PANEL)	

PARTS FOR INSTALLATION AND CONNECTIONS

151	X-2179-431-1	FRAME ASSY, FITTING
152	1-833-974-21	CONNECTION CORD FOR AUTOMOBILE (POWER)
153	3-246-471-01	KEY (FRAME)
154	3-209-713-01	COLLAR
155	X-3381-154-1	SCREW ASSY (BS4), FITTING
156	3-349-410-11	BUSHING
157	3-934-325-01	SCREW, +K (5X8) TAPPING

