

# Visitor Centre: News.

## How to Book a Tour.

Call: **020 3053 3991** during office hours OR  
Email: **VisitorCentre.gb@jw.org** and request a 'Booking Form'



## The Time Left is Reduced

Our Branch construction project is now in its final stages. All buildings are almost complete and the wildflower meadows, ponds and botanic garden are simply stunning to look at.

**The Visitor Centre closes on November 29, 2019**, and we have excellent tour availability up until that date. If you are one of the 80,000 that has visited before, why not come and see how the site and tour have changed? If you have yet to come, we warmly encourage you to visit before we close.

Touring a branch project during the construction phase has rarely been possible before. In addition, it may be some months after the project concludes before the new branch opens to visitors. Book now to avoid missing this faith-strengthening opportunity!

## Tours.

Monday to Friday

Duration: 1 hour



9 AM



10 AM



11 AM



1 PM



2 PM



3 PM

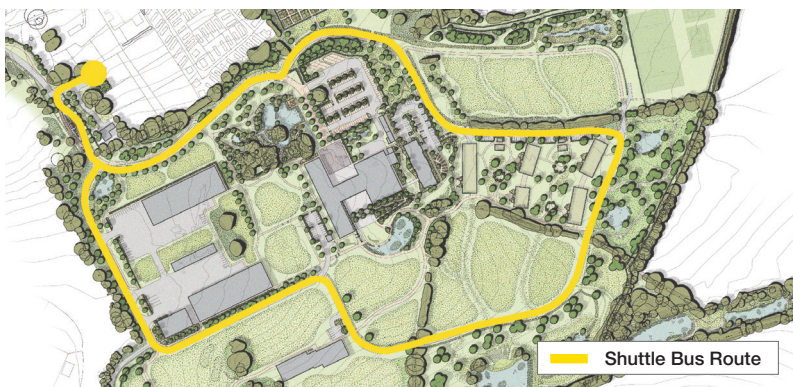

## New Shuttle Bus Route

An exciting change has been made to the tour. Visitors can now enjoy being driven around the full perimeter road with one of our experienced guides, enabling you to see more of the site than ever before!

Scan the code to  
preview the site



**Visitor Centre Closing Date: November 29, 2019**