

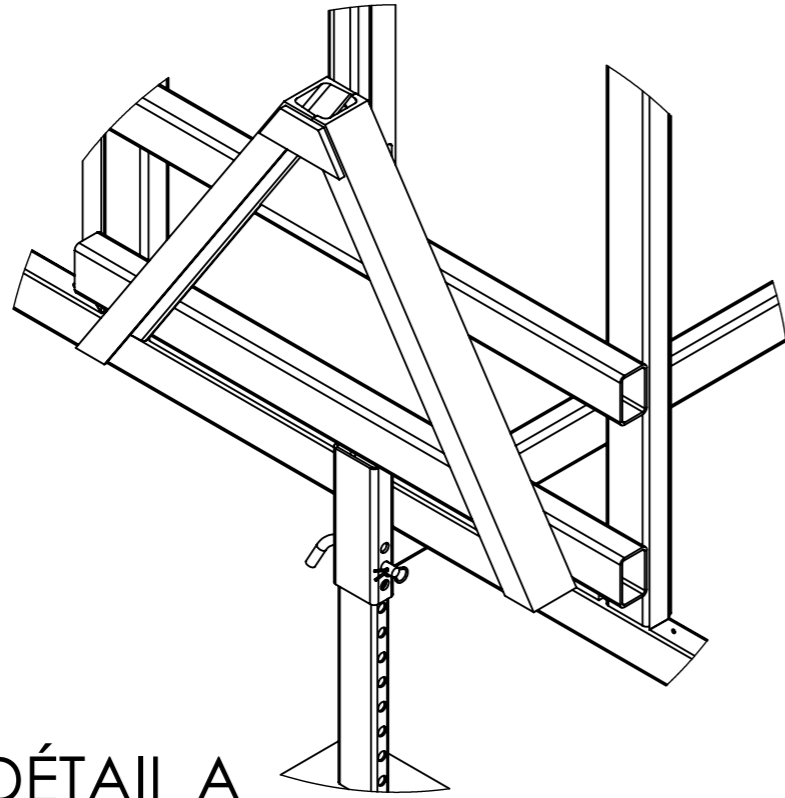

Version	1.0	Qté	1	
Date	03/06/2016			
Outil	Cabane à porc			
Pièce	Vue d'ensemble			Page : 1 / 7

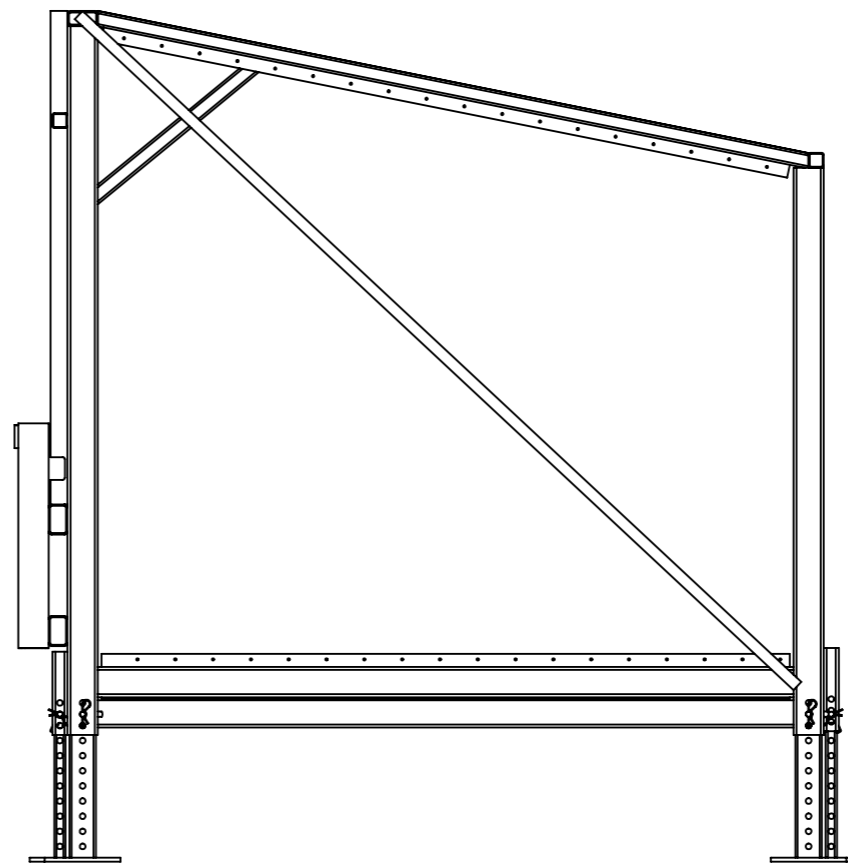

DÉTAIL A
ECHELLE 1 : 10

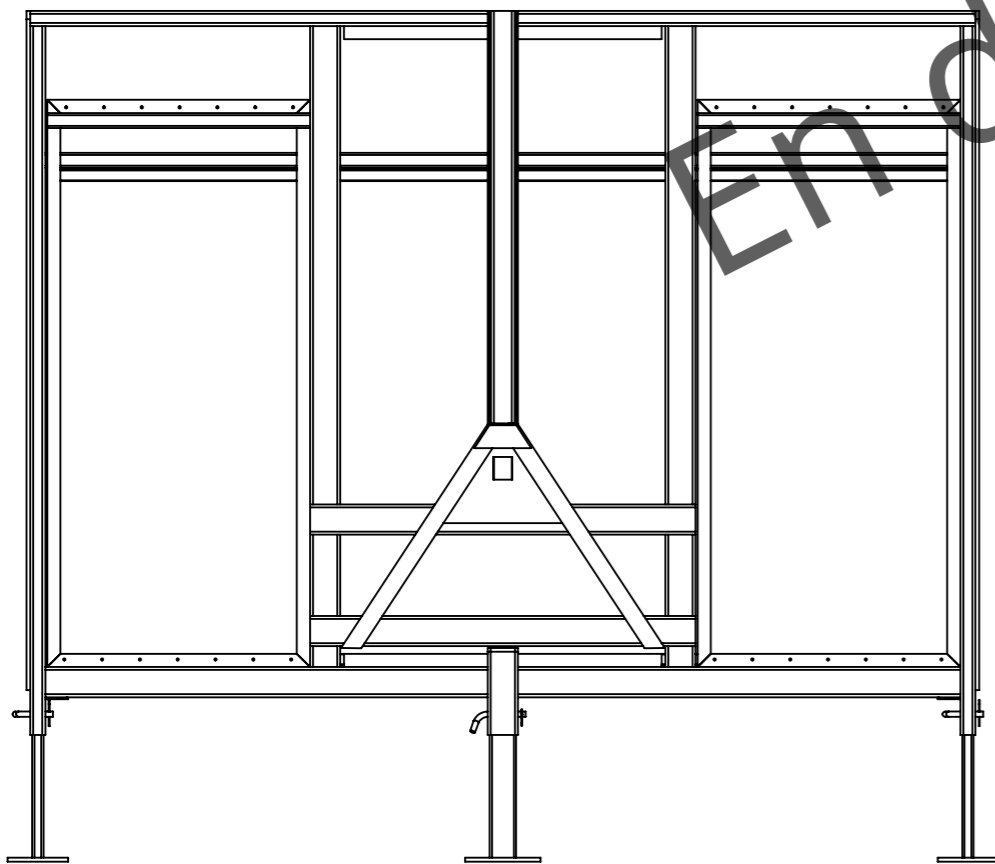
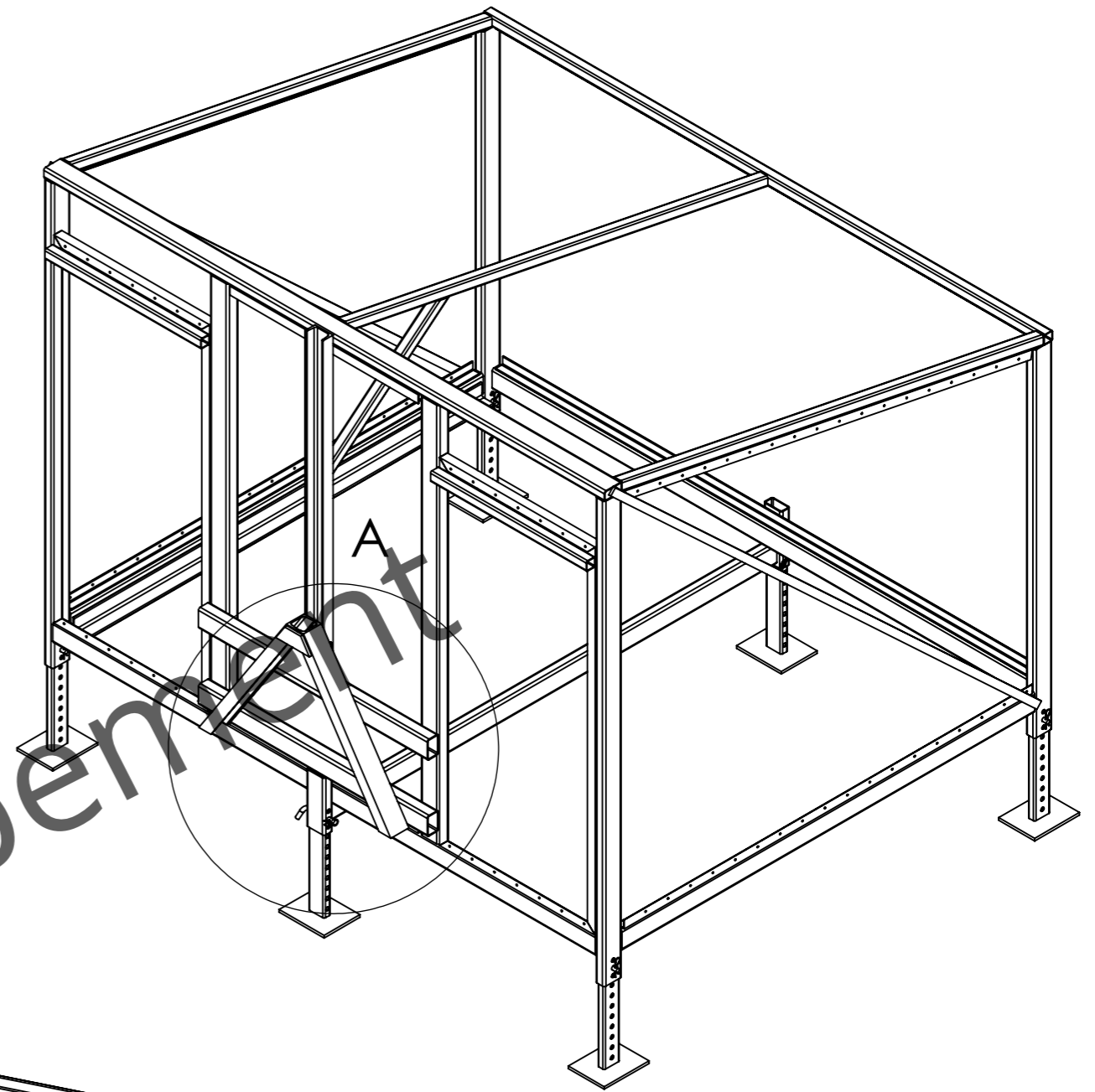

En développement

Version	1.0	Qté	1	
Date	03/06/2016			
Outil	Cabane à porc			
Pièce	Nomenclature		Page : 2 / 7	

N°	Désignation	Longueur	Qté
A1	tube rectangulaire 80 x 40 x 4	2420	2
A2	tube rectangulaire 80 x 40 x 4	1840	2
A3	tube rectangulaire 80 x 40 x 4	1500	2
A4	tube rectangulaire 80 x 40 x 4	1875	2
A5	tube rectangulaire 80 x 40 x 4	2500	1
A6	tube carré 40 x 3	2500	1
A7	tube rectangulaire 80 x 40 x 4	2000	1
A9	tube rectangulaire 80 x 40 x 4	220	2
A8	tube carré 40 x 3	1925	3
A11	Profilé UPN 80 x 45	1305	1
A12	tube rectangulaire 80 x 50 x 4	1695	2
A13	tube rectangulaire 80 x 50 x 4	1020	2
TR3	Fer plat 60 x 10	150	1
TR1	Profilé UPN 80 x 45	740	1
TR2	Profilé UPN 80 x 45	740	1
A16	Cornière 35 x 35 x 3,5	2400	2
A17	Cornière 35 x 35 x 3,5	1850	2
A18	Cornière 35 x 35 x 3,5	1820	2
A19	Cornière 35 x 35 x 3,5	840	2
A18	Cornière 60 x 60 x 5	1820	2
A20	tube carré 40 x 3	700	1
B1	tube rectangulaire 70 x 30 x 3	500	4
B2	Large plat 160 x 10	200	4
TR4	Tôle triangle intérieure		1
D1	tube rectangulaire 70 x 30 x 3	500	2
D2	Large plat 160 x 10	200	2
Broche 1	étiré rond Ø14	130	4
Broche	étiré rond Ø14	170	2
Goupille	Goupille épingle d'axe, 15x70 Ø4		6
C2	Cornière 35 x 35 x 3,5	695	4
C3	Cornière 35 x 35 x 3,5	1500	4
C1	tube carré 40 x 3	695	2
A22	Fer plat 30 x 10	2600	2

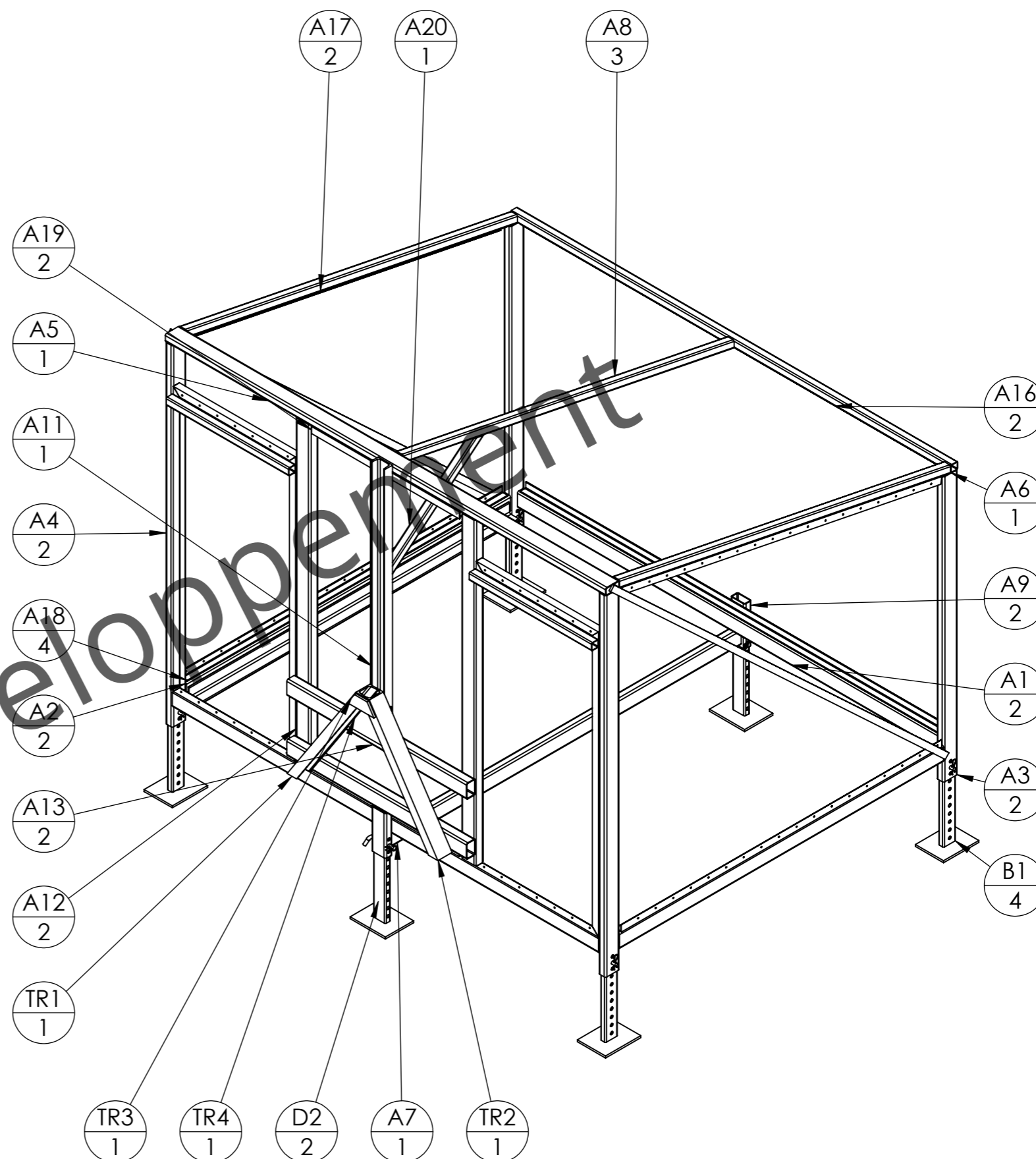

Version	1.0	Qté	1	
Date	03/06/2016			
Outil	Cabane à porc			
Pièce	Châssis A			

Page : 3 / 7

N°	Désignation	Longueur	Qté
A1	tube rectangulaire 80 x 40 x 4	2420	2
A2	tube rectangulaire 80 x 40 x 4	1840	2
A3	tube rectangulaire 80 x 40 x 4	1500	2
A4	tube rectangulaire 80 x 40 x 4	1875	2
A5	tube rectangulaire 80 x 40 x 4	2500	1
A6	tube carré 40 x 3	2500	1
A7	tube rectangulaire 80 x 40 x 4	2000	1
A9	tube rectangulaire 80 x 40 x 4	220	2
A8	tube carré 40 x 3	1925	3
A11	Profilé UPN 80 x 45	1305	1
A12	tube rectangulaire 80 x 50 x 4	1695	2
A13	tube rectangulaire 80 x 50 x 4	1020	2
TR3	Fer plat 60 x 10	150	1
TR1	Profilé UPN 80 x 45	740	1
TR2	Profilé UPN 80 x 45	740	1
TR4	Tôle triangle intérieure		1
A16	Cornière 35 x 35 x 3,5	2400	2
A17	Cornière 35 x 35 x 3,5	1850	2
A18	Cornière 35 x 35 x 3,5	1820	2
A19	Cornière 35 x 35 x 3,5	840	2
A18	Cornière 60 x 60 x 5	1820	2
A20	tube carré 40 x 3	700	1
A22	Fer plat 30 x 10	2600	2

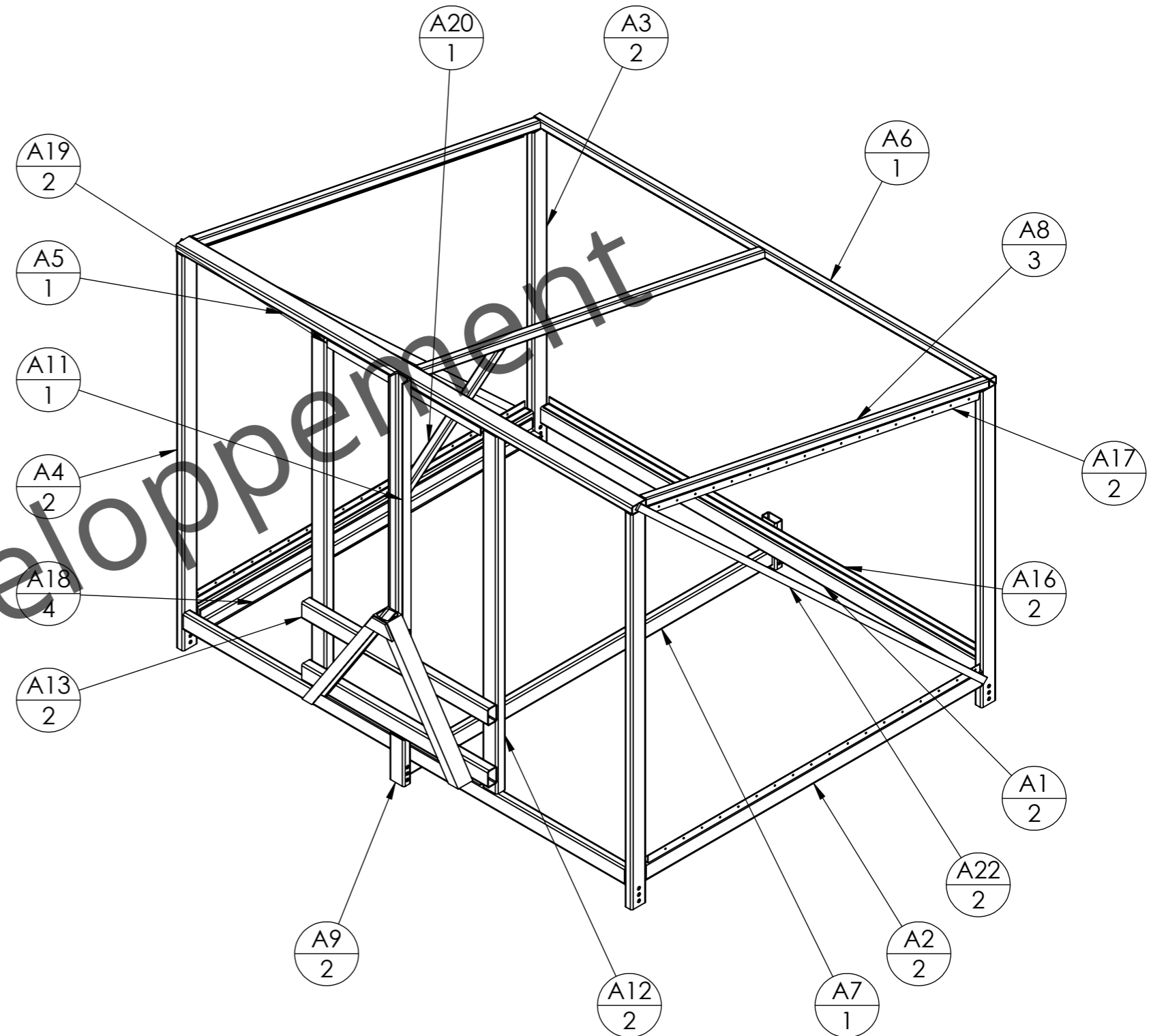

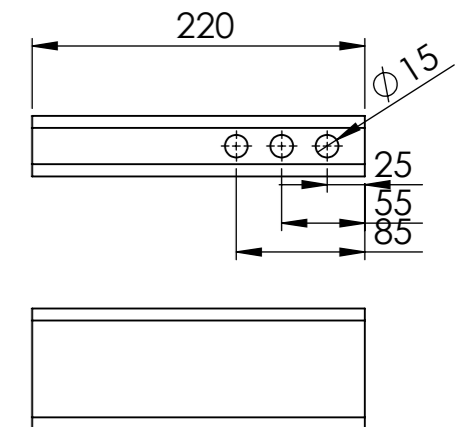
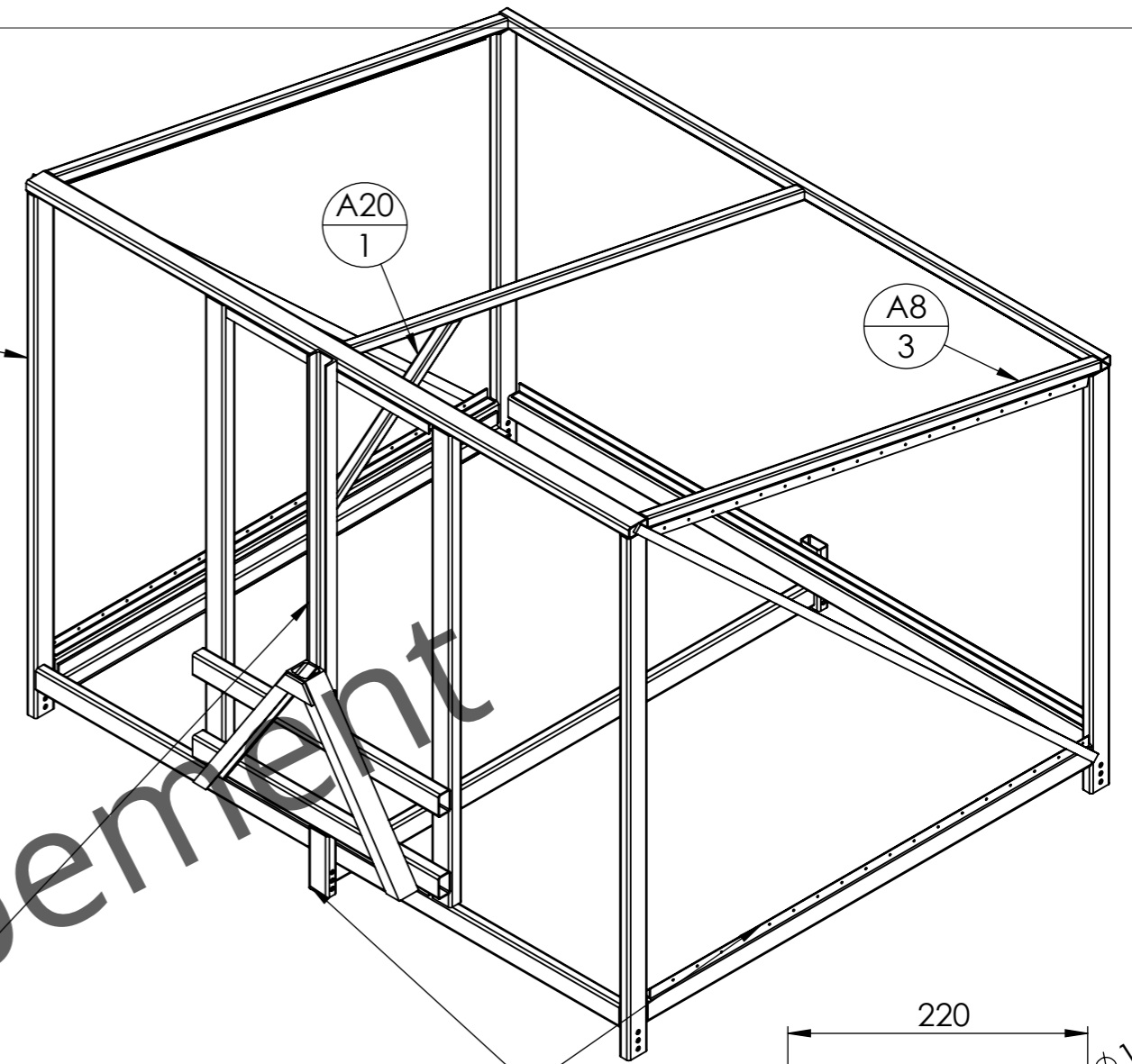
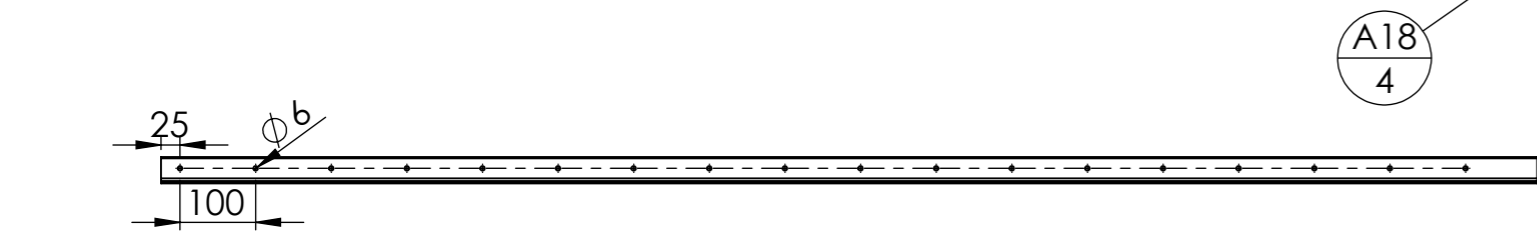
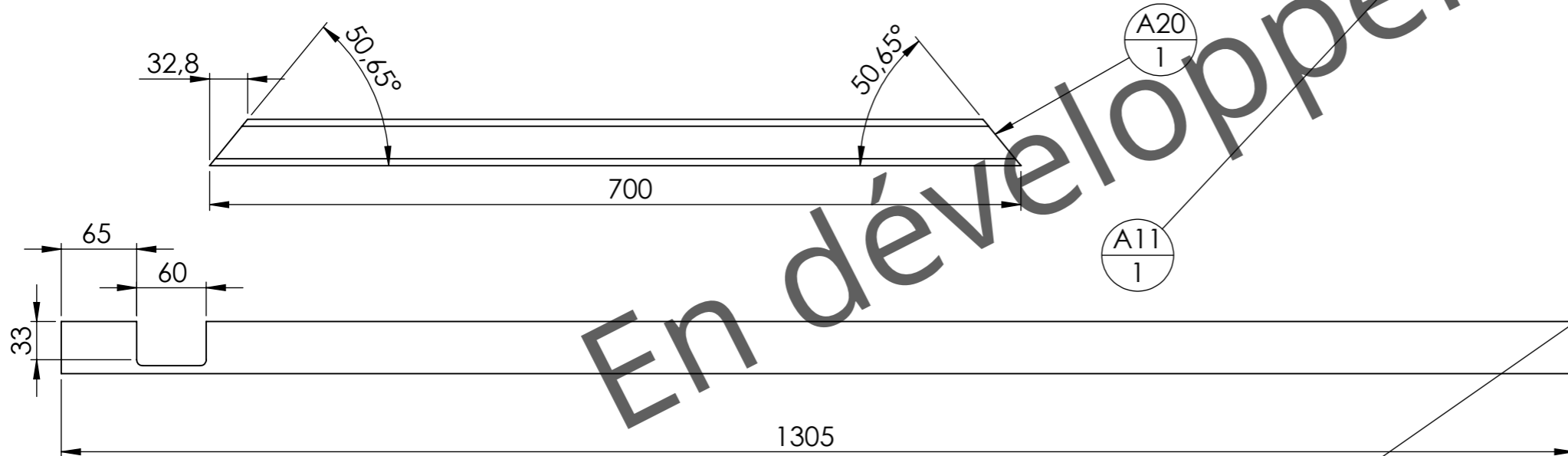
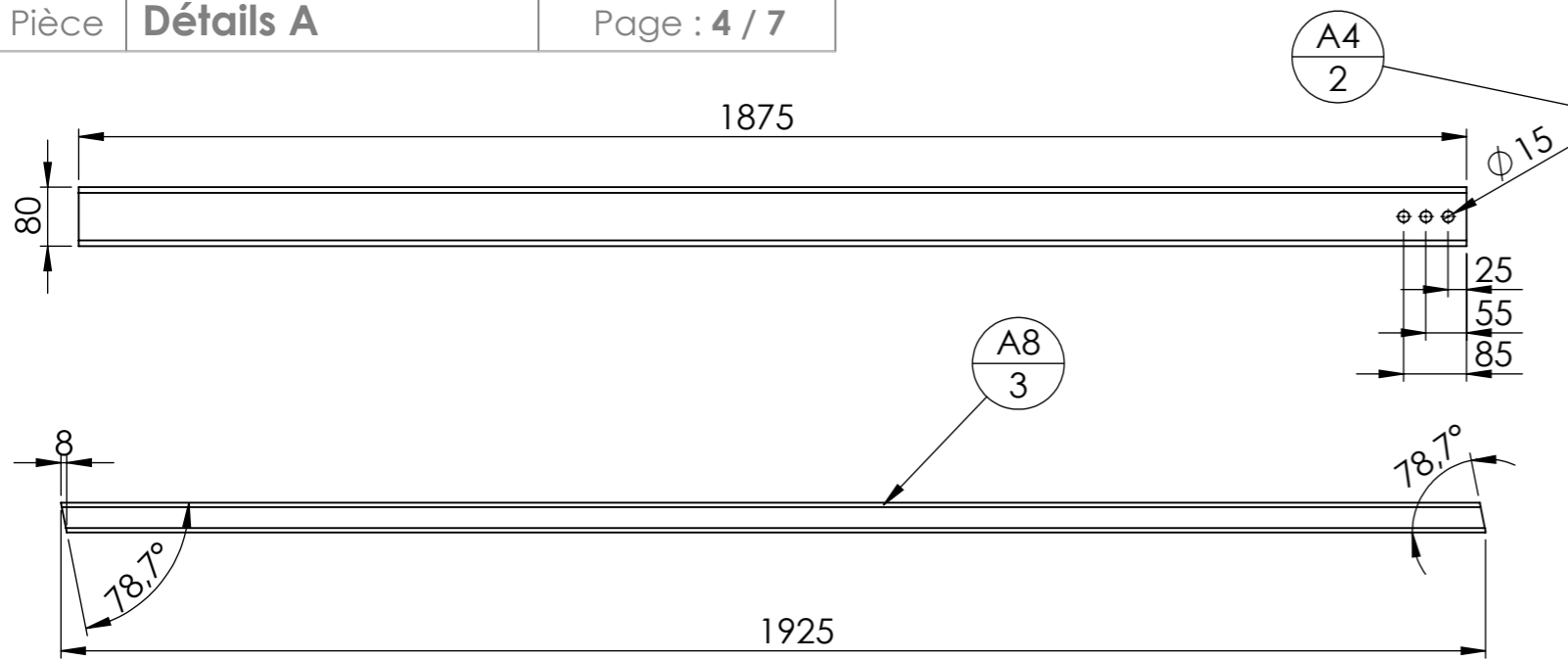



En développement

N°	Désignation	Longueur	Qté
A4	tube rectangulaire 80 x 40 x 4	1875	2
A9	tube rectangulaire 80 x 40 x 4	220	2
A8	tube carré 40 x 3	1925	3
A11	Profilé UPN 80 x 45	1305	1
A16	Cornière 35 x 35 x 3,5	2400	2
A17	Cornière 35 x 35 x 3,5	1850	2
A18	Cornière 35 x 35 x 3,5	1820	2
A19	Cornière 35 x 35 x 3,5	840	2
A18	Cornière 60 x 60 x 5	1820	2
A20	tube carré 40 x 3	700	1
A22	Fer plat 30 x 10	2600	2

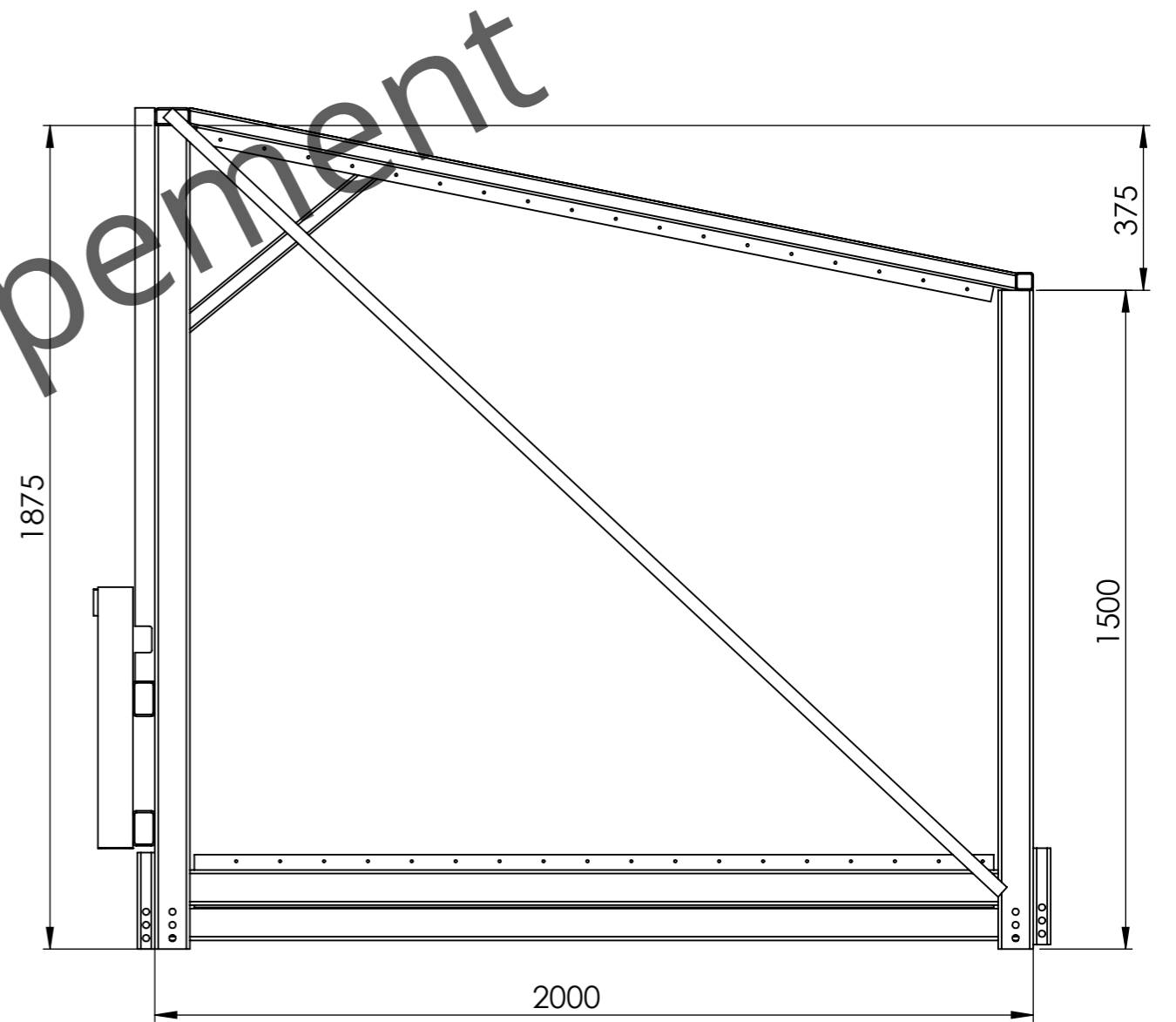
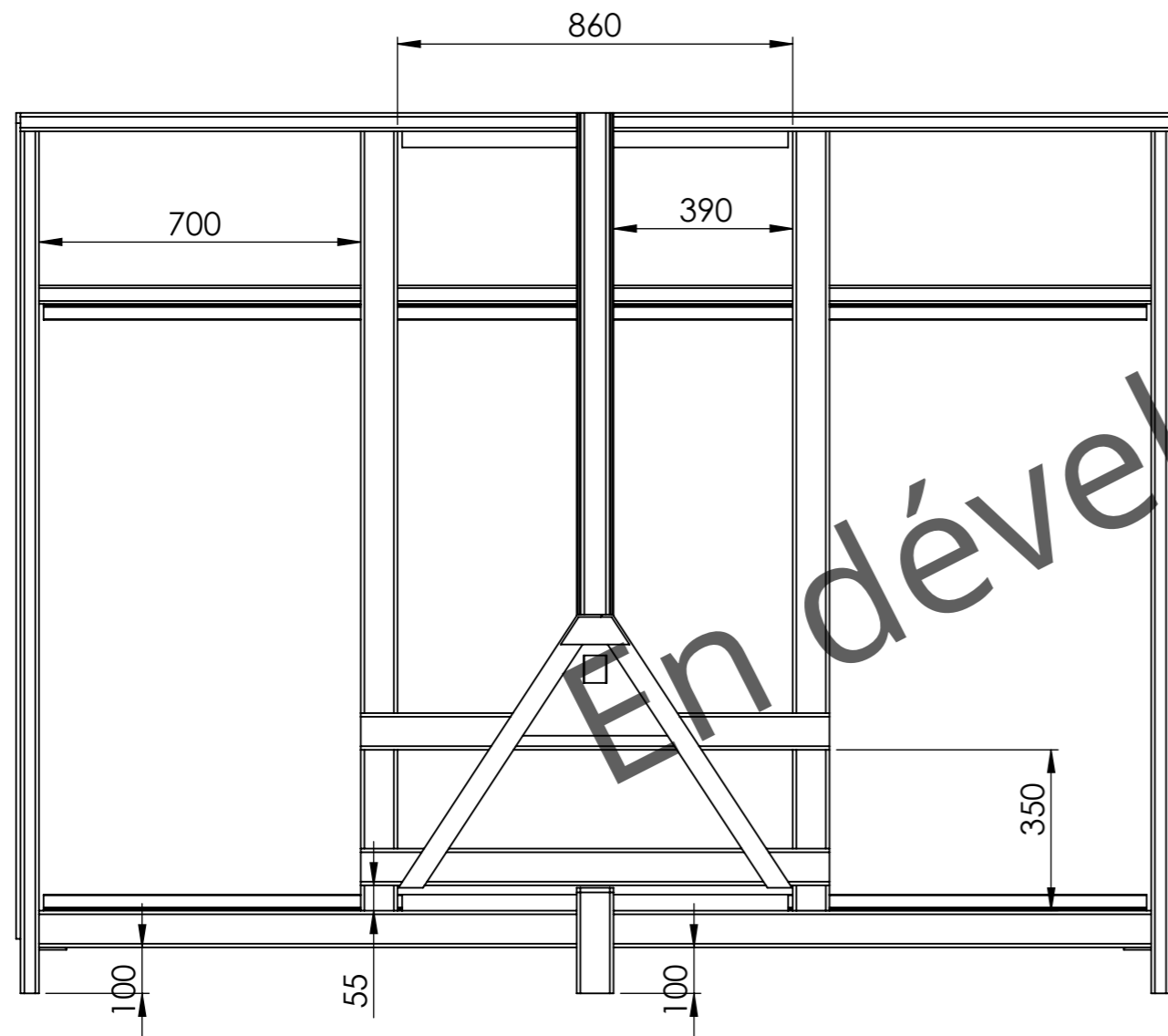
Version	1.0	Qté	1	
Date	03/06/2016			
Outil	Cabane à porc			
Pièce	Dimensions		Page : 5 / 7	



En développement

Version	1.0	Qté	1	
Date	03/06/2016			
Outil	Cabane à porc			
Pièce	Pieds B et D			
				Page : 6 / 7

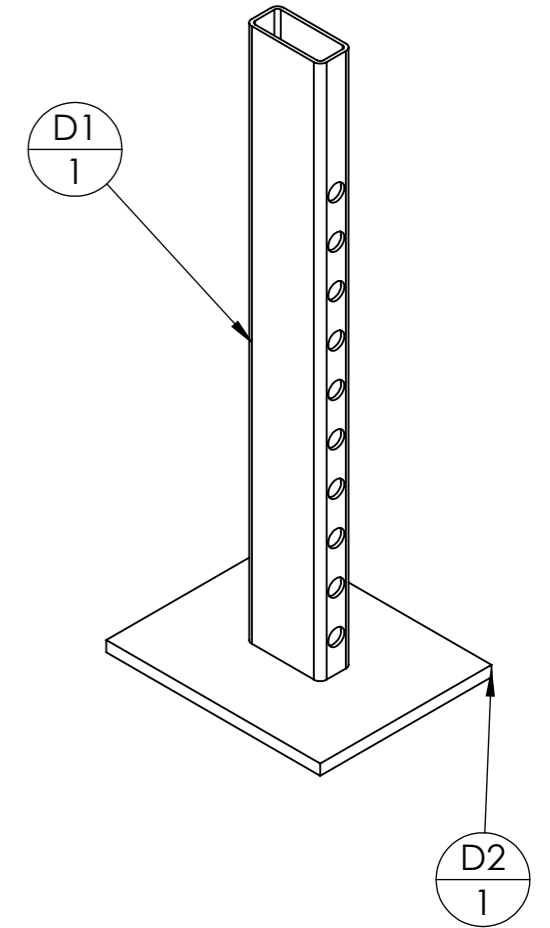
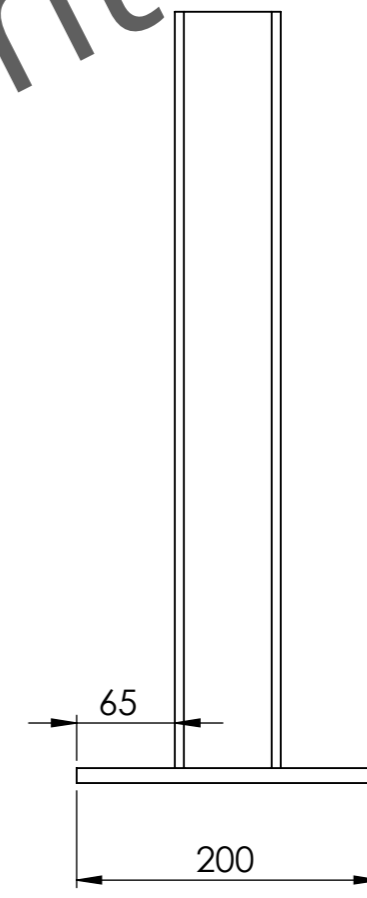
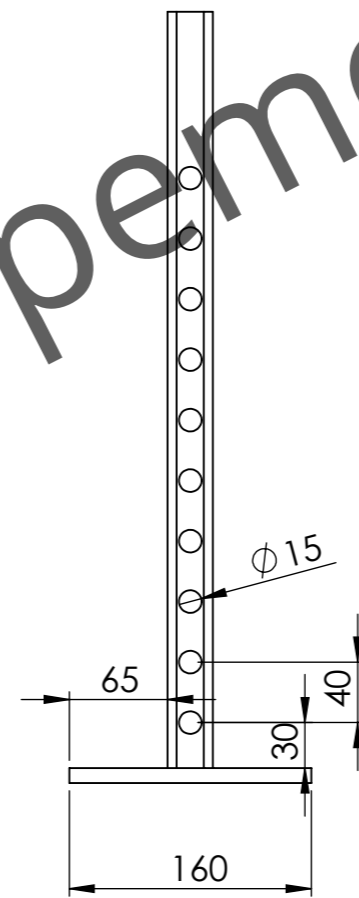
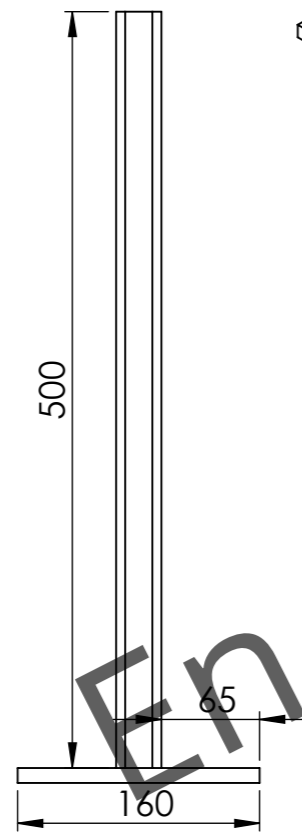
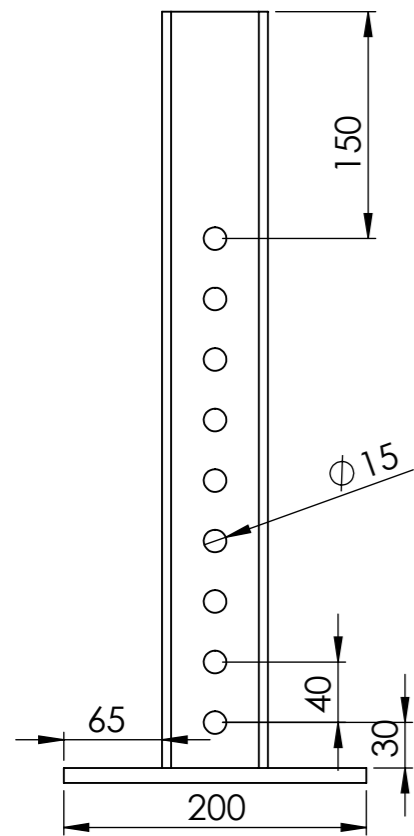
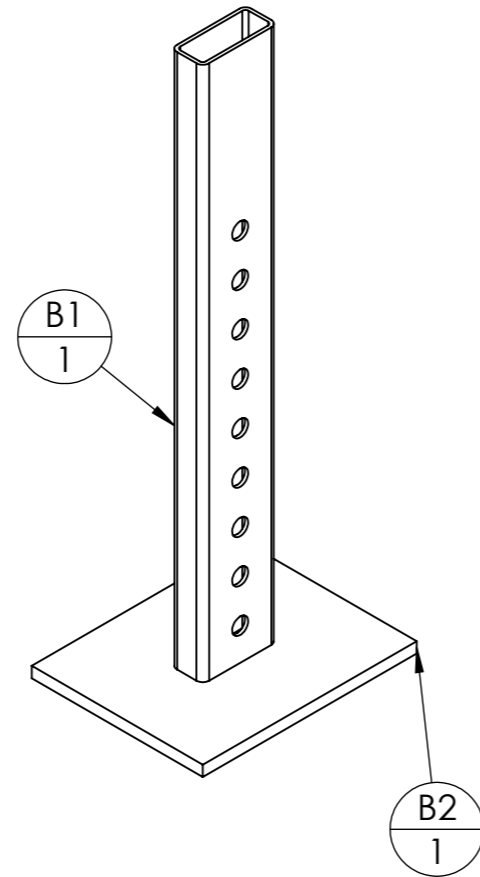

N°	Désignation	Longueur	Qté
B1	tube rectangulaire 70 x 30 x 3	500	1
B2	Large plat 160 x 10	200	1

N°	Désignation	Longueur	Qté
D1	tube rectangulaire 70 x 30 x 3	500	1
D2	Large plat 160 x 10	200	1

Version	1.0	Qté	1	
Date	03/06/2016			
Outil	Cabane à porc			
Pièce	Porte C			Page : 7 / 7

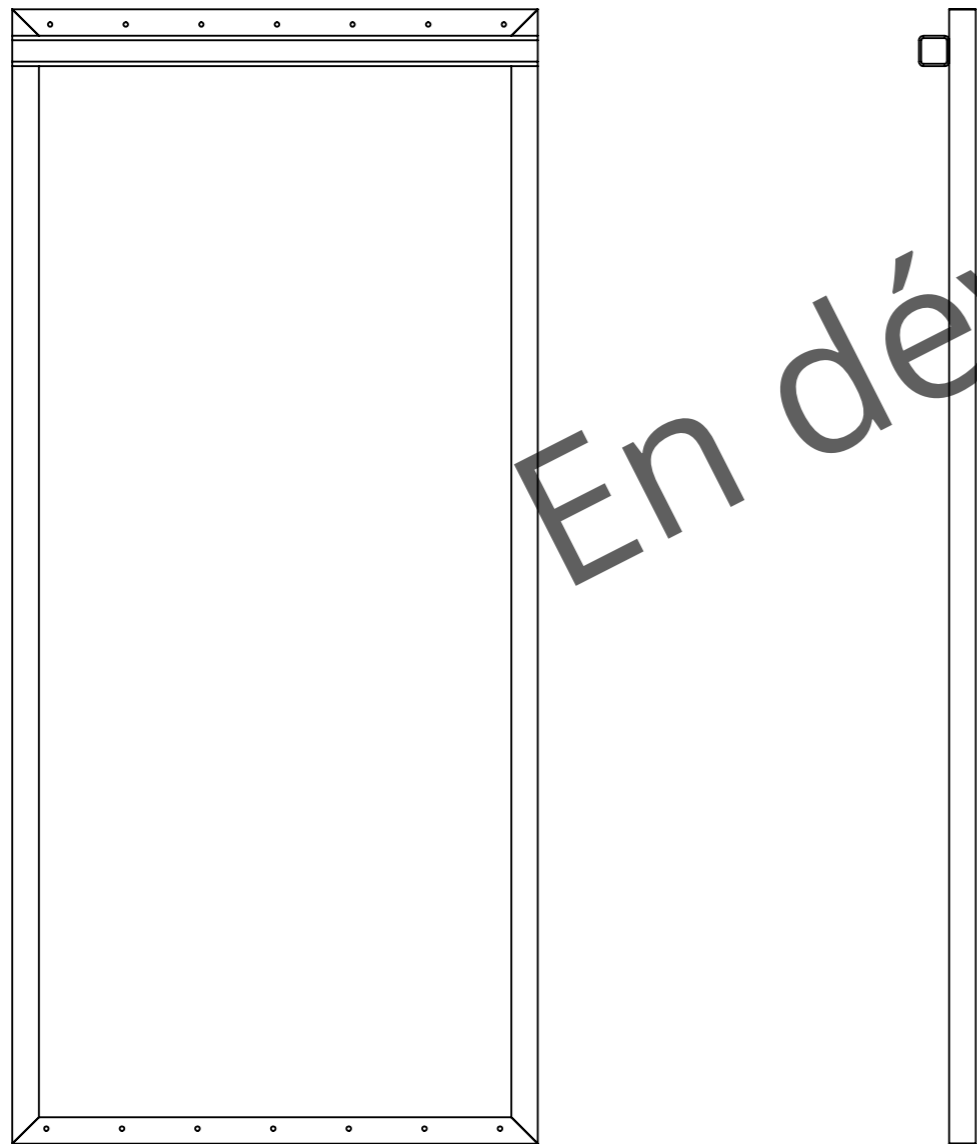
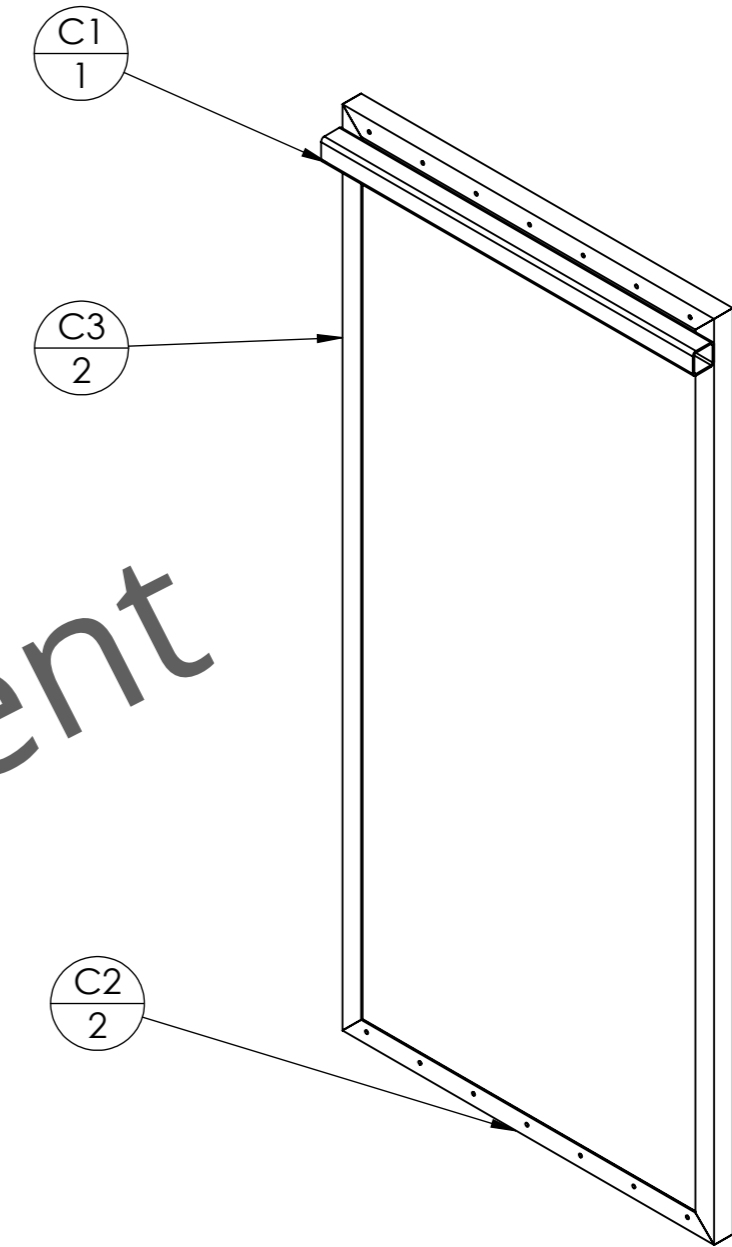
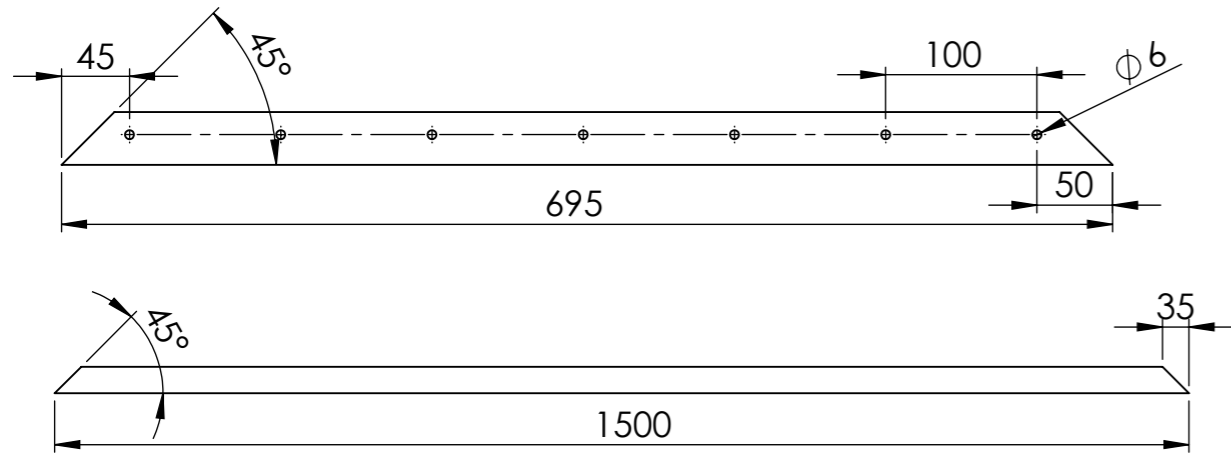

En développement

N°	Désignation	Longueur	Qté
C2	Cornière 35 x 35 x 3,5	695	2
C3	Cornière 35 x 35 x 3,5	1500	2
C1	tube carré 40 x 3	695	1