

Austin-Bergstrom International Airport Master Plan Update

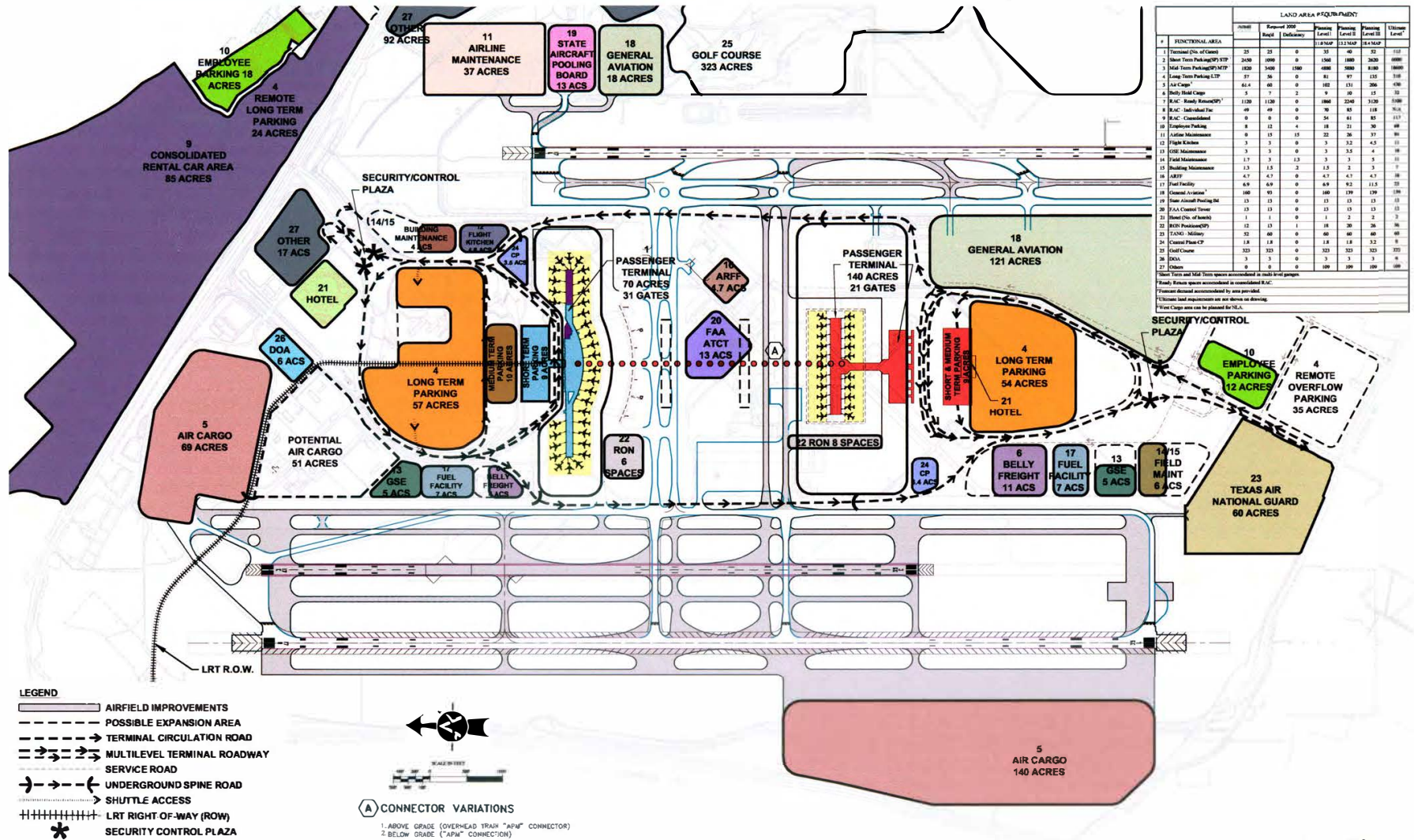
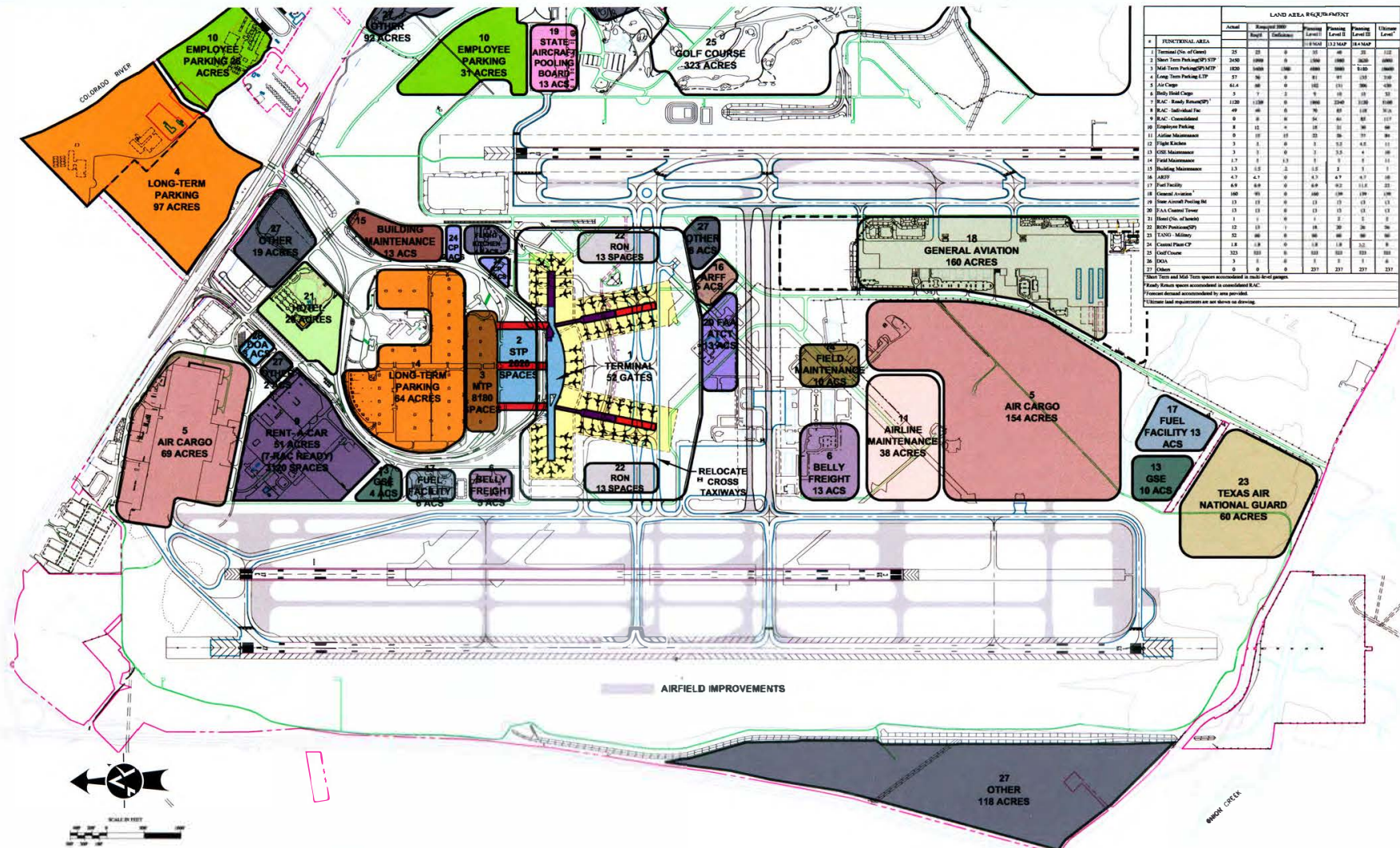

Figure 7-2
Recommended Land Use Plan

**Austin-Bergstrom International Airport
Master Plan Update**



FUNCTIONAL AREA	LAND AREA REQUIREMENT					
	Actual	Required 2020	Existing	Existing Level 1	Existing Level 2	Existing Level 3
1 Terminal (25 of 25)	25	25	0	0	0	0
2 Short Term Parking (STP)	2400	2400	0	1000	1000	1400
3 Mid Term Parking (MTP)	1000	1000	0	0	0	1000
4 Long Term Parking (LTP)	97	97	0	0	0	97
5 Air Cargo	69	69	0	100	100	0
6 Rent-A-Car	51	51	0	0	0	51
7 Long Term Parking (LTP)	64	64	0	0	0	64
8 MTP (8100 SPACES)	8100	8100	0	0	0	8100
9 Terminal (59 GATES)	59	59	0	0	0	59
10 Employee Parking	31	31	0	0	0	31
11 State Aircraft Pooling Board	13	13	0	0	0	13
12 Golf Course	323	323	0	0	0	323
13 Other	19	19	0	0	0	19
14 Building Maintenance	13	13	0	0	0	13
15 Other	19	19	0	0	0	19
16 Airfield Improvements	40	40	0	0	0	40
17 Fuel Facility	13	13	0	0	0	13
18 General Aviation	160	160	0	0	0	160
19 Air Cargo	154	154	0	0	0	154
20 Airline Maintenance	38	38	0	0	0	38
21 Belly Freight	13	13	0	0	0	13
22 RON (13 SPACES)	13	13	0	0	0	13
23 Texas Air National Guard	60	60	0	0	0	60
24 Other	19	19	0	0	0	19
25 Other	19	19	0	0	0	19
26 Other	19	19	0	0	0	19
27 Other	118	118	0	0	0	118

**Figure 5-1
Concept A-01
Passenger Terminal Complex
Development Alternatives**

Austin-Bergstrom International Airport
Master Plan Update

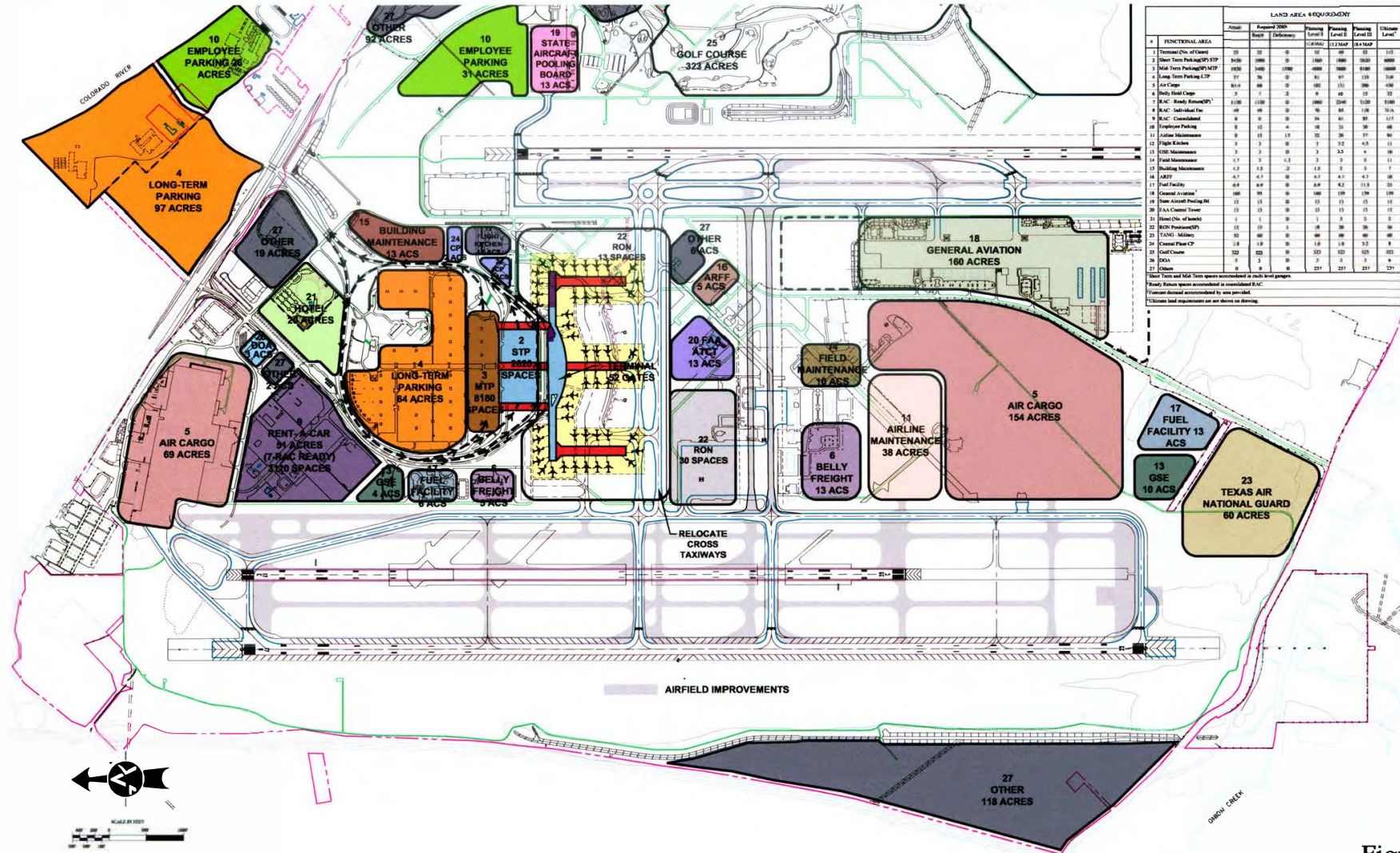

Figure 5-2
Concept A-02

Passenger Terminal Complex
Development Alternatives

Austin-Bergstrom International Airport
Master Plan Update

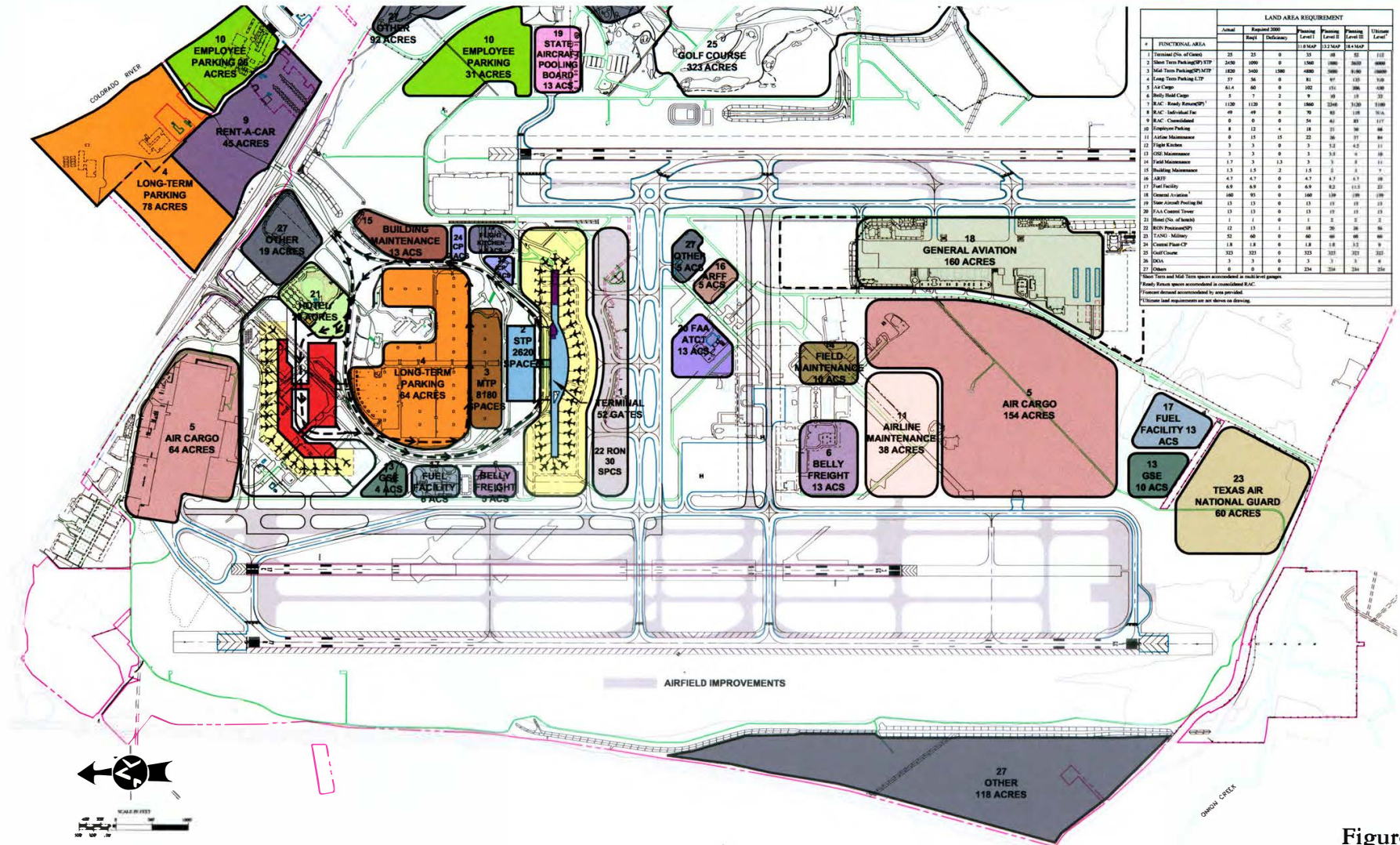

Figure 5-3
Concept A-03

Austin-Bergstrom International Airport
Master Plan Update

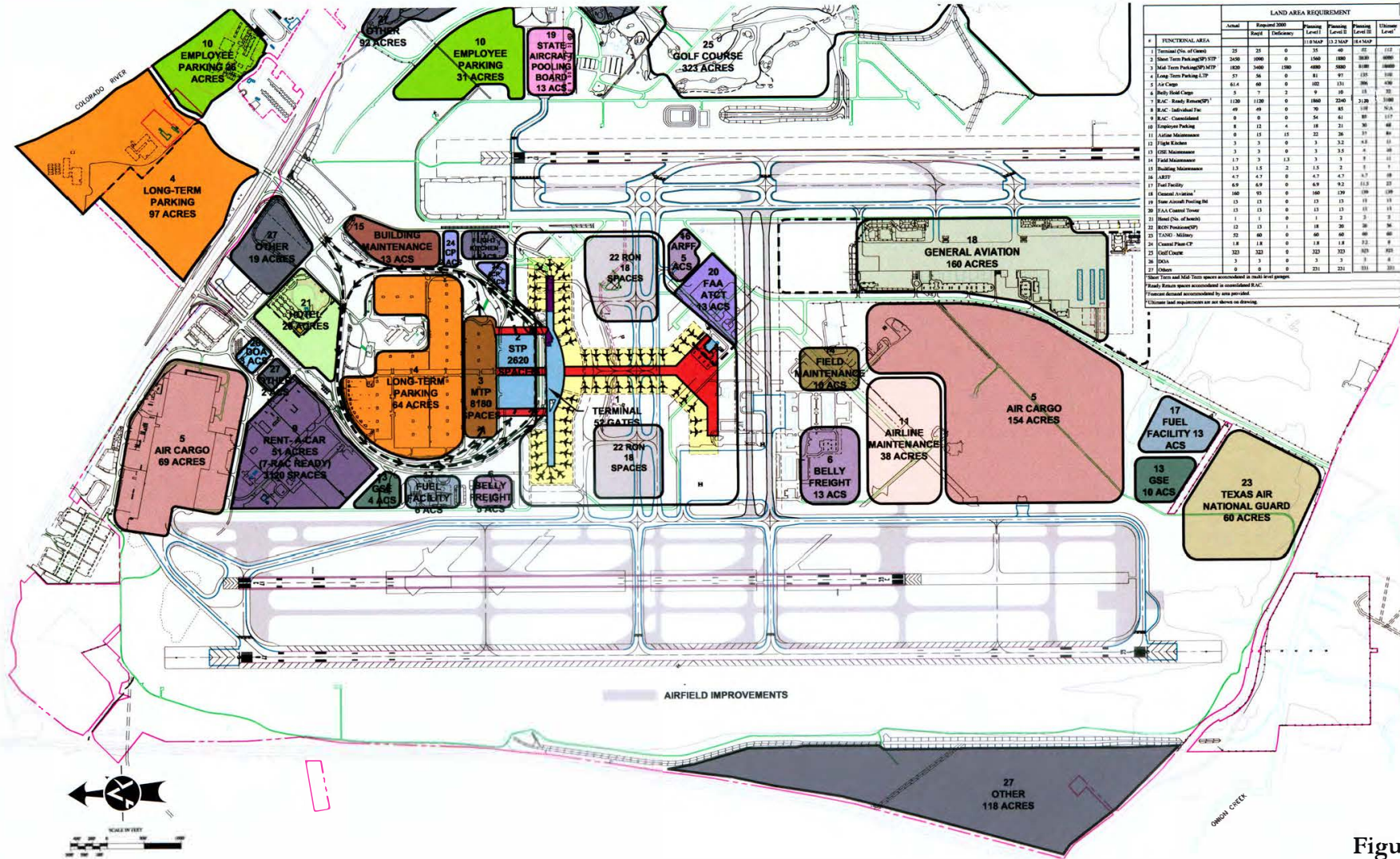

Figure 5-4
Concept A-04

Austin-Bergstrom International Airport
Master Plan Update

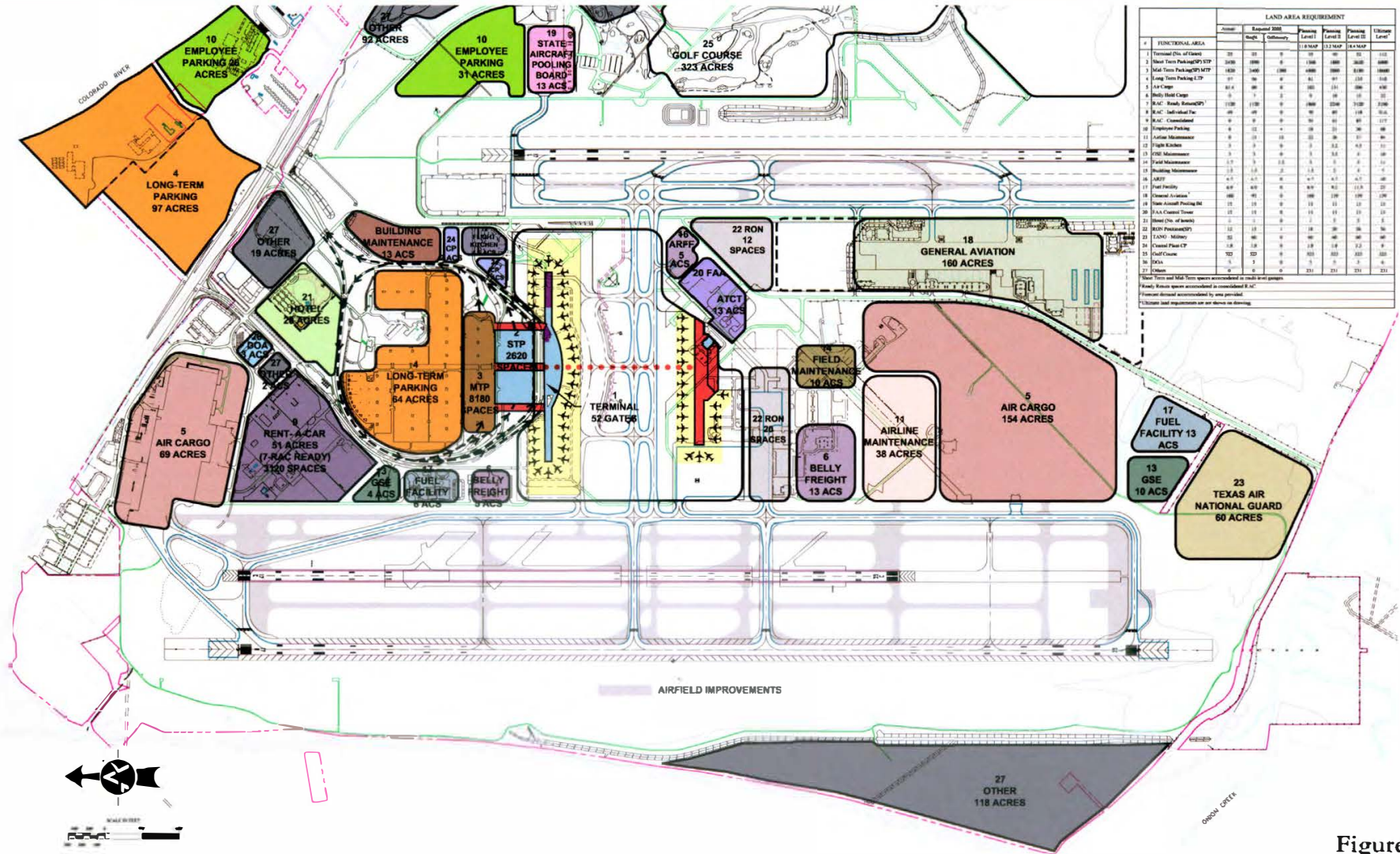

Figure 5-5
Concept A-05

Austin-Bergstrom International Airport
Master Plan Update

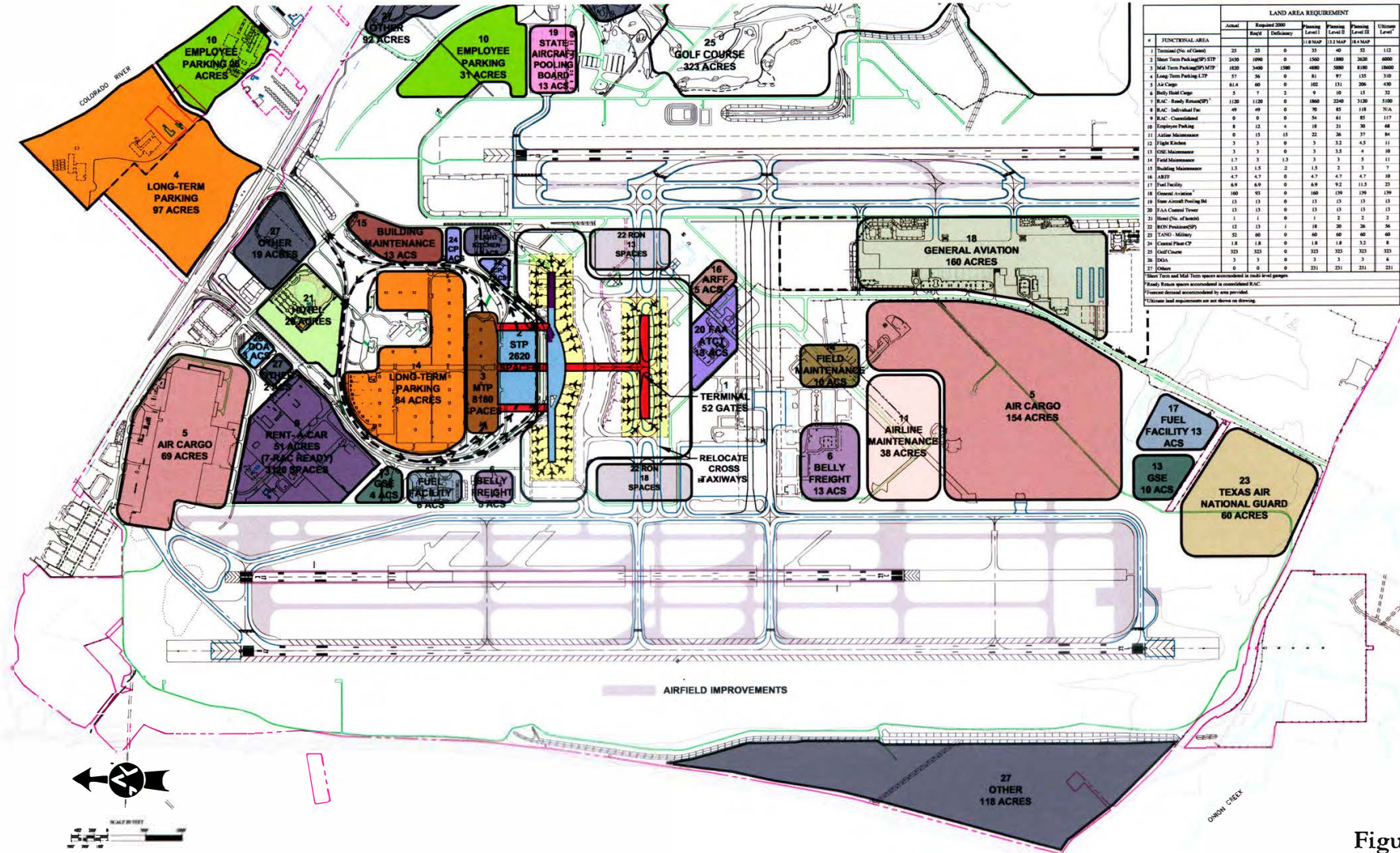
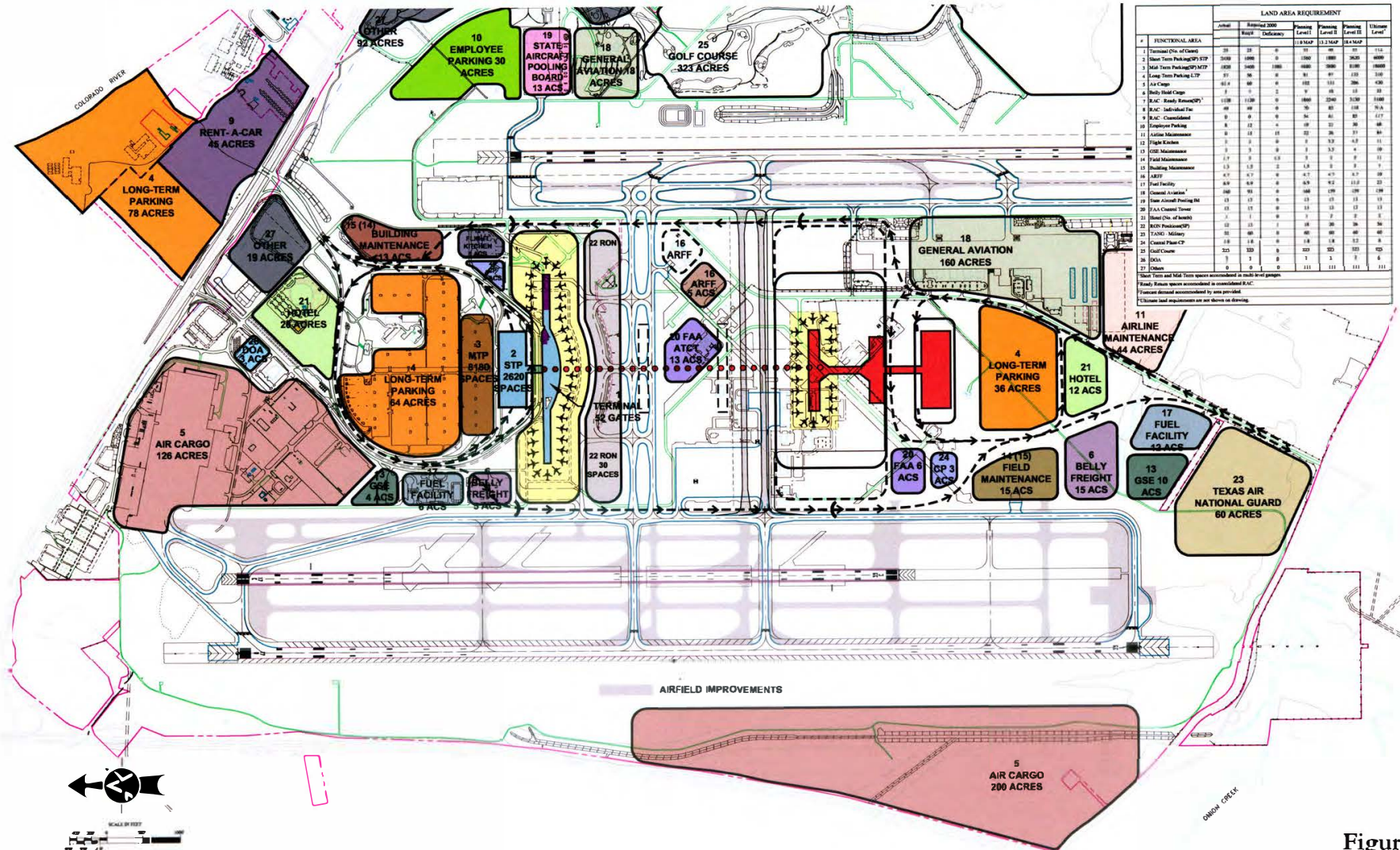

Figure 5-6
Concept A-06

**Austin-Bergstrom International Airport
Master Plan Update**



#	FUNCTIONAL AREA	LAND AREA REQUIREMENT				
		Actual	Estimated 2009	18 MAP	24 MAP	Ultimate
1	Terminal (See A-07)	92	92	92	92	92
2	State Term Parking/STP	2620	2620	2620	2620	2620
3	Mid Term Parking/MT/TP	8199	8199	8199	8199	8199
4	Long Term Parking LTP	36	36	36	36	36
5	Air Cargo	126	126	126	126	126
6	Belly Hold Cages	15	15	15	15	15
7	RAC - Ready Response	1500	1500	1500	1500	1500
8	RAC - Scheduled Fee	60	60	60	60	60
9	RAC - Unscheduled	0	0	0	0	0
10	Employee Parking	30	30	30	30	30
11	Airline Maintenance	14	14	14	14	14
12	Flight Kitchens	2	2	2	2	2
13	Field Maintenance	15	15	15	15	15
14	Building Maintenance	15	15	15	15	15
15	FAA ATCT	13	13	13	13	13
16	ARFF	4	4	4	4	4
17	Fuel Facility	13	13	13	13	13
18	General Aviation	160	160	160	160	160
19	State General Parking	13	13	13	13	13
20	AAA General Term	13	13	13	13	13
21	Hotel (See A-07)	12	12	12	12	12
22	RON (See A-07)	30	30	30	30	30
23	FAA ATCT	13	13	13	13	13
24	GP (See A-07)	3	3	3	3	3
25	Other	92	92	92	92	92
26	DOA	0	0	0	0	0
27	Other	0	0	0	0	0

**Figure 5-7
Concept A-07**

Austin-Bergstrom International Airport
Master Plan Update

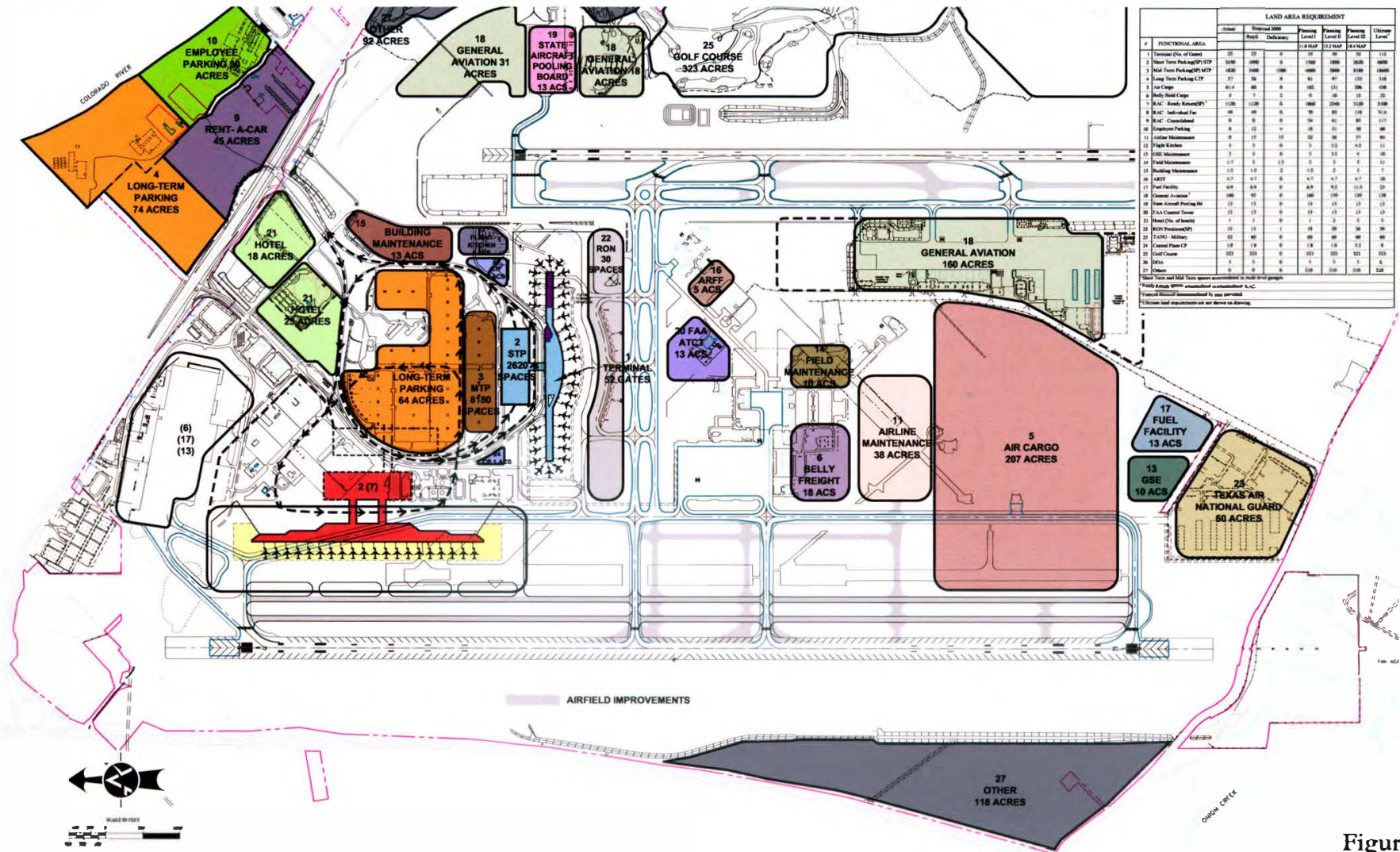

Figure 5-8
Concept B-01

Austin-Bergstrom International Airport
Master Plan Update

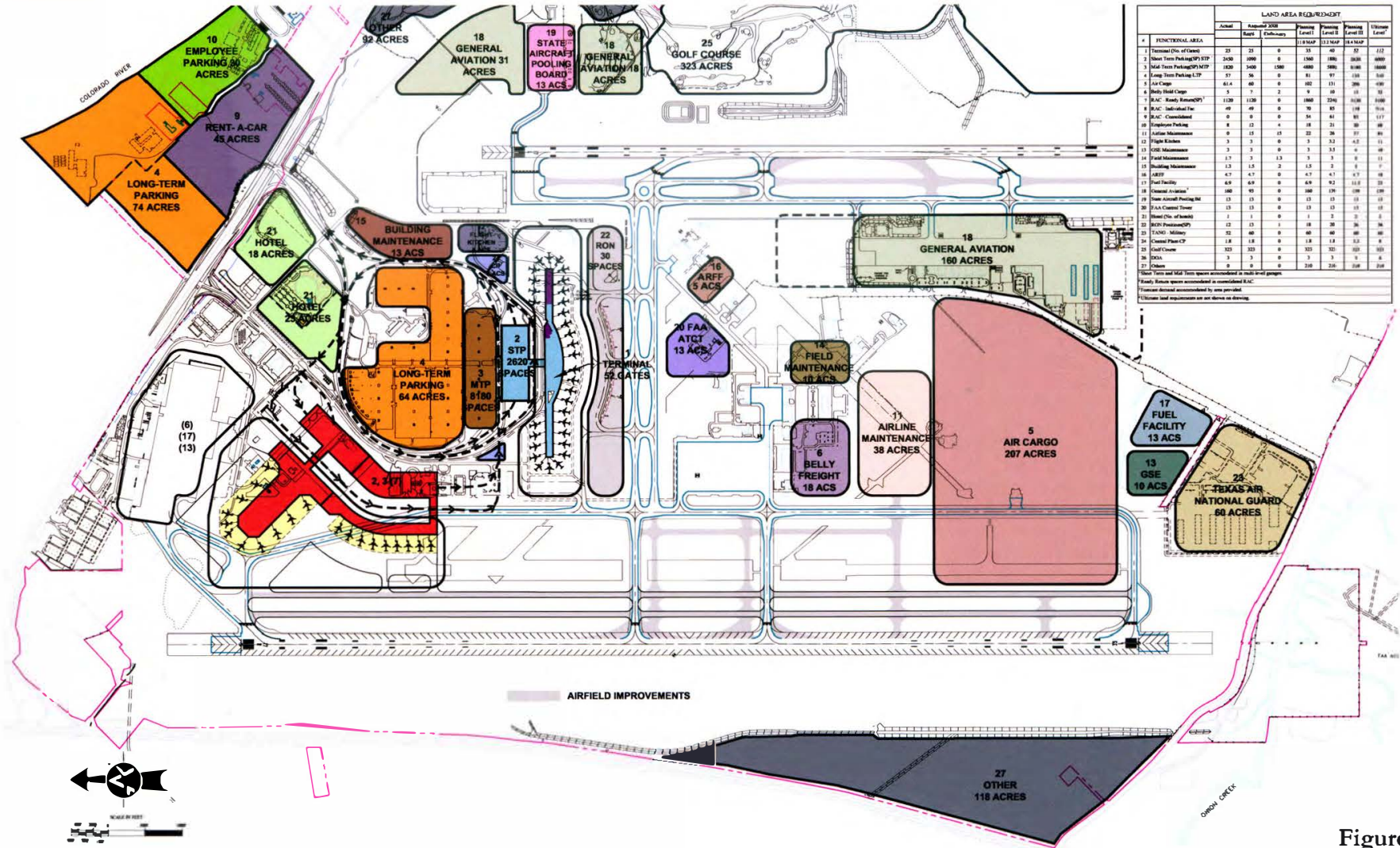

Figure 5-9
Concept B-02

Austin-Bergstrom International Airport
Master Plan Update

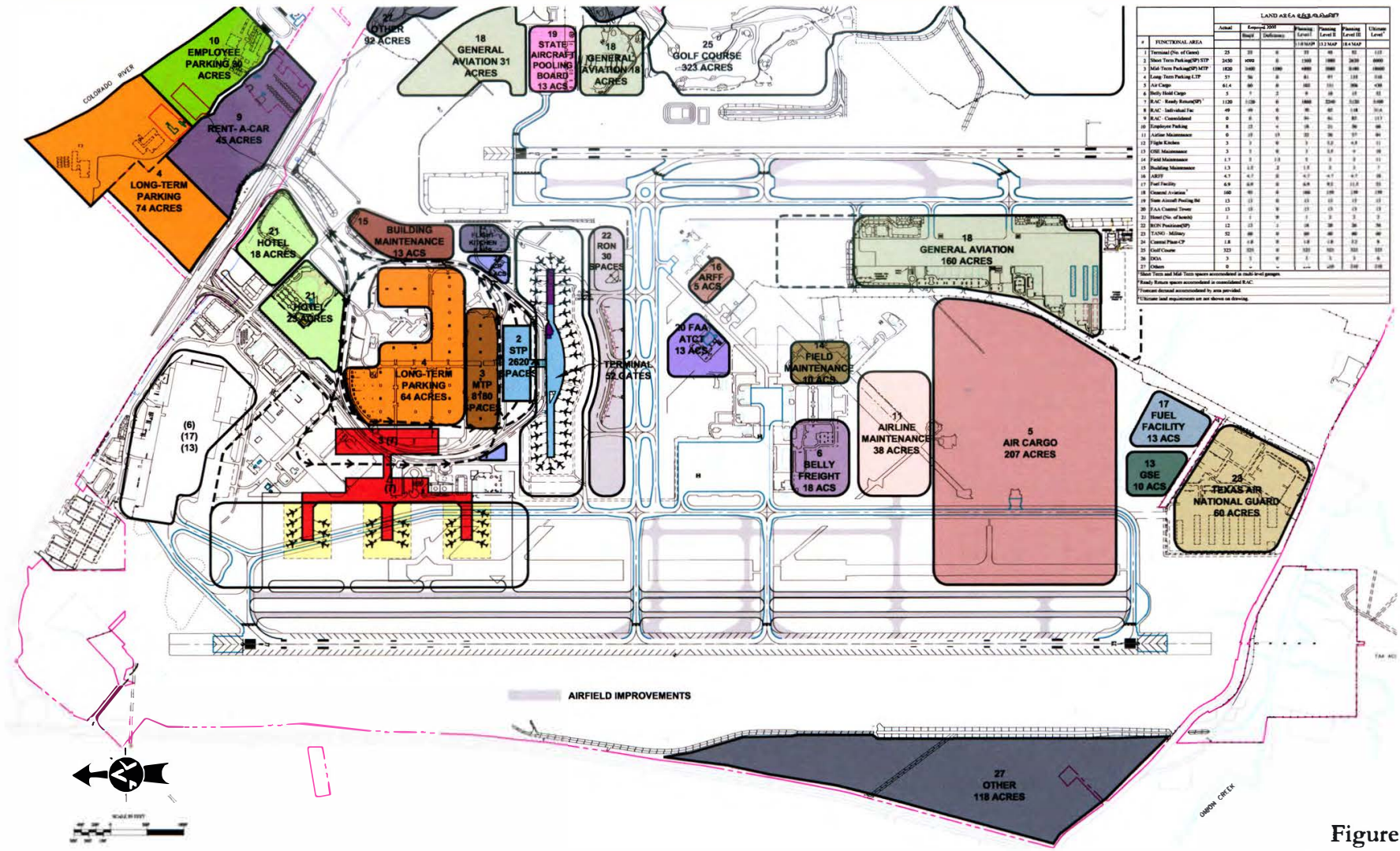

Figure 5-10
Concept B-03

Austin-Bergstrom International Airport
Master Plan Update

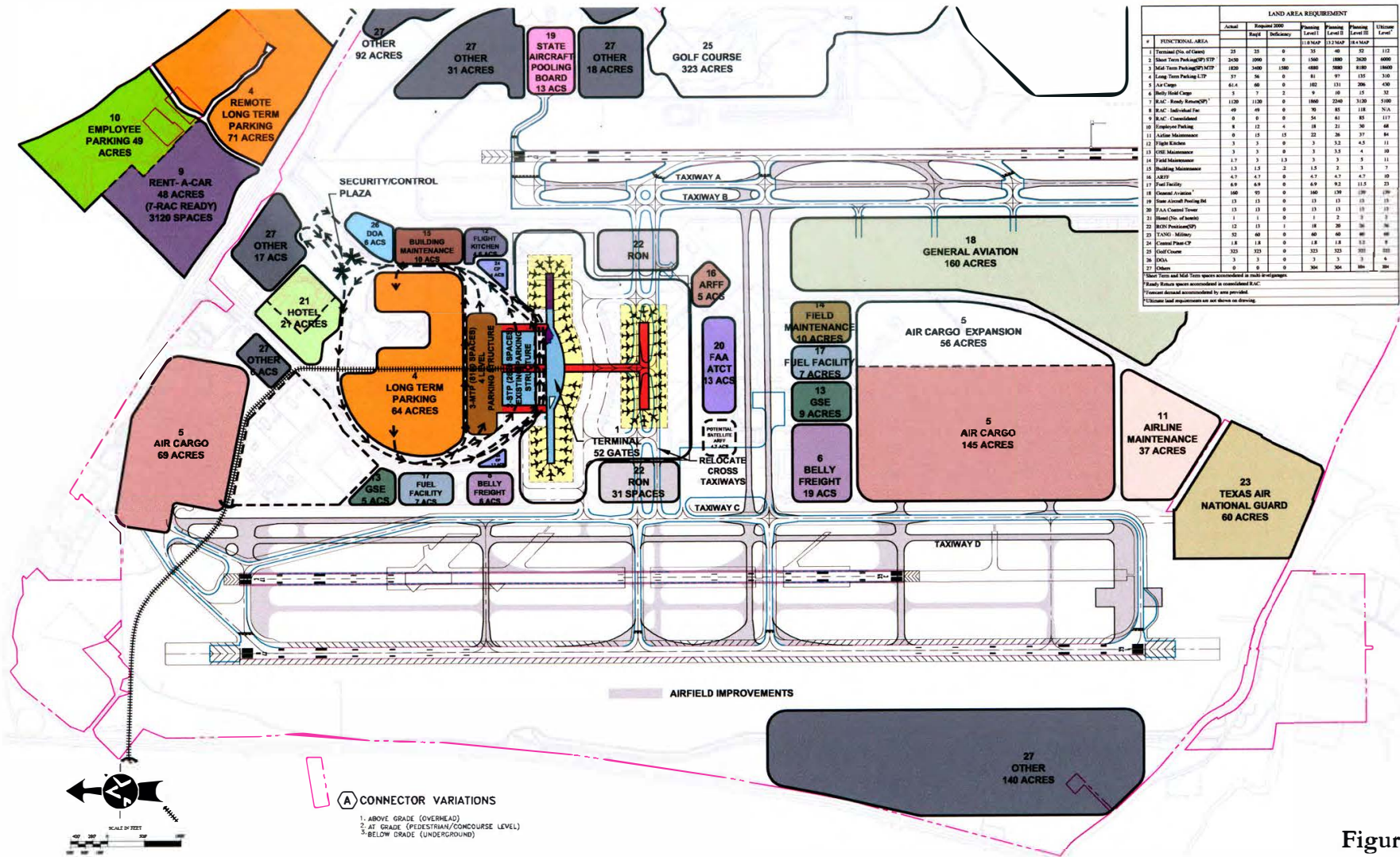

Figure 5-11
Concept A-06A

Austin-Bergstrom International Airport
Master Plan Update

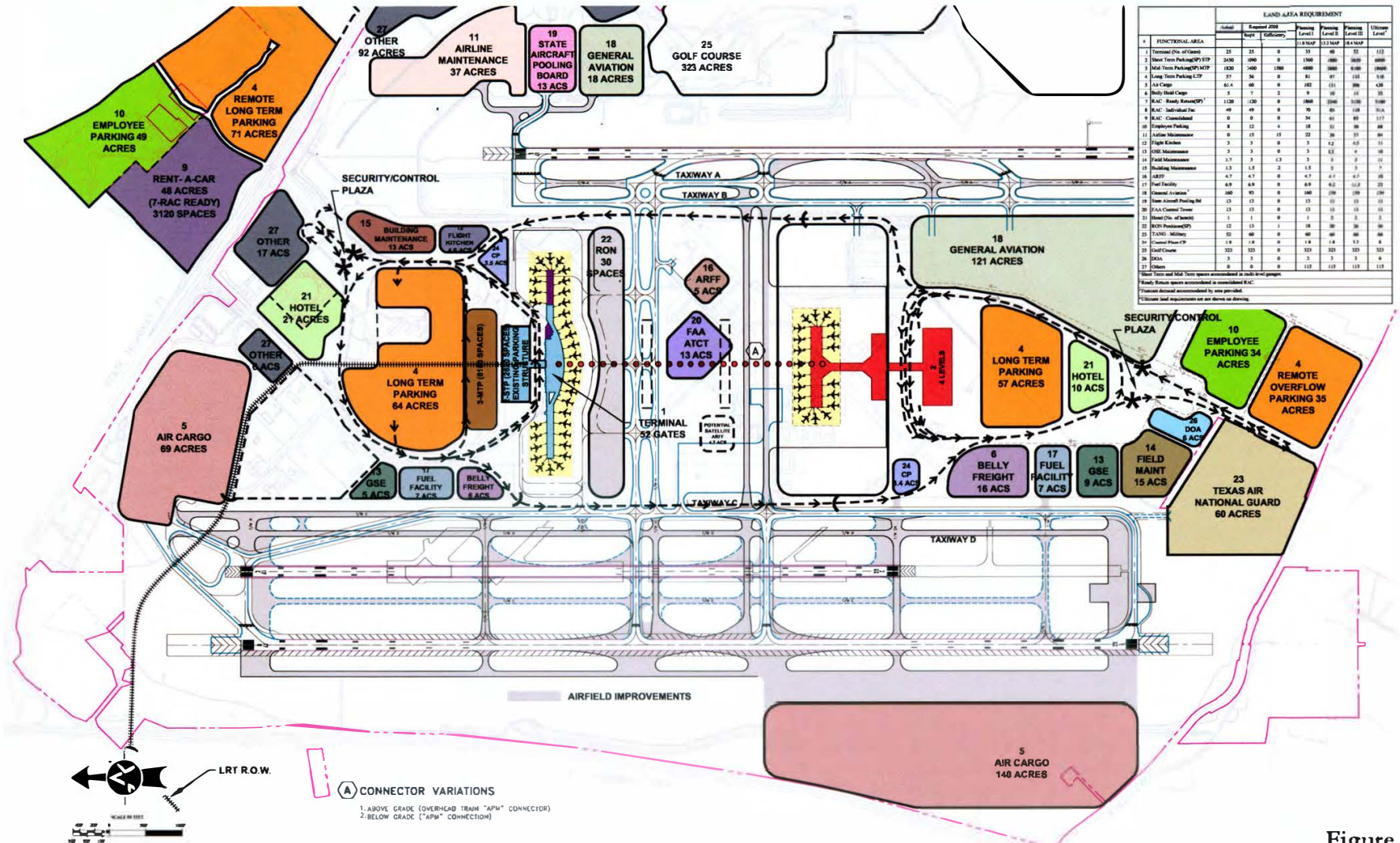

Figure 5-12
Concept A-07A