

Fig.F.13. Installation of the selector mechanism.

1. Lock ball
2. Interlock pin
3. Spring
4. Lock ball
5. Selector lever for 1st and reverse speeds
6. Guide tube
7. Selector lever for 2nd and 3rd speeds
8. Selector quadrant
9. Selector fork for 2nd and 3rd speeds
10. Selector fork for 1st and reverse speeds
11. Selector quadrant

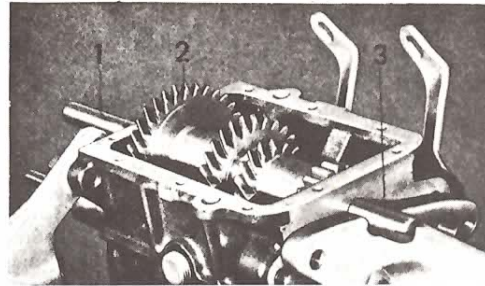

Fig.F.14. Installation of the countershaft. 1. Dummy shaft, 2. Countershaft gear cluster, 3. Countershaft.

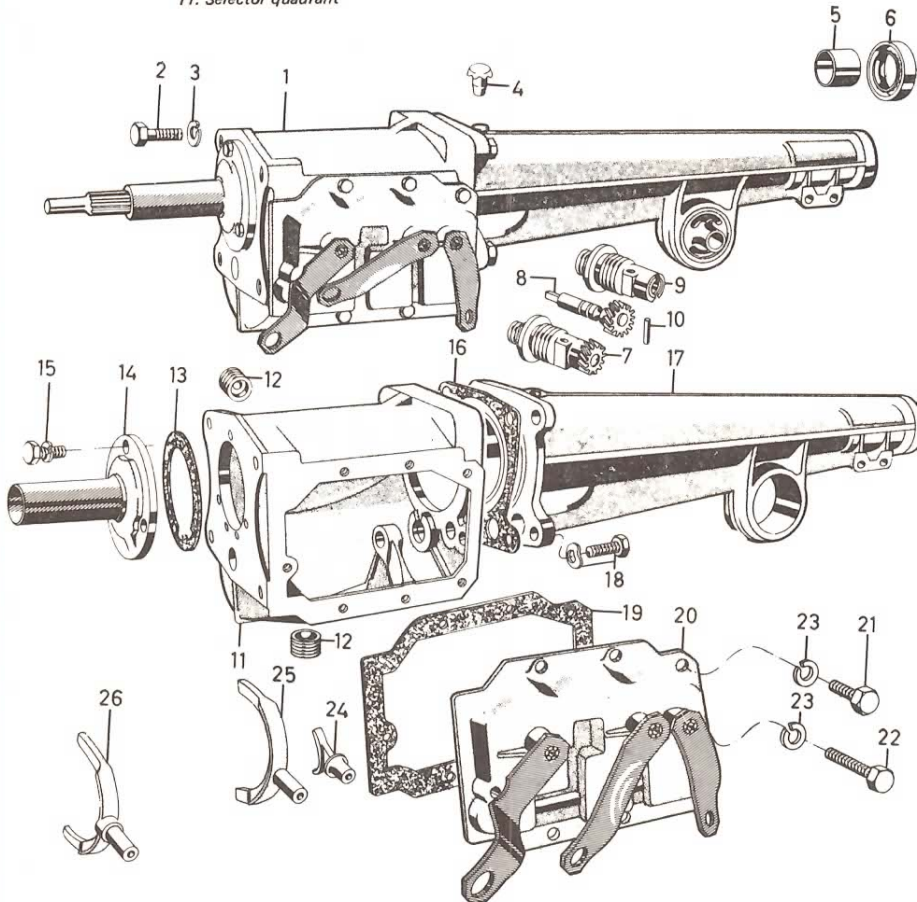

Fig.F.15. Exploded view of the four-speed gearbox (transmission) with selector mechanism.

1. Four-speed gearbox
2. Hex. head bolt
3. Spring washer
4. Breather
5. Bush for extension housing
6. Oil seal for extension housing
7. Speedometer drive gear
8. Speedometer drive pinion
9. Drive pinion sleeve
10. Retaining pin
11. Gearbox case
12. Screw plug
13. Gasket for front cover
14. Front cover
15. Securing bolt
16. Extension housing gasket
17. Extension housing
18. Hex. head bolt
19. Gasket
20. Selector cover
21. Hex. head bolt
22. Hex. head bolt
23. Spring washer
24. Selector fork
25. Selector fork - 1st/2nd speeds
26. Selector fork - 3rd/4th speeds

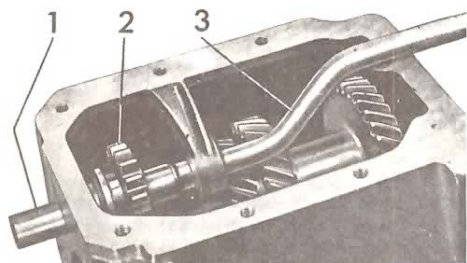

Fig.F.16. Remove the reverse idler shaft by means of a cranked drift as shown. 1. Idler shaft, 2. Reverse idler gear, 3. Cranked drift.

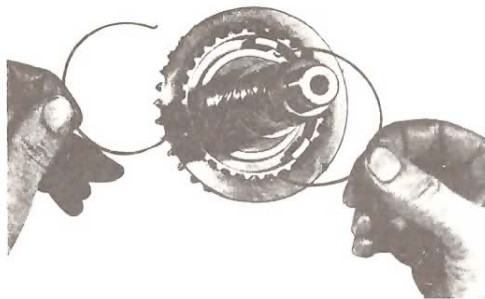

Fig.F.17. Install the synchroniser springs as shown to ensure correct assembly.

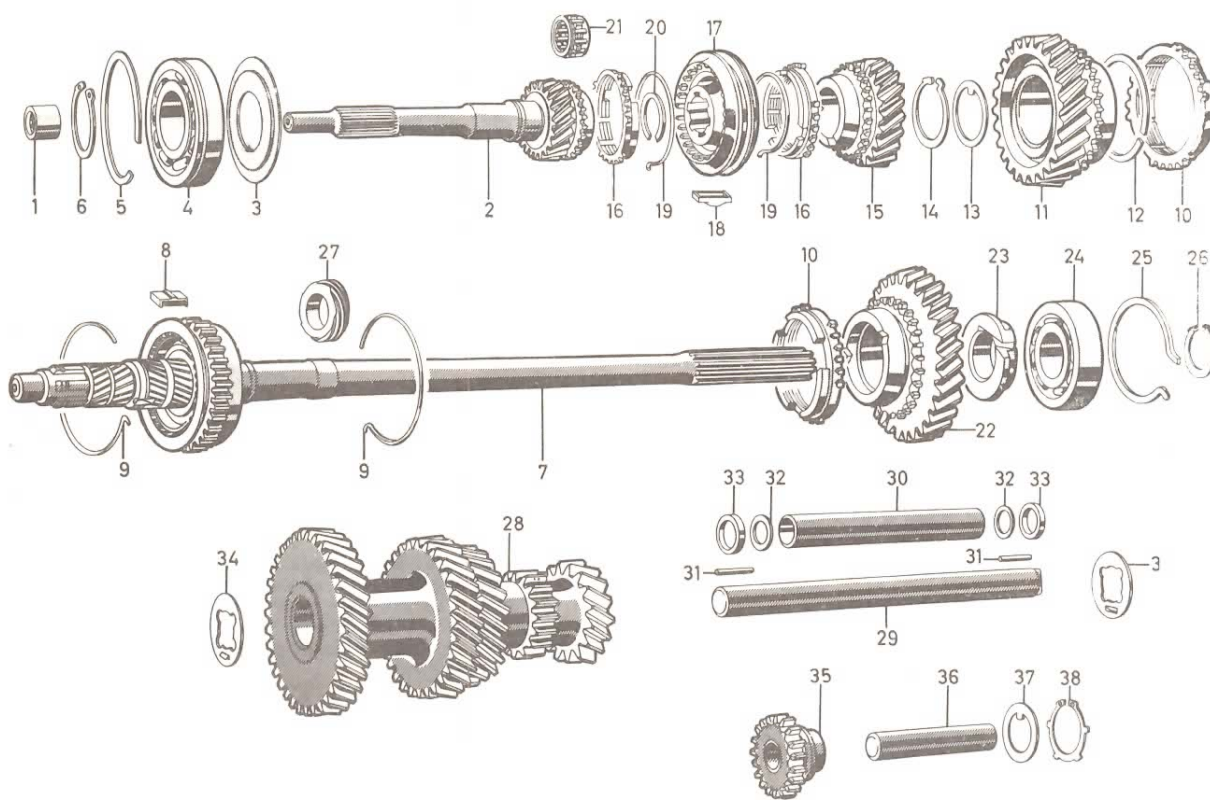

Fig.F.18. Exploded view of the four-speed gearbox gear train.

- 1. Needle roller bearing
- 2. Main drive gear
- 3. Oil flinger
- 4. Ball bearing
- 5. Circlip
- 6. Circlip
- 7. Main shaft
- 8. Shifting key
- 9. Synchroniser spring
- 10. Synchroniser ring (balk ring)

- 11. 2nd speed gearwheel
- 12. Circlip
- 13. Thrust washer
- 14. Circlip
- 15. 3rd speed gearwheel
- 16. Synchroniser ring (balk ring)
- 17. Synchroniser (3rd/4th speeds)
- 18. Shifting key
- 19. Synchroniser spring
- 20. Circlip

- 21. Needle roller bearing
- 22. 1st speed gearwheel
- 23. Spacer
- 24. Ball bearing
- 25. Circlip
- 26. Circlip
- 27. Speedometer worm drive
- 28. Countershaft gear cluster
- 29. Countershaft
- 30. Spacer tube

- 31. Needle bearing
- 32. Thrust washer
- 33. Thrust washer
- 34. Retaining washer
- 35. Reverse idler gear
- 36. Reverse idler shaft
- 37. Thrust washer
- 38. Circlip



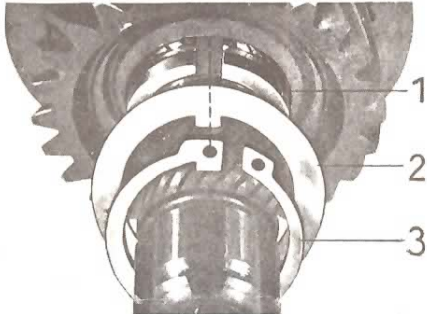

Fig.F.19. Circlip and thrust washer fitted to the end of the mainshaft. 1. Mainshaft, 2. Thrust washer, 3. Circlip.

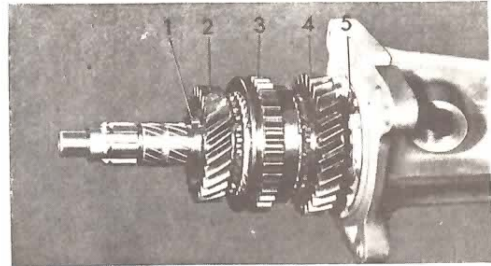

Fig.F.20. Gearwheels fitted to the end of the mainshaft.

1. Circlip
2. 2nd speed gearwheel
3. Sliding gear for 1st/2nd speed
4. 1st speed gearwheel
5. Circlip

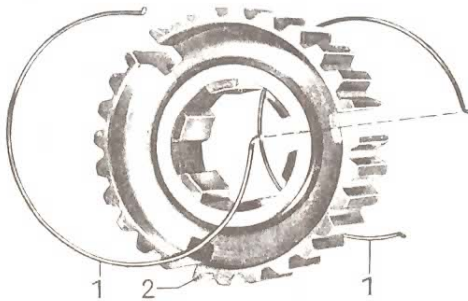

Fig.F.21. Fit the synchroniser springs as shown. 1. Synchroniser springs, 2. Synchroniser hub.

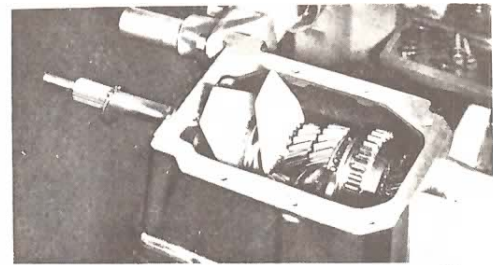

Fig.F.22. The protective plates are inserted in the gearbox to avoid damage to the synchroniser rings (see text).

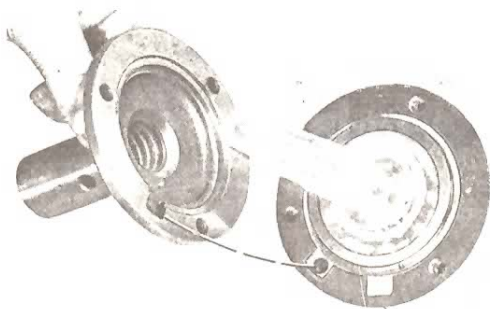

Fig.F.23. When fitting the front cover, take care that the oil hole in cover, paper gasket and gearbox case is aligned.

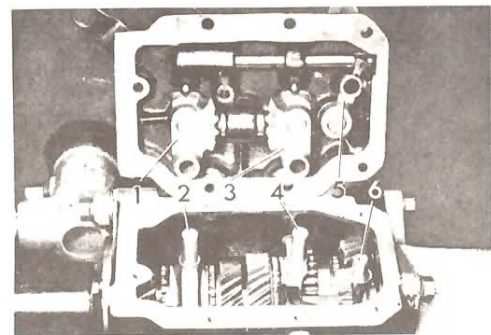

Fig.F.24. Installation of the selector cover.

1. Selector quadrant (3rd/4th speeds)
2. Selector fork (3rd/4th speeds)
3. Selector quadrant (1st/2nd speeds)
4. Selector fork (1st/2nd speeds)
5. Selector quadrant (reverse speed)
6. Selector fork (reverse speed)