

Proposal for Earith Preschool outdoor classroom

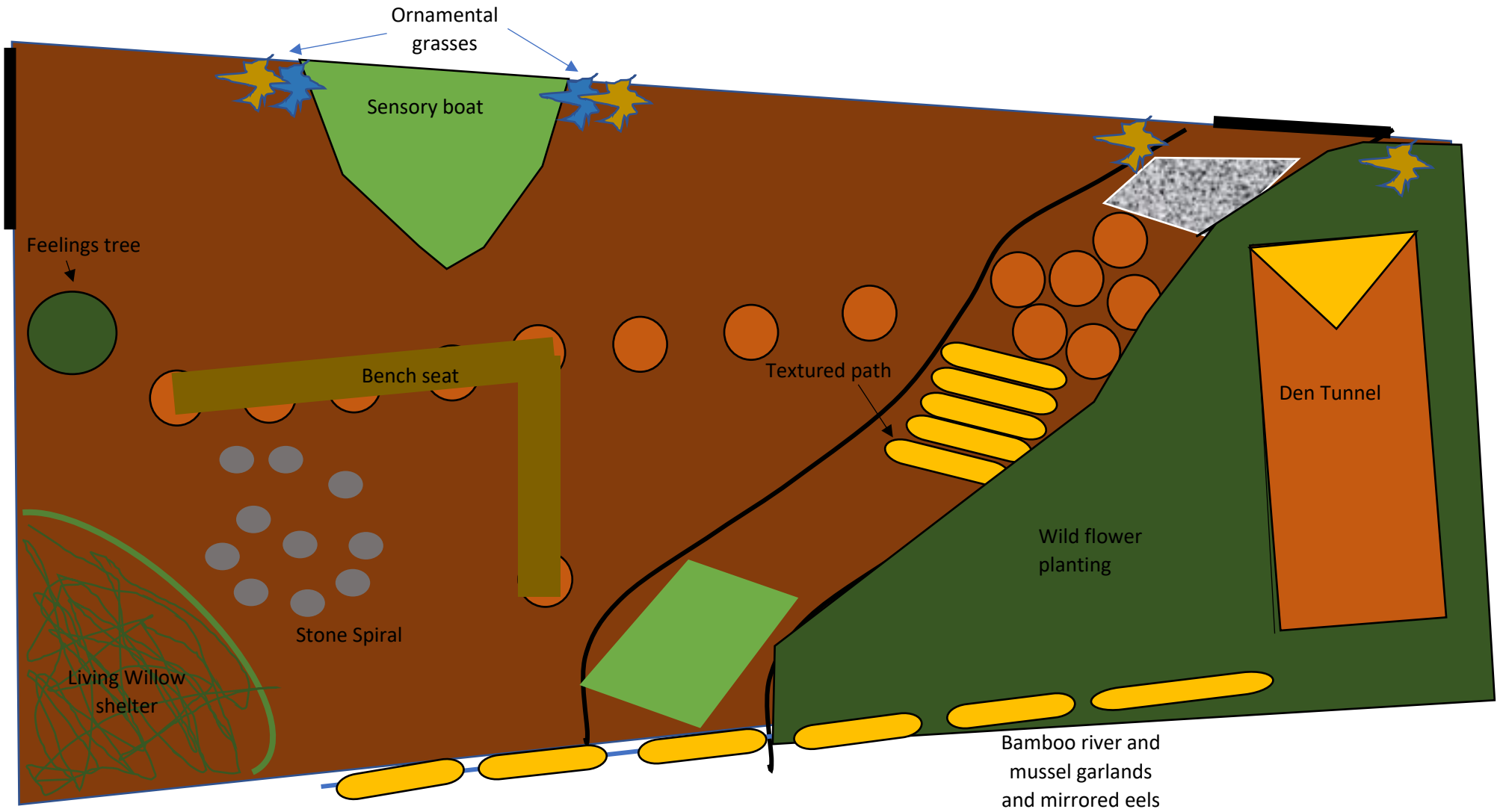



Sensory boat

I have noticed a number of old, broken beyond repair boats in garden etc locally. I want to see if we can find one to donate to the garden. We would then cut it in half and have it sticking out of the brick wall (We could dig it in and/or secure to the wall with brackets). This would be filled with soil and planted with hardy perennial herbs. The boat would be flanked by blue and green ornamental grasses to give the impression of water and reeds.

- Magic potion making
- Help with baking (add to cheese scones for example)
- Explore senses

- Collage, glue or stick to paper
- Press into clay
- Leave to dry to observe changes to materials



Feelings Tree

Create 3 or 4 different faces and attach them to the tree.

- Use if a child is having a difficult day to discuss feelings
- Refer to the tree to explore feelings in a story
- Make own natural faces and use these as inspiration
- Observational drawing- try and draw a face that matches this one

Textured path

This would guide children into the garden. Grass, bamboo, soil, stone and wood would make a varied texture to explore.

- As a supervised activity it could be used as a barefoot walk



- Observation- are any animals found on one area but not another?
- Colour chart

Bamboo river

This would offer a way of incorporating a river without creating a water feature needing maintaining, watching. Using the natural downward gradient a series of bamboo would gradually drop down and down so water put in the top would travel along. A waterwheel would be a great addition and reflect the local environment if we could find someone to build it. The bamboo would end near the living willow bottom which will happily absorb a lot of water or a bucket could be put there to collect the water and return it to the top.

- Damming the river- explore putting different objects in the bamboo and observing the effect.
- Enjoying water play
- Talking about waters value to plants



Mirrored eels

Sitting under the bamboo river these would offer opportunity for discussion about the animals living in our river as well as offering a sparkling, bright addition to the wall.

- History of local area
- Local fauna
- Have a go at making their own mosaics

Woven living willow bower

This could be used as a play shelter, a focus point for story time or a place to hang seasonal objects. It will grow and develop over time.

- Story time
- Seasonal display
- Performance space
- Play house



Den tunnel

A frame structure with branches lent (either loose or wired) against it to create a den tunnel.

- A way to engage in den building in a non wild space
- An alternative route to take through the space
- Playing dens
- Talking about habitat

Ornamental grass entrance

Low cost ornamental grass will create something nice for the children to run their hands through

- Moving their bodies like the grass and other things in the garden
- Craft- Print with sides of cardboard and paint to make grass paintings
- Cut to make magic wands





Seating areas

Using the existing stumps and one extra this section could make a nice V shaped bench.

- Story time
- Balancing
- Drumming, rhythm

Stone Spiral

Not sure how this will work on top of wood chip so would have to experiment.

- Centre could be used as a fire pit location, swirl provides a natural boundary for the children to keep.
- Searching for shapes in nature, look for other swirls then look for other shapes.
- Make other patterns in nature (basic Andy Goldsworthy)

Muscle Garlands

Use twine and muscles to make dangling garlands which will shine in the sun.

- Talk about local fauna
- Explore animal habitats

