

## Parts List

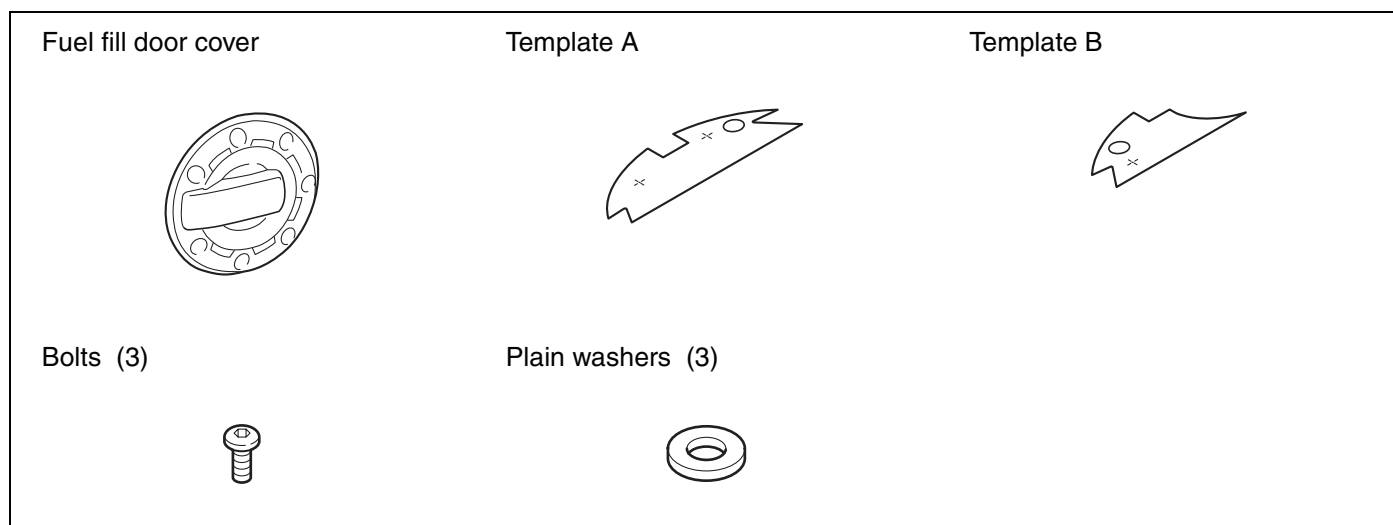

## Tools and Supplies Required

- Flat-tip screwdriver
- Drill
- Nippers
- Eye protection (face shield, safety goggles, and so on.)
- Masking tape
- Shop towel, cardboard and so on.
- Phillips screwdriver
- 3 mm, 5 mm and 7 mm Drill bits
- File
- Pushpin

## Before You Begin

### Customer Information

- Be extremely careful not to damage the accessory and body paint finish when removing and installing the accessory.
- Be sure to use the bolts, screws and nuts included in this kit. Use of bolts, nuts and screws other than those included in this kit may damage the parts.

## Illustration of the Components on the Vehicle

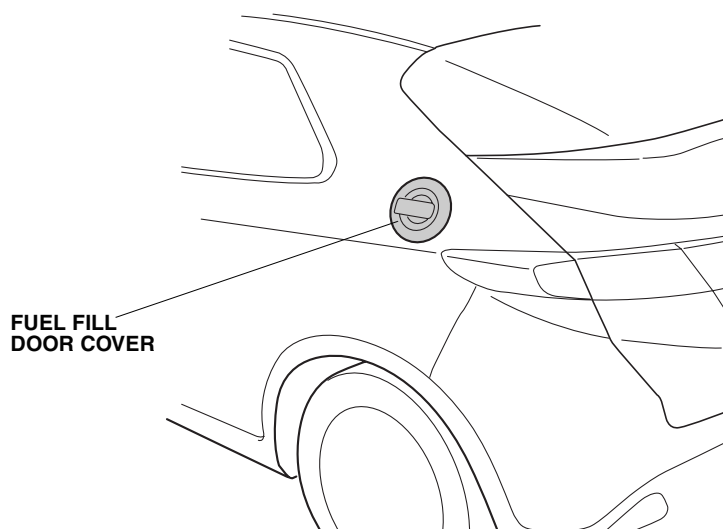

850301AT

## Installation

1. To protect vehicle body to avoid damage, attach the cover on the vehicle left side.

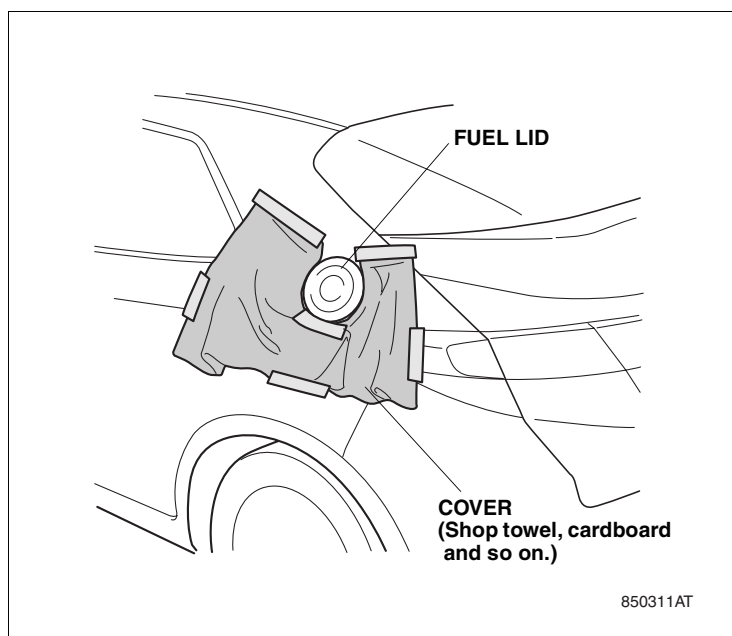

850311AT

2. Open the fuel fill door.
3. Using a flat-tip screwdriver, carefully remove the unit fuel fill door cover (discard).

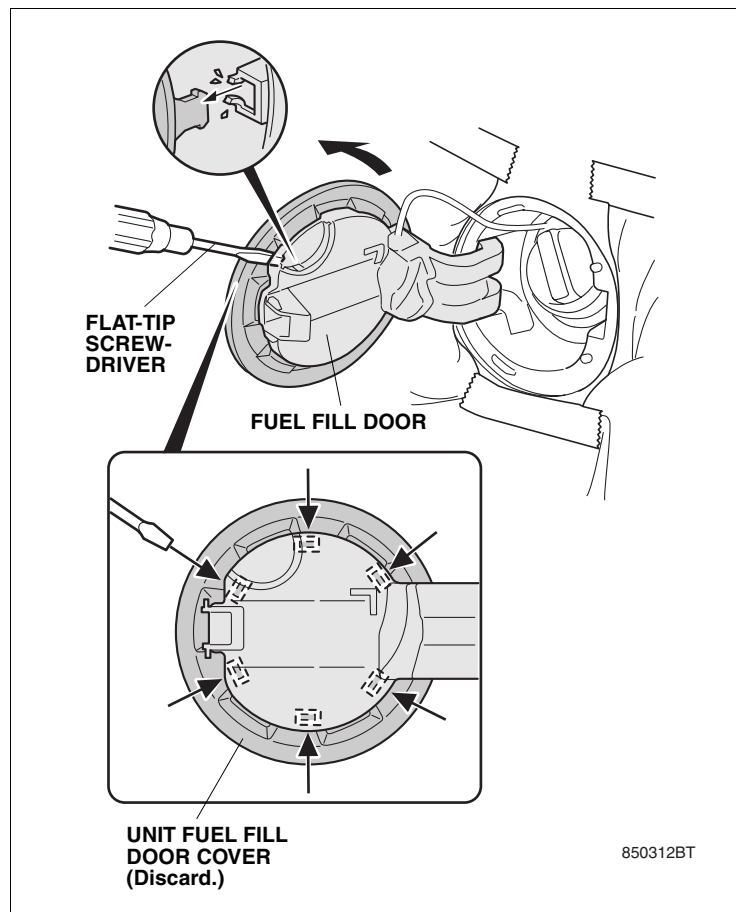

4. Close the fuel fill door.
5. Cut off all broken plastic burrs.

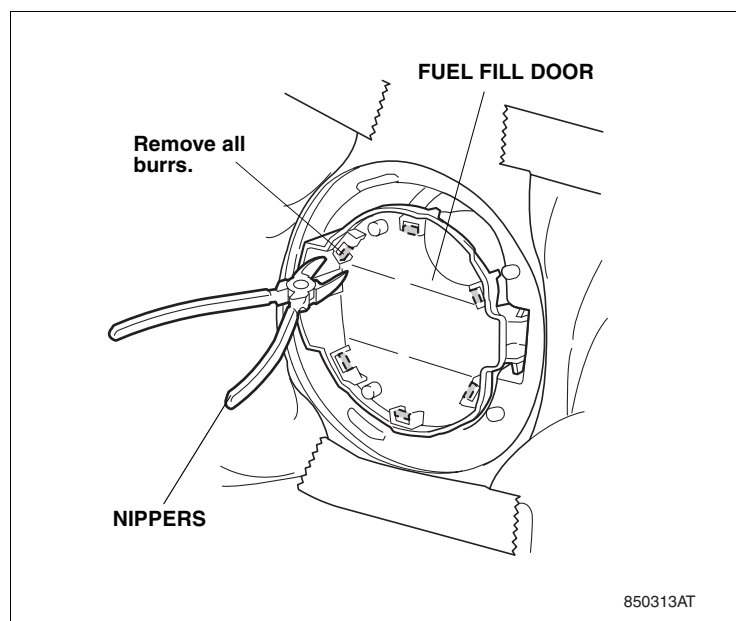

6. Apply two templates A and B, and secure them with two masking tapes.

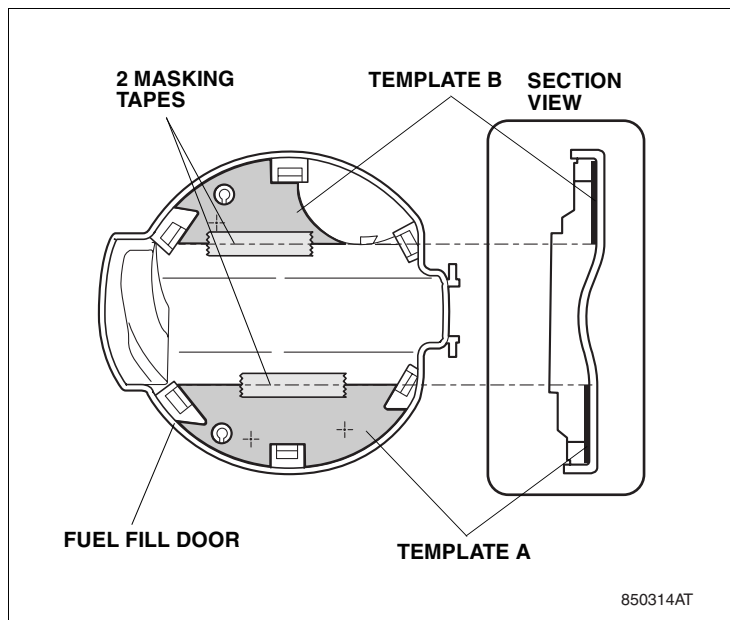

7. Using a pushpin, pierce the center of three marks on the templates A and B.

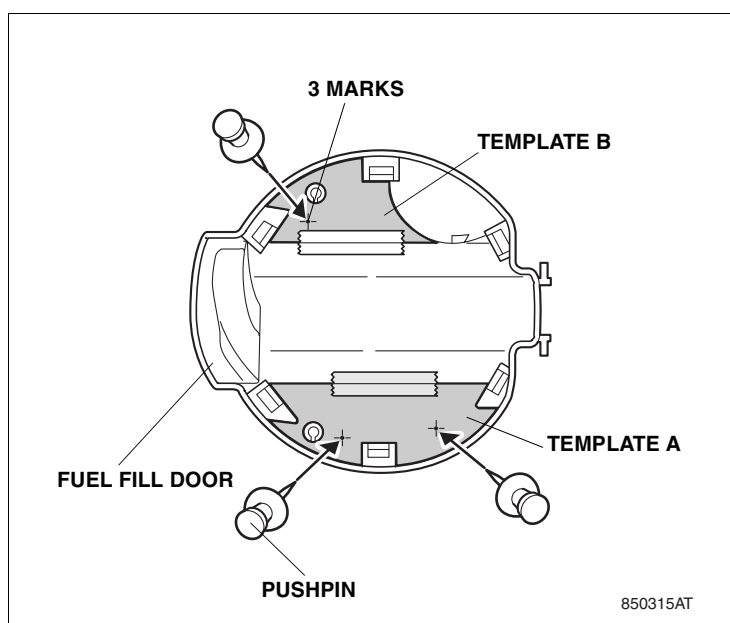

8. Open the fuel fill door.
9. From the back side, using a pushpin, and pierce the three pierced holes on the fuel fill door.

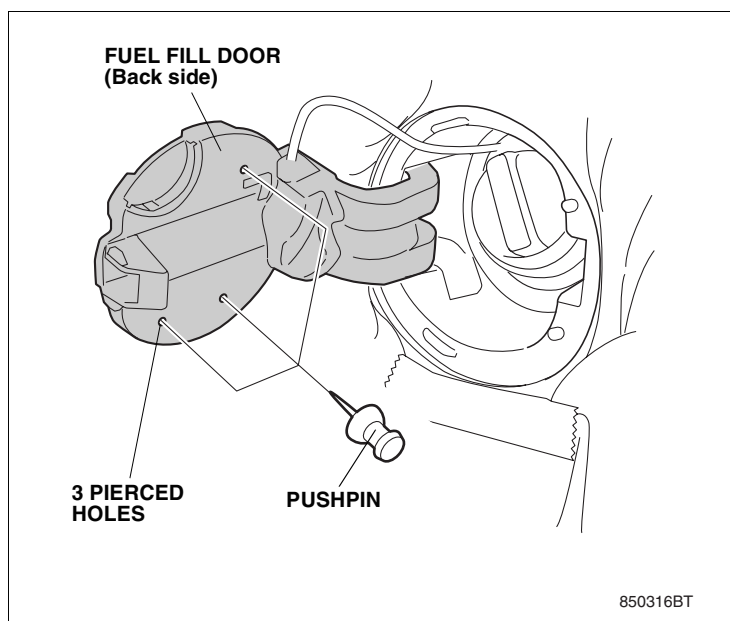

10. While wearing eye protection, carefully drill three 3 mm holes from the back side.
11. From the back side, enlarge three holes by using a 5 mm and finally a 7 mm drill bit.
12. Remove the burrs.

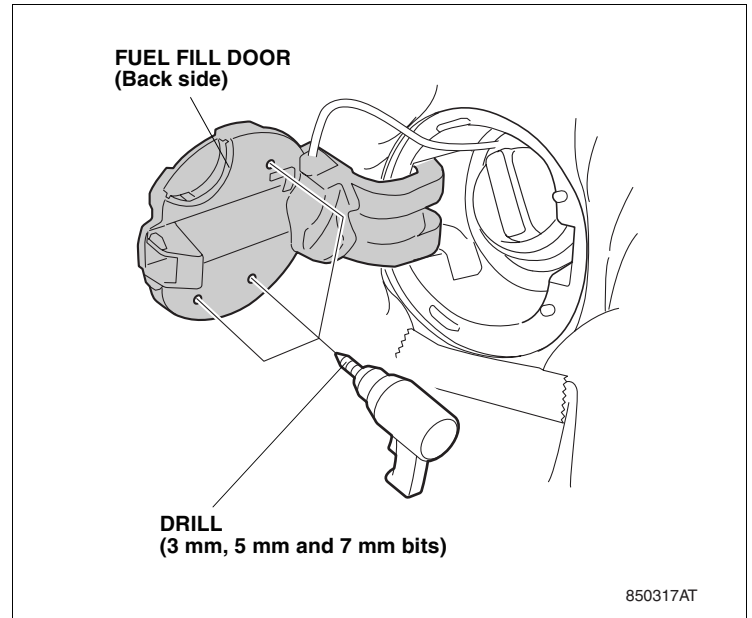

13. Position the new fuel fill door cover and fix by three bolts and three plain washers.
14. Remove the cover (shop towel, cardboard and so on.) for protect the vehicle.

